



**THE DATASHEET OF
SS-39300-001**



3

2

1

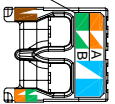

WIRE GUIDE CAP

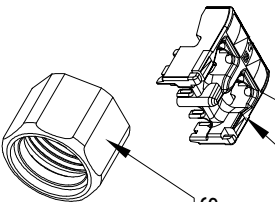

STRAIN RELIEF NUT

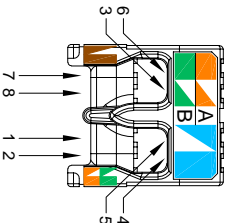

DATE	REV	ECN	APP'D. BY
09/18/18	A0	Released	DG
09/12/19	A1	11446	AB
10/16/19	A2	11459	AB
04/28/20	A3	11542	AB
03/02/21	A4	11709	AB

COMPONENTS		
ITEM	PART NAME	QTY
1	PLUG BODY	1
2	STRAIN RELIEF NUT	1
3	WIRE GUIDE CAP	1

WIRE MAP		
PIN #	TIA / EIA 568A	TIA / EIA 568B
1	WHITE/GREEN	WHITE/ORANGE
2	GREEN	ORANGE
3	WHITE/ORANGE	WHITE/GREEN
4	BLUE	BLUE
5	WHITE/BLUE	WHITE/BLUE
6	ORANGE	GREEN
7	WHITE/BROWN	WHITE/BROWN
8	BROWN	BROWN

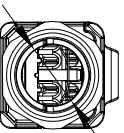
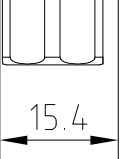
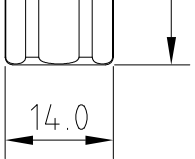
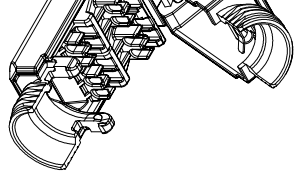
 $\phi 6.0 \sim \phi 8.0$

WIRE MAP

TRANSMISSION PERFORMANCE

Meet all requirements specified in Patch Cord requirement of ANSI/TIA-568-C-2, Category 6

ELECTRICAL

Electrical Insulation Resistance: 500M Ω min. @100V DC
 Dielectric Withstanding Voltage: IEC 60603-7
 Contact to Contact: 1000 VDC or AC Peak
 Contact to Shield: 1500 VDC or AC Peak

MECHANICAL

IDC Wire Gauge : 22 ~ 26 AWG
 This product works with 26 AWG, but cannot have been previously used with any other wire gauge if being used with 26 AWG.

PHYSICAL

Housing : Zinc-alloy fully shielded
 Contact pin : Phosphor Bronze Alloy Plated With 50 micro-inch of Gold
 IDC : Phosphor Bronze Alloy With 100 micro-inch 100% Sn Alloy

SS-39300-001
PART NUMBER

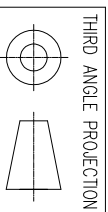

THIRD ANGLE PROJECTION

DO NOT SCALE DRAWING
 DRAWING IS SUBJECT TO
 CHANGE WITHOUT NOTICE

DIMENSIONS: METRIC
 UNLESS OTHERWISE SPECIFIED
 TOLERANCES ARE: ±0.2
 ANGLES ARE: ± 1°

SHEET NO. 1 OF 1

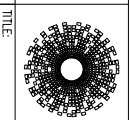

Stewart
 CONNECTOR
 a bel group

11118 Susquehanna Trail, South
 Glen Rock, PA 17327-9199
 (717) 235-7512
<http://www.stewartconnector.com>

CAT 6 FIELD TERMINATED PLUG

TITLE

THIS DRAWING AND THE SUBJECT MATTER SHOWN THEREON ARE CONFIDENTIAL AND THE PROPRIETARY PROPERTY OF STEWART CONNECTOR AND SHALL NOT BE REPRODUCED, COPIED, OR USED IN ANY MANNER WITHOUT PRIOR WRITTEN CONSENT OF STEWART CONNECTOR. ONE OR MORE U.S. PATENTS MAY APPLY TO THIS PRODUCT. FOR DETAILS, PLEASE VISIT: [HTTP://BELFUSE.COM/STEWART/STEWART_PATENTS/](http://BELFUSE.COM/STEWART/STEWART_PATENTS/)



DRN. BR.	DATE	DRN. BR.	DATE	REV.
JM	09/13/18	DG	09/18/18	A4
AWG. NO.	CT390201			



RoHS

Looking for pricing, stock, or lifecycle information?

Click below to explore more details on WIN SOURCE:

-  [View SS-39300-001 on WIN SOURCE](#)
-  [Stewart Connector Information](#)

Optimize Your Supply Chain with WIN SOURCE Solutions

-  Global Sourcing Solution
-  Obsolete Management
-  Cost Control Management
-  Shortage Management
-  Alternative Solution
-  Excess Inventory Management