

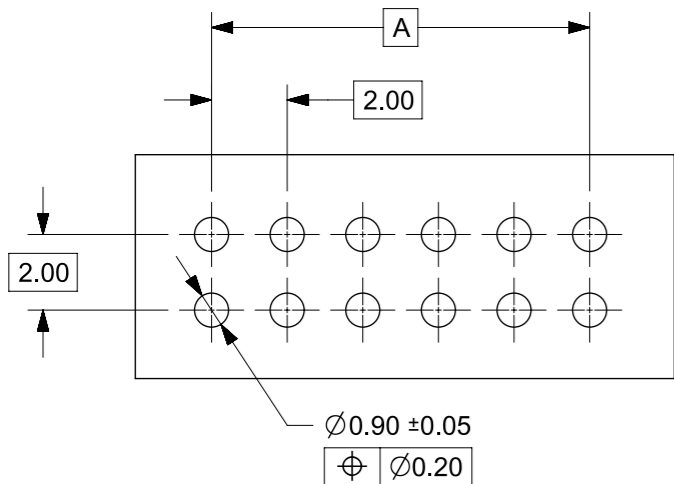

**THE DATASHEET OF**  
**0877601016+**





RECOMMENDED PCB LAYOUT

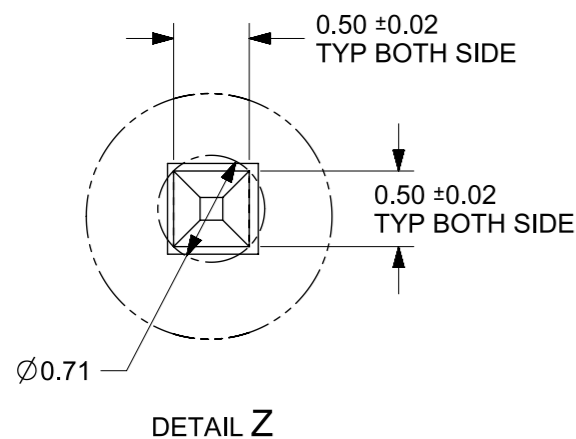
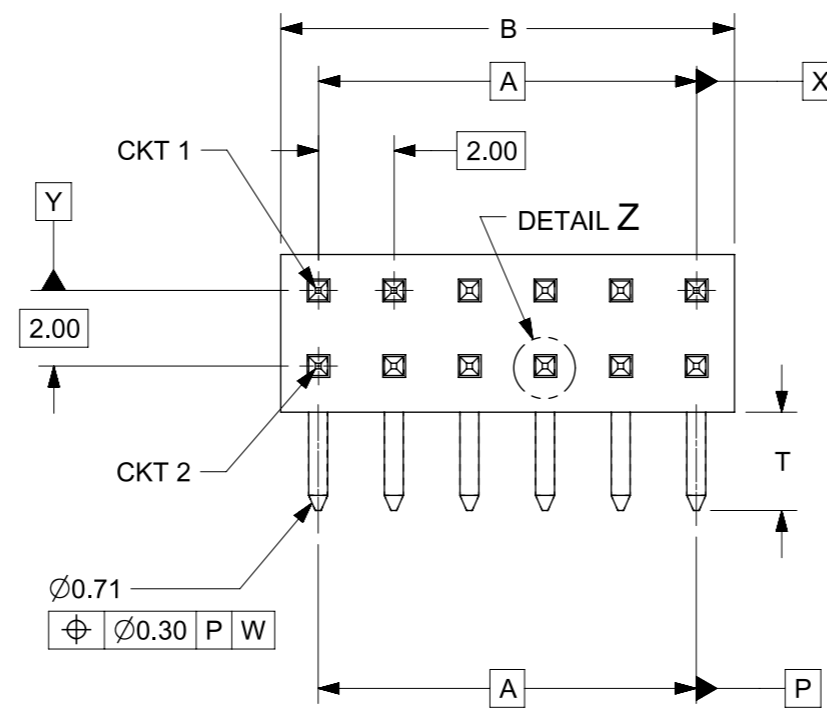
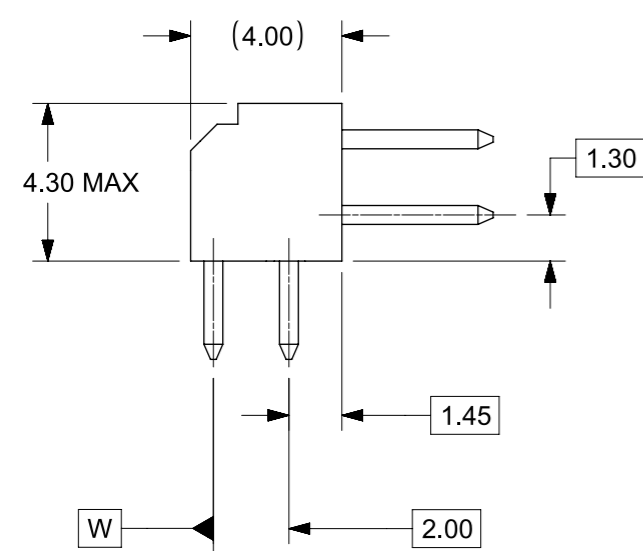
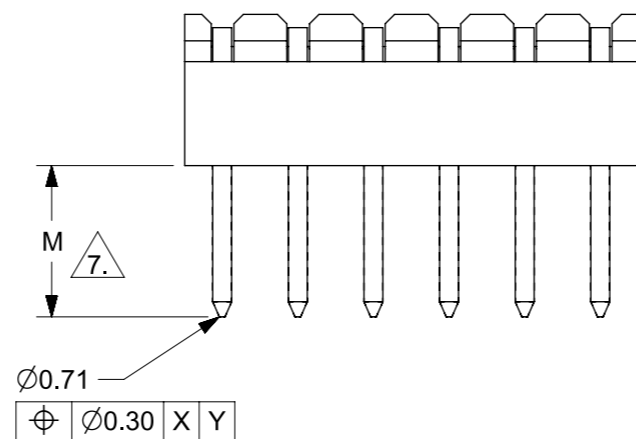

NOTES:

1. MATERIAL:  
HSG: PCT, 30% GLASS FILLED, UL 94V-0, COLOUR BLACK.  
PIN: 0.50MM SQ PHOSPHOR BRONZE 510
2. PLATING:  
\*\*\*5 - 0.05µm MIN - 0.25µm MAX GOLD IN CONTACT AREA, 2.00µm MIN TIN IN SOLDER TAIL AREA, BOTH OVER 1.25µm MIN NICKEL OVERALL  
  
\*\*\*6 - 0.38µm MIN GOLD IN CONTACT AREA, 2.00µm MIN TIN IN SOLDER TAIL AREA, BOTH OVER 1.25µm MIN NICKEL OVERALL  
  
\*\*\*7 - 0.76µm MIN GOLD IN CONTACT AREA, 2.00µm MIN TIN IN SOLDER TAIL AREA, BOTH OVER 1.25µm MIN NICKEL OVERALL  
  
\*\*\*8 - 2.54µm MIN TIN OVER 1.25µm MIN NICKEL OVERALL
3. 12 CKT USED FOR ILLUSTRATION ONLY
4. PART TO BE PACKED IN POCKET TRAY/TUBE (SEE TABLE).
5. PRODUCT SPEC PS-87761-100 APPLIES.
6. RECOMMENDED PCB BOARD THK 1.60±0.10 MM.
7. MATING LENGTH: 1 - 4.00MM  
2 - 3.50MM  
3 - 3.06MM  
4 - 5.75MM
8. PART NUMBERS THAT ARE UNAVAILABLE IN THIS SD: 87760-0646, 87760-1046, 87760-1446, 87760-2446, 87760-4046. (REFER TO SD-87760-133 FOR THESE PART NUMBERS)

LEGEND:

8 7 7 6 0 - \* \* \* \*

PLATING OPTION (SEE NOTE 2) 2.

MATING OPTION 7.

THIS DRAWING CONTAINS INFORMATION THAT IS PROPRIETARY TO MOLEX ELECTRONIC TECHNOLOGIES, LLC AND SHOULD NOT BE USED WITHOUT WRITTEN PERMISSION											
DIMENSION UNITS		SCALE		CURRENT REV DESC: MIGRATED TO ECTR						<b>molex</b>	
mm		NTS									
GENERAL TOLERANCES (UNLESS SPECIFIED)				EC NO: 178255		DRWN: VLM		2018/01/24		MGRID, 2MM DUAL ROW HDR. R/A	
				CHK'D: CD		2018/08/02					
				APPR: GGA		2018/08/03		PRODUCT CUSTOMER DRAWING			
4 PLACES ±				INITIAL REVISION:		DRWN: KSEE		2003/10/15		DOCUMENT NUMBER	
3 PLACES ±				APPR: SKTOH		2003/12/11		SD-87760-109		DOC TYPE DOC PART REVISION	
2 PLACES ± 0.2				DRAFT WHERE APPLICABLE MUST REMAIN WITHIN DIMENSIONS		THIRD ANGLE PROJECTION		DRAWING		SERIES	
1 PLACE ±				A3-SIZE		87760		MATERIAL NUMBER		CUSTOMER	
0 PLACES ±				SEE TABLE		GENERAL MARKET		SHEET NUMBER		1 OF 3	
ANGULAR TOL ± 3.0°											

PART NUMBER	VOID PIN LOCATION	CKT SIZE	A	B	M	T	PACKAGING TYPE
87760-04**	-	4	2.00	4.00	REFER TO NOTE 7.	2.60	TRAY
87760-06**	8	6	4.00	6.00			
87760-08**	-	8	6.00	8.00			
87760-10**	8	10	8.00	10.00			
87760-12**	8	12	10.00	12.00			
87760-14**	8	14	12.00	14.00			
87760-16**	-	16	14.00	16.00			
87760-18**	-	18	16.00	18.00			
87760-20**	-	20	18.00	20.00			
87760-22**	-	22	20.00	22.00			
87760-24**	8	24	22.00	24.00			
87760-26**	-	26	24.00	26.00			
87760-28**	-	28	26.00	28.00			
87760-30**	-	30	28.00	30.00			
87760-32**	-	32	30.00	32.00			
87760-34**	-	34	32.00	34.00			
87760-36**	-	36	34.00	36.00			
87760-38**	-	38	36.00	38.00			
87760-40**	8	40	38.00	40.00			
87760-42**	-	42	40.00	42.00			
87760-44**	-	44	42.00	44.00			
87760-46**	-	46	44.00	46.00			
87760-48**	-	48	46.00	48.00			
87760-50**	-	50	48.00	50.00			

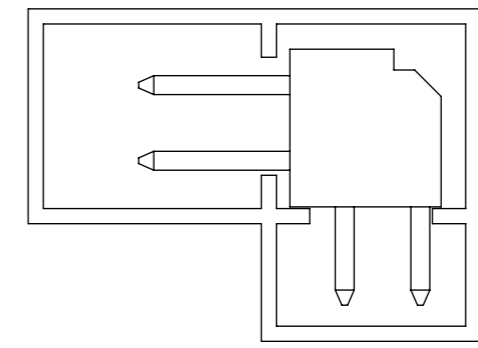

PART IN TUBE

THIS DRAWING CONTAINS INFORMATION THAT IS PROPRIETARY TO MOLEX ELECTRONIC TECHNOLOGIES, LLC AND SHOULD NOT BE USED WITHOUT WRITTEN PERMISSION

DIMENSION UNITS		SCALE		CURRENT REV DESC: MIGRATED TO ECTR				<b>molex</b>			
mm		NTS									
GENERAL TOLERANCES (UNLESS SPECIFIED)				EC NO: 178255				MGRID, 2MM DUAL ROW HDR. R/A			
				DRWN: VLM 2018/01/24							
				CHK'D: CD 2018/08/02				PRODUCT CUSTOMER DRAWING			
				APPR: GGA 2018/08/03							
				INITIAL REVISION:				DOCUMENT NUMBER			
4 PLACES ±				DRWN: KSEE 2003/10/15				SD-87760-109			
3 PLACES ±				APPR: SKTOH 2003/12/11				PSD 001 A17			
2 PLACES ± 0.2				ANGULAR TOL ± 3.0°				MATERIAL NUMBER			
1 PLACE ±				DRAFT WHERE APPLICABLE MUST REMAIN WITHIN DIMENSIONS				CUSTOMER			
0 PLACES ±				THIRD ANGLE PROJECTION				SHEET NUMBER			
				DRAWING				GENERAL MARKET			
				SERIES				2 OF 3			
				A3-SIZE							
				87760							

PART NUMBER	VOID PIN LOCATION	CKT SIZE	A	B	M	T	PACKAGING TYPE
87760-5116	5, 6 & 26	50	48.00	50.00	REFER TO NOTE 7.	2.60	TUBE
87760-531*	-	24	22.00	24.00		1.50	TRAY
87760-5216	-	04	2.00	4.00		2.60	TUBE
87760-5416	-	20	18.00	20.00			
87760-5248	-	28	26.00	28.00			
87760-5516	5, 6, 7, 8, 9, 10, 15, 16, 17, 18, 19, 20, 25, 26, 27, 28, 29, 30	34	32.00	34.00			

THIS DRAWING CONTAINS INFORMATION THAT IS PROPRIETARY TO MOLEX ELECTRONIC TECHNOLOGIES, LLC AND SHOULD NOT BE USED WITHOUT WRITTEN PERMISSION

DIMENSION UNITS		SCALE		CURRENT REV DESC: MIGRATED TO ECTR		<b>molex</b>	
mm		NTS					
GENERAL TOLERANCES (UNLESS SPECIFIED)				EC NO: 178255		MGRID, 2MM DUAL ROW HDR. R/A	
		MM	INCH	DRWN: VLM 2018/01/24			
4 PLACES		±	±	CHK'D: CD 2018/08/02		PRODUCT CUSTOMER DRAWING	
3 PLACES		±	±	APPR: GGA 2018/08/03			
2 PLACES		± 0.2	±	INITIAL REVISION:		DOCUMENT NUMBER	
1 PLACE		±	±	DRWN: KSEE 2003/10/15		SD-87760-109	
0 PLACES		±	±	APPR: SKTOH 2003/12/11		PSD 001 A17	
ANGULAR TOL		± 3.0°		DRAFT WHERE APPLICABLE MUST REMAIN WITHIN DIMENSIONS		THIRD ANGLE PROJECTION	
DRAWING		SERIES		MATERIAL NUMBER		CUSTOMER	
A3-SIZE		87760		SEE TABLE		GENERAL MARKET	
SHEET NUMBER		3 OF 3					

## Looking for pricing, stock, or lifecycle information?

Click below to explore more details on WIN SOURCE:

 [View 0877601016+ on WIN SOURCE](#)

 [Molex, LLC Information](#)

## Optimize Your Supply Chain with WIN SOURCE Solutions

-  Global Sourcing Solution
-  Obsolete Management
-  Cost Control Management
-  Shortage Management
-  Alternative Solution
-  Excess Inventory Management