



**THE DATASHEET OF**  
**M39003/09-3009**



## Solid-Electrolyte TANTALEX™ Capacitors, Military MIL-PRF-39003/09 Qualified, Style CSR21



### FEATURES

- Hermetically sealed
- Metal cased
- Axial lead
- Weibull failure rates B, C, D
- Exponential failure rates M, P, R, S
- Low ESR
- 100 % surge current test
- Tape and reel available per EIA-296 standard

### PERFORMANCE CHARACTERISTICS

**Operating Temperature:** -55 °C to +125 °C  
(above 85 °C, voltage derating is required)

**Capacitance Range:** 5.6 µF to 330 µF

**Capacitance Tolerance:** ± 5 %, ± 10 %, ± 20 %

**Voltage Rating:** 6 V<sub>DC</sub> to 50 V<sub>DC</sub>

### DESCRIPTION

Solid-electrolyte TANTALEX capacitors to military specification MIL-PRF-39003 - Exponential and Weibull Distribution: hermetically sealed, metal cased, axial leaded tubular capacitors manufactured as military style CSR21. These capacitors are furnished to the requirements of the military specification, including marking, testing and inspection.

In accordance with the specification, all capacitors are marked with the military part number (M39003/xx-xxxx) rather than the older style designation (CSRxxxxxxx) and should be ordered as such. All capacitors covered by MIL-PRF-39003 are now ordered with the military part number as illustrated in the Part Numbering System chart. Capacitors must not be ordered using the style number identification.

### STYLE, MILITARY SPECIFICATION SHEET

Style CSR21, M39003/09 MIL-PRF-39003/9

MIL-PRF-39003 establishes failure rates (expressed in percent per 1000 h) based on exponential and Weibull distribution. Care must be exercised in ordering to insure the part number correctly identifies the desired failure rate level.

In addition, each order for military style CSR13, CSR21, CSR23 capacitors requiring government inspection must state whether inspection is to be at the destination or at the Vishay plant. Orders requiring source inspection cannot be shipped until this has been accomplished.

For information on the performance characteristics of these capacitors, please refer to the latest issue of the military specification.

| ORDERING INFORMATION  |   |   |   |   |
|---|---|---|---|---|
| <b>M39003</b>   | <b>/09</b>  | <b>-2085</b>  | <b>B</b>  | <b>/TR</b>  |
| BASIC<br>DOCUMENT NUMBER                                      | SLASH SHEET   | DASH NUMBER   | SURGE CURRENT<br>OPTION LETTER  | PACKAGING OPTION <sup>(1)</sup>   |
| Indicates the Basic Specification; in this case MIL-PRF-39003 | Indicates the Specification Sheet of the Basic Military Specification | Taken from Ratings table of the Specification Sheet | Blank = standard, +25 °C, after Weibull<br>B = -55 °C and +85 °C, after Weibull<br>C = -55 °C and +85 °C, before Weibull<br>E = -55 °C and +85 °C, after Weibull, high temperature solder<br>F = -55 °C and +85 °C, before Weibull, high temperature solder<br>H = +25 °C, after Weibull, high temperature solder | Blank = bulk<br>/TR = tape and reel, full reel<br>/HR = tape and reel, half reel<br>/PR = tape and reel, partial reel<br>/RR = tape and reel, option R, full reel<br>/WR = tape and reel, option W, full reel |

**Note**

<sup>(1)</sup> See detailed packaging information following the Standard Ratings table

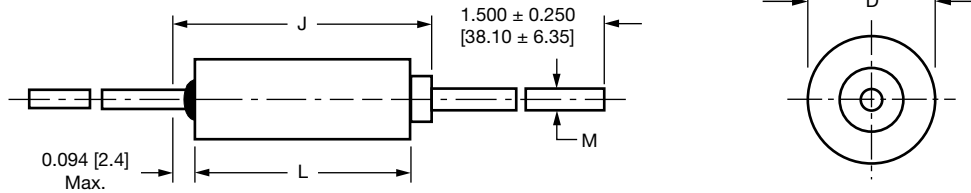
**DIMENSIONS** in inches [millimeters]

| CASE CODE | L<br>± 0.031 [0.79] | D<br>+ 0.016 [0.41]<br>- 0.015 [0.38] | M<br>± 0.002 [0.05] | J<br>(MAX.)   |
|-----------|---------------------|---------------------------------------|---------------------|---------------|
| C         | 0.686 [17.42]       | 0.289 [7.34]                          | 0.025 [0.64]        | 0.822 [20.88] |
| D         | 0.786 [19.96]       | 0.351 [8.92]                          | 0.025 [0.64]        | 0.922 [23.42] |

**Notes**

- Capacitors of this series are supplied with shrink-fitted insulation sleeve. The insulation sleeve laps over the ends of the capacitor body, extending by 0.015" [0.38 mm] minimum beyond each end. Dimensions L and D include insulation sleeve additives. Dimension J is always larger than L and is not affected by insulation sleeve
- A minimum lead length of 1.0" [25.4 mm] for use with tape and reel automatic insertion equipment is available upon request

**RATINGS AND CASE CODES**

| μF  | 6 V | 10 V | 15 V | 20 V | 35 V | 50 V |
|-----|-----|------|------|------|------|------|
| 5.6 |     |      |      |      |      | C    |
| 6.8 |     |      |      |      |      | C    |
| 8.2 |     |      |      |      |      | C    |
| 10  |     |      |      |      |      | C    |
| 12  |     |      |      |      |      | C    |
| 15  |     |      |      |      |      | C    |
| 18  |     |      |      |      |      | C    |
| 22  |     |      |      |      | C    | D    |
| 27  |     |      |      | C    | D    |      |
| 33  |     |      |      | C    | D    |      |
| 39  |     |      |      | C    | D    |      |
| 47  |     |      |      | C    | D    |      |
| 56  |     |      | C    | D    |      |      |
| 68  |     |      | C    | D    |      |      |
| 82  |     | C    |      | D    |      |      |
| 100 |     | C    |      | D    |      |      |
| 120 |     | C    | D    |      |      |      |
| 150 | C   |      | D    |      |      |      |
| 180 | C   | D    |      |      |      |      |
| 220 |     | D    |      |      |      |      |
| 270 | D   |      |      |      |      |      |
| 330 | D   |      |      |      |      |      |



| STANDARD RATINGS   |              |                            |  |      |      |       |      |      |       |                        |        |         |                         |                          |  |       |
|--|--------------|----------------------------|--|------|------|-------|------|------|-------|------------------------|--------|---------|-------------------------|--------------------------|--|-------|
| CAPACITANCE<br>( $\mu$ F)  | CASE<br>CODE | CAP.<br>TOL.<br>( $\pm$ %) | PART NO. M39003/09-<br>FAILURE RATE LEVEL (%/1000 h) |      |      |       |      |      |       | MAX. DCL ( $\mu$ A) AT |        |         | MAX.<br>DF AT<br>+25 °C | MAX.<br>ESR AT<br>+25 °C | DERATED<br>MAX. RIPPLE<br>CURRENT<br>AT +25 °C |       |
|  |              |                            | M  | P    | R    | S     | B    | C    | D     | +25 °C                 | +85 °C | +125 °C | 1 kHz<br>(%)            | 100 kHz<br>( $\Omega$ )  | 40 kHz<br>(A)                                  | 1 kHz |
|  |              |                            | 1.0  | 0.1  | 0.01 | 0.001 | 0.1  | 0.01 | 0.001 |                        |        |         |                         |                          |  |       |
| <b>6 V<sub>DC</sub> AT +85 °C, SURGE = 8 V; 4 V<sub>DC</sub> AT +125 °C</b>    |              |                            |  |      |      |       |      |      |       |                        |        |         |                         |                          |  |       |
| 150  | C            | 5                          | 0001   | 0101 | 0201 | 0301  | 2001 | 3001 | 4001  | 4.5                    | 90.0   | 113     | 10                      | 0.065                    | 3.3  | 2.0   |
| 150  | C            | 10                         | 0002   | 0102 | 0202 | 0302  | 2002 | 3002 | 4002  | 4.5                    | 90.0   | 113     | 10                      | 0.065                    | 3.3  | 2.0   |
| 150  | C            | 20                         | 0003   | 0103 | 0203 | 0303  | 2003 | 3003 | 4003  | 4.5                    | 90.0   | 113     | 10                      | 0.065                    | 3.3  | 2.0   |
| 180  | C            | 5                          | 0004   | 0104 | 0204 | 0304  | 2004 | 3004 | 4004  | 5.5                    | 110    | 138     | 10                      | 0.060                    | 3.4  | 2.4   |
| 180  | C            | 10                         | 0005   | 0105 | 0205 | 0305  | 2005 | 3005 | 4005  | 5.5                    | 110    | 138     | 10                      | 0.060                    | 3.4  | 2.4   |
| 270  | D            | 5                          | 0006   | 0106 | 0206 | 0306  | 2006 | 3006 | 4006  | 6.5                    | 130    | 163     | 10                      | 0.050                    | 4.1  | 3.4   |
| 270  | D            | 10                         | 0007   | 0107 | 0207 | 0307  | 2007 | 3007 | 4007  | 6.5                    | 130    | 163     | 10                      | 0.050                    | 4.1  | 3.4   |
| 330  | D            | 5                          | 0008   | 0108 | 0208 | 0308  | 2008 | 3008 | 4008  | 7.5                    | 150    | 188     | 12                      | 0.045                    | 4.3  | 3.8   |
| 330  | D            | 10                         | 0009   | 0109 | 0209 | 0309  | 2009 | 3009 | 4009  | 7.5                    | 150    | 188     | 12                      | 0.045                    | 4.3  | 3.8   |
| 330  | D            | 20                         | 0010   | 0110 | 0210 | 0310  | 2010 | 3010 | 4010  | 7.5                    | 150    | 188     | 12                      | 0.045                    | 4.3  | 3.8   |
| <b>10 V<sub>DC</sub> AT +85 °C, SURGE = 13 V; 7 V<sub>DC</sub> AT +125 °C</b>  |              |                            |  |      |      |       |      |      |       |                        |        |         |                         |                          |  |       |
| 82   | C            | 5                          | 0011   | 0111 | 0211 | 0311  | 2011 | 3011 | 4011  | 4.0                    | 80.0   | 100     | 8                       | 0.085                    | 2.9  | 1.8   |
| 82   | C            | 10                         | 0012   | 0112 | 0212 | 0312  | 2012 | 3012 | 4012  | 4.0                    | 80.0   | 100     | 8                       | 0.085                    | 2.9  | 1.8   |
| 100  | C            | 5                          | 0013   | 0113 | 0213 | 0313  | 2013 | 3013 | 4013  | 5.0                    | 100    | 125     | 8                       | 0.075                    | 3.0  | 2.2   |
| 100  | C            | 10                         | 0014   | 0114 | 0214 | 0314  | 2014 | 3014 | 4014  | 5.0                    | 100    | 125     | 8                       | 0.075                    | 3.0  | 2.2   |
| 100  | C            | 20                         | 0015   | 0115 | 0215 | 0315  | 2015 | 3015 | 4015  | 5.0                    | 100    | 125     | 8                       | 0.075                    | 3.0  | 2.2   |
| 120  | C            | 5                          | 0016   | 0116 | 0216 | 0316  | 2016 | 3016 | 4016  | 6.0                    | 120    | 150     | 8                       | 0.070                    | 3.2  | 2.5   |
| 120  | C            | 10                         | 0017   | 0117 | 0217 | 0317  | 2017 | 3017 | 4017  | 6.0                    | 120    | 150     | 8                       | 0.070                    | 3.2  | 2.5   |
| 180  | D            | 5                          | 0018   | 0118 | 0218 | 0318  | 2018 | 3018 | 4018  | 9.0                    | 180    | 226     | 8                       | 0.060                    | 3.7  | 3.4   |
| 180  | D            | 10                         | 0019   | 0119 | 0219 | 0319  | 2019 | 3019 | 4019  | 9.0                    | 180    | 226     | 8                       | 0.060                    | 3.7  | 3.4   |
| 220  | D            | 5                          | 0020   | 0120 | 0220 | 0320  | 2020 | 3020 | 4020  | 10.0                   | 200    | 250     | 10                      | 0.055                    | 3.9  | 3.4   |
| 220  | D            | 10                         | 0021   | 0121 | 0221 | 0321  | 2021 | 3021 | 4021  | 10.0                   | 200    | 250     | 10                      | 0.055                    | 3.9  | 3.4   |
| 220  | D            | 20                         | 0022   | 0122 | 0222 | 0322  | 2022 | 3022 | 4022  | 10.0                   | 200    | 250     | 10                      | 0.055                    | 3.9  | 3.4   |
| <b>15 V<sub>DC</sub> AT +85 °C, SURGE = 20 V; 10 V<sub>DC</sub> AT +125 °C</b> |              |                            |  |      |      |       |      |      |       |                        |        |         |                         |                          |  |       |
| 56   | C            | 5                          | 0023   | 0123 | 0223 | 0323  | 2023 | 3023 | 4023  | 4.0                    | 80.0   | 100     | 6                       | 0.100                    | 2.6  | 1.8   |
| 56   | C            | 10                         | 0024   | 0124 | 0224 | 0324  | 2024 | 3024 | 4024  | 4.0                    | 80.0   | 100     | 6                       | 0.100                    | 2.6  | 1.8   |
| 68   | C            | 5                          | 0025   | 0125 | 0225 | 0325  | 2025 | 3025 | 4025  | 5.0                    | 100    | 125     | 6                       | 0.095                    | 2.7  | 2.2   |
| 68   | C            | 10                         | 0026   | 0126 | 0226 | 0326  | 2026 | 3026 | 4026  | 5.0                    | 100    | 125     | 6                       | 0.095                    | 2.7  | 2.2   |
| 68   | C            | 20                         | 0027   | 0127 | 0227 | 0327  | 2027 | 3027 | 4027  | 5.0                    | 100    | 125     | 6                       | 0.095                    | 2.7  | 2.2   |
| 120  | D            | 5                          | 0028   | 0128 | 0228 | 0328  | 2028 | 3028 | 4028  | 9.0                    | 180    | 226     | 8                       | 0.070                    | 3.5  | 2.8   |
| 120  | D            | 10                         | 0029   | 0129 | 0229 | 0329  | 2029 | 3029 | 4029  | 9.0                    | 180    | 226     | 8                       | 0.070                    | 3.5  | 2.8   |
| 150  | D            | 5                          | 0030   | 0130 | 0230 | 0330  | 2030 | 3030 | 4030  | 10.0                   | 200    | 250     | 8                       | 0.065                    | 3.6  | 3.1   |
| 150  | D            | 10                         | 0031   | 0131 | 0231 | 0331  | 2031 | 3031 | 4031  | 10.0                   | 200    | 250     | 8                       | 0.065                    | 3.6  | 3.1   |
| 150  | D            | 20                         | 0032   | 0132 | 0232 | 0332  | 2032 | 3032 | 4032  | 10.0                   | 200    | 250     | 8                       | 0.065                    | 3.6  | 3.1   |
| <b>20 V<sub>DC</sub> AT +85 °C, SURGE = 26 V; 13 V<sub>DC</sub> AT +125 °C</b> |              |                            |  |      |      |       |      |      |       |                        |        |         |                         |                          |  |       |
| 27   | C            | 5                          | 0033   | 0133 | 0233 | 0333  | 2033 | 3033 | 4033  | 2.5                    | 50.0   | 63.0    | 5                       | 0.145                    | 2.2  | 1.2   |
| 27   | C            | 10                         | 0034   | 0134 | 0234 | 0334  | 2034 | 3034 | 4034  | 2.5                    | 50.0   | 63.0    | 5                       | 0.145                    | 2.2  | 1.2   |
| 33   | C            | 5                          | 0035   | 0135 | 0235 | 0335  | 2035 | 3035 | 4035  | 3.5                    | 70.0   | 88.0    | 5                       | 0.130                    | 2.3  | 1.4   |
| 33   | C            | 10                         | 0036   | 0136 | 0236 | 0336  | 2036 | 3036 | 4036  | 3.5                    | 70.0   | 88.0    | 5                       | 0.130                    | 2.3  | 1.4   |
| 33   | C            | 20                         | 0037   | 0137 | 0237 | 0337  | 2037 | 3037 | 4037  | 3.5                    | 70.0   | 88.0    | 5                       | 0.130                    | 2.3  | 1.4   |
| 39   | C            | 5                          | 0038   | 0138 | 0238 | 0338  | 2038 | 3038 | 4038  | 4.0                    | 80.0   | 100     | 5                       | 0.120                    | 2.4  | 1.7   |
| 39   | C            | 10                         | 0039   | 0139 | 0239 | 0339  | 2039 | 3039 | 4039  | 4.0                    | 80.0   | 100     | 5                       | 0.120                    | 2.4  | 1.7   |
| 47   | C            | 5                          | 0040   | 0140 | 0240 | 0340  | 2040 | 3040 | 4040  | 4.5                    | 90.0   | 113     | 6                       | 0.110                    | 2.5  | 1.8   |



| STANDARD RATINGS   |              |                            |  |      |      |       |      |      |       |                        |        |         |   |   |   |       |
|--|--------------|----------------------------|--|------|------|-------|------|------|-------|------------------------|--------|---------|---|---|---|-------|
| CAPACITANCE<br>( $\mu$ F)  | CASE<br>CODE | CAP.<br>TOL.<br>( $\pm$ %) | PART NO. M39003/09-<br>FAILURE RATE LEVEL (%/1000 h) |      |      |       |      |      |       | MAX. DCL ( $\mu$ A) AT |        |         | MAX.<br>DF AT<br>+25 °C<br>1 kHz<br>(%) | MAX.<br>ESR AT<br>+25 °C<br>100 kHz<br>( $\Omega$ ) | DERATED<br>MAX. RIPPLE<br>CURRENT<br>AT +25 °C<br>(A) |       |
|  |              |                            | M  | P    | R    | S     | B    | C    | D     | +25 °C                 | +85 °C | +125 °C |   |   | 40 kHz  | 1 kHz |
|  |              |                            | 1.0  | 0.1  | 0.01 | 0.001 | 0.1  | 0.01 | 0.001 |                        |        |         |   |   |   |       |
| <b>20 V<sub>DC</sub> AT +85 °C, SURGE = 26 V; 13 V<sub>DC</sub> AT +125 °C</b> |              |                            |  |      |      |       |      |      |       |                        |        |         |   |   |   |       |
| 47   | C            | 10                         | 0041   | 0141 | 0241 | 0341  | 2041 | 3041 | 4041  | 4.5                    | 90.0   | 113     | 6                                       | 0.110   | 2.5   | 1.8   |
| 47   | C            | 20                         | 0042   | 0142 | 0242 | 0342  | 2042 | 3042 | 4042  | 4.5                    | 90.0   | 113     | 6                                       | 0.110   | 2.5   | 1.8   |
| 56   | D            | 5                          | 0043   | 0143 | 0243 | 0343  | 2043 | 3043 | 4043  | 5.5                    | 110    | 138     | 6                                       | 0.100   | 2.9   | 2.2   |
| 56   | D            | 10                         | 0044   | 0144 | 0244 | 0344  | 2044 | 3044 | 4044  | 5.5                    | 110    | 138     | 6                                       | 0.100   | 2.9   | 2.2   |
| 68   | D            | 5                          | 0045   | 0145 | 0245 | 0345  | 2045 | 3045 | 4045  | 7.0                    | 140    | 175     | 6                                       | 0.095   | 3.0   | 2.4   |
| 68   | D            | 10                         | 0046   | 0146 | 0246 | 0346  | 2046 | 3046 | 4046  | 7.0                    | 140    | 175     | 6                                       | 0.095   | 3.0   | 2.4   |
| 68   | D            | 20                         | 0047   | 0147 | 0247 | 0347  | 2047 | 3047 | 4047  | 7.0                    | 140    | 175     | 6                                       | 0.095   | 3.0   | 2.4   |
| 82   | D            | 5                          | 0048   | 0148 | 0248 | 0348  | 2048 | 3048 | 4048  | 8.0                    | 160    | 200     | 6                                       | 0.085   | 3.1   | 2.5   |
| 82   | D            | 10                         | 0049   | 0149 | 0249 | 0349  | 2049 | 3049 | 4049  | 8.0                    | 160    | 200     | 6                                       | 0.085   | 3.1   | 2.5   |
| 100  | D            | 5                          | 0050   | 0150 | 0250 | 0350  | 2050 | 3050 | 4050  | 10.0                   | 200    | 250     | 8                                       | 0.075   | 3.3   | 2.5   |
| 100  | D            | 10                         | 0051   | 0151 | 0251 | 0351  | 2051 | 3051 | 4051  | 10.0                   | 200    | 250     | 8                                       | 0.075   | 3.3   | 2.5   |
| 100  | D            | 20                         | 0052   | 0152 | 0252 | 0352  | 2052 | 3052 | 4052  | 10.0                   | 200    | 250     | 8                                       | 0.075   | 3.3   | 2.5   |
| <b>35 V<sub>DC</sub> AT +85 °C, SURGE = 46 V; 23 V<sub>DC</sub> AT +125 °C</b> |              |                            |  |      |      |       |      |      |       |                        |        |         |   |   |   |       |
| 22   | C            | 5                          | 0053   | 0153 | 0253 | 0353  | 2053 | 3053 | 4053  | 4.0                    | 80.0   | 100     | 4                                       | 0.160   | 2.1   | 1.5   |
| 22   | C            | 10                         | 0054   | 0154 | 0254 | 0354  | 2054 | 3054 | 4054  | 4.0                    | 80.0   | 100     | 4                                       | 0.160   | 2.1   | 1.5   |
| 22   | C            | 20                         | 0055   | 0155 | 0255 | 0355  | 2055 | 3055 | 4055  | 4.0                    | 80.0   | 100     | 4                                       | 0.160   | 2.1   | 1.5   |
| 27   | D            | 5                          | 0056   | 0156 | 0256 | 0356  | 2056 | 3056 | 4056  | 4.5                    | 90.0   | 113     | 4                                       | 0.145   | 2.4   | 1.9   |
| 27   | D            | 10                         | 0057   | 0157 | 0257 | 0357  | 2057 | 3057 | 4057  | 4.5                    | 90.0   | 113     | 4                                       | 0.145   | 2.4   | 1.9   |
| 33   | D            | 5                          | 0058   | 0158 | 0258 | 0358  | 2058 | 3058 | 4058  | 5.5                    | 110    | 138     | 5                                       | 0.130   | 2.5   | 1.9   |
| 33   | D            | 10                         | 0059   | 0159 | 0259 | 0359  | 2059 | 3059 | 4059  | 5.5                    | 110    | 138     | 5                                       | 0.130   | 2.5   | 1.9   |
| 33   | D            | 20                         | 0060   | 0160 | 0260 | 0360  | 2060 | 3060 | 4060  | 5.5                    | 110    | 138     | 5                                       | 0.130   | 2.5   | 1.9   |
| 39   | D            | 5                          | 0061   | 0161 | 0261 | 0361  | 2061 | 3061 | 4061  | 7.0                    | 140    | 175     | 5                                       | 0.120   | 2.6   | 2.0   |
| 39   | D            | 10                         | 0062   | 0162 | 0262 | 0362  | 2062 | 3062 | 4062  | 7.0                    | 140    | 175     | 5                                       | 0.120   | 2.6   | 2.0   |
| 47   | D            | 5                          | 0063   | 0163 | 0263 | 0363  | 2063 | 3063 | 4063  | 8.0                    | 160    | 200     | 5                                       | 0.110   | 2.7   | 2.2   |
| 47   | D            | 10                         | 0064   | 0164 | 0264 | 0364  | 2064 | 3064 | 4064  | 8.0                    | 160    | 200     | 5                                       | 0.110   | 2.7   | 2.2   |
| 47   | D            | 20                         | 0065   | 0165 | 0265 | 0365  | 2065 | 3065 | 4065  | 8.0                    | 160    | 200     | 5                                       | 0.110   | 2.7   | 2.2   |
| <b>50 V<sub>DC</sub> AT +85 °C, SURGE = 65 V; 33 V<sub>DC</sub> AT +125 °C</b> |              |                            |  |      |      |       |      |      |       |                        |        |         |   |   |   |       |
| 5.6  | C            | 5                          | 0066   | 0166 | 0266 | 0366  | 2066 | 3066 | 4066  | 2.2                    | 45.0   | 56.0    | 3                                       | 0.300   | 1.5   | 0.6   |
| 5.6  | C            | 10                         | 0067   | 0167 | 0267 | 0367  | 2067 | 3067 | 4067  | 2.2                    | 45.0   | 56.0    | 3                                       | 0.300   | 1.5   | 0.6   |
| 6.8  | C            | 5                          | 0068   | 0168 | 0268 | 0368  | 2068 | 3068 | 4068  | 2.2                    | 45.0   | 56.0    | 3                                       | 0.275   | 1.6   | 0.7   |
| 6.8  | C            | 10                         | 0069   | 0169 | 0269 | 0369  | 2069 | 3069 | 4069  | 2.2                    | 45.0   | 56.0    | 3                                       | 0.275   | 1.6   | 0.7   |
| 6.8  | C            | 20                         | 0070   | 0170 | 0270 | 0370  | 2070 | 3070 | 4070  | 2.2                    | 45.0   | 56.0    | 3                                       | 0.275   | 1.6   | 0.7   |
| 8.2  | C            | 5                          | 0071   | 0171 | 0271 | 0371  | 2071 | 3071 | 4071  | 2.5                    | 50.0   | 63.0    | 3                                       | 0.250   | 1.6   | 0.9   |
| 8.2  | C            | 10                         | 0072   | 0172 | 0272 | 0372  | 2072 | 3072 | 4072  | 2.5                    | 50.0   | 63.0    | 3                                       | 0.250   | 1.6   | 0.9   |
| 10   | C            | 5                          | 0073   | 0173 | 0273 | 0373  | 2073 | 3073 | 4073  | 2.5                    | 50.0   | 63.0    | 3                                       | 0.230   | 1.7   | 1.1   |
| 10   | C            | 10                         | 0074   | 0174 | 0274 | 0374  | 2074 | 3074 | 4074  | 2.5                    | 50.0   | 63.0    | 3                                       | 0.230   | 1.7   | 1.1   |
| 10   | C            | 20                         | 0075   | 0175 | 0275 | 0375  | 2075 | 3075 | 4075  | 2.5                    | 50.0   | 63.0    | 3                                       | 0.230   | 1.7   | 1.1   |
| 12   | C            | 5                          | 0076   | 0176 | 0276 | 0376  | 2076 | 3076 | 4076  | 3.0                    | 60.0   | 75.0    | 3                                       | 0.210   | 1.8   | 1.3   |
| 12   | C            | 10                         | 0077   | 0177 | 0277 | 0377  | 2077 | 3077 | 4077  | 3.0                    | 60.0   | 75.0    | 3                                       | 0.210   | 1.8   | 1.3   |
| 15   | C            | 5                          | 0078   | 0178 | 0278 | 0378  | 2078 | 3078 | 4078  | 4.0                    | 80.0   | 100     | 3                                       | 0.190   | 1.9   | 1.4   |
| 15   | C            | 10                         | 0079   | 0179 | 0279 | 0379  | 2079 | 3079 | 4079  | 4.0                    | 80.0   | 100     | 3                                       | 0.190   | 1.9   | 1.4   |
| 15   | C            | 20                         | 0080   | 0180 | 0280 | 0380  | 2080 | 3080 | 4080  | 4.0                    | 80.0   | 100     | 3                                       | 0.190   | 1.9   | 1.4   |
| 18   | C            | 5                          | 0081   | 0181 | 0281 | 0381  | 2081 | 3081 | 4081  | 4.5                    | 90.0   | 113     | 4                                       | 0.175   | 2.0   | 1.4   |
| 18   | C            | 10                         | 0082   | 0182 | 0282 | 0382  | 2082 | 3082 | 4082  | 4.5                    | 90.0   | 113     | 4                                       | 0.175   | 2.0   | 1.4   |
| 22   | D            | 5                          | 0083   | 0183 | 0283 | 0383  | 2083 | 3083 | 4083  | 5.5                    | 110    | 138     | 4                                       | 0.160   | 2.3   | 1.7   |
| 22   | D            | 10                         | 0084   | 0184 | 0284 | 0384  | 2084 | 3084 | 4084  | 5.5                    | 110    | 138     | 4                                       | 0.160   | 2.3   | 1.7   |
| 22   | D            | 20                         | 0085   | 0185 | 0285 | 0385  | 2085 | 3085 | 4085  | 5.5                    | 110    | 138     | 4                                       | 0.160   | 2.3   | 1.7   |



| STANDARD PACKAGING QUANTITY |                            |                  |                     |               |         |
|-----------------------------|----------------------------|------------------|---------------------|---------------|---------|
| CASE CODE                   | QUANTITY (pcs/reel)        |                  |                     | BULK QUANTITY |         |
|                             | FULL REEL<br>/TR; /RR; /WR | HALF REEL<br>/HR | PARTIAL REEL<br>/PR | PER TRAY      | PER BOX |
| C                           | 500                        | 250              | 100                 | 20            | 100     |
| D                           | 500                        | 250              | 100                 | 20            | 80      |

| INSIDE TAPE SPACING |           |                              |
|---------------------|-----------|------------------------------|
| PACKAGING OPTION    | CASE CODE | TAPE SPACING                 |
| /TR; /HR; /PR       | C, D      | 2.88 ± 0.02<br>[73.0 ± 0.51] |
| /RR                 | C, D      | 2.47 ± 0.02<br>[62.7 ± 0.51] |
| /WR                 | C, D      | 2.05 ± 0.02<br>[52.1 ± 0.51] |

| PRODUCT INFORMATION  |  |
|--|--|
| Mounting of Through-Hole Components  | <a href="http://www.vishay.com/doc?40108">www.vishay.com/doc?40108</a> |
| Solid Tantalum Capacitors (With MnO <sub>2</sub> Electrolyte) Voltage Derating | <a href="http://www.vishay.com/doc?40246">www.vishay.com/doc?40246</a> |
| SELECTOR GUIDES  |  |
| Selector Guide   | <a href="http://www.vishay.com/doc?49054">www.vishay.com/doc?49054</a> |
| FAQ  |  |
| Frequently Asked Questions   | <a href="http://www.vishay.com/doc?40110">www.vishay.com/doc?40110</a> |



## Disclaimer

ALL PRODUCT, PRODUCT SPECIFICATIONS AND DATA ARE SUBJECT TO CHANGE WITHOUT NOTICE TO IMPROVE RELIABILITY, FUNCTION OR DESIGN OR OTHERWISE.

Vishay Intertechnology, Inc., its affiliates, agents, and employees, and all persons acting on its or their behalf (collectively, "Vishay"), disclaim any and all liability for any errors, inaccuracies or incompleteness contained in any datasheet or in any other disclosure relating to any product.

Vishay makes no warranty, representation or guarantee regarding the suitability of the products for any particular purpose or the continuing production of any product. To the maximum extent permitted by applicable law, Vishay disclaims (i) any and all liability arising out of the application or use of any product, (ii) any and all liability, including without limitation special, consequential or incidental damages, and (iii) any and all implied warranties, including warranties of fitness for particular purpose, non-infringement and merchantability.

Statements regarding the suitability of products for certain types of applications are based on Vishay's knowledge of typical requirements that are often placed on Vishay products in generic applications. Such statements are not binding statements about the suitability of products for a particular application. It is the customer's responsibility to validate that a particular product with the properties described in the product specification is suitable for use in a particular application. Parameters provided in datasheets and / or specifications may vary in different applications and performance may vary over time. All operating parameters, including typical parameters, must be validated for each customer application by the customer's technical experts. Product specifications do not expand or otherwise modify Vishay's terms and conditions of purchase, including but not limited to the warranty expressed therein.

Hyperlinks included in this datasheet may direct users to third-party websites. These links are provided as a convenience and for informational purposes only. Inclusion of these hyperlinks does not constitute an endorsement or an approval by Vishay of any of the products, services or opinions of the corporation, organization or individual associated with the third-party website. Vishay disclaims any and all liability and bears no responsibility for the accuracy, legality or content of the third-party website or for that of subsequent links.

Vishay products are not designed for use in life-saving or life-sustaining applications or any application in which the failure of the Vishay product could result in personal injury or death unless specifically qualified in writing by Vishay. Customers using or selling Vishay products not expressly indicated for use in such applications do so at their own risk. Please contact authorized Vishay personnel to obtain written terms and conditions regarding products designed for such applications.

No license, express or implied, by estoppel or otherwise, to any intellectual property rights is granted by this document or by any conduct of Vishay. Product names and markings noted herein may be trademarks of their respective owners.

## Looking for pricing, stock, or lifecycle information?

Click below to explore more details on WIN SOURCE:

 [View M39003/09-3009](#) on WIN SOURCE

 [Vishay](#) Information

## Optimize Your Supply Chain with WIN SOURCE Solutions

-  Global Sourcing Solution
-  Obsolete Management
-  Cost Control Management
-  Shortage Management
-  Alternative Solution
-  Excess Inventory Management