



**THE DATASHEET OF  
RJS AE508002**



*Now you're connected!*

### About Amphenol Commercial Products

Amphenol's commercial connector products are used in a variety of end user applications including networking, telecom, server & computer, storage & HDD, consumer electronics and entertainment, professional audio & Industrial & Military/Aerospace.

### Related Products

#### RJSSE

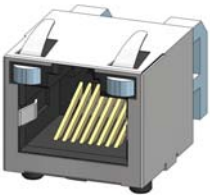

P/N RJSSE-5381 SHOWN  
SINGLE PORT, 8 POSITION,  
WITH SHIELD AND LIGHT PIPE

#### RJHSE



P/N RJHSE-3081 SHOWN  
SINGLE PORT VERTICAL MOUNT,  
NO SHIELD, WITH LEDs

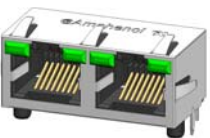

P/N RJHSE-5385-02 SHOWN  
TWO PORT REGULAR MOUNT,  
WITH SHIELD AND LEDs

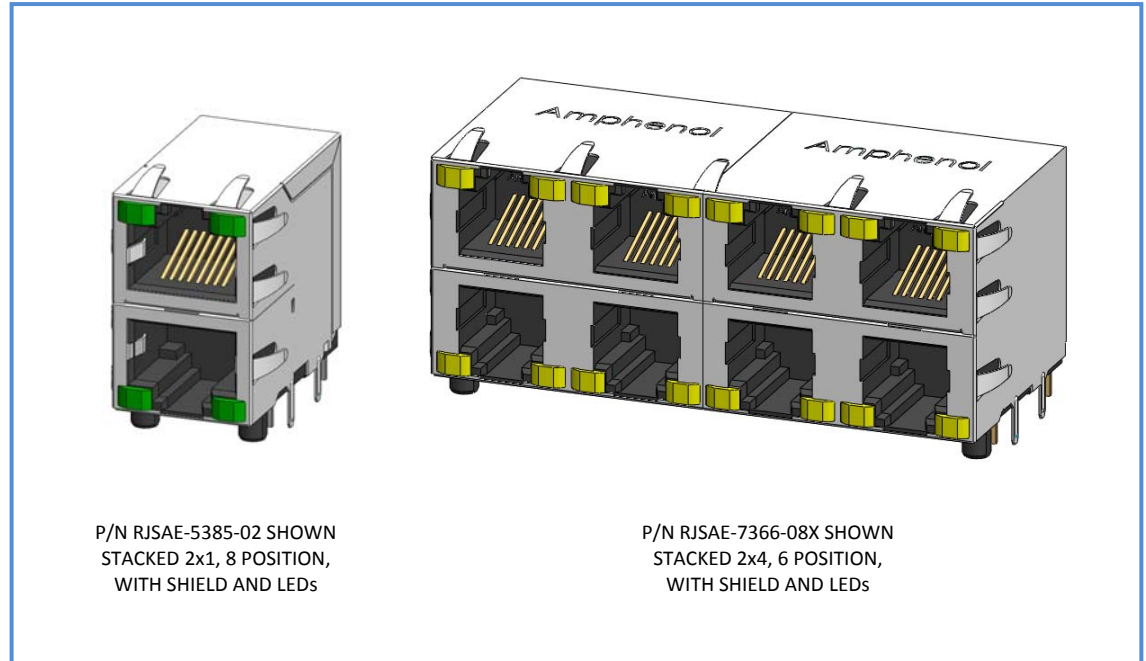

P/N RJSAE-5385-02 SHOWN  
STACKED 2x1, 8 POSITION,  
WITH SHIELD AND LEDs

P/N RJSAE-7366-08X SHOWN  
STACKED 2x4, 6 POSITION,  
WITH SHIELD AND LEDs

### Overview

This product specification defines the general use and performance parameters for Amphenol's RJSAE series of stackable modular jacks.

Availability: 2x1, 2x2 and 2x4 ports available with a wide variety of LED and shielding options.

### Usage

The RJSAE stackable modular jacks supports Ethernet Protocols. Shielding available with and without a Ferrite filter for increased EMI performance and LEDs for Link Activity and Network Speed verification.

### Applications

Intended for use in applications such as:

#### Networking & Telecom

- Wireless (WiMAX)
- Network servers
- Hubs, routers, switches

#### Office & Home Equipment

- PC's, Laptops, Copiers/Printers
- Telephones, modems
- Surge Protectors
- ATMs, Vending Machines

#### Consumer Goods

- Security Systems
- Set Top Boxes
- Video Game Systems

#### Miscellaneous

- Multi-Media Equipment
- Industrial Equipment
- POS Terminals

# Now you're connected!

## About Amphenol Commercial Products

Amphenol's commercial connector products are used in a variety of end user applications including networking, telecom, server & computer, storage & HDD, consumer electronics and entertainment, professional audio & Industrial & Military/Aerospace.

## Related Products

### RJULE

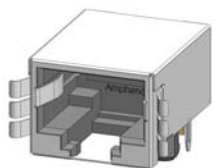

P/N RJULE-4X182-01 SHOWN  
SINGLE PORT REGULAR MOUNT,  
STANDARD SHIELD WITH SMT

### FRJAE



P/N FRJAE-418 SHOWN  
SINGLE PORT, 8 POSITION,  
WITH FERRITE FILTER AND  
SHIELD (FRONT TABS)

### RJLSE

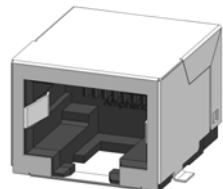

P/N RJLSE-41181-01 SHOWN  
SINGLE PORT REGULAR MOUNT,  
STANDARD SHIELD WITH SMT

## Electrical Characteristics

Contact resistance:	20 mΩ max.
Insulation resistance:	500 MΩ minimum at 500V DC for 2 minutes max.
Current rating:	1.5 Amps
Voltage rating:	125 Volts AC
DWV	1000 VAC, 60 Hz. 1 min.
LED forward DC current:	20mA typical
LED forward Voltage:	1.9 Volts max. @ 2mA (for single colors) 2.6 Volts max. @ 20mA (for Bi-colors)
LED reverse voltage:	5 Volts minimum
LED light intensity:	0.4 to 1.5 mcd @ 2mA (for single colors) 0.5 mcd min. @ 2mA (for Bi-colors)
LED wave length:	Yellow: 587± 7 nm measured @ 20mA Green: 565± 6 nm measured @ 20mA Red: 625± 5 nm measured @ 20mA

## Mechanical Characteristics

Mating connector insertion force: 5.0 lbs. Maximum.  
Mating connector pull retention force: 20 lbs Minimum.  
Durability: 750 mating & unmating cycles  
Recommended soldering temperature: Wave soldering peaked at 260° C for 5 seconds maximum.  
Connectors without LED's are suitable for IR Reflow

Operating temperature: -55° C to +85° C

## Material Requirements

RJSAE connectors are RoHS compliant.  
Unless otherwise specified, the materials for each component shall be:

### Insulator:

- High Temp thermoplastic. Complies with UL 94V-0, Black color

### Contacts:

- Phosphor Bronze hard temper with gold thickness options (6μ", 15μ", 30μ", 50μ") over 50μ" minimum Nickel on contact mating area.
- 100μ" minimum matte tin plating on soldering tail

### Shield:

- Copper alloy; Nickel plated with pure tin dipped tail

### LED:

- Pure Tin plating on LED tail

## Available Documents

### Drawing Numbers:

P-RJSAE-508X-A4X	2x2 Stackable Modular Jack, 8 Position, Unshielded with LED options
P-RJSAE-528X-02X	2x1 Stackable Modular Jack, Filtered, 8 Position, Shielded with LED options
P-RJSAE-706X-A8X	2x4 Stackable Modular Jack, 6 Position, Unshielded with LED options
P-RJSAE-J38X-0D	2x8 Stackable Modular Jack, 8 Position, Shielded with LEDs

Contact factory or Authorized Amphenol representative for additional configurations

## Looking for pricing, stock, or lifecycle information?

Click below to explore more details on WIN SOURCE:

 [View RJSAE508002](#) on WIN SOURCE

 [Amphenol](#) Information

## Optimize Your Supply Chain with WIN SOURCE Solutions

-  Global Sourcing Solution
-  Obsolete Management
-  Cost Control Management
-  Shortage Management
-  Alternative Solution
-  Excess Inventory Management