



THE DATASHEET OF
S558-10GB-23



THE INFORMATION CONTAINED HEREIN IS CONSIDERED "PROPRIETARY" TO BEL FUSE INC. AND SHALL NOT BE COPIED, REPRODUCED OR DISCLOSED WITHOUT THE WRITTEN APPROVAL OF BEL FUSE INC.

ELECTRICAL SPECIFICATION @25°C

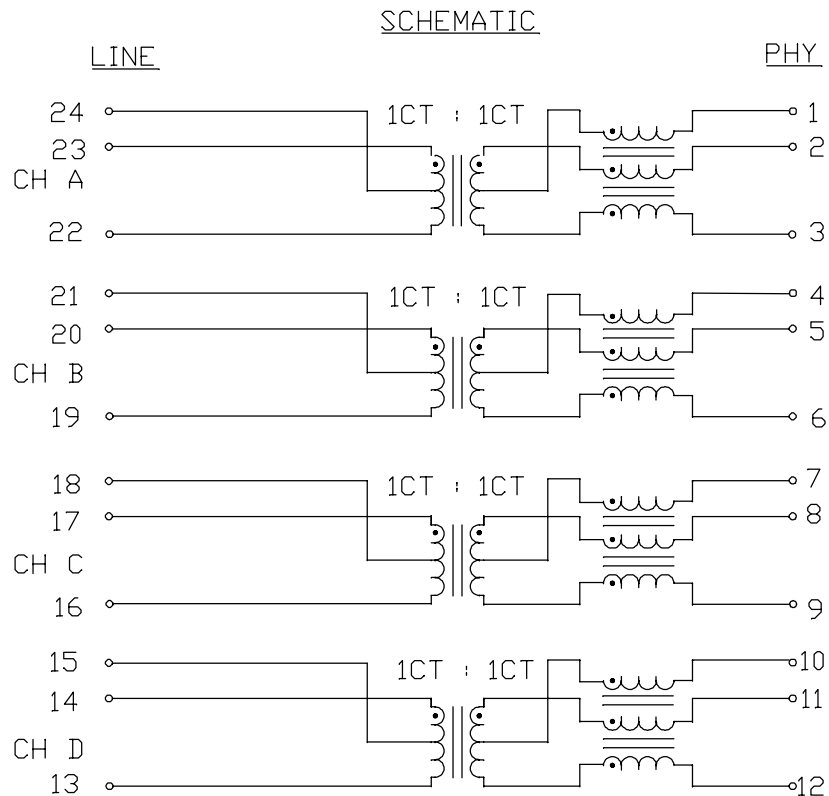

URNS RATIO

(2-1-3) : (23-24-22)
 (5-4-6) : (20-21-19)
 (8-7-9) : (17-18-16)
 (11-10-12) : (14-15-13)

1CT : 1CT
 1CT : 1CT
 1CT : 1CT
 1CT : 1CT

POLARITY

PER DOT CONVENTION

□CL

@100kHz, 100mV, 23mA DC BIAS
 @100kHz, 100mV, 8mA DC BIAS

120uH MIN
 180uH MIN

HIPOT

LEAKAGE CURRENT LESS THAN 1mA AT 2250VDC

INSERTION LOSS

FREQ(MHz)	1	2-300	400	500
MAX (dB)	0.3	1.0	1.5	2.0

RETURN LOSS

(100 OHM LINESIDE LOAD)

FREQ(MHz)	1	2-100	200	500	600
MIN (dB)	18	20	15	12	9

COMM. TO DIFF. MODE REJECTION

FREQ(MHz)	50	100	200	300	400	500
MAX (dB)	48	42	36	33	30	28

DIFF. TO COMM. MODE REJECTION

FREQ(MHz)	50	100	200	300	400	500
MAX (dB)	30	27	24	22	21	20

BALANCED DC LINE CURRENT: 1A MAXIMUM CONTINUOUS @57VDC

DESIGNED FOR EXTENDED TEMPERATURE 10G 100W 802.3BT APPLICATIONS
 OPERATING TEMPERATURE : -40 TO 85°C

ORIGINATED BY	DATE
ZJ CHEN	2023-12-05
DRAWN BY	DATE
JL WU	2023-12-05

TITLE
ELECTRICAL SPECIFICATION

PART NO. / DRAWING NO.
S558-10GB-23
FILE NAME
S55810GB23B.DWG

STANDARD DIM.	[] METRIC DIM. AS REF.
TOL. IN INCH	UNIT : INCH [mm]
.X	SCALE : N/A
.XX	SIZE : A4
.XXX	

REV. : B	PAGE : 2
----------	----------

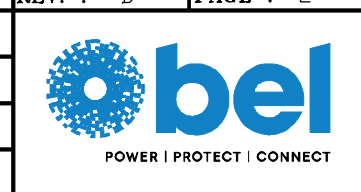

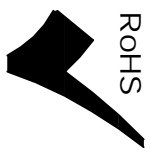

SUGGESTED PCB PAD LAYOUT

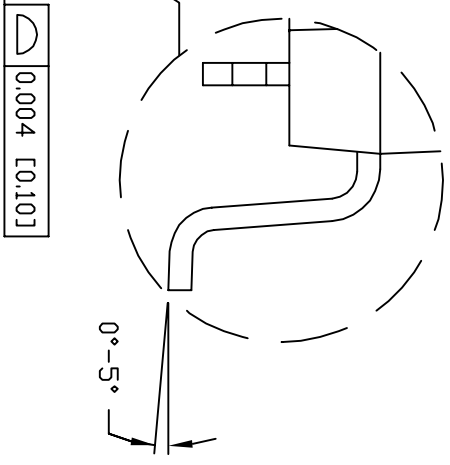
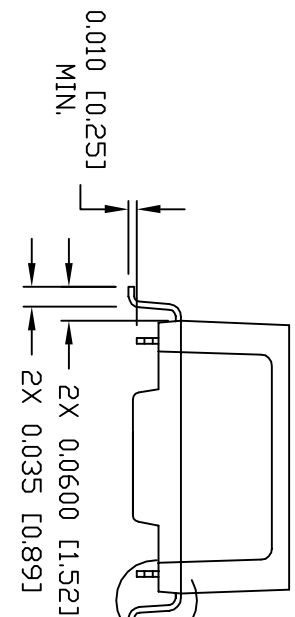
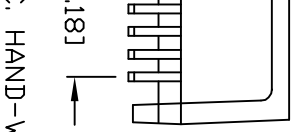
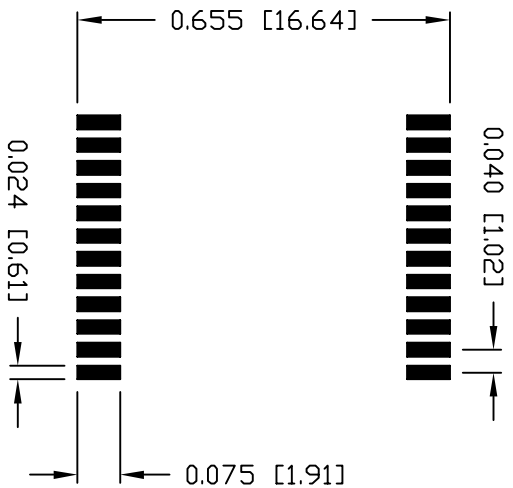
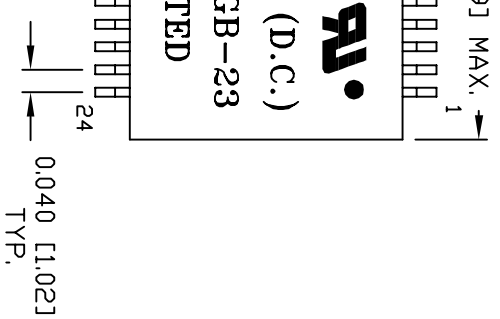

HAND-WORK-04.

PART NO. / DRAWING NO.
 S558-10GB-23
 FILE NAME
 S55810GB23A.DWG

STANDARD DIM. [] METRIC DIM. AS REF.	TOL. IN INCH		UNIT : INCH [mm]	SCALE : N/A	SIZE : A4
	.X	±0.01			
	.XX	±0.01			
	.XXX	±0.005			

REV. : A PAGE : 3

AL SPECIFICATION

Looking for pricing, stock, or lifecycle information?

Click below to explore more details on WIN SOURCE:

 [View S558-10GB-23 on WIN SOURCE](#)

 [Bel Fuse Inc. Information](#)

Optimize Your Supply Chain with WIN SOURCE Solutions

-  Global Sourcing Solution
-  Obsolete Management
-  Cost Control Management
-  Shortage Management
-  Alternative Solution
-  Excess Inventory Management