



**THE DATASHEET OF  
SWPA6028S120MT**



# 绕线贴片功率电感—SWPA 系列

## Wire Wound SMD Power Inductors – SWPA Series

Operating temperature range: -40°C~+125°C (Including self-heating)



### 特征

- 磁性胶水涂敷结构极大减少了蜂鸣声
- 在磁芯上金属化电极，抗跌落冲击强，经久耐用
- 闭合磁路结构设计，漏磁少，抗 EMI 能力强
- 电流特性较同等尺寸传统电感高出 30%以上
- 省空间，更省电

### FEATURES

- Magnetic-resin shielded construction reduces buzz noise to ultra-low levels
- Metallization on ferrite core results in excellent shock resistance and damage-free durability
- Closed magnetic circuit design reduces leakage flux and Electro Magnetic Interference (EMI)
- 30% higher current rating than conventional inductors of equal size
- Takes up less PCB real estate and save more

### 用途

- 智能手机、智能电视、机顶盒、笔记本电脑
- 车载导航影音、通讯设备
- 虚拟现实、增强现实
- LED 照明

### APPLICATIONS

- Smart phone, smart TV, set top box, notebook
- Car navigation systems, telecomm base stations
- VR, AR
- LED lighting

### 产品型号

**SWPA**      **3012**      **S**      **1R0**  
 ①                      ②                      ③                      ④

|           |   |
|-----------|---|
| ① 分类 Type |   |
| SWPA      | 绕线贴片功率电感<br>Wire Wound SMD Power Inductor |

|                     |              |
|---------------------|--------------|
| ③ 特性类型 Feature Type |              |
| S                   | 标准型 Standard |

|                            |               |
|----------------------------|---------------|
| ④ 公称电感量 Nominal Inductance |               |
| Example                    | Nominal Value |
| 1R0                        | 1.0μH         |
| 100                        | 10μH          |

|                             |      |
|-----------------------------|------|
| ⑤ 感量精度 Inductance Tolerance |      |
| K                           | ±10% |
| M                           | ±20% |
| N                           | ±30% |

|              |                      |
|--------------|----------------------|
| ⑥ 包装 Packing |                      |
| T            | Tape Carrier Package |

|                    |                           |
|--------------------|---------------------------|
| ⑦ 设计代号 Design Code |                           |
| □□□                | Standard product is blank |

### PRODUCT IDENTIFICATION

**N**      **T**      □□□  
 ⑤                      ⑥                      ⑦

|  |             |
|--|-------------|
| ② 外形尺寸尺寸(L×W×H) [mm]<br>External Dimensions (L×W×H) [mm] |             |
| 252010   | 2.5×2.0×1.0 |
| 252012   | 2.5×2.0×1.2 |
| 3010   | 3.0×3.0×1.0 |
| 3012   | 3.0×3.0×1.2 |
| 3015   | 3.0×3.0×1.5 |
| 4010   | 4.0×4.0×1.0 |
| 4012   | 4.0×4.0×1.2 |
| 4018   | 4.0×4.0×1.8 |
| 4020   | 4.0×4.0×2.0 |
| 4030   | 4.0×4.0×3.0 |
| 5012   | 5.0×5.0×1.2 |
| 5020   | 5.0×5.0×2.0 |
| 5040   | 5.0×5.0×4.0 |
| 5045   | 5.0×5.0×4.5 |
| 6020   | 6.0×6.0×2.0 |
| 6028   | 6.0×6.0×2.8 |
| 6045   | 6.0×6.0×4.5 |
| 8040   | 8.0×8.0×4.0 |
| 8060   | 8.0×8.0×6.0 |
| 8065   | 8.0×8.0×6.5 |

# 外观尺寸

# SHAPE AND DIMENSIONS

Fig.1



Fig.2



Fig.3

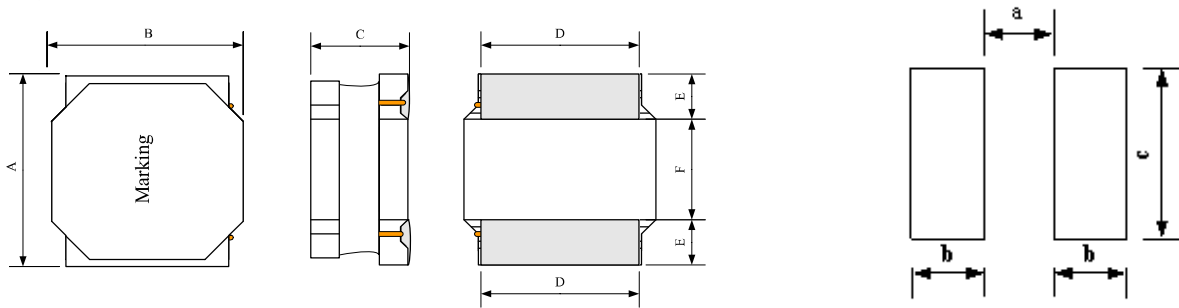

Recommended Land Pattern

Unit: mm

| Series      | Shape | A       | B       | C        | D       | E        | F        | a Typ. | b Typ. | c Typ. |
|-------------|-------|---------|---------|----------|---------|----------|----------|--------|--------|--------|
| SWPA252010S | Fig.1 | 2.5±0.1 | 2.0±0.1 | 1.0 Max. | 2.0±0.2 | 0.80±0.2 | 0.80±0.2 | 0.80   | 0.85   | 2.0    |
| SWPA252012S | Fig.1 | 2.5±0.1 | 2.0±0.1 | 1.2 Max. | 2.0±0.2 | 0.80±0.2 | 0.80±0.2 | 0.80   | 0.85   | 2.0    |
| SWPA3010S   | Fig.2 | 3.0±0.2 | 3.0±0.2 | 1.0 Max. | 2.5±0.2 | 0.75±0.2 | 1.5±0.2  | 1.5    | 0.8    | 2.7    |
| SWPA3012S   | Fig.2 | 3.0±0.2 | 3.0±0.2 | 1.2 Max. | 2.5±0.2 | 0.75±0.2 | 1.5±0.2  | 1.5    | 0.8    | 2.7    |
| SWPA3015S   | Fig.2 | 3.0±0.2 | 3.0±0.2 | 1.5 Max. | 2.5±0.2 | 0.75±0.2 | 1.5±0.2  | 1.5    | 0.8    | 2.7    |
| SWPA4010S   | Fig.2 | 4.0±0.2 | 4.0±0.2 | 1.0 Max. | 3.3±0.2 | 0.95±0.2 | 2.1±0.2  | 1.9    | 1.1    | 3.7    |
| SWPA4012S   | Fig.2 | 4.0±0.2 | 4.0±0.2 | 1.2 Max. | 3.3±0.2 | 0.95±0.2 | 2.1±0.2  | 1.9    | 1.1    | 3.7    |
| SWPA4018S   | Fig.2 | 4.0±0.2 | 4.0±0.2 | 1.8 Max. | 3.3±0.2 | 0.95±0.2 | 2.1±0.2  | 1.9    | 1.1    | 3.7    |
| SWPA4020S   | Fig.2 | 4.0±0.2 | 4.0±0.2 | 2.0 Max. | 3.3±0.2 | 0.95±0.2 | 2.1±0.2  | 1.9    | 1.1    | 3.7    |
| SWPA4030S   | Fig.2 | 4.0±0.2 | 4.0±0.2 | 3.0 Max. | 3.3±0.2 | 0.95±0.2 | 2.1±0.2  | 1.9    | 1.1    | 3.7    |
| SWPA5012S   | Fig.3 | 5.0±0.2 | 5.0±0.2 | 1.2 Max. | 4.0±0.2 | 1.25±0.2 | 2.5±0.2  | 2.3    | 1.4    | 4.2    |
| SWPA5020S   | Fig.3 | 5.0±0.2 | 5.0±0.2 | 2.0 Max. | 4.0±0.2 | 1.25±0.2 | 2.5±0.2  | 2.3    | 1.4    | 4.2    |
| SWPA5040S   | Fig.3 | 5.0±0.2 | 5.0±0.2 | 4.0 Max. | 4.0±0.2 | 1.25±0.2 | 2.5±0.2  | 2.3    | 1.4    | 4.2    |
| SWPA5045S   | Fig.3 | 5.0±0.2 | 5.0±0.2 | 4.5 Max. | 4.0±0.2 | 1.30±0.2 | 2.5±0.2  | 2.3    | 1.4    | 4.2    |
| SWPA6020S   | Fig.2 | 6.0±0.3 | 6.0±0.3 | 2.0 Max. | 4.9±0.3 | 1.55±0.3 | 2.9±0.3  | 2.8    | 1.7    | 5.7    |
| SWPA6028S   | Fig.2 | 6.0±0.3 | 6.0±0.3 | 2.8 Max. | 4.9±0.3 | 1.55±0.3 | 2.9±0.3  | 2.8    | 1.7    | 5.7    |
| SWPA6045S   | Fig.2 | 6.0±0.3 | 6.0±0.3 | 4.5 Max. | 4.9±0.3 | 1.55±0.3 | 2.9±0.3  | 2.8    | 1.7    | 5.7    |
| SWPA8040S   | Fig.2 | 8.0±0.3 | 8.0±0.3 | 4.2 Max. | 6.3±0.3 | 2.00±0.3 | 4.0±0.3  | 3.8    | 2.2    | 7.5    |
| SWPA8060S   | Fig.2 | 8.0±0.3 | 8.0±0.3 | 6.0 Max. | 6.3±0.3 | 2.00±0.3 | 4.0±0.3  | 3.8    | 2.2    | 7.5    |
| SWPA8065S   | Fig.3 | 8.0±0.3 | 8.0±0.3 | 6.5 Max. | 6.3±0.3 | 2.00±0.3 | 4.0±0.3  | 3.8    | 2.2    | 7.5    |

※\*1: All products are printed with Marking except the 252010S, 252012S, 3010S, 3012S and 3015S series.

## 规格特性

## SPECIFICATIONS

## SWPA252010S Series

| Part Number<br>型号 | Inductance<br>电感量 | DC Resistance<br>直流电阻 |       | Self-resonant<br>Frequency<br>自谐频率 | Saturation Current<br>饱和电流 <sup>*3</sup> |      | Heat Rating<br>Current<br>温升电流 <sup>*4</sup> |      |
|-------------------|-------------------|-----------------------|-------|------------------------------------|--|------|--|------|
|                   |                   | Max.                  | Typ.  |                                    | Max.                                     | Typ. | Max.   | Typ. |
| Units 单位          | @100kHz, 1V<br>µH | Ω                     |       | Min.<br>MHz                        | A  |      | A  |      |
| Symbol 符号         | L                 | DCR                   |       | S.R.F                              | Isat                                     |      | Irms   |      |
| SWPA252010SR47NT  | 0.47±30%          | 0.056                 | 0.047 | 206                                | 2.50                                     | 3.35 | 2.35   | 2.56 |
| SWPA252010SR56NT  | 0.56±30%          | 0.072                 | 0.060 | 160                                | 2.90                                     | 3.20 | 2.00   | 2.18 |
| SWPA252010SR68NT  | 0.68±30%          | 0.074                 | 0.062 | 129                                | 2.20                                     | 2.75 | 2.00   | 2.18 |
| SWPA252010S1R0NT  | 1.0±30%           | 0.108                 | 0.090 | 100                                | 1.85                                     | 2.20 | 1.65   | 1.80 |
| SWPA252010S1R5NT  | 1.5±30%           | 0.182                 | 0.152 | 81                                 | 1.80                                     | 2.10 | 1.30   | 1.42 |
| SWPA252010S2R2NT  | 2.2±30%           | 0.209                 | 0.174 | 61                                 | 1.20                                     | 1.60 | 1.20   | 1.31 |
| SWPA252010S3R3MT  | 3.3±20%           | 0.328                 | 0.273 | 47                                 | 1.05                                     | 1.30 | 0.90   | 0.98 |
| SWPA252010S4R7MT  | 4.7±20%           | 0.563                 | 0.469 | 42                                 | 0.95                                     | 1.15 | 0.70   | 0.76 |
| SWPA252010S5R6MT  | 5.6±20%           | 0.563                 | 0.469 | 35                                 | 0.80                                     | 0.95 | 0.73   | 0.80 |
| SWPA252010S6R8MT  | 6.8±20%           | 0.896                 | 0.747 | 31                                 | 0.78                                     | 0.92 | 0.59   | 0.64 |
| SWPA252010S100MT  | 10±20%            | 1.092                 | 0.910 | 27                                 | 0.65                                     | 0.78 | 0.50   | 0.55 |

## SWPA252012S Series

| Part Number<br>型号 | Inductance<br>电感量 | DC Resistance<br>直流电阻 |       | Self-resonant<br>Frequency<br>自谐频率 | Saturation Current<br>饱和电流 <sup>*3</sup> |      | Heat Rating<br>Current<br>温升电流 <sup>*4</sup> |      |
|-------------------|-------------------|-----------------------|-------|------------------------------------|--|------|--|------|
|                   |                   | Max.                  | Typ.  |                                    | Max.                                     | Typ. | Max.   | Typ. |
| Units 单位          | @100kHz, 1V<br>µH | Ω                     |       | Min.<br>MHz                        | A  |      | A  |      |
| Symbol 符号         | L                 | DCR                   |       | S.R.F                              | Isat                                     |      | Irms   |      |
| SWPA252012SR47NT  | 0.47±30%          | 0.061                 | 0.047 | 160                                | 3.82                                     | 4.27 | 2.15   | 2.34 |
| SWPA252012SR68NT  | 0.68±30%          | 0.074                 | 0.057 | 140                                | 3.28                                     | 3.68 | 1.95   | 2.13 |
| SWPA252012S1R0NT  | 1.0±30%           | 0.090                 | 0.069 | 110                                | 2.59                                     | 2.90 | 1.93   | 2.10 |
| SWPA252012S1R2NT  | 1.2±30%           | 0.129                 | 0.099 | 100                                | 2.38                                     | 2.67 | 1.46   | 1.59 |
| SWPA252012S1R5MT  | 1.5±20%           | 0.147                 | 0.113 | 97                                 | 2.24                                     | 2.51 | 1.40   | 1.53 |
| SWPA252012S2R2MT  | 2.2±20%           | 0.216                 | 0.166 | 69                                 | 1.85                                     | 2.07 | 1.15   | 1.25 |
| SWPA252012S2R7MT  | 2.7±20%           | 0.239                 | 0.184 | 63                                 | 1.72                                     | 1.92 | 1.09   | 1.19 |
| SWPA252012S3R3MT  | 3.3±20%           | 0.264                 | 0.203 | 62                                 | 1.61                                     | 1.80 | 1.04   | 1.13 |
| SWPA252012S3R6MT  | 3.6±20%           | 0.348                 | 0.268 | 53                                 | 1.46                                     | 1.64 | 0.90   | 0.98 |
| SWPA252012S4R3MT  | 4.3±20%           | 0.377                 | 0.290 | 51                                 | 1.37                                     | 1.53 | 0.87   | 0.95 |
| SWPA252012S4R7MT  | 4.7±20%           | 0.377                 | 0.290 | 47                                 | 1.12                                     | 1.25 | 0.84   | 0.92 |
| SWPA252012S5R1MT  | 5.1±20%           | 0.500                 | 0.385 | 44                                 | 1.23                                     | 1.37 | 0.75   | 0.82 |
| SWPA252012S5R6MT  | 5.6±20%           | 0.538                 | 0.414 | 38                                 | 1.11                                     | 1.25 | 0.73   | 0.80 |
| SWPA252012S6R2MT  | 6.2±20%           | 0.542                 | 0.417 | 38                                 | 1.03                                     | 1.16 | 0.73   | 0.80 |
| SWPA252012S6R8MT  | 6.8±20%           | 0.581                 | 0.447 | 38                                 | 0.98                                     | 1.09 | 0.69   | 0.75 |
| SWPA252012S7R5MT  | 7.5±20%           | 0.611                 | 0.470 | 35                                 | 0.97                                     | 1.09 | 0.68   | 0.74 |
| SWPA252012S8R2MT  | 8.2±20%           | 0.658                 | 0.506 | 36                                 | 0.98                                     | 1.10 | 0.65   | 0.71 |
| SWPA252012S9R1MT  | 9.1±20%           | 0.690                 | 0.531 | 34                                 | 0.91                                     | 1.02 | 0.62   | 0.68 |
| SWPA252012S100MT  | 10±20%            | 0.690                 | 0.531 | 34                                 | 0.79                                     | 0.88 | 0.62   | 0.68 |
| SWPA252012S120MT  | 12±20%            | 1.075                 | 0.827 | 28                                 | 0.78                                     | 0.88 | 0.51   | 0.56 |
| SWPA252012S150MT  | 15±20%            | 1.591                 | 1.224 | 25                                 | 0.68                                     | 0.77 | 0.42   | 0.46 |
| SWPA252012S220MT  | 22±20%            | 1.976                 | 1.520 | 20                                 | 0.53                                     | 0.59 | 0.38   | 0.41 |

## 规格特性

## SPECIFICATIONS

## SWPA3010S Series

| Part Number<br>型号 | Inductance<br>电感量<br>@100kHz,1V | DC Resistance<br>直流电阻 |       | Self-resonant<br>Frequency<br>自谐频率 | Saturation Current<br>饱和电流 <sup>*3</sup> |      | Heat Rating<br>Current<br>温升电流 <sup>*4</sup> |      |
|-------------------|---------------------------------|-----------------------|-------|------------------------------------|--|------|--|------|
|                   |                                 | Max.                  | Typ.  |                                    | Min.                                     | Max. | Typ.   | Max. |
| Units 单位          | μH                              | Ω                     |       | MHz                                | A  |      | A  |      |
| Symbol 符号         | L                               | DCR                   |       | S.R.F                              | Isat                                     |      | Irms   |      |
| SWPA3010S1R0NT    | 1.0±30%                         | 0.085                 | 0.065 | 180                                | 1.40                                     | 2.10 | 1.45   | 1.80 |
| SWPA3010S1R2NT    | 1.2±30%                         | 0.085                 | 0.065 | 137                                | 1.25                                     | 1.70 | 1.45   | 1.80 |
| SWPA3010S1R5NT    | 1.5±30%                         | 0.104                 | 0.080 | 120                                | 1.27                                     | 1.70 | 1.30   | 1.60 |
| SWPA3010S2R2NT    | 2.2±30%                         | 0.143                 | 0.110 | 100                                | 1.15                                     | 1.50 | 1.09   | 1.40 |
| SWPA3010S2R7MT    | 2.7±20%                         | 0.169                 | 0.130 | 90                                 | 1.00                                     | 1.20 | 1.02   | 1.40 |
| SWPA3010S3R3NT    | 3.3±30%                         | 0.189                 | 0.145 | 74                                 | 0.97                                     | 1.20 | 0.96   | 1.20 |
| SWPA3010S3R6MT    | 3.6±20%                         | 0.215                 | 0.165 | 67                                 | 0.95                                     | 1.20 | 0.90   | 1.10 |
| SWPA3010S4R7MT    | 4.7±20%                         | 0.293                 | 0.225 | 59                                 | 0.75                                     | 1.05 | 0.77   | 1.10 |
| SWPA3010S5R6MT    | 5.6±20%                         | 0.322                 | 0.248 | 40                                 | 0.58                                     | 0.65 | 0.70   | 1.05 |
| SWPA3010S6R8MT    | 6.8±20%                         | 0.397                 | 0.305 | 42                                 | 0.55                                     | 0.72 | 0.66   | 0.96 |
| SWPA3010S8R2MT    | 8.2±20%                         | 0.520                 | 0.40  | 23                                 | 0.55                                     | 0.70 | 0.58   | 0.70 |
| SWPA3010S100MT    | 10±20%                          | 0.520                 | 0.40  | 39                                 | 0.55                                     | 0.75 | 0.58   | 0.70 |
| SWPA3010S120MT    | 12±20%                          | 0.657                 | 0.505 | 36                                 | 0.43                                     | 0.65 | 0.52   | 0.67 |
| SWPA3010S150MT    | 15±20%                          | 0.793                 | 0.610 | 30                                 | 0.42                                     | 0.57 | 0.47   | 0.57 |
| SWPA3010S220MT    | 22±20%                          | 1.209                 | 0.930 | 28                                 | 0.35                                     | 0.48 | 0.38   | 0.52 |
| SWPA3010S270MT    | 27±20%                          | 1.404                 | 1.080 | 25                                 | 0.30                                     | 0.45 | 0.35   | 0.50 |
| SWPA3010S330MT    | 33±20%                          | 2.015                 | 1.550 | 18                                 | 0.29                                     | 0.42 | 0.30   | 0.55 |
| SWPA3010S390MT    | 39±20%                          | 2.275                 | 1.750 | 18                                 | 0.28                                     | 0.38 | 0.28   | 0.53 |
| SWPA3010S430MT    | 43±20%                          | 2.340                 | 1.80  | 18                                 | 0.23                                     | 0.36 | 0.27   | 0.52 |
| SWPA3010S470MT    | 47±20%                          | 2.535                 | 1.950 | 18                                 | 0.22                                     | 0.35 | 0.26   | 0.52 |
| SWPA3010S510MT    | 51±20%                          | 2.860                 | 2.20  | 18                                 | 0.21                                     | 0.33 | 0.25   | 0.48 |
| SWPA3010S560MT    | 56±20%                          | 3.016                 | 2.320 | 16                                 | 0.21                                     | 0.28 | 0.24   | 0.35 |

## SWPA3012S Series

| Part Number<br>型号 | Inductance<br>电感量<br>@100kHz,1V | DC Resistance<br>直流电阻 |       | Self-resonant<br>Frequency<br>自谐频率 | Saturation Current<br>饱和电流 <sup>*3</sup> |      | Heat Rating<br>Current<br>温升电流 <sup>*4</sup> |      |
|-------------------|---------------------------------|-----------------------|-------|------------------------------------|--|------|--|------|
|                   |                                 | Max.                  | Typ.  |                                    | Min.                                     | Max. | Typ.   | Max. |
| Units 单位          | μH                              | Ω                     |       | MHz                                | A  |      | A  |      |
| Symbol 符号         | L                               | DCR                   |       | S.R.F                              | Isat                                     |      | Irms   |      |
| SWPA3012SR22NT    | 0.22±30%                        | 0.022                 | 0.017 | 321                                | 5.30                                     | 6.00 | 3.00   | 3.30 |
| SWPA3012SR82NT    | 0.82±30%                        | 0.039                 | 0.030 | 180                                | 2.05                                     | 2.80 | 2.47   | 3.00 |
| SWPA3012S1R0NT    | 1.0±30%                         | 0.052                 | 0.040 | 120                                | 1.87                                     | 2.80 | 2.20   | 2.70 |
| SWPA3012S1R2NT    | 1.2±30%                         | 0.059                 | 0.045 | 120                                | 2.22                                     | 2.50 | 2.01   | 2.20 |
| SWPA3012S1R5NT    | 1.5±30%                         | 0.059                 | 0.045 | 110                                | 1.62                                     | 1.90 | 2.01   | 2.20 |
| SWPA3012S1R8NT    | 1.8±30%                         | 0.082                 | 0.063 | 90                                 | 1.30                                     | 1.90 | 1.65   | 1.80 |
| SWPA3012S2R2NT    | 2.2±30%                         | 0.098                 | 0.075 | 84                                 | 1.20                                     | 1.90 | 1.55   | 1.70 |
| SWPA3012S2R4NT    | 2.4±30%                         | 0.088                 | 0.068 | 100                                | 1.15                                     | 1.50 | 1.60   | 1.70 |
| SWPA3012S2R7NT    | 2.7±30%                         | 0.110                 | 0.085 | 65                                 | 1.14                                     | 1.50 | 1.48   | 1.50 |
| SWPA3012S3R3MT    | 3.3±20%                         | 0.130                 | 0.10  | 64                                 | 1.05                                     | 1.50 | 1.36   | 1.40 |
| SWPA3012S3R6MT    | 3.6±20%                         | 0.130                 | 0.10  | 36                                 | 1.05                                     | 1.50 | 1.36   | 1.40 |
| SWPA3012S3R9MT    | 3.9±20%                         | 0.189                 | 0.145 | 61                                 | 1.00                                     | 1.30 | 1.24   | 1.30 |
| SWPA3012S4R7MT    | 4.7±20%                         | 0.156                 | 0.120 | 61                                 | 0.90                                     | 1.00 | 1.24   | 1.30 |
| SWPA3012S6R8MT    | 6.8±20%                         | 0.247                 | 0.190 | 61                                 | 0.75                                     | 0.90 | 0.98   | 1.10 |
| SWPA3012S100MT    | 10±20%                          | 0.345                 | 0.265 | 42                                 | 0.60                                     | 0.88 | 0.83   | 0.90 |
| SWPA3012S120MT    | 12±20%                          | 0.449                 | 0.345 | 32                                 | 0.48                                     | 0.67 | 0.73   | 0.84 |
| SWPA3012S150MT    | 15±20%                          | 0.468                 | 0.360 | 27                                 | 0.45                                     | 0.62 | 0.71   | 0.77 |
| SWPA3012S180MT    | 18±20%                          | 0.709                 | 0.545 | 25                                 | 0.43                                     | 0.59 | 0.58   | 0.65 |
| SWPA3012S220MT    | 22±20%                          | 0.839                 | 0.645 | 23                                 | 0.42                                     | 0.52 | 0.53   | 0.59 |

## 规格特性

## SPECIFICATIONS

## SWPA3012S Series

| Part Number<br>型号 | Inductance<br>电感量<br>@100kHz,1V | DC Resistance<br>直流电阻 |       | Self-resonant<br>Frequency<br>自谐频率 | Saturation Current<br>饱和电流 <sup>*3</sup> |      | Heat Rating<br>Current<br>温升电流 <sup>*4</sup> |      |
|-------------------|---------------------------------|-----------------------|-------|------------------------------------|--|------|--|------|
|                   |                                 | Max.                  | Typ.  |                                    | Min.                                     | Max. | Typ.   | Max. |
| Units 单位          | μH                              | Ω                     |       | MHz                                | A  |      | A  |      |
| Symbol 符号         | L                               | DCR                   |       | S.R.F                              | Isat                                     |      | Irms   |      |
| SWPA3012S270MT    | 27±20%                          | 1.131                 | 0.870 | 21                                 | 0.35                                     | 0.48 | 0.47   | 0.51 |
| SWPA3012S330MT    | 33±20%                          | 1.138                 | 0.875 | 18                                 | 0.36                                     | 0.46 | 0.46   | 0.50 |
| SWPA3012S360MT    | 36±20%                          | 1.235                 | 0.950 | 18                                 | 0.34                                     | 0.44 | 0.44   | 0.48 |
| SWPA3012S390MT    | 39±20%                          | 1.729                 | 1.330 | 18                                 | 0.30                                     | 0.39 | 0.37   | 0.41 |
| SWPA3012S470MT    | 47±20%                          | 1.885                 | 1.450 | 14                                 | 0.27                                     | 0.35 | 0.35   | 0.40 |
| SWPA3012S560MT    | 56±20%                          | 1.794                 | 1.380 | 9                                  | 0.26                                     | 0.33 | 0.28   | 0.40 |
| SWPA3012S680MT    | 68±20%                          | 2.171                 | 1.670 | 7                                  | 0.24                                     | 0.29 | 0.33   | 0.37 |
| SWPA3012S820MT    | 82±20%                          | 3.302                 | 2.540 | 7                                  | 0.17                                     | 0.27 | 0.27   | 0.31 |
| SWPA3012S101MT    | 100±20%                         | 3.718                 | 2.860 | 5                                  | 0.21                                     | 0.23 | 0.25   | 0.29 |

## SWPA3015S Series

| Part Number<br>型号 | Inductance<br>电感量<br>@100kHz,1V | DC Resistance<br>直流电阻 |       | Self-resonant<br>Frequency<br>自谐频率 | Saturation Current<br>饱和电流 <sup>*3</sup> |      | Heat Rating<br>Current<br>温升电流 <sup>*4</sup> |      |
|-------------------|---------------------------------|-----------------------|-------|------------------------------------|--|------|--|------|
|                   |                                 | Max.                  | Typ.  |                                    | Min.                                     | Max. | Typ.   | Max. |
| Units 单位          | μH                              | Ω                     |       | MHz                                | A  |      | A  |      |
| Symbol 符号         | L                               | DCR                   |       | S.R.F                              | Isat                                     |      | Irms   |      |
| SWPA3015SR50NT    | 0.5±30%                         | 0.039                 | 0.030 | 162                                | 3.90                                     | 4.20 | 2.60   | 2.80 |
| SWPA3015S1R0NT    | 1.0±30%                         | 0.039                 | 0.030 | 150                                | 2.32                                     | 2.80 | 2.35   | 2.50 |
| SWPA3015S1R2NT    | 1.2±30%                         | 0.052                 | 0.040 | 110                                | 2.21                                     | 3.10 | 1.95   | 2.30 |
| SWPA3015S1R5NT    | 1.5±30%                         | 0.065                 | 0.050 | 100                                | 2.30                                     | 2.70 | 1.70   | 2.20 |
| SWPA3015S1R8NT    | 1.8±30%                         | 0.065                 | 0.050 | 92                                 | 1.75                                     | 2.20 | 1.70   | 2.20 |
| SWPA3015S2R2NT    | 2.2±30%                         | 0.078                 | 0.060 | 86                                 | 1.60                                     | 2.00 | 1.60   | 2.00 |
| SWPA3015S2R7NT    | 2.7±30%                         | 0.098                 | 0.075 | 64                                 | 1.52                                     | 1.90 | 1.43   | 1.90 |
| SWPA3015S3R3MT    | 3.3±20%                         | 0.104                 | 0.080 | 68                                 | 1.32                                     | 1.81 | 1.36   | 1.60 |
| SWPA3015S3R6MT    | 3.6±20%                         | 0.137                 | 0.105 | 59                                 | 1.28                                     | 1.60 | 1.20   | 1.50 |
| SWPA3015S3R9MT    | 3.9±20%                         | 0.137                 | 0.105 | 47                                 | 1.20                                     | 1.40 | 1.20   | 1.50 |
| SWPA3015S4R3MT    | 4.3±20%                         | 0.150                 | 0.115 | 53                                 | 1.20                                     | 1.40 | 1.14   | 1.30 |
| SWPA3015S4R7MT    | 4.7±20%                         | 0.163                 | 0.125 | 46                                 | 1.10                                     | 1.40 | 1.09   | 1.30 |
| SWPA3015S5R1MT    | 5.1±20%                         | 0.173                 | 0.133 | 49                                 | 1.00                                     | 1.20 | 1.05   | 1.20 |
| SWPA3015S6R2MT    | 6.2±20%                         | 0.254                 | 0.195 | 46                                 | 1.00                                     | 1.20 | 0.86   | 1.00 |
| SWPA3015S6R8MT    | 6.8±20%                         | 0.260                 | 0.20  | 39                                 | 0.85                                     | 1.10 | 0.85   | 1.10 |
| SWPA3015S100MT    | 10±20%                          | 0.325                 | 0.250 | 41                                 | 0.72                                     | 0.92 | 0.77   | 0.90 |
| SWPA3015S120MT    | 12±20%                          | 0.416                 | 0.320 | 32                                 | 0.70                                     | 0.90 | 0.68   | 0.89 |
| SWPA3015S150MT    | 15±20%                          | 0.455                 | 0.350 | 30                                 | 0.66                                     | 0.88 | 0.65   | 0.72 |
| SWPA3015S180MT    | 18±20%                          | 0.559                 | 0.430 | 23                                 | 0.56                                     | 0.72 | 0.59   | 0.72 |
| SWPA3015S220MT    | 22±20%                          | 0.598                 | 0.460 | 23                                 | 0.52                                     | 0.68 | 0.57   | 0.69 |
| SWPA3015S270MT    | 27±20%                          | 0.949                 | 0.730 | 22                                 | 0.48                                     | 0.56 | 0.45   | 0.56 |
| SWPA3015S330MT    | 33±20%                          | 1.066                 | 0.820 | 20                                 | 0.44                                     | 0.53 | 0.43   | 0.51 |
| SWPA3015S390MT    | 39±20%                          | 1.294                 | 0.995 | 14                                 | 0.41                                     | 0.55 | 0.39   | 0.44 |
| SWPA3015S430MT    | 43±20%                          | 1.378                 | 1.060 | 16                                 | 0.37                                     | 0.43 | 0.37   | 0.48 |
| SWPA3015S470MT    | 47±20%                          | 1.625                 | 1.250 | 14                                 | 0.35                                     | 0.43 | 0.35   | 0.44 |
| SWPA3015S560MT    | 56±20%                          | 1.664                 | 1.280 | 13                                 | 0.33                                     | 0.42 | 0.34   | 0.41 |
| SWPA3015S620MT    | 62±20%                          | 2.093                 | 1.610 | 13                                 | 0.30                                     | 0.40 | 0.30   | 0.41 |
| SWPA3015S680MT    | 68±20%                          | 3.510                 | 2.700 | 11                                 | 0.28                                     | 0.37 | 0.23   | 0.31 |
| SWPA3015S101MT    | 100±20%                         | 4.043                 | 3.110 | 7.2                                | 0.23                                     | 0.25 | 0.21   | 0.25 |
| SWPA3015S151MT    | 150±20%                         | 4.940                 | 3.80  | 4.5                                | 0.18                                     | 0.22 | 0.19   | 0.23 |

## 规格特性

## SPECIFICATIONS

## SWPA4010S Series

| Part Number<br>型号 | Inductance<br>电感量<br>@100kHz,1V | DC Resistance<br>直流电阻 |       | Self-resonant<br>Frequency<br>自谐频率 | Saturation Current<br>饱和电流 <sup>*3</sup> |      | Heat Rating<br>Current<br>温升电流 <sup>*4</sup> |      |
|-------------------|---------------------------------|-----------------------|-------|------------------------------------|--|------|--|------|
|                   |                                 | Max.                  | Typ.  |                                    | Min.                                     | Max. | Typ.   | Max. |
| Units 单位          | μH                              | Ω                     |       | MHz                                | A  |      | A  |      |
| Symbol 符号         | L                               | DCR                   |       | S.R.F                              | Isat                                     |      | Irms   |      |
| SWPA4010S1R0NT    | 1.0±30%                         | 0.067                 | 0.056 | 104                                | 2.00                                     | 2.30 | 1.90   | 2.40 |
| SWPA4010S1R5NT    | 1.5±30%                         | 0.084                 | 0.070 | 71                                 | 1.68                                     | 2.00 | 1.70   | 2.00 |
| SWPA4010S2R2MT    | 2.2±20%                         | 0.102                 | 0.085 | 52                                 | 1.20                                     | 1.50 | 1.50   | 2.00 |
| SWPA4010S3R3MT    | 3.3±20%                         | 0.120                 | 0.100 | 42                                 | 1.10                                     | 1.40 | 1.40   | 1.80 |
| SWPA4010S4R7MT    | 4.7±20%                         | 0.168                 | 0.140 | 30                                 | 0.95                                     | 1.10 | 1.20   | 1.50 |
| SWPA4010S6R8MT    | 6.8±20%                         | 0.240                 | 0.200 | 26                                 | 0.80                                     | 0.95 | 1.00   | 1.20 |
| SWPA4010S100MT    | 10±20%                          | 0.360                 | 0.300 | 19                                 | 0.62                                     | 0.75 | 0.75   | 1.00 |
| SWPA4010S150MT    | 15±20%                          | 0.516                 | 0.430 | 17                                 | 0.54                                     | 0.61 | 0.60   | 0.85 |
| SWPA4010S220MT    | 22±20%                          | 0.684                 | 0.570 | 11                                 | 0.45                                     | 0.52 | 0.50   | 0.75 |

## SWPA4012S Series

| Part Number<br>型号 | Inductance<br>电感量<br>@100kHz,1V | DC Resistance<br>直流电阻 |       | Self-resonant<br>Frequency<br>自谐频率 | Saturation Current<br>饱和电流 <sup>*3</sup> |      | Heat Rating<br>Current<br>温升电流 <sup>*4</sup> |      |
|-------------------|---------------------------------|-----------------------|-------|------------------------------------|--|------|--|------|
|                   |                                 | Max.                  | Typ.  |                                    | Min.                                     | Max. | Typ.   | Max. |
| Units 单位          | μH                              | Ω                     |       | MHz                                | A  |      | A  |      |
| Symbol 符号         | L                               | DCR                   |       | S.R.F                              | Isat                                     |      | Irms   |      |
| SWPA4012SR82NT    | 0.82±30%                        | 0.065                 | 0.050 | 150                                | 3.02                                     | 3.30 | 1.65   | 2.50 |
| SWPA4012S1R0NT    | 1.0±30%                         | 0.065                 | 0.050 | 120                                | 2.61                                     | 3.20 | 1.65   | 2.50 |
| SWPA4012S1R5NT    | 1.5±30%                         | 0.085                 | 0.065 | 90                                 | 2.10                                     | 2.70 | 1.46   | 2.20 |
| SWPA4012S1R8NT    | 1.8±30%                         | 0.104                 | 0.080 | 88                                 | 2.12                                     | 2.60 | 1.32   | 1.90 |
| SWPA4012S2R2NT    | 2.2±30%                         | 0.104                 | 0.080 | 74                                 | 1.76                                     | 2.30 | 1.32   | 1.90 |
| SWPA4012S2R7NT    | 2.7±30%                         | 0.117                 | 0.090 | 71                                 | 1.90                                     | 2.30 | 1.25   | 1.70 |
| SWPA4012S3R3NT    | 3.3±30%                         | 0.143                 | 0.110 | 60                                 | 1.72                                     | 2.10 | 1.12   | 1.60 |
| SWPA4012S3R6NT    | 3.6±30%                         | 0.143                 | 0.110 | 57                                 | 1.20                                     | 1.70 | 1.12   | 1.60 |
| SWPA4012S4R3NT    | 4.3±30%                         | 0.182                 | 0.140 | 54                                 | 1.58                                     | 1.70 | 1.00   | 1.50 |
| SWPA4012S4R7NT    | 4.7±30%                         | 0.163                 | 0.125 | 50                                 | 1.15                                     | 1.80 | 1.05   | 1.50 |
| SWPA4012S5R1NT    | 5.1±30%                         | 0.201                 | 0.155 | 50                                 | 1.55                                     | 1.60 | 0.95   | 1.50 |
| SWPA4012S5R6NT    | 5.6±30%                         | 0.182                 | 0.140 | 42                                 | 1.00                                     | 1.60 | 1.00   | 1.20 |
| SWPA4012S6R8MT    | 6.8±20%                         | 0.257                 | 0.198 | 40                                 | 0.85                                     | 1.40 | 0.84   | 1.20 |
| SWPA4012S100MT    | 10±20%                          | 0.345                 | 0.265 | 33                                 | 0.80                                     | 1.10 | 0.77   | 1.00 |
| SWPA4012S120MT    | 12±20%                          | 0.377                 | 0.290 | 32                                 | 0.66                                     | 1.00 | 0.70   | 0.95 |
| SWPA4012S150MT    | 15±20%                          | 0.442                 | 0.340 | 25                                 | 0.56                                     | 0.80 | 0.64   | 0.85 |
| SWPA4012S180MT    | 18±20%                          | 0.611                 | 0.470 | 23                                 | 0.55                                     | 0.75 | 0.55   | 0.80 |
| SWPA4012S220MT    | 22±20%                          | 0.763                 | 0.587 | 20                                 | 0.46                                     | 0.70 | 0.49   | 0.75 |
| SWPA4012S270MT    | 27±20%                          | 0.936                 | 0.720 | 18                                 | 0.50                                     | 0.70 | 0.45   | 0.60 |
| SWPA4012S330MT    | 33±20%                          | 1.053                 | 0.810 | 17                                 | 0.42                                     | 0.60 | 0.42   | 0.58 |
| SWPA4012S360MT    | 36±20%                          | 1.170                 | 0.90  | 14                                 | 0.40                                     | 0.50 | 0.40   | 0.56 |
| SWPA4012S390MT    | 39±20%                          | 1.430                 | 1.10  | 16                                 | 0.55                                     | 0.66 | 0.37   | 0.50 |
| SWPA4012S470MT    | 47±20%                          | 1.430                 | 1.10  | 12                                 | 0.35                                     | 0.50 | 0.37   | 0.50 |
| SWPA4012S560MT    | 56±20%                          | 1.625                 | 1.250 | 11                                 | 0.33                                     | 0.45 | 0.33   | 0.46 |
| SWPA4012S680MT    | 68±20%                          | 2.535                 | 1.950 | 11                                 | 0.38                                     | 0.45 | 0.27   | 0.45 |
| SWPA4012S820MT    | 82±20%                          | 2.782                 | 2.140 | 11                                 | 0.28                                     | 0.40 | 0.26   | 0.36 |
| SWPA4012S101MT    | 100±20%                         | 2.873                 | 2.210 | 9.4                                | 0.25                                     | 0.30 | 0.25   | 0.35 |

## 规格特性

## SPECIFICATIONS

## SWPA4018S Series

| Part Number<br>型号 | Inductance<br>电感量<br>@100kHz,1V | DC Resistance<br>直流电阻 |       | Self-resonant<br>Frequency<br>自谐频率 | Saturation Current<br>饱和电流 <sup>*3</sup> |      | Heat Rating<br>Current<br>温升电流 <sup>*4</sup> |      |
|-------------------|---------------------------------|-----------------------|-------|------------------------------------|--|------|--|------|
|                   |                                 | Max.                  | Typ.  |                                    | Min.                                     | Max. | Typ.   | Max. |
| Units 单位          | μH                              | Ω                     |       | MHz                                | A  |      | A  |      |
| Symbol 符号         | L                               | DCR                   |       | S.R.F                              | Isat                                     |      | Irms   |      |
| SWPA4018SR47NT    | 0.47±30%                        | 0.018                 | 0.014 | 155                                | 4.30                                     | 5.20 | 4.00   | 4.50 |
| SWPA4018SR68NT    | 0.68±30%                        | 0.026                 | 0.020 | 128                                | 4.90                                     | 5.60 | 3.30   | 3.80 |
| SWPA4018S1R0NT    | 1.0±30%                         | 0.033                 | 0.025 | 80                                 | 4.80                                     | 5.20 | 2.00   | 3.30 |
| SWPA4018S1R5NT    | 1.5±30%                         | 0.039                 | 0.030 | 65                                 | 3.35                                     | 4.00 | 1.80   | 3.20 |
| SWPA4018S1R8NT    | 1.8±30%                         | 0.044                 | 0.034 | 54                                 | 3.00                                     | 3.40 | 2.00   | 2.80 |
| SWPA4018S2R2MT    | 2.2±20%                         | 0.059                 | 0.045 | 52                                 | 2.70                                     | 3.20 | 1.65   | 2.60 |
| SWPA4018S3R3MT    | 3.3±20%                         | 0.091                 | 0.070 | 44                                 | 2.45                                     | 2.90 | 1.23   | 2.10 |
| SWPA4018S4R7MT    | 4.7±20%                         | 0.117                 | 0.090 | 34                                 | 1.70                                     | 2.20 | 1.20   | 1.80 |
| SWPA4018S6R8MT    | 6.8±20%                         | 0.143                 | 0.110 | 29                                 | 1.45                                     | 2.00 | 1.06   | 1.50 |
| SWPA4018S100MT    | 10±20%                          | 0.234                 | 0.180 | 24                                 | 1.30                                     | 1.60 | 0.84   | 1.20 |
| SWPA4018S150MT    | 15±20%                          | 0.325                 | 0.250 | 19                                 | 0.94                                     | 1.10 | 0.65   | 1.00 |
| SWPA4018S220MT    | 22±20%                          | 0.468                 | 0.360 | 16                                 | 0.80                                     | 0.88 | 0.59   | 0.85 |
| SWPA4018S330MT    | 33±20%                          | 0.689                 | 0.530 | 12                                 | 0.56                                     | 0.75 | 0.49   | 0.72 |
| SWPA4018S470MT    | 47±20%                          | 0.845                 | 0.650 | 10                                 | 0.57                                     | 0.70 | 0.42   | 0.65 |
| SWPA4018S680MT    | 68±20%                          | 1.30                  | 1.0   | 8.3                                | 0.47                                     | 0.51 | 0.32   | 0.52 |
| SWPA4018S101MT    | 100±20%                         | 2.275                 | 1.750 | 6.5                                | 0.40                                     | 0.44 | 0.25   | 0.41 |
| SWPA4018S151MT    | 150±20%                         | 3.250                 | 2.50  | 5.5                                | 0.31                                     | 0.34 | 0.22   | 0.36 |
| SWPA4018S221MT    | 220±20%                         | 5.20                  | 4.0   | 4                                  | 0.27                                     | 0.30 | 0.17   | 0.27 |

## SWPA4020S Series

| Part Number<br>型号 | Inductance<br>电感量<br>@100kHz,1V | DC Resistance<br>直流电阻 |       | Self-resonant<br>Frequency<br>自谐频率 | Saturation Current<br>饱和电流 <sup>*3</sup> |      | Heat Rating<br>Current<br>温升电流 <sup>*4</sup> |      |
|-------------------|---------------------------------|-----------------------|-------|------------------------------------|--|------|--|------|
|                   |                                 | Max.                  | Typ.  |                                    | Min.                                     | Max. | Typ.   | Max. |
| Units 单位          | μH                              | Ω                     |       | MHz                                | A  |      | A  |      |
| Symbol 符号         | L                               | DCR                   |       | S.R.F                              | Isat                                     |      | Irms   |      |
| SWPA4020SR24MT    | 0.24±20%                        | 0.014                 | 0.011 | 283                                | 10.5                                     | 12.5 | 4.50   | 5.20 |
| SWPA4020SR33NT    | 0.33±30%                        | 0.016                 | 0.013 | 223                                | 7.50                                     | 8.50 | 3.30   | 4.90 |
| SWPA4020SR47NT    | 0.47±30%                        | 0.029                 | 0.022 | 160                                | 7.00                                     | 7.50 | 3.30   | 3.70 |
| SWPA4020SR68NT    | 0.68±30%                        | 0.036                 | 0.028 | 120                                | 6.40                                     | 6.60 | 2.80   | 3.30 |
| SWPA4020S1R0NT    | 1.0±30%                         | 0.038                 | 0.029 | 75                                 | 4.78                                     | 5.20 | 2.15   | 3.20 |
| SWPA4020S1R2NT    | 1.2±30%                         | 0.038                 | 0.029 | 72                                 | 5.10                                     | 5.60 | 2.15   | 3.20 |
| SWPA4020S1R5NT    | 1.5±30%                         | 0.046                 | 0.035 | 71                                 | 4.45                                     | 4.90 | 1.98   | 3.00 |
| SWPA4020S2R2MT    | 2.2±20%                         | 0.052                 | 0.040 | 49                                 | 3.40                                     | 3.70 | 1.85   | 2.80 |
| SWPA4020S3R3MT    | 3.3±20%                         | 0.091                 | 0.070 | 44                                 | 3.20                                     | 3.50 | 1.40   | 2.50 |
| SWPA4020S3R6MT    | 3.6±20%                         | 0.072                 | 0.055 | 49                                 | 2.80                                     | 3.00 | 1.54   | 2.50 |
| SWPA4020S4R7MT    | 4.7±20%                         | 0.098                 | 0.075 | 42                                 | 2.35                                     | 2.50 | 1.34   | 2.00 |
| SWPA4020S5R1MT    | 5.1±20%                         | 0.111                 | 0.085 | 42                                 | 2.30                                     | 2.50 | 1.27   | 1.80 |
| SWPA4020S5R6MT    | 5.6±20%                         | 0.117                 | 0.090 | 30                                 | 2.20                                     | 2.40 | 1.22   | 1.80 |
| SWPA4020S6R2MT    | 6.2±20%                         | 0.150                 | 0.115 | 36                                 | 2.15                                     | 2.30 | 1.08   | 1.60 |
| SWPA4020S6R8MT    | 6.8±20%                         | 0.163                 | 0.125 | 33                                 | 2.20                                     | 2.40 | 1.04   | 1.60 |
| SWPA4020S7R5MT    | 7.5±20%                         | 0.150                 | 0.115 | 30                                 | 1.85                                     | 2.00 | 1.08   | 1.50 |
| SWPA4020S8R2MT    | 8.2±20%                         | 0.163                 | 0.125 | 27                                 | 1.75                                     | 1.90 | 1.04   | 1.40 |
| SWPA4020S100MT    | 10±20%                          | 0.215                 | 0.165 | 26                                 | 1.60                                     | 1.70 | 0.90   | 1.20 |
| SWPA4020S120MT    | 12±20%                          | 0.228                 | 0.175 | 26                                 | 1.50                                     | 1.60 | 0.88   | 1.20 |
| SWPA4020S150MT    | 15±20%                          | 0.299                 | 0.230 | 24                                 | 1.35                                     | 1.50 | 0.77   | 1.10 |
| SWPA4020S220MT    | 22±20%                          | 0.455                 | 0.350 | 15                                 | 1.05                                     | 1.10 | 0.62   | 0.87 |
| SWPA4020S270MT    | 27±20%                          | 0.709                 | 0.545 | 14                                 | 1.02                                     | 1.10 | 0.50   | 0.70 |

## 规格特性

## SPECIFICATIONS

## SWPA4020S Series

| Part Number<br>型号 | Inductance<br>电感量<br>@100kHz,1V | DC Resistance<br>直流电阻 |       | Self-resonant<br>Frequency<br>自谐频率 | Saturation Current<br>饱和电流 <sup>*3</sup> |      | Heat Rating<br>Current<br>温升电流 <sup>*4</sup> |      |
|-------------------|---------------------------------|-----------------------|-------|------------------------------------|--|------|--|------|
|                   |                                 | Max.                  | Typ.  |                                    | Min.                                     | Max. | Typ.   | Max. |
| Units 单位          | μH                              | Ω                     |       | MHz                                | A  |      | A  |      |
| Symbol 符号         | L                               | DCR                   |       | S.R.F                              | Isat                                     |      | Irms   |      |
| SWPA4020S330MT    | 33±20%                          | 0.715                 | 0.550 | 11                                 | 0.85                                     | 0.93 | 0.49   | 0.68 |
| SWPA4020S390MT    | 39±20%                          | 0.845                 | 0.650 | 11                                 | 0.82                                     | 0.90 | 0.46   | 0.64 |
| SWPA4020S430MT    | 43±20%                          | 0.858                 | 0.660 | 10                                 | 0.77                                     | 0.85 | 0.45   | 0.63 |
| SWPA4020S470MT    | 47±20%                          | 0.923                 | 0.710 | 10                                 | 0.74                                     | 0.81 | 0.44   | 0.61 |
| SWPA4020S510MT    | 51±20%                          | 0.975                 | 0.750 | 10                                 | 0.70                                     | 0.77 | 0.42   | 0.59 |
| SWPA4020S560MT    | 56±20%                          | 1.040                 | 0.80  | 10                                 | 0.66                                     | 0.72 | 0.41   | 0.57 |
| SWPA4020S620MT    | 62±20%                          | 1.170                 | 0.90  | 9.6                                | 0.65                                     | 0.71 | 0.39   | 0.52 |
| SWPA4020S680MT    | 68±20%                          | 1.380                 | 1.060 | 7.7                                | 0.61                                     | 0.67 | 0.36   | 0.50 |
| SWPA4020S750MT    | 75±20%                          | 1.510                 | 1.160 | 7.7                                | 0.70                                     | 0.77 | 0.35   | 0.49 |
| SWPA4020S820MT    | 82±20%                          | 1.520                 | 1.170 | 7.2                                | 0.50                                     | 0.55 | 0.34   | 0.47 |
| SWPA4020S101MT    | 100±20%                         | 2.020                 | 1.550 | 6.3                                | 0.48                                     | 0.53 | 0.31   | 0.43 |

## SWPA4030S Series

| Part Number<br>型号         | Inductance<br>电感量<br>@100kHz,1V | DC Resistance<br>直流电阻 |                  | Self-resonant<br>Frequency<br>自谐频率 | Saturation Current<br>饱和电流 <sup>*3</sup> |                 | Heat Rating<br>Current<br>温升电流 <sup>*4</sup> |                 |
|---------------------------|---------------------------------|-----------------------|------------------|------------------------------------|--|-----------------|--|-----------------|
|                           |                                 | Max.                  | Typ.             |                                    | Min.                                     | Max.            | Typ.   | Max.            |
| Units 单位                  | μH                              | Ω                     |                  | MHz                                | A  |                 | A  |                 |
| Symbol 符号                 | L                               | DCR                   |                  | S.R.F                              | Isat                                     |                 | Irms   |                 |
| <del>SWPA4030SR47NT</del> | <del>0.47±30%</del>             | <del>0.0104</del>     | <del>0.008</del> | <del>184</del>                     | <del>7.80</del>                          | <del>9.80</del> | <del>5.20</del>                              | <del>5.90</del> |
| SWPA4030SR68NT            | 0.68±30%                        | 0.013                 | 0.010            | 130                                | 6.80                                     | 8.00            | 4.56   | 5.10            |
| SWPA4030SR91NT            | 0.91±30%                        | 0.017                 | 0.013            | 100                                | 6.25                                     | 6.80            | 4.15   | 4.70            |
| SWPA4030S1R0NT            | 1.0±30%                         | 0.018                 | 0.014            | 70                                 | 5.26                                     | 5.70            | 4.15   | 4.70            |
| SWPA4030S1R2NT            | 1.2±30%                         | 0.020                 | 0.015            | 80                                 | 5.80                                     | 6.30            | 3.82   | 4.20            |
| SWPA4030S1R5NT            | 1.5±30%                         | 0.026                 | 0.020            | 62                                 | 4.84                                     | 5.30            | 3.34   | 3.60            |
| SWPA4030S1R8NT            | 1.8±30%                         | 0.033                 | 0.025            | 60                                 | 4.50                                     | 5.00            | 3.20   | 3.30            |
| SWPA4030S2R2NT            | 2.2±30%                         | 0.039                 | 0.030            | 52                                 | 4.90                                     | 5.80            | 2.95   | 3.20            |
| SWPA4030S3R3MT            | 3.3±20%                         | 0.052                 | 0.040            | 38                                 | 3.30                                     | 3.60            | 2.40   | 2.60            |
| <del>SWPA4030S3R6MT</del> | <del>3.6±20%</del>              | <del>0.052</del>      | <del>0.040</del> | <del>37</del>                      | <del>3.00</del>                          | <del>3.50</del> | <del>2.40</del>                              | <del>2.60</del> |
| SWPA4030S3R9MT            | 3.9±20%                         | 0.074                 | 0.057            | 32                                 | 3.00                                     | 3.30            | 2.10   | 2.30            |
| SWPA4030S4R3MT            | 4.3±20%                         | 0.072                 | 0.055            | 37                                 | 2.95                                     | 3.20            | 2.10   | 2.30            |
| SWPA4030S4R7MT            | 4.7±20%                         | 0.078                 | 0.060            | 31                                 | 2.90                                     | 3.20            | 2.00   | 2.30            |
| SWPA4030S5R6MT            | 5.6±20%                         | 0.085                 | 0.065            | 30                                 | 2.60                                     | 2.80            | 1.95   | 2.10            |
| SWPA4030S6R8MT            | 6.8±20%                         | 0.117                 | 0.090            | 24                                 | 2.75                                     | 3.00            | 1.60   | 1.70            |
| SWPA4030S7R5MT            | 7.5±20%                         | 0.110                 | 0.085            | 26                                 | 2.20                                     | 2.40            | 1.65   | 1.80            |
| SWPA4030S8R2MT            | 8.2±20%                         | 0.117                 | 0.090            | 26                                 | 2.10                                     | 2.30            | 1.60   | 1.70            |
| SWPA4030S100MT            | 10±20%                          | 0.130                 | 0.10             | 21                                 | 1.95                                     | 2.40            | 1.50   | 1.60            |
| SWPA4030S120MT            | 12±20%                          | 0.175                 | 0.135            | 18                                 | 1.70                                     | 1.80            | 1.30   | 1.40            |
| SWPA4030S150MT            | 15±20%                          | 0.247                 | 0.190            | 16                                 | 1.65                                     | 1.80            | 1.11   | 1.20            |
| SWPA4030S180MT            | 18±20%                          | 0.260                 | 0.20             | 10                                 | 1.40                                     | 1.50            | 1.10   | 1.20            |
| SWPA4030S220MT            | 22±20%                          | 0.293                 | 0.225            | 10                                 | 1.30                                     | 1.40            | 1.00   | 1.20            |
| SWPA4030S330MT            | 33±20%                          | 0.429                 | 0.330            | 10                                 | 1.10                                     | 1.20            | 0.84   | 0.92            |
| SWPA4030S360MT            | 36±20%                          | 0.436                 | 0.335            | 9.8                                | 1.05                                     | 1.10            | 0.83   | 0.91            |
| SWPA4030S390MT            | 39±20%                          | 0.566                 | 0.435            | 10                                 | 1.03                                     | 1.10            | 0.73   | 0.80            |
| SWPA4030S470MT            | 47±20%                          | 0.579                 | 0.445            | 8.4                                | 0.95                                     | 1.00            | 0.72   | 0.80            |
| SWPA4030S510MT            | 51±20%                          | 0.611                 | 0.470            | 8.4                                | 0.90                                     | 1.13            | 0.70   | 0.80            |
| SWPA4030S560MT            | 56±20%                          | 0.722                 | 0.555            | 8.4                                | 0.85                                     | 0.94            | 0.65   | 0.71            |
| SWPA4030S620MT            | 62±20%                          | 0.760                 | 0.585            | 7                                  | 0.80                                     | 0.99            | 0.63   | 0.70            |
| SWPA4030S680MT            | 68±20%                          | 1.128                 | 0.868            | 7                                  | 0.72                                     | 0.80            | 0.52   | 0.57            |

## 规格特性

## SPECIFICATIONS

## SWPA4030S Series

| Part Number<br>型号 | Inductance<br>电感量 | DC Resistance<br>直流电阻 |       | Self-resonant<br>Frequency<br>自谐频率 | Saturation Current<br>饱和电流 <sup>*3</sup> |      | Heat Rating<br>Current<br>温升电流 <sup>*4</sup> |      |
|-------------------|-------------------|-----------------------|-------|------------------------------------|--|------|--|------|
|                   |                   | Max.                  | Typ.  |                                    | Max.                                     | Typ. | Max.   | Typ. |
| Units 单位          | @100kHz,1V<br>μH  | Ω                     |       | MHz                                | A  |      | A  |      |
| Symbol 符号         | L                 | DCR                   |       | S.R.F                              | Isat                                     |      | Irms   |      |
| SWPA4030S750MT    | 75±20%            | 1.326                 | 1.020 | 6.3                                | 0.70                                     | 0.88 | 0.48   | 0.53 |
| SWPA4030S820MT    | 82±20%            | 1.378                 | 1.060 | 5.6                                | 0.66                                     | 0.72 | 0.47   | 0.52 |
| SWPA4030S910MT    | 91±20%            | 1.430                 | 1.10  | 5.6                                | 0.65                                     | 0.71 | 0.46   | 0.50 |
| SWPA4030S101MT    | 100±20%           | 1.495                 | 1.150 | 5.6                                | 0.60                                     | 0.73 | 0.45   | 0.49 |
| SWPA4030S121MT    | 120±20%           | 1.755                 | 1.350 | 5.4                                | 0.55                                     | 0.60 | 0.42   | 0.46 |
| SWPA4030S151MT    | 150±20%           | 2.340                 | 1.80  | 4                                  | 0.50                                     | 0.55 | 0.30   | 0.35 |
| SWPA4030S471KT    | 470±10%           | 9.360                 | 7.20  | 2                                  | 0.30                                     | 0.35 | 0.20   | 0.23 |
| SWPA4030S501MT    | 500±20%           | 9.027                 | 6.944 | 2                                  | 0.28                                     | 0.30 | 0.15   | 0.20 |
| SWPA4030S681MT    | 680±20%           | 9.854                 | 7.580 | 1.2                                | 0.19                                     | 0.20 | 0.14   | 0.18 |

## SWPA5012S Series

| Part Number<br>型号 | Inductance<br>电感量 | DC Resistance<br>直流电阻 |       | Self-resonant<br>Frequency<br>自谐频率 | Saturation Current<br>饱和电流 <sup>*3</sup> |      | Heat Rating<br>Current<br>温升电流 <sup>*4</sup> |      |
|-------------------|-------------------|-----------------------|-------|------------------------------------|--|------|--|------|
|                   |                   | Max.                  | Typ.  |                                    | Max.                                     | Typ. | Max.   | Typ. |
| Units 单位          | @100kHz,1V<br>μH  | Ω                     |       | MHz                                | A  |      | A  |      |
| Symbol 符号         | L                 | DCR                   |       | S.R.F                              | Isat                                     |      | Irms   |      |
| SWPA5012S1R0NT    | 1.0±30%           | 0.068                 | 0.057 | 103                                | 4.40                                     | 4.70 | 2.00   | 2.40 |
| SWPA5012S1R5NT    | 1.5±30%           | 0.086                 | 0.072 | 68                                 | 3.70                                     | 3.80 | 1.90   | 2.20 |
| SWPA5012S2R2NT    | 2.2±30%           | 0.108                 | 0.090 | 50                                 | 3.10                                     | 3.20 | 1.70   | 2.00 |
| SWPA5012S3R3NT    | 3.3±30%           | 0.151                 | 0.126 | 34                                 | 2.40                                     | 2.60 | 1.40   | 1.70 |
| SWPA5012S4R7NT    | 4.7±30%           | 0.197                 | 0.164 | 31                                 | 2.20                                     | 2.30 | 1.30   | 1.50 |
| SWPA5012S6R8MT    | 6.8±20%           | 0.294                 | 0.245 | 22                                 | 1.70                                     | 1.90 | 1.00   | 1.20 |
| SWPA5012S100MT    | 10±20%            | 0.413                 | 0.344 | 17                                 | 1.40                                     | 1.50 | 0.85   | 1.00 |
| SWPA5012S150MT    | 15±20%            | 0.523                 | 0.436 | 13                                 | 1.20                                     | 1.30 | 0.80   | 0.92 |
| SWPA5012S220MT    | 22±20%            | 0.858                 | 0.780 | 16                                 | 0.88                                     | 0.98 | 0.60   | 0.68 |

## SWPA5020S Series

| Part Number<br>型号 | Inductance<br>电感量 | DC Resistance<br>直流电阻 |       | Self-resonant<br>Frequency<br>自谐频率 | Saturation Current<br>饱和电流 <sup>*3</sup> |       | Heat Rating<br>Current<br>温升电流 <sup>*4</sup> |      |
|-------------------|-------------------|-----------------------|-------|------------------------------------|--|-------|--|------|
|                   |                   | Max.                  | Typ.  |                                    | Max.                                     | Typ.  | Max.   | Typ. |
| Units 单位          | @100kHz,1V<br>μH  | Ω                     |       | MHz                                | A  |       | A  |      |
| Symbol 符号         | L                 | DCR                   |       | S.R.F                              | Isat                                     |       | Irms   |      |
| SWPA5020SR22NT    | 0.22±30%          | 0.011                 | 0.009 | 280                                | 9.00                                     | 12.00 | 5.30   | 6.00 |
| SWPA5020SR24NT    | 0.24±30%          | 0.011                 | 0.009 | 248                                | 8.00                                     | 10.00 | 5.30   | 6.00 |
| SWPA5020SR47NT    | 0.47±30%          | 0.017                 | 0.013 | 160                                | 6.15                                     | 6.70  | 4.60   | 5.00 |
| SWPA5020SR56NT    | 0.56±30%          | 0.022                 | 0.017 | 137                                | 8.50                                     | 9.60  | 3.80   | 4.20 |
| SWPA5020SR68NT    | 0.68±30%          | 0.022                 | 0.017 | 120                                | 5.50                                     | 6.00  | 4.00   | 4.40 |
| SWPA5020SR75NT    | 0.75±30%          | 0.022                 | 0.017 | 117                                | 5.50                                     | 6.00  | 4.00   | 4.40 |
| SWPA5020S1R0NT    | 1.0±30%           | 0.026                 | 0.020 | 114                                | 4.10                                     | 5.00  | 3.80   | 4.10 |
| SWPA5020S1R2NT    | 1.2±30%           | 0.029                 | 0.022 | 83                                 | 4.50                                     | 4.90  | 3.55   | 3.90 |
| SWPA5020S1R5NT    | 1.5±30%           | 0.034                 | 0.026 | 68                                 | 4.10                                     | 4.50  | 3.20   | 3.50 |
| SWPA5020S2R2NT    | 2.2±30%           | 0.042                 | 0.032 | 57                                 | 3.20                                     | 4.00  | 2.90   | 3.10 |
| SWPA5020S2R7NT    | 2.7±30%           | 0.049                 | 0.038 | 52                                 | 2.90                                     | 3.50  | 2.70   | 2.90 |
| SWPA5020S3R0NT    | 3.0±30%           | 0.049                 | 0.038 | 49                                 | 2.55                                     | 2.80  | 2.70   | 2.90 |
| SWPA5020S3R3NT    | 3.3±30%           | 0.056                 | 0.043 | 46                                 | 2.55                                     | 3.00  | 2.50   | 2.70 |
| SWPA5020S3R6NT    | 3.6±30%           | 0.056                 | 0.043 | 43                                 | 2.80                                     | 3.00  | 2.50   | 2.70 |

## 规格特性

## SPECIFICATIONS

## SWPA5020S Series

| Part Number<br>型号 | Inductance<br>电感量<br>@100kHz,1V | DC Resistance<br>直流电阻 |       | Self-resonant<br>Frequency<br>自谐频率 | Saturation Current<br>饱和电流 <sup>*3</sup> |      | Heat Rating<br>Current<br>温升电流 <sup>*4</sup> |      |
|-------------------|---------------------------------|-----------------------|-------|------------------------------------|--|------|--|------|
|                   |                                 | Max.                  | Typ.  |                                    | Max.                                     | Typ. | Max.   | Typ. |
| Units 单位          | μH                              | Ω                     |       | MHz                                | A  |      | A  |      |
| Symbol 符号         | L                               | DCR                   |       | S.R.F                              | Isat                                     |      | Irms   |      |
| SWPA5020S3R9NT    | 3.9±30%                         | 0.056                 | 0.043 | 40                                 | 2.30                                     | 2.80 | 2.50   | 2.70 |
| SWPA5020S4R3MT    | 4.3±20%                         | 0.074                 | 0.057 | 37                                 | 2.50                                     | 3.00 | 2.20   | 2.40 |
| SWPA5020S4R7MT    | 4.7±20%                         | 0.074                 | 0.057 | 37                                 | 2.50                                     | 2.70 | 2.20   | 2.40 |
| SWPA5020S5R1MT    | 5.1±20%                         | 0.083                 | 0.064 | 32                                 | 2.25                                     | 2.60 | 2.05   | 2.20 |
| SWPA5020S5R6MT    | 5.6±20%                         | 0.083                 | 0.064 | 32                                 | 2.30                                     | 2.50 | 2.05   | 2.20 |
| SWPA5020S6R8MT    | 6.8±20%                         | 0.108                 | 0.083 | 30                                 | 2.05                                     | 2.20 | 1.80   | 1.90 |
| SWPA5020S7R5MT    | 7.5±20%                         | 0.117                 | 0.090 | 26                                 | 1.85                                     | 2.00 | 1.75   | 1.90 |
| SWPA5020S8R2MT    | 8.2±20%                         | 0.127                 | 0.098 | 26                                 | 1.85                                     | 2.00 | 1.65   | 1.80 |
| SWPA5020S9R1MT    | 9.1±20%                         | 0.143                 | 0.110 | 24                                 | 1.70                                     | 1.80 | 1.55   | 1.70 |
| SWPA5020S100MT    | 10±20%                          | 0.143                 | 0.110 | 24                                 | 1.70                                     | 1.80 | 1.55   | 1.70 |
| SWPA5020S120MT    | 12±20%                          | 0.182                 | 0.140 | 22                                 | 1.50                                     | 1.60 | 1.40   | 1.50 |
| SWPA5020S150MT    | 15±20%                          | 0.215                 | 0.165 | 20                                 | 1.35                                     | 1.40 | 1.25   | 1.30 |
| SWPA5020S180MT    | 18±20%                          | 0.260                 | 0.200 | 16                                 | 1.25                                     | 1.30 | 1.15   | 1.20 |
| SWPA5020S220MT    | 22±20%                          | 0.294                 | 0.226 | 14                                 | 1.15                                     | 1.20 | 1.10   | 1.20 |
| SWPA5020S330MT    | 33±20%                          | 0.507                 | 0.390 | 10                                 | 0.92                                     | 1.00 | 0.90   | 0.99 |
| SWPA5020S470MT    | 47±20%                          | 0.680                 | 0.523 | 7                                  | 0.77                                     | 0.84 | 0.77   | 0.84 |
| SWPA5020S560MT    | 56±20%                          | 0.819                 | 0.630 | 6                                  | 0.77                                     | 0.84 | 0.70   | 0.77 |
| SWPA5020S680MT    | 68±20%                          | 0.962                 | 0.740 | 6                                  | 0.65                                     | 0.70 | 0.64   | 0.70 |
| SWPA5020S820MT    | 82±20%                          | 1.158                 | 0.965 | 6                                  | 0.65                                     | 0.75 | 0.50   | 0.60 |
| SWPA5020S101MT    | 100±20%                         | 1.430                 | 1.100 | 6                                  | 0.53                                     | 0.58 | 0.53   | 0.58 |
| SWPA5020S121MT    | 120±20%                         | 1.755                 | 1.350 | 6                                  | 0.42                                     | 0.53 | 0.40   | 0.50 |
| SWPA5020S201MT    | 200±20%                         | 2.60                  | 2.00  | 4.5                                | 0.30                                     | 0.33 | 0.40   | 0.45 |

## SWPA5040S Series

| Part Number<br>型号 | Inductance<br>电感量<br>@100kHz,1V | DC Resistance<br>直流电阻 |       | Self-resonant<br>Frequency<br>自谐频率 | Saturation Current<br>饱和电流 <sup>*3</sup> |       | Heat Rating<br>Current<br>温升电流 <sup>*4</sup> |      |
|-------------------|---------------------------------|-----------------------|-------|------------------------------------|--|-------|--|------|
|                   |                                 | Max.                  | Typ.  |                                    | Max.                                     | Typ.  | Max.   | Typ. |
| Units 单位          | μH                              | Ω                     |       | MHz                                | A  |       | A  |      |
| Symbol 符号         | L                               | DCR                   |       | S.R.F                              | Isat                                     |       | Irms   |      |
| SWPA5040SR22MT    | 0.22 ±20%                       | 0.008                 | 0.006 | 289                                | 18.00                                    | 20.00 | 6.50   | 7.50 |
| SWPA5040SR24NT    | 0.24 ±30%                       | 0.008                 | 0.006 | 251                                | 15.70                                    | 18.00 | 6.40   | 7.40 |
| SWPA5040SR47MT    | 0.47 ±20%                       | 0.009                 | 0.007 | 171                                | 10.00                                    | 11.50 | 6.60   | 7.60 |
| SWPA5040S1R0NT    | 1.0±30%                         | 0.016                 | 0.012 | 117                                | 7.35                                     | 8.20  | 4.90   | 5.10 |
| SWPA5040S1R2NT    | 1.2±30%                         | 0.021                 | 0.016 | 110                                | 6.50                                     | 7.00  | 4.15   | 4.30 |
| SWPA5040S1R5NT    | 1.5±30%                         | 0.020                 | 0.015 | 86                                 | 6.30                                     | 7.30  | 4.30   | 4.80 |
| SWPA5040S1R8MT    | 1.8±20%                         | 0.021                 | 0.016 | 55                                 | 5.50                                     | 6.40  | 4.15   | 4.30 |
| SWPA5040S2R2NT    | 2.2±30%                         | 0.025                 | 0.019 | 50                                 | 4.90                                     | 5.50  | 3.80   | 4.30 |
| SWPA5040S2R7NT    | 2.7±30%                         | 0.029                 | 0.022 | 37                                 | 4.30                                     | 5.10  | 3.60   | 4.10 |
| SWPA5040S3R0NT    | 3.0±30%                         | 0.029                 | 0.022 | 37                                 | 4.15                                     | 4.80  | 3.60   | 4.20 |
| SWPA5040S3R3NT    | 3.3±30%                         | 0.031                 | 0.024 | 32                                 | 3.95                                     | 4.60  | 3.40   | 3.90 |
| SWPA5040S3R6MT    | 3.6±20%                         | 0.031                 | 0.026 | 30                                 | 3.80                                     | 4.40  | 3.30   | 3.70 |
| SWPA5040S3R9NT    | 3.9±30%                         | 0.035                 | 0.027 | 29                                 | 3.55                                     | 4.20  | 3.20   | 3.70 |
| SWPA5040S3R9NT    | 3.9±30%                         | 0.035                 | 0.027 | 29                                 | 3.55                                     | 4.20  | 3.20   | 3.70 |
| SWPA5040S4R7NT    | 4.7±30%                         | 0.039                 | 0.030 | 28                                 | 3.50                                     | 3.90  | 3.00   | 3.30 |
| SWPA5040S5R6MT    | 5.6±20%                         | 0.046                 | 0.035 | 27                                 | 3.00                                     | 3.70  | 2.80   | 3.10 |
| SWPA5040S6R8MT    | 6.8±20%                         | 0.056                 | 0.043 | 21                                 | 2.90                                     | 3.50  | 2.50   | 2.80 |
| SWPA5040S8R2MT    | 8.2±20%                         | 0.062                 | 0.048 | 20                                 | 2.70                                     | 3.00  | 2.30   | 2.60 |
| SWPA5040S100MT    | 10±20%                          | 0.083                 | 0.064 | 18                                 | 2.35                                     | 2.90  | 2.10   | 2.40 |

## 规格特性

## SPECIFICATIONS

## SWPA5040S Series

| Part Number<br>型号 | Inductance<br>电感量<br>@100kHz,1V | DC Resistance<br>直流电阻 |       | Self-resonant<br>Frequency<br>自谐频率 | Saturation Current<br>饱和电流 <sup>*3</sup> |      | Heat Rating<br>Current<br>温升电流 <sup>*4</sup> |      |
|-------------------|---------------------------------|-----------------------|-------|------------------------------------|--|------|--|------|
|                   |                                 | Max.                  | Typ.  |                                    | Min.                                     | Max. | Typ.   | Max. |
| Units 单位          | μH                              | Ω                     |       | MHz                                | A  |      | A  |      |
| Symbol 符号         | L                               | DCR                   |       | S.R.F                              | Isat                                     |      | Irms   |      |
| SWPA5040S120MT    | 12±20%                          | 0.100                 | 0.077 | 14                                 | 2.20                                     | 2.50 | 2.00   | 2.10 |
| SWPA5040S150MT    | 15±20%                          | 0.112                 | 0.086 | 13                                 | 2.00                                     | 2.30 | 2.00   | 2.10 |
| SWPA5040S180MT    | 18±20%                          | 0.155                 | 0.119 | 12                                 | 1.70                                     | 2.00 | 1.45   | 1.65 |
| SWPA5040S220MT    | 22±20%                          | 0.168                 | 0.129 | 11                                 | 1.60                                     | 1.90 | 1.50   | 1.60 |
| SWPA5040S270MT    | 27±20%                          | 0.244                 | 0.188 | 9.8                                | 1.52                                     | 1.75 | 1.10   | 1.25 |
| SWPA5040S330MT    | 33±20%                          | 0.244                 | 0.188 | 9                                  | 1.30                                     | 1.50 | 1.20   | 1.40 |
| SWPA5040S470MT    | 47±20%                          | 0.354                 | 0.272 | 7                                  | 1.10                                     | 1.30 | 1.00   | 1.10 |
| SWPA5040S510MT    | 51±20%                          | 0.494                 | 0.380 | 6                                  | 1.00                                     | 1.20 | 1.00   | 1.10 |
| SWPA5040S560MT    | 56±20%                          | 0.494                 | 0.380 | 6                                  | 1.05                                     | 1.20 | 0.80   | 0.90 |
| SWPA5040S680MT    | 68±20%                          | 0.520                 | 0.40  | 6                                  | 0.90                                     | 1.10 | 0.80   | 0.90 |
| SWPA5040S750MT    | 75±20%                          | 0.585                 | 0.450 | 6                                  | 0.85                                     | 0.95 | 0.72   | 0.80 |
| SWPA5040S101MT    | 100±20%                         | 0.728                 | 0.560 | 5                                  | 0.75                                     | 0.85 | 0.70   | 0.80 |
| SWPA5040S151MT    | 150±20%                         | 0.975                 | 0.750 | 3.7                                | 0.65                                     | 0.67 | 0.60   | 0.70 |
| SWPA5040S221MT    | 220±20%                         | 1.820                 | 1.400 | 3.0                                | 0.48                                     | 0.55 | 0.40   | 0.50 |
| SWPA5040S301MT    | 300±20%                         | 2.600                 | 2.000 | 2.7                                | 0.50                                     | 0.58 | 0.35   | 0.40 |
| SWPA5040S331MT    | 330±20%                         | 2.730                 | 2.100 | 2.7                                | 0.42                                     | 0.47 | 0.40   | 0.50 |
| SWPA5040S471MT    | 470±20%                         | 3.900                 | 3.000 | 2.7                                | 0.37                                     | 0.43 | 0.35   | 0.40 |
| SWPA5040S561MT    | 560±20%                         | 4.914                 | 3.780 | 1.52                               | 0.31                                     | 0.36 | 0.31   | 0.35 |
| SWPA5040S681MT    | 680±20%                         | 5.070                 | 3.900 | 1.60                               | 0.30                                     | 0.35 | 0.25   | 0.30 |

## SWPA5045S Series

| Part Number<br>型号 | Inductance<br>电感量<br>@100kHz,1V | DC Resistance<br>直流电阻 |       | Self-resonant<br>Frequency<br>自谐频率 | Saturation Current<br>饱和电流 <sup>*3</sup> |      | Heat Rating<br>Current<br>温升电流 <sup>*4</sup> |      |
|-------------------|---------------------------------|-----------------------|-------|------------------------------------|--|------|--|------|
|                   |                                 | Max.                  | Typ.  |                                    | Min.                                     | Typ. | Typ.   | Typ. |
| Units 单位          | μH                              | Ω                     |       | MHz                                | A  |      | A  |      |
| Symbol 符号         | L                               | DCR                   |       | S.R.F                              | Isat                                     |      | Irms   |      |
| SWPA5045S1R5NT    | 1.5±30%                         | 0.022                 | 0.017 | 78                                 | 7.40                                     | 8.50 | 5.20   | 5.90 |
| SWPA5045S2R2NT    | 2.2±20%                         | 0.029                 | 0.022 | 50                                 | 6.40                                     | 7.20 | 4.70   | 5.40 |
| SWPA5045S3R3MT    | 3.3±20%                         | 0.035                 | 0.027 | 36                                 | 6.40                                     | 7.20 | 4.20   | 4.85 |
| SWPA5045S100MT    | 10±20%                          | 0.079                 | 0.061 | 17                                 | 3.20                                     | 3.70 | 2.50   | 2.90 |
| SWPA5045S220MT    | 22±20%                          | 0.163                 | 0.125 | 10                                 | 2.00                                     | 2.35 | 1.55   | 1.80 |

## SWPA6020S Series

| Part Number<br>型号 | Inductance<br>电感量<br>@100kHz,1V | DC Resistance<br>直流电阻 |       | Self-resonant<br>Frequency<br>自谐频率 | Saturation Current<br>饱和电流 <sup>*3</sup> |      | Heat Rating<br>Current<br>温升电流 <sup>*4</sup> |      |
|-------------------|---------------------------------|-----------------------|-------|------------------------------------|--|------|--|------|
|                   |                                 | Max.                  | Typ.  |                                    | Min.                                     | Max. | Typ.   | Max. |
| Units 单位          | μH                              | Ω                     |       | MHz                                | A  |      | A  |      |
| Symbol 符号         | L                               | DCR                   |       | S.R.F                              | Isat                                     |      | Irms   |      |
| SWPA6020SR50NT    | 0.50±30%                        | 0.018                 | 0.014 | 120                                | 4.50                                     | 6.00 | 4.00   | 5.00 |
| SWPA6020SR68NT    | 0.68±30%                        | 0.022                 | 0.017 | 115                                | 6.55                                     | 7.80 | 3.80   | 4.80 |
| SWPA6020SR82NT    | 0.82±30%                        | 0.022                 | 0.017 | 110                                | 5.30                                     | 6.30 | 3.80   | 4.80 |
| SWPA6020S1R0NT    | 1.0±30%                         | 0.026                 | 0.020 | 100                                | 4.15                                     | 5.00 | 3.50   | 4.40 |
| SWPA6020S1R2NT    | 1.2±30%                         | 0.029                 | 0.022 | 88                                 | 5.90                                     | 7.00 | 3.20   | 4.00 |
| SWPA6020S1R5NT    | 1.5±30%                         | 0.029                 | 0.022 | 79                                 | 4.25                                     | 5.10 | 3.20   | 4.00 |
| SWPA6020S1R8NT    | 1.8±30%                         | 0.036                 | 0.028 | 68                                 | 4.85                                     | 5.80 | 2.75   | 3.50 |
| SWPA6020S2R0NT    | 2.0±30%                         | 0.046                 | 0.035 | 65                                 | 4.10                                     | 4.90 | 2.60   | 3.30 |

## 规格特性

## SPECIFICATIONS

## SWPA6020S Series

| Part Number<br>型号 | Inductance<br>电感量<br>@100kHz,1V | DC Resistance<br>直流电阻 |       | Self-resonant<br>Frequency<br>自谐频率 | Saturation Current<br>饱和电流 <sup>*3</sup> |      | Heat Rating<br>Current<br>温升电流 <sup>*4</sup> |      |
|-------------------|---------------------------------|-----------------------|-------|------------------------------------|--|------|--|------|
|                   |                                 | Max.                  | Typ.  |                                    | Max.                                     | Typ. | Max.   | Typ. |
| Units 单位          | μH                              | Ω                     |       | MHz                                | A  |      | A  |      |
| Symbol 符号         | L                               | DCR                   |       | S.R.F                              | Isat                                     |      | Irms   |      |
| SWPA6020S2R2NT    | 2.2±30%                         | 0.036                 | 0.028 | 61                                 | 3.75                                     | 4.50 | 2.75   | 3.50 |
| SWPA6020S2R7NT    | 2.7±30%                         | 0.046                 | 0.035 | 56                                 | 3.90                                     | 4.60 | 2.60   | 3.30 |
| SWPA6020S3R3NT    | 3.3±30%                         | 0.046                 | 0.035 | 51                                 | 3.15                                     | 3.70 | 2.60   | 3.30 |
| SWPA6020S3R9NT    | 3.9±30%                         | 0.064                 | 0.049 | 45                                 | 3.25                                     | 3.90 | 2.10   | 2.60 |
| SWPA6020S4R3NT    | 4.3±30%                         | 0.064                 | 0.049 | 44                                 | 2.70                                     | 3.20 | 2.10   | 2.60 |
| SWPA6020S4R7NT    | 4.7±30%                         | 0.075                 | 0.058 | 41                                 | 3.00                                     | 3.60 | 2.00   | 2.50 |
| SWPA6020S5R6NT    | 5.6±30%                         | 0.075                 | 0.058 | 36                                 | 2.40                                     | 2.90 | 1.90   | 2.40 |
| SWPA6020S6R2NT    | 6.2±30%                         | 0.103                 | 0.079 | 31                                 | 2.30                                     | 2.70 | 1.80   | 2.30 |
| SWPA6020S6R8NT    | 6.8±30%                         | 0.103                 | 0.079 | 31                                 | 2.20                                     | 2.60 | 1.80   | 2.30 |
| SWPA6020S8R2NT    | 8.2±30%                         | 0.137                 | 0.105 | 27                                 | 2.10                                     | 2.50 | 1.40   | 1.80 |
| SWPA6020S100MT    | 10±20%                          | 0.137                 | 0.105 | 27                                 | 1.75                                     | 2.10 | 1.40   | 1.80 |
| SWPA6020S120MT    | 12±20%                          | 0.156                 | 0.120 | 25                                 | 1.45                                     | 1.70 | 1.30   | 1.60 |
| SWPA6020S150MT    | 15±20%                          | 0.189                 | 0.145 | 21                                 | 1.20                                     | 1.40 | 1.20   | 1.50 |
| SWPA6020S180MT    | 18±20%                          | 0.234                 | 0.180 | 18                                 | 1.20                                     | 1.40 | 1.08   | 1.40 |
| SWPA6020S220MT    | 22±20%                          | 0.265                 | 0.204 | 16                                 | 1.05                                     | 1.20 | 1.00   | 1.30 |
| SWPA6020S330MT    | 33±20%                          | 0.390                 | 0.30  | 11                                 | 0.95                                     | 1.10 | 0.84   | 1.05 |
| SWPA6020S470MT    | 47±20%                          | 0.559                 | 0.430 | 10                                 | 0.70                                     | 0.90 | 0.80   | 0.90 |

## SWPA6028S Series

| Part Number<br>型号 | Inductance<br>电感量<br>@100kHz,1V | DC Resistance<br>直流电阻 |       | Self-resonant<br>Frequency<br>自谐频率 | Saturation Current<br>饱和电流 <sup>*3</sup> |      | Heat Rating<br>Current<br>温升电流 <sup>*4</sup> |      |
|-------------------|---------------------------------|-----------------------|-------|------------------------------------|--|------|--|------|
|                   |                                 | Max.                  | Typ.  |                                    | Max.                                     | Typ. | Max.   | Typ. |
| Units 单位          | μH                              | Ω                     |       | MHz                                | A  |      | A  |      |
| Symbol 符号         | L                               | DCR                   |       | S.R.F                              | Isat                                     |      | Irms   |      |
| SWPA6028SR82NT    | 0.82±30%                        | 0.016                 | 0.012 | 97                                 | 6.50                                     | 9.00 | 5.20   | 6.00 |
| SWPA6028S1R0NT    | 1.0±30%                         | 0.013                 | 0.010 | 70                                 | 5.75                                     | 7.00 | 5.20   | 5.70 |
| SWPA6028S1R2NT    | 1.2±30%                         | 0.017                 | 0.013 | 69                                 | 6.40                                     | 7.50 | 4.58   | 5.00 |
| SWPA6028S1R5NT    | 1.5±30%                         | 0.017                 | 0.013 | 65                                 | 6.00                                     | 6.60 | 4.58   | 5.00 |
| SWPA6028S2R2NT    | 2.2±30%                         | 0.026                 | 0.020 | 48                                 | 5.10                                     | 5.60 | 3.75   | 4.10 |
| SWPA6028S2R7NT    | 2.7±30%                         | 0.026                 | 0.020 | 48                                 | 3.80                                     | 4.10 | 3.75   | 4.10 |
| SWPA6028S3R3NT    | 3.3±30%                         | 0.033                 | 0.025 | 41                                 | 4.15                                     | 4.50 | 3.48   | 3.80 |
| SWPA6028S4R7NT    | 4.7±30%                         | 0.039                 | 0.030 | 35                                 | 3.00                                     | 3.30 | 3.08   | 3.40 |
| SWPA6028S5R1NT    | 5.1±30%                         | 0.056                 | 0.043 | 32                                 | 3.20                                     | 3.50 | 2.60   | 2.80 |
| SWPA6028S6R2MT    | 6.2±20%                         | 0.061                 | 0.047 | 30                                 | 3.05                                     | 3.30 | 2.40   | 2.60 |
| SWPA6028S6R8MT    | 6.8±20%                         | 0.061                 | 0.047 | 27                                 | 2.60                                     | 3.00 | 2.40   | 2.60 |
| SWPA6028S8R2MT    | 8.2±20%                         | 0.072                 | 0.055 | 24                                 | 2.30                                     | 2.50 | 2.25   | 2.50 |
| SWPA6028S9R1MT    | 9.1±20%                         | 0.096                 | 0.074 | 24                                 | 2.55                                     | 2.80 | 2.15   | 2.40 |
| SWPA6028S100MT    | 10±20%                          | 0.094                 | 0.072 | 23                                 | 2.04                                     | 2.50 | 1.95   | 2.40 |
| SWPA6028S120MT    | 12±20%                          | 0.104                 | 0.080 | 18                                 | 1.80                                     | 2.00 | 1.85   | 2.00 |
| SWPA6028S150MT    | 15±20%                          | 0.163                 | 0.125 | 18                                 | 1.75                                     | 1.90 | 1.45   | 1.60 |
| SWPA6028S180MT    | 18±20%                          | 0.156                 | 0.120 | 15                                 | 1.52                                     | 1.80 | 1.45   | 1.60 |
| SWPA6028S220MT    | 22±20%                          | 0.182                 | 0.140 | 14                                 | 1.45                                     | 1.80 | 1.40   | 1.60 |
| SWPA6028S270MT    | 27±20%                          | 0.202                 | 0.155 | 13                                 | 1.50                                     | 1.60 | 1.32   | 1.40 |
| SWPA6028S330MT    | 33±20%                          | 0.241                 | 0.185 | 12                                 | 1.35                                     | 1.50 | 1.22   | 1.30 |
| SWPA6028S360MT    | 36±20%                          | 0.280                 | 0.215 | 11                                 | 1.25                                     | 1.40 | 1.13   | 1.20 |
| SWPA6028S390MT    | 39±20%                          | 0.293                 | 0.225 | 11                                 | 1.25                                     | 1.40 | 1.10   | 1.20 |
| SWPA6028S470MT    | 47±20%                          | 0.410                 | 0.315 | 9.5                                | 1.15                                     | 1.30 | 1.06   | 1.10 |
| SWPA6028S560MT    | 56±20%                          | 0.449                 | 0.345 | 8.2                                | 1.05                                     | 1.20 | 0.89   | 1.00 |

## 规格特性

## SPECIFICATIONS

## SWPA6028S Series

| Part Number<br>型号 | Inductance<br>电感量 | DC Resistance<br>直流电阻 |       | Self-resonant<br>Frequency<br>自谐振频率 | Saturation Current<br>饱和电流 <sup>*3</sup> |      | Heat Rating<br>Current<br>温升电流 <sup>*4</sup> |      |
|-------------------|-------------------|-----------------------|-------|-------------------------------------|--|------|--|------|
|                   |                   | Max.                  | Typ.  |                                     | Max.                                     | Typ. | Max.   | Typ. |
| Units 单位          | @100kHz,1V<br>μH  | Ω                     |       | MHz                                 | A  |      | A  |      |
| Symbol 符号         | L                 | DCR                   |       | S.R.F                               | Isat                                     |      | Irms   |      |
| SWPA6028S680MT    | 68±20%            | 0.468                 | 0.360 | 7.7                                 | 0.80                                     | 0.95 | 0.86   | 0.95 |
| SWPA6028S750MT    | 75±20%            | 0.533                 | 0.410 | 7.7                                 | 0.90                                     | 0.99 | 0.81   | 0.90 |
| SWPA6028S820MT    | 82±20%            | 0.650                 | 0.50  | 7.7                                 | 0.80                                     | 0.88 | 0.70   | 0.77 |
| SWPA6028S101MT    | 100±20%           | 0.650                 | 0.50  | 7.1                                 | 0.65                                     | 0.71 | 0.70   | 0.77 |
| SWPA6028S401MT    | 400±20%           | 2.808                 | 2.160 | 2.8                                 | 0.30                                     | 0.33 | 0.40   | 0.45 |

## SWPA6045S Series

| Part Number<br>型号 | Inductance<br>电感量 | DC Resistance<br>直流电阻 |       | Self-resonant<br>Frequency<br>自谐振频率 | Saturation Current<br>饱和电流 <sup>*3</sup> |       | Heat Rating<br>Current<br>温升电流 <sup>*4</sup> |      |
|-------------------|-------------------|-----------------------|-------|-------------------------------------|--|-------|--|------|
|                   |                   | Max.                  | Typ.  |                                     | Max.                                     | Typ.  | Max.   | Typ. |
| Units 单位          | @100kHz,1V<br>μH  | Ω                     |       | MHz                                 | A  |       | A  |      |
| Symbol 符号         | L                 | DCR                   |       | S.R.F                               | Isat                                     |       | Irms   |      |
| SWPA6045SR47NT    | 0.47±30%          | 0.008                 | 0.006 | 155                                 | 15.00                                    | 16.50 | 6.50   | 6.60 |
| SWPA6045SR56NT    | 0.56±30%          | 0.008                 | 0.006 | 142                                 | 14.00                                    | 15.00 | 6.50   | 7.50 |
| SWPA6045SR68NT    | 0.68±30%          | 0.008                 | 0.006 | 99                                  | 11.00                                    | 12.00 | 5.70   | 6.50 |
| SWPA6045SR82NT    | 0.82±30%          | 0.010                 | 0.008 | 140                                 | 10.35                                    | 11.00 | 5.90   | 6.50 |
| SWPA6045S1R0NT    | 1.0±30%           | 0.014                 | 0.011 | 100                                 | 9.85                                     | 10.00 | 5.14   | 5.60 |
| SWPA6045S1R2NT    | 1.2±30%           | 0.013                 | 0.010 | 100                                 | 8.35                                     | 9.10  | 5.40   | 5.90 |
| SWPA6045S1R3NT    | 1.3±30%           | 0.013                 | 0.010 | 100                                 | 8.35                                     | 9.10  | 5.40   | 5.90 |
| SWPA6045S1R5NT    | 1.5±30%           | 0.016                 | 0.012 | 65                                  | 8.80                                     | 9.70  | 4.95   | 5.40 |
| SWPA6045S1R8NT    | 1.8±30%           | 0.016                 | 0.012 | 74                                  | 7.60                                     | 8.40  | 4.95   | 5.40 |
| SWPA6045S2R2NT    | 2.2±30%           | 0.018                 | 0.014 | 52                                  | 6.75                                     | 7.40  | 4.60   | 5.00 |
| SWPA6045S2R3NT    | 2.3±30%           | 0.027                 | 0.021 | 60                                  | 6.00                                     | 6.60  | 3.50   | 3.80 |
| SWPA6045S2R7NT    | 2.7±30%           | 0.020                 | 0.015 | 38                                  | 5.75                                     | 6.30  | 4.30   | 4.70 |
| SWPA6045S3R0NT    | 3.0±30%           | 0.026                 | 0.020 | 35                                  | 5.60                                     | 6.20  | 3.80   | 4.20 |
| SWPA6045S3R3NT    | 3.3±30%           | 0.027                 | 0.021 | 32                                  | 5.90                                     | 6.20  | 3.70   | 4.00 |
| SWPA6045S3R6NT    | 3.6±30%           | 0.027                 | 0.021 | 28                                  | 5.25                                     | 5.70  | 3.70   | 4.00 |
| SWPA6045S4R3MT    | 4.3±20%           | 0.030                 | 0.023 | 23                                  | 4.45                                     | 4.90  | 3.50   | 3.80 |
| SWPA6045S4R5MT    | 4.5±20%           | 0.034                 | 0.026 | 24                                  | 4.97                                     | 5.50  | 3.30   | 3.60 |
| SWPA6045S4R7MT    | 4.7±20%           | 0.034                 | 0.026 | 24                                  | 4.97                                     | 5.50  | 3.30   | 3.60 |
| SWPA6045S5R1MT    | 5.1±20%           | 0.034                 | 0.026 | 23                                  | 4.40                                     | 4.80  | 3.30   | 3.60 |
| SWPA6045S5R6MT    | 5.6±20%           | 0.038                 | 0.029 | 23                                  | 4.15                                     | 4.60  | 3.15   | 3.40 |
| SWPA6045S6R2MT    | 6.2±20%           | 0.040                 | 0.031 | 26                                  | 4.43                                     | 4.80  | 3.00   | 3.30 |
| SWPA6045S6R3MT    | 6.3±20%           | 0.040                 | 0.031 | 26                                  | 4.43                                     | 4.70  | 3.00   | 3.30 |
| SWPA6045S6R8MT    | 6.8±20%           | 0.040                 | 0.031 | 20                                  | 3.90                                     | 4.30  | 3.00   | 3.30 |
| SWPA6045S7R5MT    | 7.5±20%           | 0.044                 | 0.034 | 18                                  | 3.50                                     | 3.80  | 2.90   | 3.20 |
| SWPA6045S8R2MT    | 8.2±20%           | 0.056                 | 0.043 | 21                                  | 3.90                                     | 4.30  | 2.60   | 2.80 |
| SWPA6045S9R1MT    | 9.1±20%           | 0.056                 | 0.043 | 17                                  | 3.35                                     | 3.70  | 2.60   | 2.80 |
| SWPA6045S100MT    | 10±20%            | 0.062                 | 0.048 | 15                                  | 3.20                                     | 3.50  | 2.45   | 2.70 |
| SWPA6045S120MT    | 12±20%            | 0.075                 | 0.058 | 13                                  | 2.80                                     | 3.00  | 2.20   | 2.40 |
| SWPA6045S150MT    | 15±20%            | 0.088                 | 0.068 | 12                                  | 2.50                                     | 2.70  | 2.05   | 2.20 |
| SWPA6045S180MT    | 18±20%            | 0.105                 | 0.081 | 10                                  | 2.20                                     | 2.40  | 1.85   | 2.00 |
| SWPA6045S220MT    | 22±20%            | 0.116                 | 0.089 | 10                                  | 2.05                                     | 2.20  | 1.80   | 2.00 |
| SWPA6045S270MT    | 27±20%            | 0.133                 | 0.102 | 9.2                                 | 1.90                                     | 2.10  | 1.65   | 1.80 |
| SWPA6045S300MT    | 30±20%            | 0.172                 | 0.132 | 7.8                                 | 1.70                                     | 1.80  | 1.50   | 1.60 |
| SWPA6045S330MT    | 33±20%            | 0.178                 | 0.137 | 7.8                                 | 1.65                                     | 1.80  | 1.45   | 1.60 |

## 规格特性

## SPECIFICATIONS

## SWPA6045S Series

| Part Number<br>型号 | Inductance<br>电感量<br>@100kHz,1V | DC Resistance<br>直流电阻 |       | Self-resonant<br>Frequency<br>自谐频率<br>Min. | Saturation Current<br>饱和电流 <sup>*3</sup> |       | Heat Rating<br>Current<br>温升电流 <sup>*4</sup> |       |
|-------------------|---------------------------------|-----------------------|-------|--|--|-------|--|-------|
|                   |                                 | Max.                  | Typ.  |  | Max.                                     | Typ.  | Max.   | Typ.  |
| Units 单位          | μH                              | Ω                     |       | MHz  | A  |       | A  |       |
| Symbol 符号         | L                               | DCR                   |       | S.R.F                                      | Isat                                     |       | Irms   |       |
| SWPA6045S360MT    | 36±20%                          | 0.225                 | 0.173 | 7.8  | 1.62                                     | 1.80  | 1.40   | 1.50  |
| SWPA6045S390MT    | 39±20%                          | 0.234                 | 0.180 | 7.8  | 1.50                                     | 1.60  | 1.25   | 1.40  |
| SWPA6045S430MT    | 43±20%                          | 0.260                 | 0.20  | 7.7  | 1.63                                     | 1.80  | 1.20   | 1.30  |
| SWPA6045S470MT    | 47±20%                          | 0.260                 | 0.20  | 6.4  | 1.40                                     | 1.50  | 1.20   | 1.30  |
| SWPA6045S510MT    | 51±20%                          | 0.269                 | 0.207 | 6.4  | 1.35                                     | 1.50  | 1.15   | 1.20  |
| SWPA6045S560MT    | 56±20%                          | 0.287                 | 0.221 | 6.4  | 1.30                                     | 1.40  | 1.10   | 1.20  |
| SWPA6045S620MT    | 62±20%                          | 0.306                 | 0.235 | 6.4  | 1.25                                     | 1.40  | 1.10   | 1.20  |
| SWPA6045S680MT    | 68±20%                          | 0.376                 | 0.289 | 6.4  | 1.20                                     | 1.30  | 1.00   | 1.10  |
| SWPA6045S750MT    | 75±20%                          | 0.397                 | 0.305 | 5  | 1.15                                     | 1.20  | 0.95   | 1.00  |
| SWPA6045S820MT    | 82±20%                          | 0.443                 | 0.341 | 4.9  | 1.05                                     | 1.10  | 0.90   | 0.99  |
| SWPA6045S910MT    | 91±20%                          | 0.467                 | 0.359 | 4.9  | 1.00                                     | 1.10  | 0.85   | 0.94  |
| SWPA6045S101MT    | 100±20%                         | 0.563                 | 0.433 | 4.2  | 0.95                                     | 1.00  | 0.80   | 0.88  |
| SWPA6045S121MT    | 120±20%                         | 0.629                 | 0.484 | 4.2  | 0.85                                     | 0.94  | 0.77   | 0.85  |
| SWPA6045S151MT    | 150±20%                         | 0.754                 | 0.580 | 4.2  | 0.80                                     | 0.88  | 0.70   | 0.77  |
| SWPA6045S221MT    | 220±20%                         | 1.084                 | 0.834 | 3.5  | 0.70                                     | 0.77  | 0.59   | 0.65  |
| SWPA6045S331MT    | 330±20%                         | 1.651                 | 1.270 | 2.8  | 0.57                                     | 0.63  | 0.57   | 0.63  |
| SWPA6045S471MT    | 470±20%                         | 2.340                 | 1.80  | 2.0  | 0.500                                    | 0.560 | 0.420  | 0.480 |
| SWPA6045S681MT    | 680±20%                         | 3.250                 | 2.50  | 1.7  | 0.420                                    | 0.460 | 0.330  | 0.380 |

## SWPA8040S Series

| Part Number<br>型号 | Inductance<br>电感量<br>@100kHz,1V | DC Resistance<br>直流电阻 |       | Self-resonant<br>Frequency<br>自谐频率<br>Min. | Saturation Current<br>饱和电流 <sup>*3</sup> |       | Heat Rating<br>Current<br>温升电流 <sup>*4</sup> |      |
|-------------------|---------------------------------|-----------------------|-------|--|--|-------|--|------|
|                   |                                 | Max.                  | Typ.  |  | Max.                                     | Typ.  | Max.   | Typ. |
| Units 单位          | μH                              | Ω                     |       | MHz  | A  |       | A  |      |
| Symbol 符号         | L                               | DCR                   |       | S.R.F                                      | Isat                                     |       | Irms   |      |
| SWPA8040SR82NT    | 0.82±30%                        | 0.010                 | 0.008 | 94   | 13.80                                    | 16.00 | 6.30   | 6.90 |
| SWPA8040S1R0NT    | 1.0±30%                         | 0.010                 | 0.008 | 89   | 9.85                                     | 14.00 | 6.30   | 6.90 |
| SWPA8040S1R2NT    | 1.2±30%                         | 0.013                 | 0.010 | 59   | 10.00                                    | 14.00 | 5.65   | 6.20 |
| SWPA8040S1R5NT    | 1.5±30%                         | 0.013                 | 0.010 | 67   | 8.15                                     | 11.00 | 5.65   | 6.20 |
| SWPA8040S2R0NT    | 2.0±30%                         | 0.016                 | 0.012 | 43   | 9.25                                     | 10.00 | 5.15   | 5.60 |
| SWPA8040S2R2NT    | 2.2±30%                         | 0.016                 | 0.012 | 41   | 7.10                                     | 8.00  | 5.15   | 5.60 |
| SWPA8040S3R0NT    | 3.0±30%                         | 0.018                 | 0.014 | 32   | 6.10                                     | 7.00  | 4.70   | 5.20 |
| SWPA8040S3R3NT    | 3.3±30%                         | 0.022                 | 0.017 | 27   | 6.50                                     | 7.00  | 4.40   | 4.80 |
| SWPA8040S3R6NT    | 3.6±30%                         | 0.022                 | 0.017 | 30   | 7.52                                     | 8.50  | 4.35   | 4.80 |
| SWPA8040S3R9NT    | 3.9±30%                         | 0.022                 | 0.017 | 26   | 5.75                                     | 6.50  | 4.35   | 4.80 |
| SWPA8040S4R7NT    | 4.7±30%                         | 0.025                 | 0.019 | 24   | 5.90                                     | 6.50  | 4.10   | 4.50 |
| SWPA8040S5R1NT    | 5.1±30%                         | 0.025                 | 0.019 | 22   | 4.70                                     | 5.40  | 4.05   | 4.40 |
| SWPA8040S5R6NT    | 5.6±30%                         | 0.027                 | 0.021 | 24   | 6.00                                     | 6.90  | 3.85   | 4.20 |
| SWPA8040S6R2NT    | 6.2±30%                         | 0.027                 | 0.021 | 20   | 4.45                                     | 5.10  | 3.85   | 4.20 |
| SWPA8040S6R8MT    | 6.8±20%                         | 0.031                 | 0.024 | 20   | 4.55                                     | 5.20  | 3.60   | 4.00 |
| SWPA8040S8R2MT    | 8.2±20%                         | 0.034                 | 0.026 | 17   | 4.20                                     | 4.80  | 3.45   | 3.80 |
| SWPA8040S100MT    | 10±20%                          | 0.038                 | 0.029 | 15   | 3.60                                     | 4.10  | 3.30   | 3.60 |
| SWPA8040S120MT    | 12±20%                          | 0.053                 | 0.041 | 13   | 3.50                                     | 4.00  | 2.80   | 3.00 |
| SWPA8040S150MT    | 15±20%                          | 0.061                 | 0.047 | 12   | 2.95                                     | 3.40  | 2.60   | 2.80 |
| SWPA8040S180MT    | 18±20%                          | 0.069                 | 0.053 | 11   | 2.70                                     | 3.10  | 2.40   | 2.60 |
| SWPA8040S220MT    | 22±20%                          | 0.090                 | 0.069 | 9.5  | 2.40                                     | 2.70  | 2.10   | 2.30 |
| SWPA8040S270MT    | 27±20%                          | 0.101                 | 0.078 | 9.2  | 2.15                                     | 2.50  | 2.00   | 2.20 |
| SWPA8040S330MT    | 33±20%                          | 0.126                 | 0.097 | 7.8  | 2.05                                     | 2.40  | 1.80   | 2.00 |

## 规格特性

## SPECIFICATIONS

## SWPA8060S Series

| Part Number<br>型号 | Inductance<br>电感量<br>@100kHz,1V | DC Resistance<br>直流电阻 |       | Self-resonant<br>Frequency<br>自谐频率 | Saturation Current<br>饱和电流 <sup>*3</sup> |      | Heat Rating<br>Current<br>温升电流 <sup>*4</sup> |      |
|-------------------|---------------------------------|-----------------------|-------|------------------------------------|--|------|--|------|
|                   |                                 | Max.                  | Typ.  |                                    | Min.                                     | Max. | Typ.   | Max. |
| Units 单位          | μH                              | Ω                     |       | MHz                                | A  |      | A  |      |
| Symbol 符号         | L                               | DCR                   |       | S.R.F                              | Isat                                     |      | Irms   |      |
| SWPA8040S360MT    | 36±20%                          | 0.133                 | 0.102 | 7.8                                | 2.00                                     | 2.30 | 1.75   | 1.90 |
| SWPA8040S390MT    | 39±20%                          | 0.139                 | 0.107 | 7.8                                | 1.95                                     | 2.20 | 1.70   | 1.90 |
| SWPA8040S430MT    | 43±20%                          | 0.147                 | 0.113 | 7.8                                | 1.90                                     | 2.20 | 1.65   | 1.80 |
| SWPA8040S470MT    | 47±20%                          | 0.177                 | 0.136 | 6.4                                | 1.75                                     | 2.00 | 1.55   | 1.70 |
| SWPA8040S510MT    | 51±20%                          | 0.185                 | 0.142 | 6.4                                | 1.70                                     | 1.90 | 1.50   | 1.60 |
| SWPA8040S560MT    | 56±20%                          | 0.192                 | 0.148 | 6.4                                | 1.55                                     | 1.70 | 1.45   | 1.60 |
| SWPA8040S620MT    | 62±20%                          | 0.237                 | 0.182 | 6.4                                | 1.50                                     | 1.60 | 1.30   | 1.40 |
| SWPA8040S680MT    | 68±20%                          | 0.255                 | 0.196 | 4.9                                | 1.45                                     | 1.60 | 1.25   | 1.40 |
| SWPA8040S750MT    | 75±20%                          | 0.274                 | 0.211 | 4.9                                | 1.35                                     | 1.50 | 1.20   | 1.30 |
| SWPA8040S820MT    | 82±20%                          | 0.293                 | 0.225 | 5.9                                | 1.30                                     | 1.40 | 1.15   | 1.20 |
| SWPA8040S910MT    | 91±20%                          | 0.354                 | 0.272 | 4.9                                | 1.20                                     | 1.30 | 1.05   | 1.10 |
| SWPA8040S101MT    | 100±20%                         | 0.377                 | 0.290 | 4.2                                | 1.15                                     | 1.30 | 1.00   | 1.10 |
| SWPA8040S121MT    | 120±20%                         | 0.434                 | 0.334 | 3.5                                | 1.05                                     | 1.10 | 0.95   | 1.00 |
| SWPA8040S151MT    | 150±20%                         | 0.533                 | 0.410 | 3.5                                | 1.10                                     | 1.20 | 0.85   | 0.94 |
| SWPA8040S181MT    | 180±20%                         | 0.676                 | 0.520 | 3.5                                | 0.95                                     | 1.15 | 0.83   | 0.92 |
| SWPA8040S221MT    | 220±20%                         | 0.779                 | 0.599 | 3.5                                | 0.85                                     | 0.94 | 0.80   | 0.88 |
| SWPA8040S331MT    | 330±20%                         | 1.156                 | 0.889 | 2.8                                | 0.68                                     | 0.75 | 0.64   | 0.70 |
| SWPA8040S471MT    | 470±20%                         | 1.625                 | 1.260 | 2.1                                | 0.60                                     | 0.70 | 0.50   | 0.60 |

## SWPA8060S Series

| Part Number<br>型号 | Inductance<br>电感量<br>@100kHz,1V | DC Resistance<br>直流电阻 |      | Self-resonant<br>Frequency<br>自谐频率 | Saturation Current<br>饱和电流 <sup>*3</sup> |      | Heat Rating<br>Current<br>温升电流 <sup>*4</sup> |      |
|-------------------|---------------------------------|-----------------------|------|------------------------------------|--|------|--|------|
|                   |                                 | Max.                  | Typ. |                                    | Min.                                     | Max. | Typ.   | Max. |
| Units 单位          | μH                              | Ω                     |      | MHz                                | A  |      | A  |      |
| Symbol 符号         | L                               | DCR                   |      | S.R.F                              | Isat                                     |      | Irms   |      |
| SWPA8060S681KTY01 | 680±10%                         | 2.17                  | 1.81 | 1.26                               | 0.72                                     | 0.82 | 0.46   | 0.53 |

## SWPA8065S Series

| Part Number<br>型号 | Inductance<br>电感量<br>@100kHz,1V | DC Resistance<br>直流电阻 |       | Self-resonant<br>Frequency<br>自谐频率 | Saturation Current<br>饱和电流 <sup>*3</sup> |       | Heat Rating<br>Current<br>温升电流 <sup>*4</sup> |      |
|-------------------|---------------------------------|-----------------------|-------|------------------------------------|--|-------|--|------|
|                   |                                 | Max.                  | Typ.  |                                    | Min.                                     | Max.  | Typ.   | Max. |
| Units 单位          | μH                              | Ω                     |       | MHz                                | A  |       | A  |      |
| Symbol 符号         | L                               | DCR                   |       | S.R.F                              | Isat                                     |       | Irms   |      |
| SWPA8065S1R0MT    | 1.0±20%                         | 0.011                 | 0.008 | 96                                 | 20.0                                     | 22.0  | 7.00   | 8.00 |
| SWPA8065S3R3MT    | 3.3±20%                         | 0.018                 | 0.015 | 27                                 | 9.50                                     | 10.00 | 5.10   | 5.90 |
| SWPA8065S4R7MT    | 4.7±20%                         | 0.022                 | 0.018 | 18                                 | 8.50                                     | 9.50  | 4.70   | 5.40 |
| SWPA8065S5R6MT    | 5.6±20%                         | 0.026                 | 0.022 | 17                                 | 8.00                                     | 9.00  | 4.50   | 5.20 |
| SWPA8065S6R8MT    | 6.8±20%                         | 0.026                 | 0.022 | 16                                 | 7.50                                     | 8.00  | 4.50   | 5.20 |
| SWPA8065S8R2MT    | 8.2±20%                         | 0.031                 | 0.026 | 15                                 | 7.00                                     | 7.70  | 4.20   | 4.80 |
| SWPA8065S100MT    | 10±20%                          | 0.044                 | 0.037 | 13                                 | 8.00                                     | 8.90  | 3.20   | 3.70 |
| SWPA8065S220MT    | 22±20%                          | 0.072                 | 0.060 | 8                                  | 4.30                                     | 4.80  | 2.70   | 3.10 |
| SWPA8065S101MT    | 100±20%                         | 0.028                 | 0.233 | 3.1                                | 2.00                                     | 2.40  | 1.35   | 1.45 |
| SWPA8065S151MT    | 150±20%                         | 0.440                 | 0.353 | 2.5                                | 1.60                                     | 2.00  | 0.95   | 1.10 |
| SWPA8065S221MT    | 220±20%                         | 0.656                 | 0.547 | 2.0                                | 1.20                                     | 1.50  | 0.80   | 0.90 |
| SWPA8065S331MT    | 330±20%                         | 0.840                 | 0.700 | 1.7                                | 1.00                                     | 1.20  | 0.75   | 0.85 |
| SWPA8065S431MT    | 430±20%                         | 1.20                  | 1.00  | 1.5                                | 0.95                                     | 1.05  | 0.61   | 0.69 |

- ※1: All test data is referenced to 20 °C ambient;
- ※2: Rated current: Isat or Irms, whichever is smaller;
- ※\*3: Isat: DC current at which the inductance drops approximate 30% from its value without current;
- ※\*4: Irms: DC current that causes the temperature rise ( $\Delta T = 40^\circ\text{C}$ ) from 20 °C ambient.

## 电气特性

## TYPICAL ELECTRICAL CHARACTERISTICS

### SWPA252010S Series

Temperature vs. DC Current Characteristics



Inductance vs. DC Current Characteristics



### SWPA252012S Series

Temperature vs. DC Current Characteristics



Inductance vs. DC Current Characteristics



### SWPA3010S Series

Temperature vs. DC Current Characteristics



Inductance vs. DC Current Characteristics

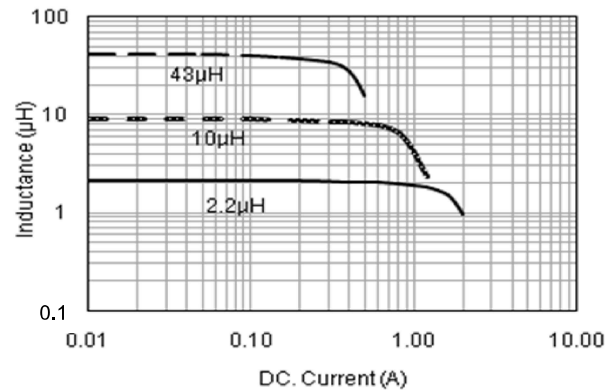

### SWPA3012S Series

Temperature vs. DC Current Characteristics

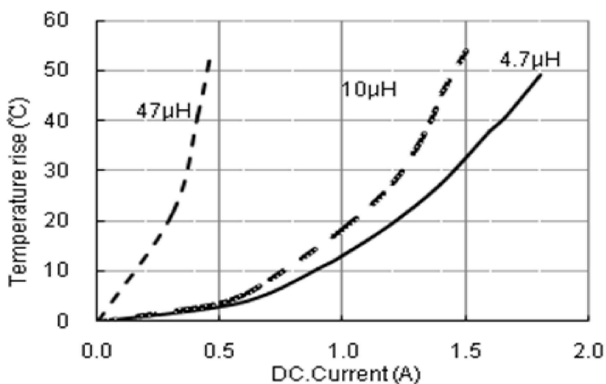

Inductance vs. DC Current Characteristics



# 电气特性

# TYPICAL ELECTRICAL CHARACTERISTICS

## SWPA3015S Series

### Temperature vs. DC Current Characteristics



### Inductance vs. DC Current Characteristics



## SWPA4010S Series

### Temperature vs. DC Current Characteristics



### Inductance vs. DC Current Characteristic



## SWPA4012S Series

### Temperature vs. DC Current Characteristics



### Inductance vs. DC Current Characteristic



## SWPA4018S Series

### Temperature vs. DC Current Characteristics



### Inductance vs. DC Current Characteristics



# 电气特性

# TYPICAL ELECTRICAL CHARACTERISTICS

## SWPA4020S Series

### Temperature vs. DC Current Characteristics



### Inductance vs. DC Current Characteristics



## SWPA4030S Series

### Temperature vs. DC Current Characteristics



### Inductance vs. DC Current Characteristics

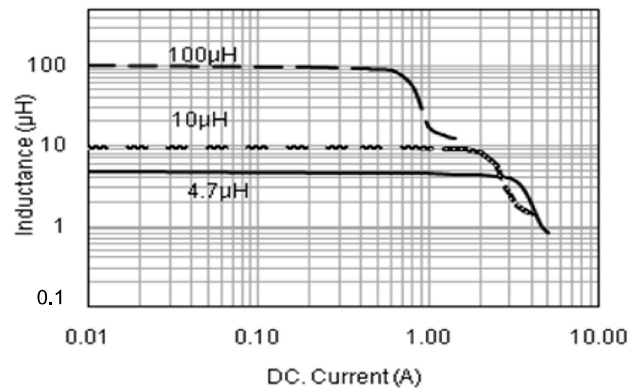

## SWPA5012S Series

### Temperature vs. DC Current Characteristics



### Inductance vs. DC Current Characteristics



## SWPA5020S Series

### Temperature vs. DC Current Characteristics



### Inductance vs. DC Current Characteristics



电气特性

TYPICAL ELECTRICAL CHARACTERISTICS

SWPA5040S Series

Temperature vs. DC Current Characteristics



Inductance vs. DC Current Characteristics

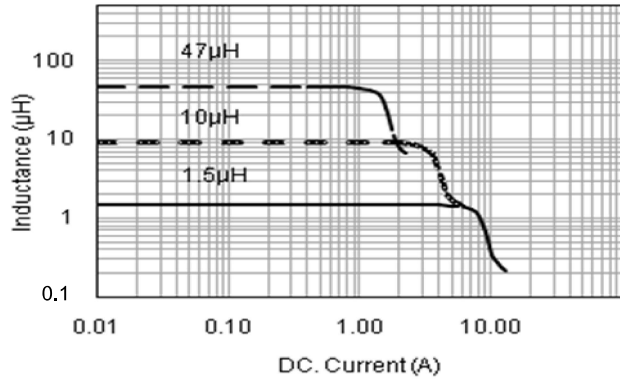

SWPA6020S Series

Temperature vs. DC Current Characteristics



Inductance vs. DC Current Characteristics

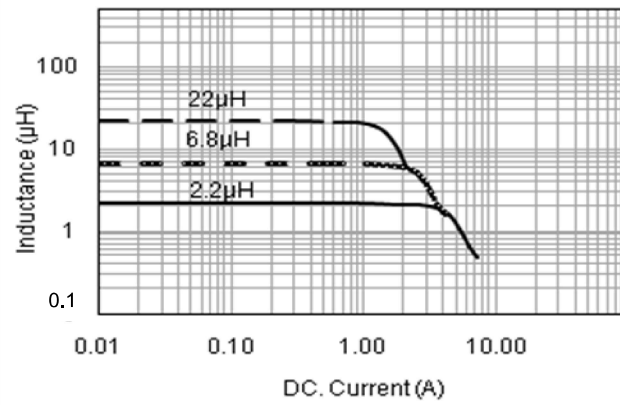

SWPA6028S Series

Temperature vs. DC Current Characteristics

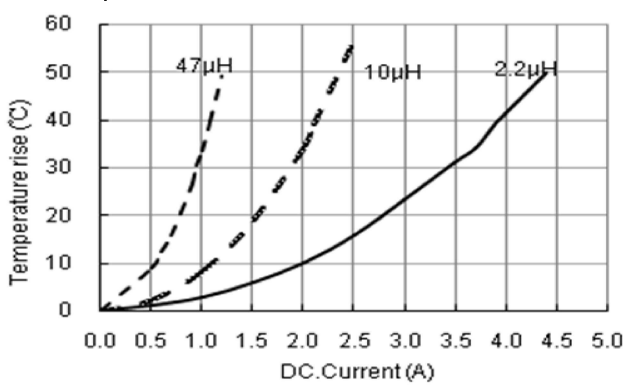

Inductance vs. DC Current Characteristics

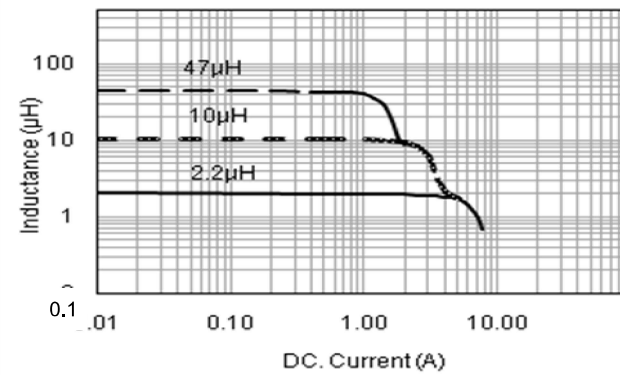

SWPA6045S Series

Temperature vs. DC Current Characteristics

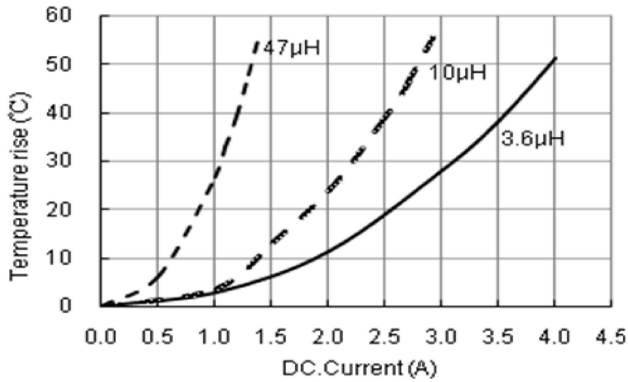

Inductance vs. DC Current Characteristics

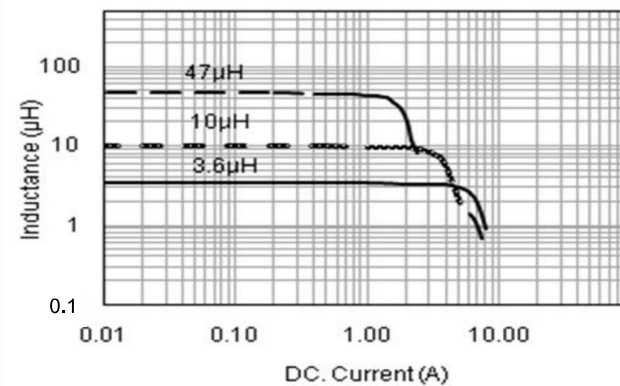

SWPA8040S Series

Temperature vs. DC Current Characteristics



Inductance vs. DC Current Characteristics



SWPA8065S Series

Temperature vs. DC Current Characteristics



Inductance vs. DC Current Characteristics



## Looking for pricing, stock, or lifecycle information?

Click below to explore more details on WIN SOURCE:

 [View SWPA6028S120MT on WIN SOURCE](#)

 [Sunlord Information](#)

## Optimize Your Supply Chain with WIN SOURCE Solutions

-  Global Sourcing Solution
-  Obsolete Management
-  Cost Control Management
-  Shortage Management
-  Alternative Solution
-  Excess Inventory Management