

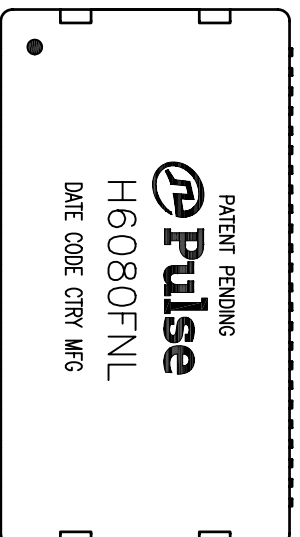

# THE DATASHEET OF H6080FNLT





WITH FLAMMABILITY

+125°C

ITY AT 245°C REFLOW PROFILE

MOISTURE SENSITIVE

MAXIMUM THROUGH REFLOW SOLDER

NG ADD A "T" SUFFIX

NL BECOMES H6080FNLT).

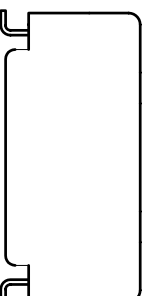
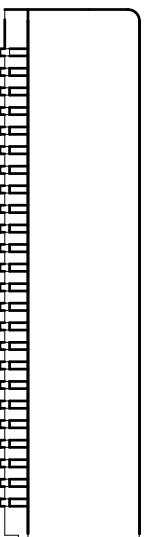

FINAL OUTLINE

All rights reserved. Pulse confidential & proprietary. (06/26/14)

ITLA DRAWING H6080FNLT-10	PS DRAWING PS-2747.001-B	SHEET 1 OF 3	PART NO. H6080FNLT	DATASHEET REV. A
------------------------------	-----------------------------	-----------------	-----------------------	---------------------

ELECTRICAL CHARACTERISTICS AT +25°C UNLESS OTHER SPECIFIED  
MEETS IEEE 802.3 SPECIFICATION

PARAMETER	SPECIFICATIONS	
OPERATING TEMP	0°C - 70 °C	
TURNS RATIO	1 : 1 ±3%	
POLARITY	PER SCHEMATIC	
INSERTION LOSS	100 KHz	1-125 MHz
	-1.2 DB MAX	-0.2-0.002*f <sup>1.4</sup> DB MAX
RETURN LOSS	.1-40 MHz	40-100 MHz
(Z OUT = 100 OHM±15%)	-16 DB MIN	-10+20*LOG <sub>10</sub> (f/80 MHz) DB MIN
INDUCTANCE (OCL) (MEDIA SIDE, 0°C-70°C)	350 uH MIN	(MEASURED AT 100 KHz, 100 mV <sub>RMS</sub> ) (AND WITH 8 mA DC BIAS)
	1 MHz	10-100 MHz
CROSSTALK, ADJACENT CHANNELS	-50 DB MIN	-50+22*LOG <sub>10</sub> (f/10) DB MIN
	2 MHz	30-200 MHz
COMMON MODE REJECTION RATIO	-50 DB MIN	-15+20*LOG <sub>10</sub> (f/200) DB MIN
	2 MHz	30-200 MHz
DIFFERENTIAL TO COMMON MODE REJECTION	-50 DB MIN	-15+20*LOG <sub>10</sub> (f/200) DB MIN
DC RESISTANCE 1/2 WINDING	.65 OHMS MAX	
DC RESISTANCE IMBALANCE	±.065 OHMS MAX (CENTER TAP SYMMETRY)	
DC CURRENT/VOLTAGE RATING	350 mA MAX @ 57V (CONTINUOUS)	
INPUT - OUTPUT ISOLATION	1500 VRMS MIN @ 60 SECONDS	

NOTE: f IS FREQUENCY IN MHZ.

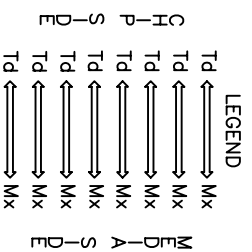

ALL CHANNELS ARE IN PHASE BETWEEN INPUT AND OUTPUT

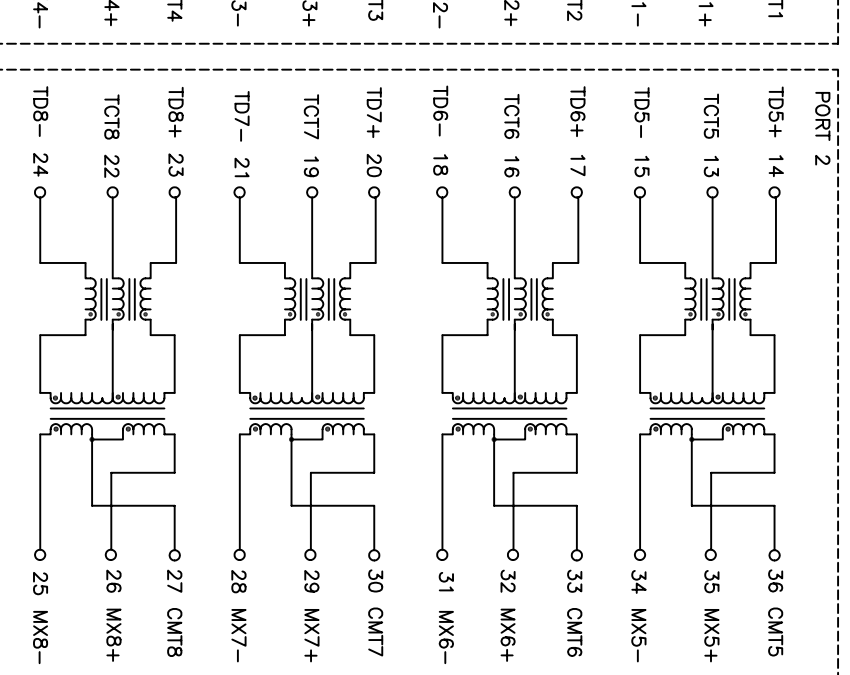

SCHEMATIC

All rights reserved. Pulse confidential & proprietary. (06/26/14)

TILA DRAWING	PS DRAWING	SHEET	PART NO.	DATASHEET REV.
60808FNL-10	PS-2747.001-B	2 OF 3	H6080FNL	A

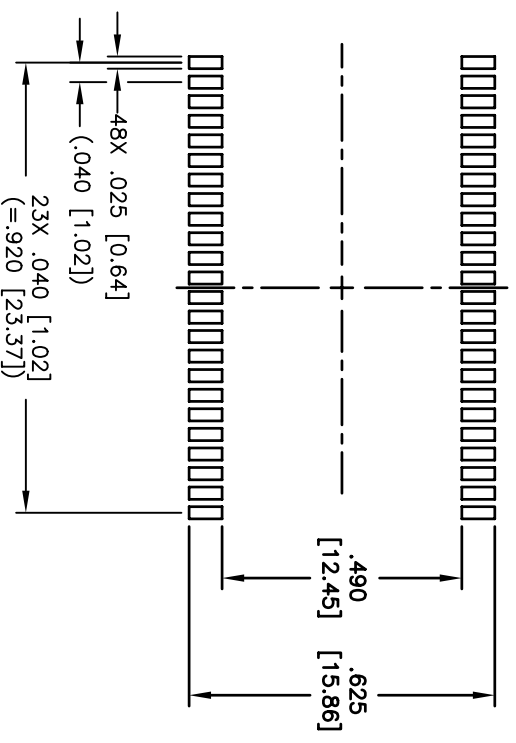
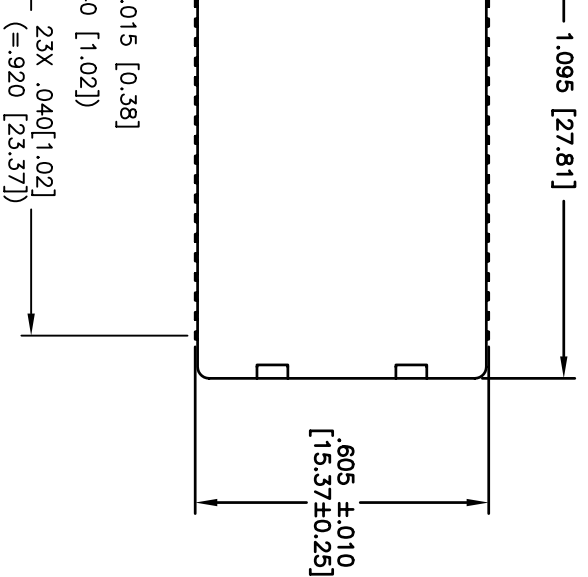

**SUGGESTED LAND PATTERN**

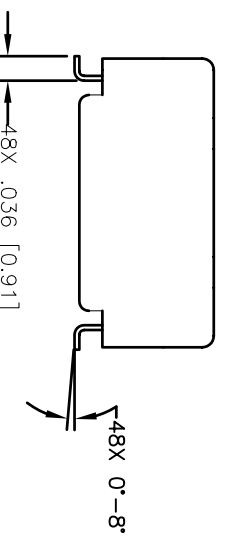
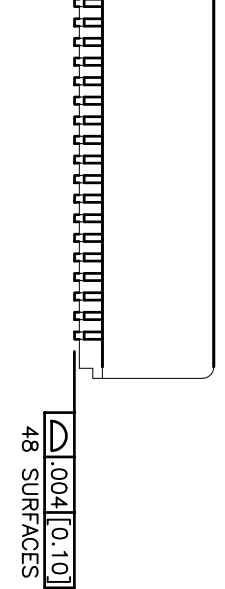

WITH THE FOLLOWING  
REFERENCE ONLY.

All rights reserved. Pulse confidential & proprietary. (06/26/14)

ITLA DRAWING 6080FNL-10	PS DRAWING PS-2747.001-B	SHEET 3 OF 3	PART NO. H6080FNL	DATASHEET REV. A
SFEI ELECTRONICS.COM(Asia)		PHONE:USA:858 674 8100, GERMANY:49 7032 78060, SINGAPORE:65 6287 8998, SHANGHAI:86 21 62787060, TAIWAN:886 3 4356768		

## Looking for pricing, stock, or lifecycle information?

Click below to explore more details on WIN SOURCE:

 [View H6080FNLT on WIN SOURCE](#)

 [Pulse Information](#)

## Optimize Your Supply Chain with WIN SOURCE Solutions

-  Global Sourcing Solution
-  Obsolete Management
-  Cost Control Management
-  Shortage Management
-  Alternative Solution
-  Excess Inventory Management