



THE DATASHEET OF CLT25N-10M630

www.win-source.net



0086-755-83957316

THIS COPY IS PROVIDED ON A RESTRICTED BASIS AND IS NOT TO BE USED IN ANY WAY DETRIMENTAL TO THE INTERESTS OF PANDUIT CORP.



Material: Nylon 6				
SLIT PART NUMBERS	NON-SLIT PART NUMBERS	DIM A Target (OD)	DIM B Target (ID)	Wall Thickness
CLT25N-*	CLTS25N-*	0.378 [9.60]	0.281 [7.14]	.007-.023 [0.18-0.51]
CLT35N-*	CLTS35N-*	0.417 [10.59]	0.323 [8.20]	
CLT38N-*	CLTS38N-*	0.535 [13.59]	0.421 [10.69]	
CLT50N-*	CLTS50N-*	0.675 [17.15]	0.518 [13.16]	
CLT62N-*	CLTS62N-*	0.815 [20.70]	0.665 [16.89]	
CLT75N-*	CLTS75N-*	0.933 [23.70]	0.762 [19.35]	
CLT100N-*	CLTS100N-*	1.114 [28.30]	0.917 [23.29]	.008-.031 [0.20-0.79]
CLT125N-*	CLTS125N-*	1.524 [38.71]	1.303 [33.10]	
CLT150N-*	CLTS150N-*	1.728 [43.89]	1.484 [37.69]	
CLT188N-*	NA	2.157 [54.79]	1.870 [47.50]	

Material: Polyethylene				
SLIT PART NUMBERS	NON-SLIT PART NUMBERS	DIM A Target (OD)	DIM B Target (ID)	Wall Thickness
CLT25F-*	CLTS25F-*	0.378 [9.60]	0.281 [7.14]	.007-.023 [0.18-0.51]
CLT35F-*	CLTS35F-*	0.417 [10.59]	0.323 [8.20]	
CLT38F-*	CLTS38F-*	0.535 [13.59]	0.421 [10.69]	
CLT50F-*	CLTS50F-*	0.675 [17.15]	0.518 [13.16]	
CLT62F-*	CLTS62F-*	0.815 [20.70]	0.665 [16.89]	
CLT75F-*	CLTS75F-*	0.933 [23.70]	0.762 [19.35]	
CLT100F-*	CLTS100F-*	1.114 [28.30]	0.917 [23.29]	.008-.031 [0.20-0.79]
CLT125F-*	CLTS125F-*	1.524 [38.71]	1.303 [33.10]	
CLT150F-*	CLTS150F-*	1.728 [43.89]	1.484 [37.69]	
CLT188F-*	NA	2.157 [54.79]	1.870 [47.50]	

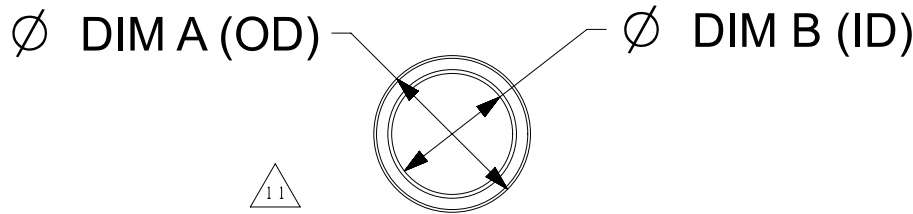

*** NOTES:**

1. SEE www.panduit.com FOR PART NUMBER SUFFIX DESIGNATION FOR PACKAGE SIZE, PART MATERIAL AND PART COLOR.
2. FOR ROLL SIZES LARGER THAN 10 FEET, SPLICES MAY OCCUR.
3. SLIT PART NUMBERS HAVE ONE CONTINUOUS SLIT ALONG ENTIRE LENGTH TUBING.

REV	DATE	BY	CHK	APR	DESCRIPTION	ECN
11	4/2/2020	RVU	DJW	JHAC	REBUILD MODEL AND REDRAWING DRAWING. ADDED NEW TWO TABLE TO INCLUDE SLIT AND NON-SLIT. CHANGED ALL A DIM AND B DIM MEASUREMENTS. UPDATED TITLE AND NOTES.	GAECN05626
10	02.10.15	BDK	VJS	RGRO	E. ADDED DUAL RIB PROFILE AND DETAIL F. REMOVED DENSITY FROM POLYETHYLENE	GB0222BP
09	5/09/14	BWG	VJS	JADE	REVISED DIMENSIONS AND WEIGHTS, REMOVED PREVIOUS REVISION BALLONS FOR CLARITY AND UPDATED TITLE BORDER, ADDED * TO PART NUMBERS, REVISED NOTE 1.	GB0222BP/09

TITLE						Slit & Non-slit Corrugated Loom Tubing					
CUSTOMER DRAWING											
ITEM REVISION NAME						G03597BN/02					
DATASET FILE NAME						G03597BN_DC_GB0222BP_11/00A					
UNLESS OTHERWISE SPECIFIED, DIMENSIONAL TOLERANCES ARE: IN (mm)											
.X ± .XXX ± .050 (1.27)											
.XX ± ANGLES ±						MATERIAL: Nylon 6 or Polyethylene					
						DRAWING NUMBER: GB0222BP					
DRAWN BY		DATE		CHK		SCALE		SHT 1 OF 1		SIZE	
CPE		9-18-97		VJS		NONE				A	

Looking for pricing, stock, or lifecycle information?

Click below to explore more details on WIN SOURCE:

 [View CLT25N-10M630 on WIN SOURCE](#)

 [Panduit Corp Information](#)

Optimize Your Supply Chain with WIN SOURCE Solutions

-  Global Sourcing Solution
-  Obsolete Management
-  Cost Control Management
-  Shortage Management
-  Alternative Solution
-  Excess Inventory Management