

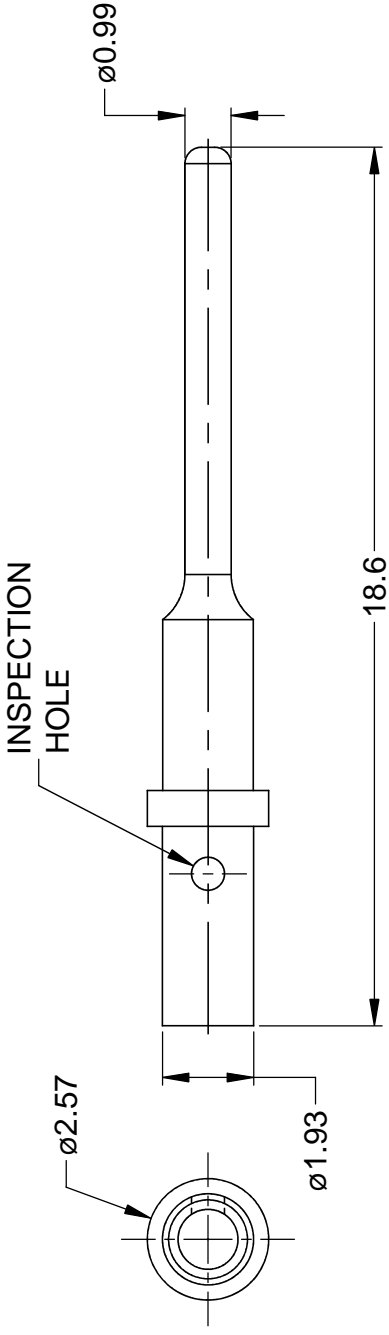

**THE DATASHEET OF  
AT60-202-20NKIT**



REVISION	
REV	DESCRIPTION
ECO	
A	RELEASE



**REFERENCE DIMENSIONS**

NOTES: UNLESS OTHERWISE SPECIFIED

1. MATERIAL: COPPER ALLOY; NICKEL PLATED
2. CONTACT SIZE: 20
3. SPECIFICATIONS:
  - 3.1 CURRENT RATING: 7.5 AMPS
  - 3.2 CONTACT MILLIVOLT DROP: 60 MILLIVOLT DROP @ 7.5 AMP TEST CURRENT.
  - 3.3 RoHS COMPLIANT
4. RECOMMENDED WIRE RANGE: 20 - 22 AWG
5. AVAILABLE HAND CRIMPER: CA-5D12
6. ALL DIMENSIONS ARE FOR REFERENCE USE ONLY

10	AT60-202-20141	CONTACT, 1
PART NUMBER		DE
<b>QUANTITY</b>		
UNLESS OTHERWISE SPECIFIED		
1) All dimensions are in metric(mm).		
2) Tolerances are as follows:		
1 PL DEC ±0.30	Fractions ±1/64	
2 PL DEC ±0.15	Angles ±1°	
3 PL DEC ±0.08		
3) Note reference = $\triangle X$		
MATERIAL SPECIFICATIONS:		
PROCESS SPECIFICATIONS:		
NEXT ASSY:		
SIGNATURES		DATE
DRAWN: D.PARMS		10/07/13
CHECKED:		
ENGINEER:		
APPROVAL:		
CUSTOMER:		
MATERIALS LIST		SIZE
		A
		TYPE
		AC-
		SCALE: NONE
		20-22

## Looking for pricing, stock, or lifecycle information?

Click below to explore more details on WIN SOURCE:

- ⊖ [View AT60-202-20NKIT](#) on WIN SOURCE
- ⊖ [Amphenol Sine Systems Corp](#) Information

## Optimize Your Supply Chain with WIN SOURCE Solutions

- ✓ Global Sourcing Solution
- ✓ Obsolete Management
- ✓ Cost Control Management
- ✓ Shortage Management
- ✓ Alternative Solution
- ✓ Excess Inventory Management