



THE DATASHEET OF AC3F



A

B

C

D

E

F

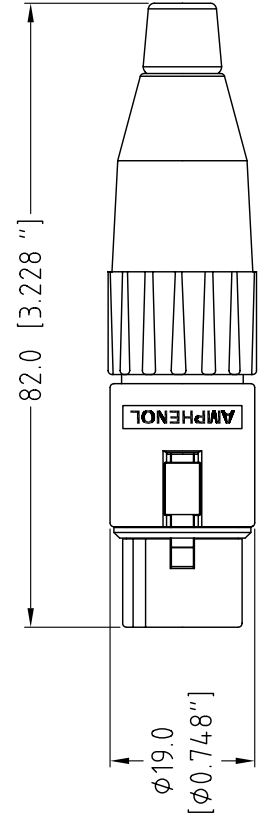

ACTUAL SIZE

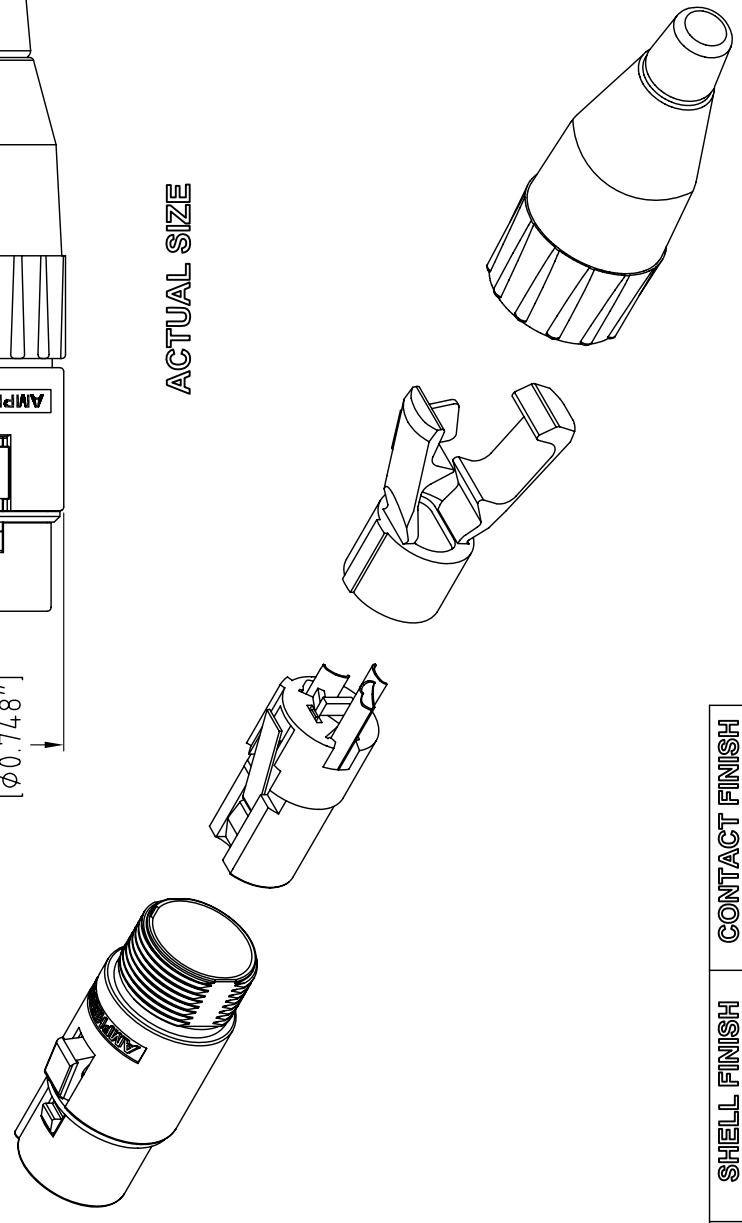



CAT P/No.	SHELL FINISH	CONTACT FINISH
AC3F	NICKEL	TIN PLATING
AC3FJ		GOLD PLATING
AC3F-AU		TIN PLATING
AC3FJ-AU		GOLD PLATING
AC3FB	BLACK	TIN PLATING
AC3FBJ		GOLD PLATING
AC3FB-AU		TIN PLATING
AC3FBJ-AU		GOLD PLATING

UNLESS OTHERWISE SPECIFIED		THIS DOCUMENT IS THE PROPERTY OF AMPHENOL AUSTRALIA PTY. LTD. NO PART THEREOF MAY BE REPRODUCED AND USED WITHOUT THE PRIOR WRITTEN CONSENT OF THE OWNER	
TOLERANCE TO BE		CAD FILE: 00848100	DRN: L.V
LINEAR	ANGULAR	MATL: REFER TO COMPONENT	CKD: M.N.H
X ± 0.5	X° ± 1°	FINISH: REFER TO COMPONENT	APP'D: P.M
X.X ± 0.1	X°X' ± 30'	DATE: 01-05-06	
X.XX ± 0.05	X°X'X" ± 15'	DATE: 01-05-06	
BREAK ALL SHARP EDGES AND REMOVE ALL BURRS		DATE: 01-05-06	
DO NOT SCALE		PART No: REF	
DIMENSIONS IN MILLIMETRES		SCALE: 1:1 UOS	

Looking for pricing, stock, or lifecycle information?

Click below to explore more details on WIN SOURCE:

-  [View AC3F on WIN SOURCE](#)
-  [Amphenol Information](#)

Optimize Your Supply Chain with WIN SOURCE Solutions

-  Global Sourcing Solution
-  Obsolete Management
-  Cost Control Management
-  Shortage Management
-  Alternative Solution
-  Excess Inventory Management