

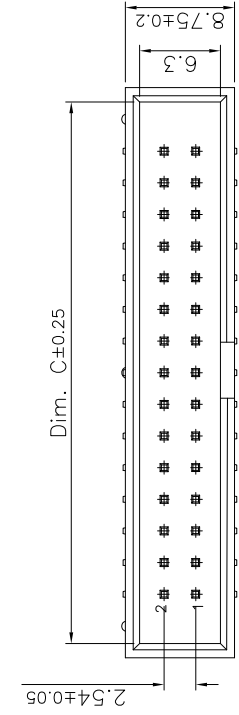

THE DATASHEET OF
3020-10-0300-00





Specifications:
 Current F...
 Voltage F...
 Contact F...
 Insulation...
 Withstand...
 Operating...
 Materials:
 Insulator: I...
 Insulator...
 Contact: B...
 Finish: Co...

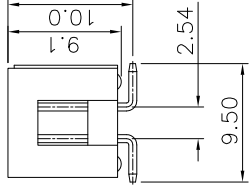
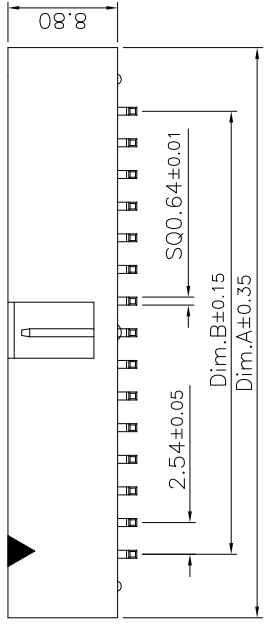

Pos	Dim A	Dim B	Dim C
6	15.24	5.08	12.94
8	17.78	7.62	15.48
10	20.32	10.16	18.02
14	25.40	15.24	23.10
16	27.94	17.78	25.64
20	33.02	22.86	30.72
26	40.64	30.48	38.34
40	58.42	48.26	56.12
50	71.12	60.96	68.82

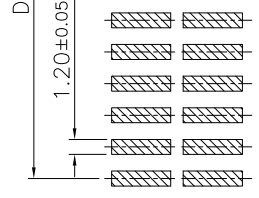

REV	DATE	FILE	BY
B	10-Apr-2023		
A	19-Jan-2021		

DRAWN:	Lisy Liu
CHECKED:	Jerry Chen
APPROVAL:	Rory Chen

GENERAL TOLERANCE:	.X = ±0.20 .XX = ±0.15
UNIT:	MM
SCALE:	1:1
SHEET:	1 / 2
PROJECTION:	

	Industrial
DESCRIPTION:	2.54mm B...
PART NO:	30...

Looking for pricing, stock, or lifecycle information?

Click below to explore more details on WIN SOURCE:

- [View 3020-10-0300-00 on WIN SOURCE](#)
- [CNC Tech Information](#)

Optimize Your Supply Chain with WIN SOURCE Solutions

- ✓ Global Sourcing Solution
- ✓ Obsolete Management
- ✓ Cost Control Management
- ✓ Shortage Management
- ✓ Alternative Solution
- ✓ Excess Inventory Management