



**THE DATASHEET OF
2SWK131AL101**



Key Switches, Medium Security

MATERIAL SPECIFICATIONS

ContactsSilver
 Cylinder Material.....Zinc alloy
 Lock BodyZinc alloy
 Key MaterialBrass
 Terminals/Fixed ContactsScrew type
 Beveled Frame Finish302 Stainless steel

TYPICAL PERFORMANCE CHARACTERISTICS

Contact Rating1A at 120 VAC resistive
 Initial Contact Resistance50 Milliohms max.
 Contact Timing.....Non-shorting
 Plunger/Actuator Travel90°
 Key Changes25 Standard
 Life ExpectancyUp to 10,000 Cycles

ENVIRONMENTAL SPECIFICATIONS

Solder Heat ResistanceSee page M3-4

NOTE: All Keylocks are supplied with 2 brass keys on a ring.

SPST

5 Disc Tumblers



2SWK131

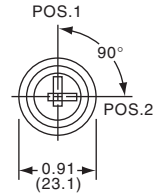
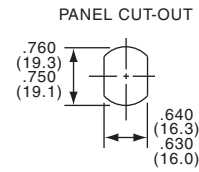
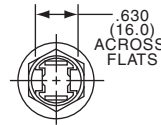
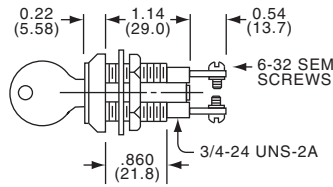

| Part Number | | | | | | Part Number | | | | | |
|------------------|--------------|------|--------|--------|-----------------|------------------|--------------|--|--------|--------|------------|
| Tyco Electronics | Alcoswitch | Type | Pos. 1 | Pos. 2 | Remove Key | Tyco Electronics | Alcoswitch | Type | Pos. 1 | Pos. 2 | Remove Key |
| 1-1437597-7 | 2SWK131AL101 | SPST | Off | On | Position 1 | 2-1437597-7 | 2SWK231AL101 | SPST | Off | (On) | Position 1 |
| 2-1437597-3 | 2SWK132AL101 | SPST | Off | On | Position 1 or 2 | 4-1437597-3 | SWK1323AL101 | Spare Key for SWK Series (On) indicates momentary position. | | | |

Medium Security Key Switch

MATERIAL SPECIFICATIONS

ContactsSilver
 Cylinder MaterialZinc alloy
 Lock BodyZinc alloy
 Key MaterialBrass
 Terminals/Fixed Contacts ...Screw type
 Beveled Frame FinishBrushed chrome

TYPICAL PERFORMANCE CHARACTERISTICS

Contact Rating1 A @ 120 VAC resistive
 Initial Contact Resistance ...50 Milliohms max.
 Contact TimingNon-shorting
 Actuator Travel90°
 Key Changes10 Standard
 Life ExpectancyUp to 10,000 Cycles

ENVIRONMENTAL SPECIFICATIONS

Operating Temperature-22°F + 185° F (-30°C to +85°C)
 Storage Temperature-22°F + 185° F (-30°C to +85°C)
 Solder Heat ResistanceSee page M3-4

NOTE: All Keylocks are supplied with 2 brass keys on a ring.

SPST

4 Disc Tumblers

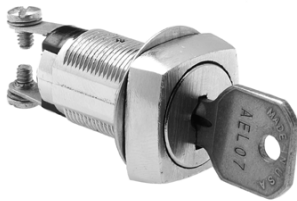

SKF131

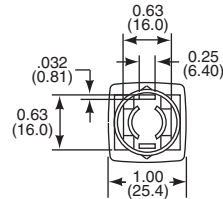
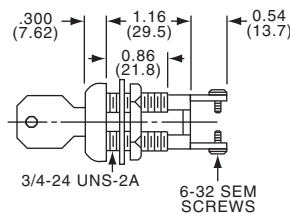

PANEL CUT-OUT

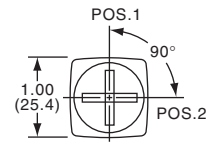
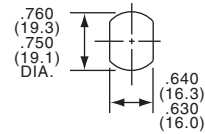

| Tyco Electronics | Alcoswitch | Type | Pos. 1 | Pos. 2 | Remove Key | Tyco Electronics | Alcoswitch | Type | Pos. 1 | Pos. 2 | Remove Key |
|------------------|--------------|------|--------|--------|-----------------|------------------|--------------|------|------------------------------------|--------|------------|
| 1437597-1 | 2SKF131AEL01 | SPST | Off | On | Position 1 | 1-1437597-1 | 2SKF231AEL01 | SPST | Off | (On) | Position 1 |
| 1437597-7 | 2SKF132AEL01 | SPST | Off | On | Position 1 or 2 | 3-1437597-4 | SK1323AEL01 | SPST | Spare key for SK Series | | |
| 1-1437597-0 | 2SKF133AEL01 | SPST | On | Off | Position 1 | | | | (On) indicates momentary position. | | |

H

SKF Series

High Security Key Switch

MATERIAL SPECIFICATIONS

ContactsSilver
 Cylinder MaterialZinc alloy
 Lock BodyZinc alloy
 Actuator MaterialBrass key
 Terminals/Fixed Contacts.....Screw type
 Beveled Frame FinishPolished chrome

ENVIRONMENTAL SPECIFICATIONS

Operating Temperature.....-22°F to +185° (-30°C to +85°C)
 Storage Temperature-22°F to +185° (-30°C to +85°C)
 Solder Heat Resistance.....See page M3-4

TYPICAL PERFORMANCE CHARACTERISTICS

Contact Rating5A @ 115 VAC, 15A @ 24 VDC
 resistive
 Initial Contact Resistance ...50 Milliohms max.
 Contact TimingNon-shorting
 Dielectric Strength1,000 VAC @ sea level
 Actuator Travel90°
 Key Changes25 Standard
 Life ExpectancyUp to 20,000 Cycles

NOTE: All Keylocks are supplied with 2 brass keys on a ring.

SPST
8 Disc Tumblers

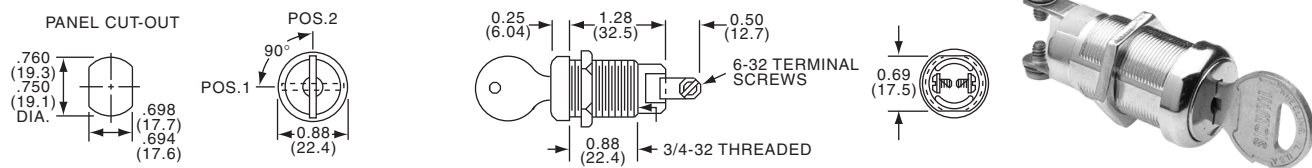

SWK12

| Tyco Electronics | Alcoswitch | Type | Pos. 1 | Pos. 2 | Remove Key |
|------------------|------------|----------------------------|--------|--------|-----------------|
| 4-1437597-0 | SWK12F315 | SPST | On | Off | Position 1 or 2 |
| 3-1437597-6 | SWK121F315 | SPST | On | Off | Position 2 |
| 3-1437597-8 | SWK123F315 | SPST | On | Off | Position 1 |
| 4-1437597-2 | SWK12KF315 | Spare key for SWK12 Series | | | |

Looking for pricing, stock, or lifecycle information?

Click below to explore more details on WIN SOURCE:

 [View 2SWK131AL101](#) on WIN SOURCE

 [TE Connectivity](#) Information

Optimize Your Supply Chain with WIN SOURCE Solutions

-  Global Sourcing Solution
-  Obsolete Management
-  Cost Control Management
-  Shortage Management
-  Alternative Solution
-  Excess Inventory Management