



**THE DATASHEET OF**  
**207544-3**



THIS DRAWING IS UNPUBLISHED. RELEASED FOR PUBLICATION. ALL RIGHTS RESERVED.  
 BY TYCO ELECTRONICS CORPORATION.

LOC	DIST	REVISIONS			
P	U/R	DESCRIPTION	DATE	DNW	APVD
BD	37	M	063B-0397-03	12MAY03	TK GS

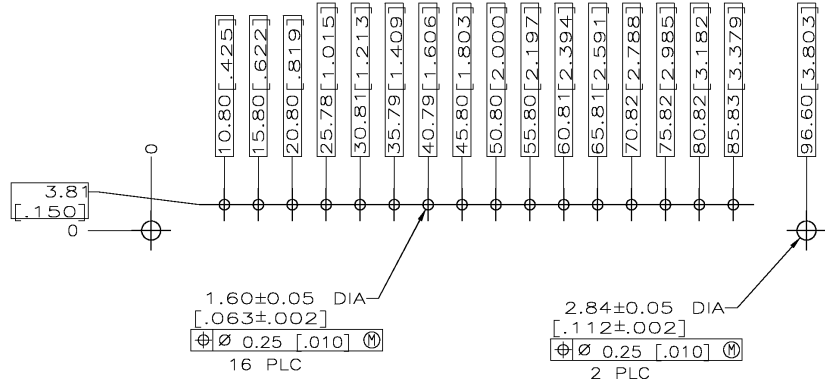
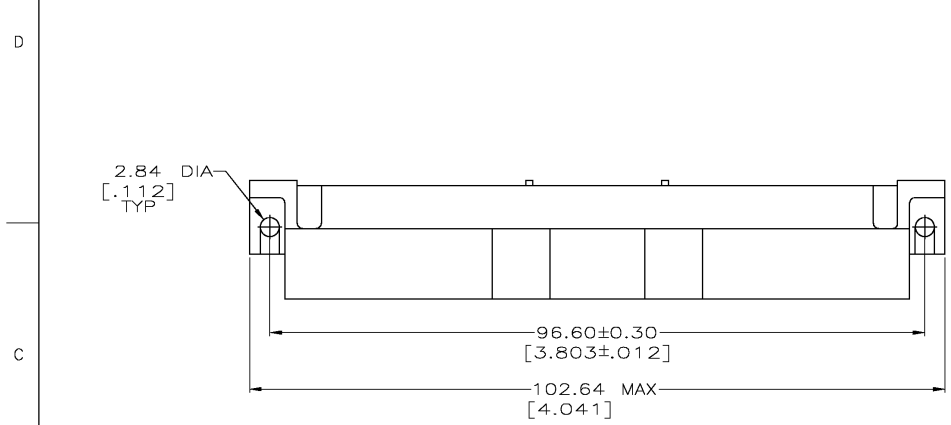

RECOMMENDED PC BOARD LAYOUT

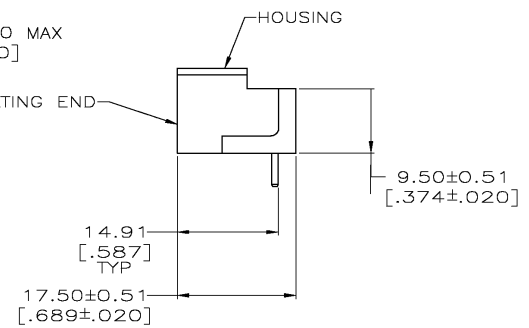
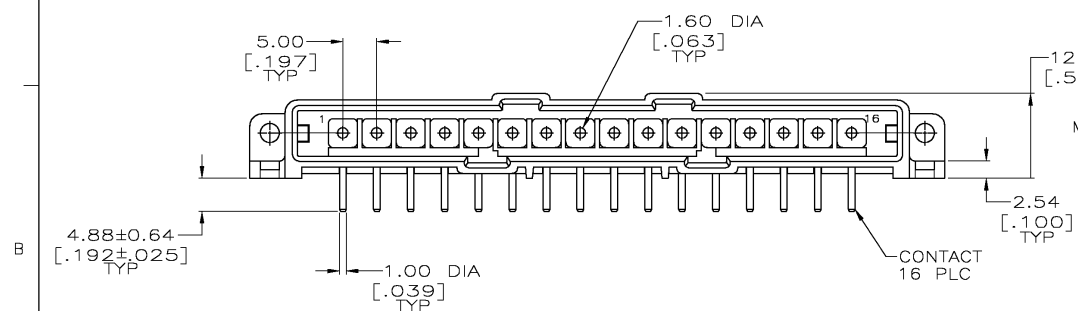

- ▲ NYLON, RED, VYDYNE M-345 FR.
- ▲ BRASS PER ASTM B36.
- ▲ 3.81µm [.000150] MIN TIN-LEAD OVER 2.54µm [.000100] MIN COPPER OR 1.27µm [.000050] MIN NICKEL.
- ▲ 0.76µm [.000030] MIN GOLD FOR A LENGTH OF 5.08 [.200] MIN FROM MATING END, 3.81µm [.000150] MIN TIN-LEAD FOR A LENGTH OF 13.08 [.515] MIN FROM OPPOSITE END, BOTH OVER 1.27µm [.000050] MIN NICKEL.
- ▲ 0.76µm [.000030] MIN GOLD FOR A LENGTH OF 5.08 [.200] MIN FROM MATING END, 3.81µm [.000150] MIN TIN FOR A LENGTH OF 13.08 [.515] MIN FROM OPPOSITE END, BOTH OVER 1.27µm [.000050] MIN NICKEL.
- ▲ .000150 MIN LEAD FREE TIN OVER .000100 MIN COPPER, OR .000050 MIN NICKEL.

OBSOLETE	6	207544-8
	5	207544-7
	-	207544-6
	4	207544-3
	3	207544-1
FINISH		PART NO

THIS DRAWING IS A CONTROLLED DOCUMENT.		DNW	07/01/92	<b>Tyco Electronics</b> Tyco Electronics Corporation Harrisburg, Pa
DIMENSIONS: INCHES		L	SIPE	
TOLERANCES UNLESS OTHERWISE SPECIFIED:		DRK	7-8-92	PIN HEADER ASSEMBLY, 16 POSN, IN-LINE, RIGHT ANGLE, SMALL METRIC CONNECTOR, METRIMATE
0 PLC ± -		APD	A TRAVIS	
1 PLC ± -		NAME		
2 PLC ± 0.25 [.010]		PRODUCT SPEC		
3 PLC ± -		APPLICATION SPEC		SIZE
4 PLC ± -		WEIGHT		AGE CODE
ANGLES ± -		RESTRICTED TO		DRAWING NO
MATERIAL	FINISH	A2 00779		©-207544
HOUSING: 1	CONTACTS: SEE TBL	CUSTOMER DRAWING		SCALE 2:1 SHEET 1 OF 1 REV M

207544

A

## Looking for pricing, stock, or lifecycle information?

Click below to explore more details on WIN SOURCE:

 [View 207544-3](#) on WIN SOURCE

 [TE Connectivity](#) Information

## Optimize Your Supply Chain with WIN SOURCE Solutions

-  Global Sourcing Solution
-  Obsolete Management
-  Cost Control Management
-  Shortage Management
-  Alternative Solution
-  Excess Inventory Management