



**THE DATASHEET OF
S8421-45R**



Customer Information Sheet

IF IN DOUBT - ASK

©

NOT TO SCALE

THIRD ANGLE PROJECTION

ALL DIMENSIONS IN mm

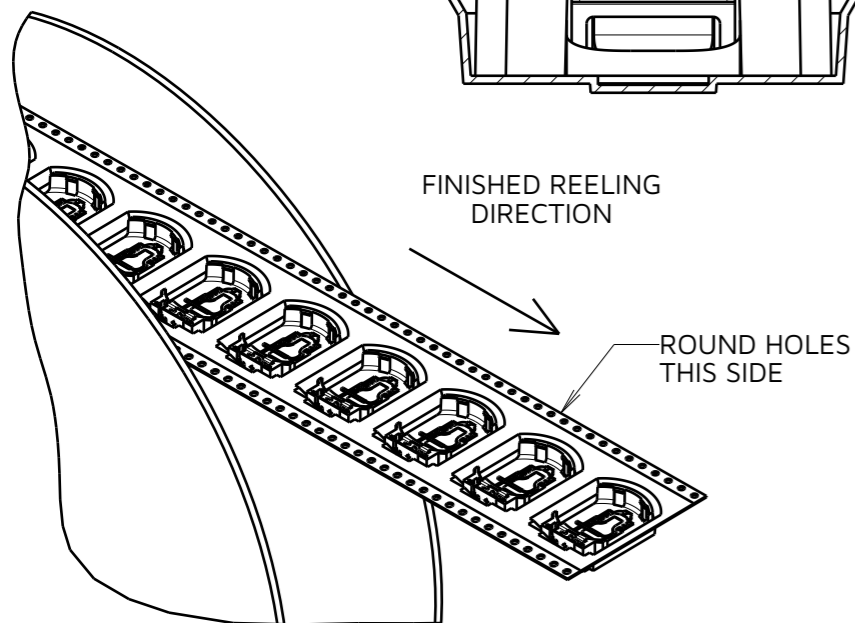
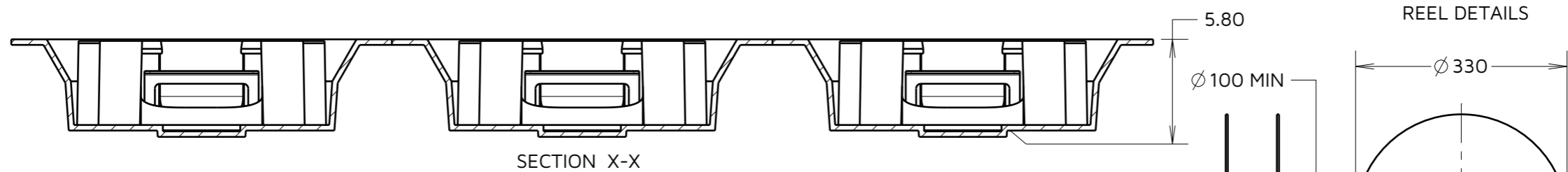
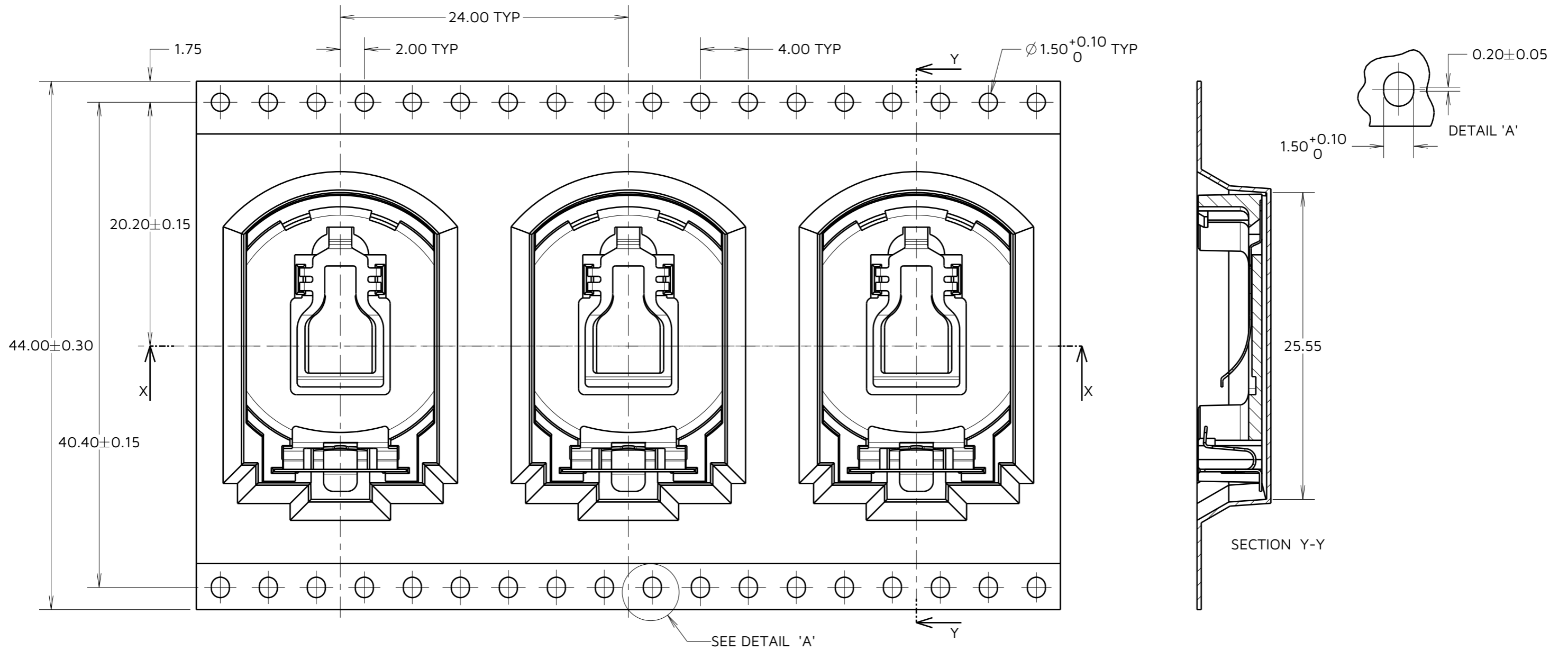

NOTES:

1. FOR CONNECTOR DETAILS SEE SHEET 4.
2. QUANTITY PER REEL = 500.
3. TAPE AND REELING TO BE IN ACCORDANCE WITH EIA-481 (ELECTRONIC INDUSTRIES ASSOCIATION)

MGP	7	20.09.23	33065
NAME	ISS.	DATE	CN/CO
APPROVED: MGP			
CHECKED: FC			
DRAWN: R.ADDE			
ASSEMBLY DRG:			

HARWIN

www.harwin.com

TOLERANCES
 X. = ±1mm
 X.X = ±0.50mm
 X.XX = ±0.20mm
 X.XXX = ±0.01mm
 ANGLES = ±5°
 UNLESS STATED

THIS DRAWING AND ANY INFORMATION OR DESCRIPTIVE MATTER SET OUT HEREON ARE CONFIDENTIAL AND COPYRIGHT PROPERTY OF THE HARWIN GROUP AND MUST NOT BE DISCLOSED, LOANED, COPIED OR USED FOR MANUFACTURING, TENDERING OR FOR ANY OTHER PURPOSE WITHOUT THEIR WRITTEN PERMISSION.

MATERIAL:
 SEE SHEET 4

TITLE:
 SMT COIN CELL HOLDER
 FOR CR2032 TAPE & REELED

DRAWING NUMBER:
 S8421-45R

SHT
 3
 OF
 4

Customer Information Sheet

IF IN DOUBT - ASK

©

NOT TO SCALE

THIRD ANGLE PROJECTION

ALL DIMENSIONS IN mm

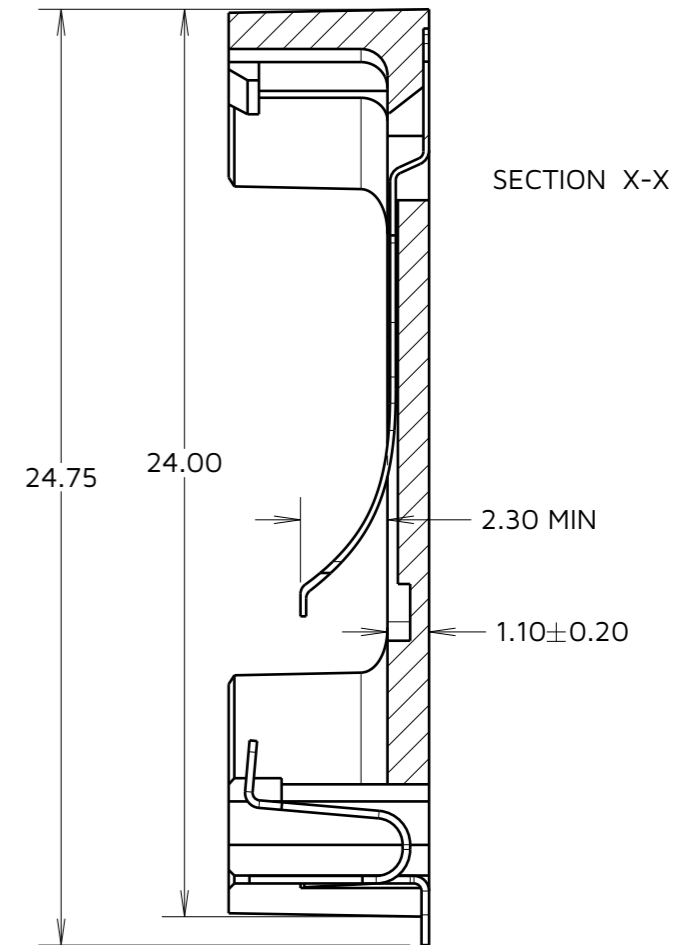
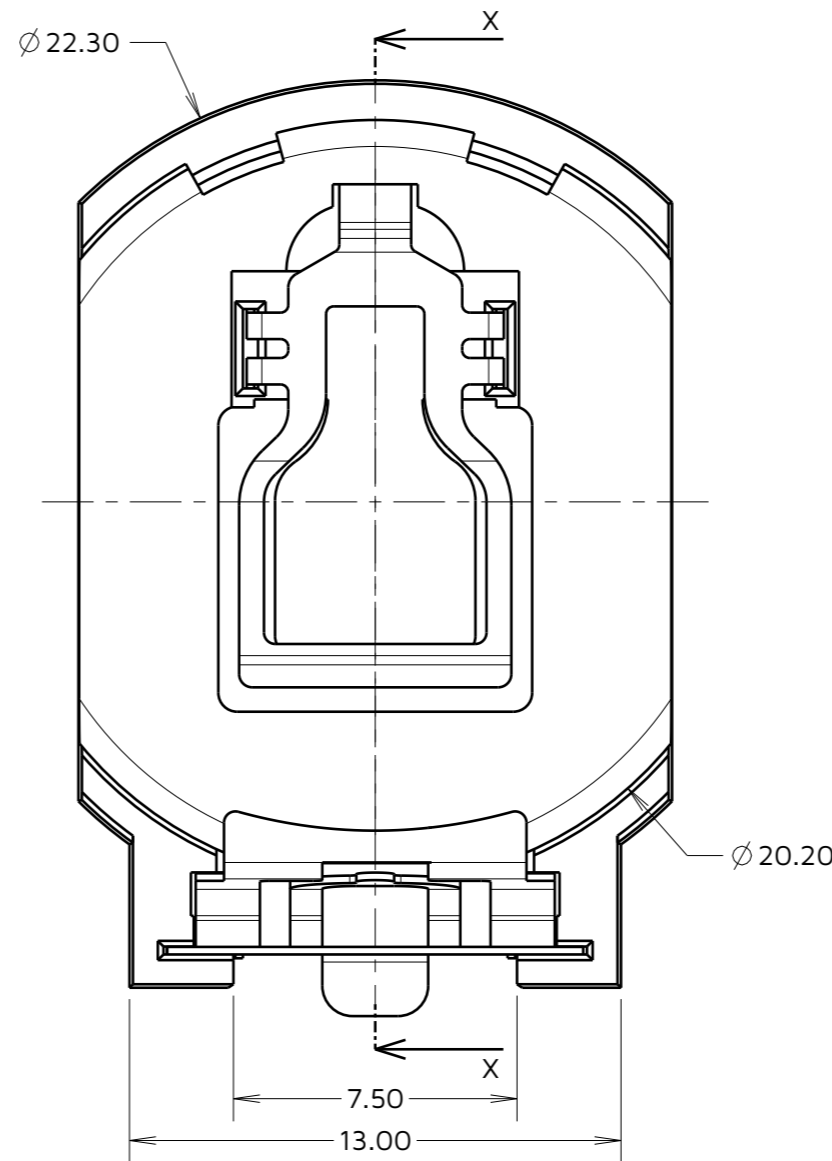
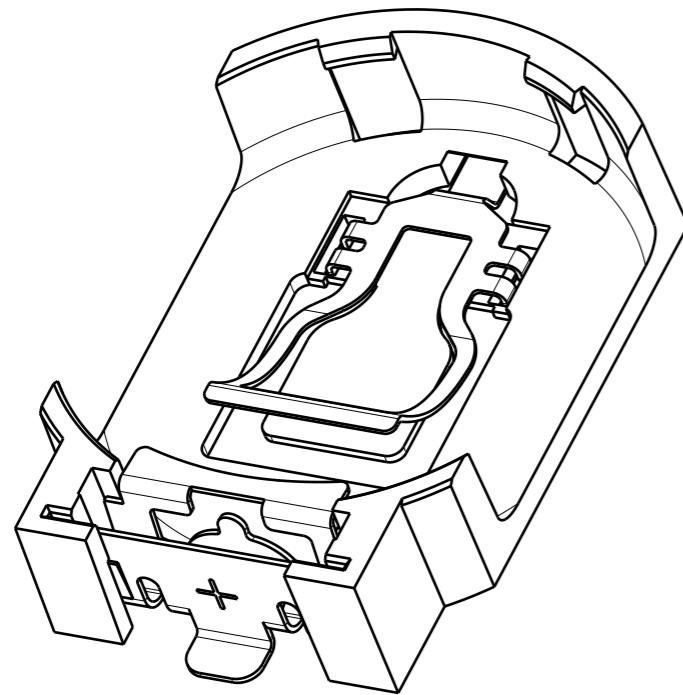

RECOMMENDED PCB LAYOUT
ALL TOLERANCES ± 0.05

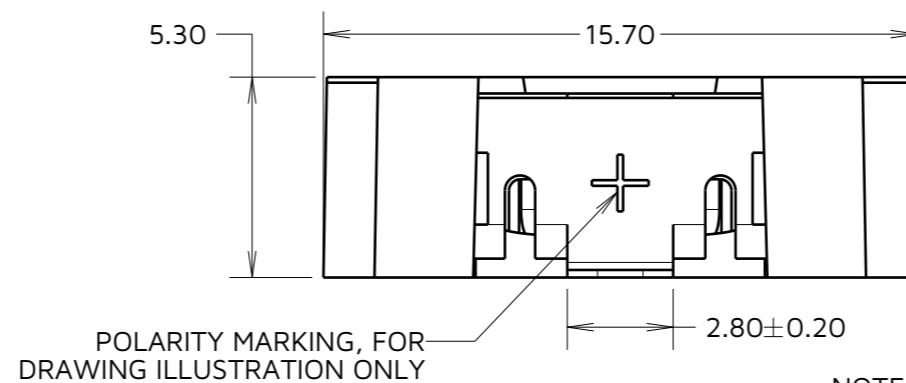
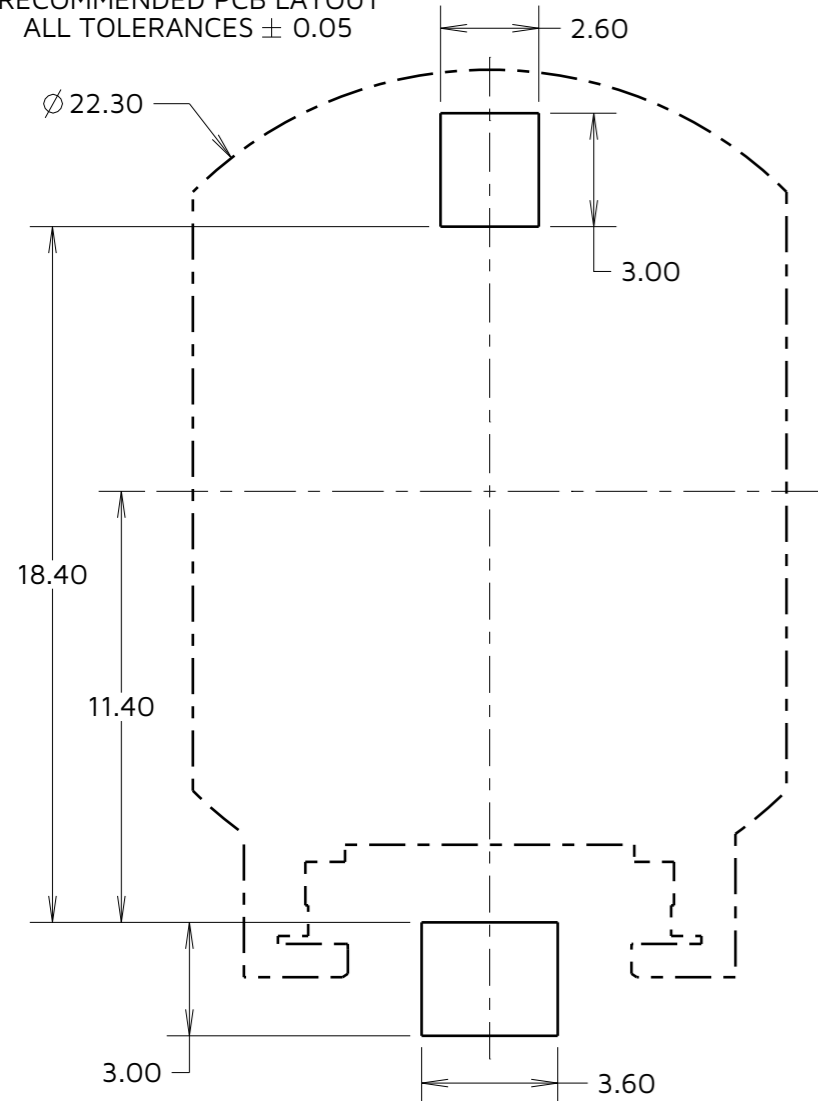

SPECIFICATIONS:

MATERIAL:

MOULDING: PPS 30% G/F, UL94V-0, BROWN
CONTACT: PHOSPHOR BRONZE

FINISH:

CONTACTS = GOLD FLASH

ELECTRICAL:

CONTACT RESISTANCE = 30mΩ MAX

INSULATION RESISTANCE = 1000MΩ MIN

DIELECTRIC VOLTAGE = 220V AC FOR 1 MINUTE

ENVIRONMENTAL:

OPERATING TEMPERATURE = -55° C TO +85° C

MGP	7	20.09.23	33065
NAME	ISS.	DATE	CN/CO
APPROVED: MGP			
CHECKED: FC			
DRAWN: R.ADDE			
ASSEMBLY DRG:			

NOTES:

- SUITABLE FOR THE FOLLOWING COIN CELL: CR2032.
- ALL TOLERANCES ARE ±0.30 UNLESS OTHERWISE STATED.

HARWIN

www.harwin.com

TOLERANCES
X = ±1mm
X.X = ±0.50mm
X.XX = ±0.20mm
X.XXX = ±0.01mm
ANGLES = ±5°
UNLESS STATED

THIS DRAWING AND ANY INFORMATION OR DESCRIPTIVE MATTER SET OUT HEREON ARE CONFIDENTIAL AND COPYRIGHT PROPERTY OF THE HARWIN GROUP AND MUST NOT BE DISCLOSED, LOANED, COPIED OR USED FOR MANUFACTURING, TENDERING OR FOR ANY OTHER PURPOSE WITHOUT THEIR WRITTEN PERMISSION.

MATERIAL:

SEE ABOVE

TITLE:

COIN CELL HOLDER FOR CR2032

DRAWING NUMBER:

S8421-45R

SHT
4 OF 4

Looking for pricing, stock, or lifecycle information?

Click below to explore more details on WIN SOURCE:

 [View S8421-45R on WIN SOURCE](#)

 [Harwin Inc. Information](#)

Optimize Your Supply Chain with WIN SOURCE Solutions

-  Global Sourcing Solution
-  Obsolete Management
-  Cost Control Management
-  Shortage Management
-  Alternative Solution
-  Excess Inventory Management