



**THE DATASHEET OF  
AH316M157501-T**



# Chip Antennas

## PACKAGING

### ① Minimum Quantity

Type	Standard Quantity (pcs)
	Embossed Tape
A4	2000
A2	3000
A6	1000
18	5000

### ② Tape Material

#### ● Embossed Tape

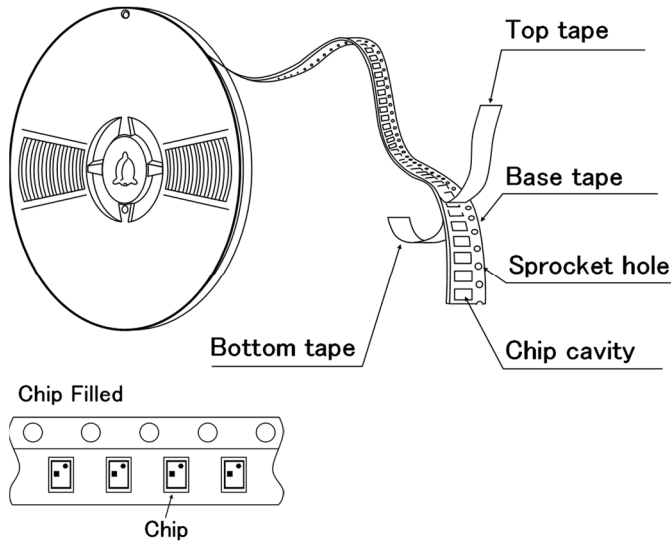

#### ● Card Board CARRIER Tape

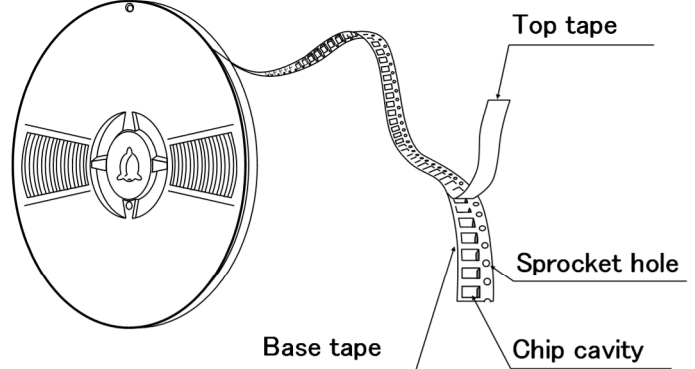

### ③ Taping Dimensions

#### ● Embossed Tape

Unit: mm (inch)

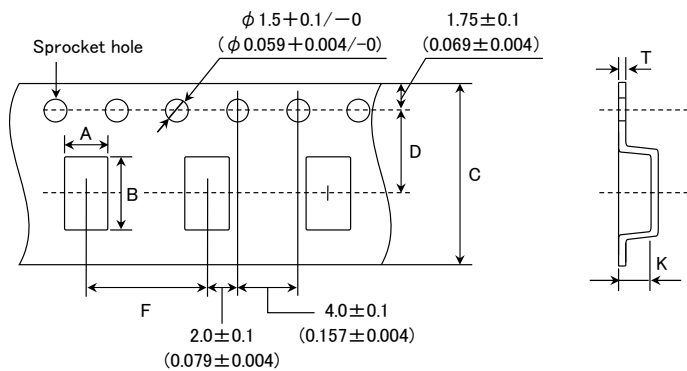

Type	Chip Cavity		Tape Width		Insertion Pitch	Tape Thickness max.	
	A	B	C	D	F	K	T
A2	$1.9 \pm 0.2$ (0.075 ± 0.008)	$3.5 \pm 0.2$ (0.138 ± 0.008)	$8 \pm 0.2$ (0.315 ± 0.008)	$3.5 \pm 0.1$ (0.138 ± 0.004)	$4 \pm 0.1$ (0.157 ± 0.004)	0.85 (0.033)	0.3 (0.012)
A4	$4.35 \pm 0.2$ (0.171 ± 0.008)	$10.35 \pm 0.2$ (0.407 ± 0.008)	$24 \pm 0.3$ (0.945 ± 0.012)	$11.5 \pm 0.1$ (0.435 ± 0.004)	$8 \pm 0.1$ (0.315 ± 0.004)	1.45 (0.061)	0.3 (0.012)
A6	$6.25 \pm 0.2$ (0.246 ± 0.008)	$8.26 \pm 0.2$ (0.325 ± 0.008)	$16 \pm 0.3$ (0.630 ± 0.012)	$7.5 \pm 0.1$ (0.296 ± 0.004)	$12 \pm 0.1$ (0.473 ± 0.004)	1.3 (0.051)	0.3 (0.012)

Unit: mm (inch)

▶ This catalog contains the typical specification only due to the limitation of space. When you consider the purchase of our products, please check our specification. For details of each product (characteristics graph, reliability information, precautions for use, and so on), see our Web site (<http://www.ty-top.com/>).

● Paper tape 0.315 inches wide

Unit: mm (inch)

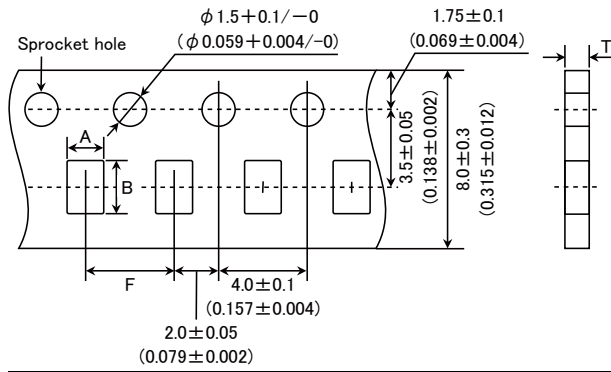

Type	Chip cavity		Insertion Pitch	Tape Thickness max.
	A	B	F	T
18	$0.95 \pm 0.05$ (0.037 ± 0.002)	$1.80 \pm 0.05$ (0.071 ± 0.002)	$4.0 \pm 0.1$ (0.157 ± 0.004)	0.80 (0.031)

Unit: mm (inch)

#### ④ Leader and Blank Portion

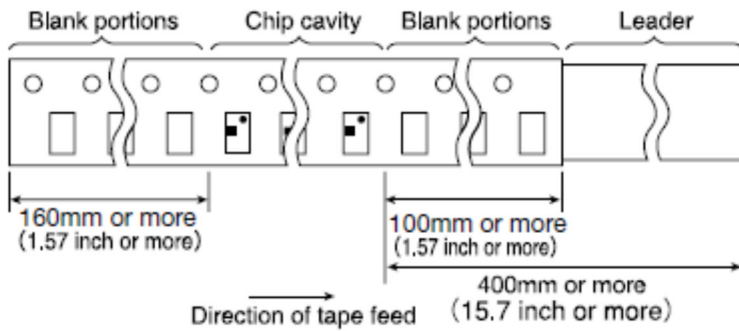

#### ⑤ Reel size

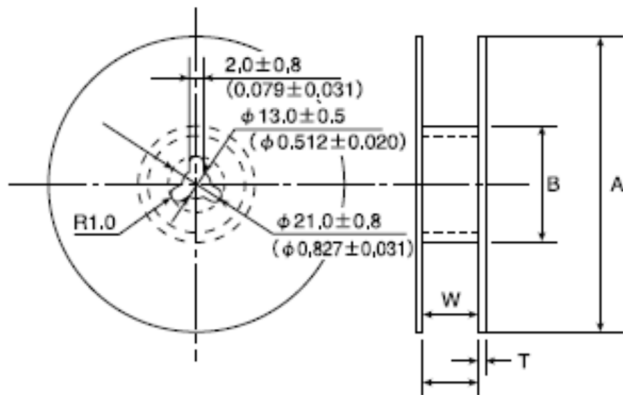

Type	A	B	W	T
18, A2	$178 \pm 2.0$ (7.0 ± 0.08)	50 min. (2.0 min.)	$10.0 \pm 1.5$ (0.394 ± 0.06)	3.0 max. (0.12 max.)
A4	$330 \pm 2.0$ (13.0 ± 0.08)	$100 \pm 1.0$ (3.94 ± 0.04)	$25.5 \pm 1.0$ (1.0 ± 0.04)	3.0 max. (0.12 max.)
A6	$330 \pm 2.0$ (13.0 ± 0.08)	$100 \pm 1.0$ (3.94 ± 0.04)	$17.0 \pm 1.0$ (0.67 ± 0.04)	2.5 max. (0.1 max.)

Unit: mm (inch)

#### ⑥ Top Tape Strength

The top tape requires a peel-off force of 0.1~0.7N in the direction of the arrow as illustrated below.

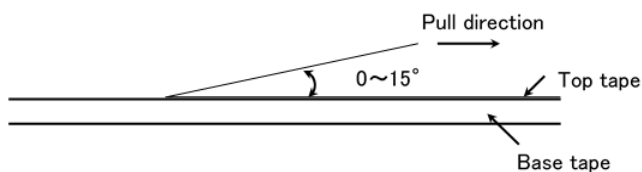

▶ This catalog contains the typical specification only due to the limitation of space. When you consider the purchase of our products, please check our specification. For details of each product (characteristics graph, reliability information, precautions for use, and so on), see our Web site (<http://www.ty-top.com/>).

## Looking for pricing, stock, or lifecycle information?

Click below to explore more details on WIN SOURCE:

- ⊖ [View AH316M157501-T on WIN SOURCE](#)
- ⊖ [Taiyo Yuden Information](#)

## Optimize Your Supply Chain with WIN SOURCE Solutions

- ✓ Global Sourcing Solution
- ✓ Obsolete Management
- ✓ Cost Control Management
- ✓ Shortage Management
- ✓ Alternative Solution
- ✓ Excess Inventory Management