



THE DATASHEET OF PS82-100G



Sensitive Snap-Action Pushbutton Switches — Solder and P.C. Terminals (Momentary Action)

PS SERIES 5 AMP. (S.P.)
1 AMP. (D.P.)
0.4 VA

DIRECT PANEL MOUNT

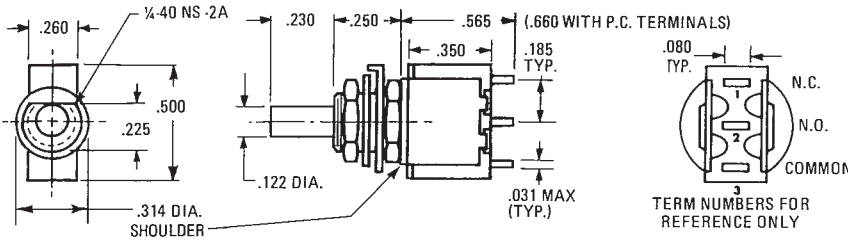

ONE POLE

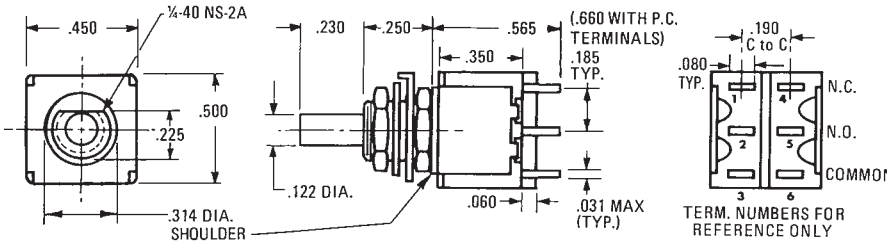

TWO POLE

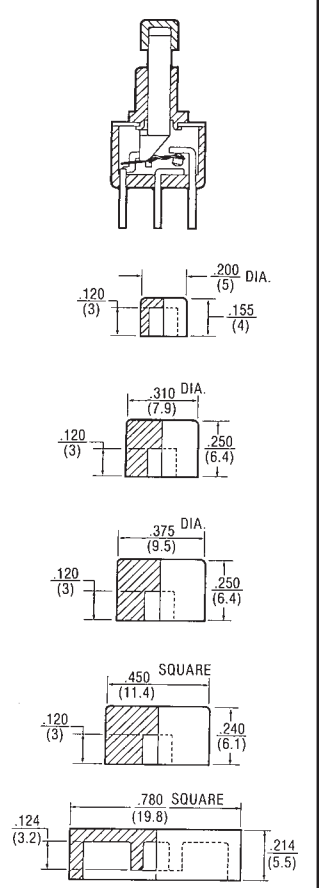

| Basic P/N | Terminal Type | Poles | Cap Size | Cap Color | Contact Material-Type |
|-----------|---|------------------------|---|---|--|
| PS | 1 - Solder lug 2 - Printed Circuit Terminals | 1 - One ① 2 - Two ① | 0 - No Cap 1 - .200 Dia. 2 - .375 Dia. 3 - .450 Sq. 4 - .310 Dia. 5 - .780 Sq. ③ | 0 - No Cap 1 - Black 2 - White 3 - Ted | B - Gold/Nickel/Brass ② G - Gold/Nickel/Silver ① ② Q - Coin Silver ① |

- ① Single pole circuit rated 5 amps, double pole circuit rated 1 amp.
- ② Ratings are 0.4 VA — 28 BAC or DC
- ③ Supplied with .90" square black bezel as Standard

EXAMPLES:

PS1-100Q = One-pole, S.L., 5 amp., No Cap, Coin Silver Contacts

PS2-221B = Two-pole, PC, .4 VA, .375 Dia., Black Cap., Gold/Nickel/Brass Contacts

NEW .780" SQUARE CAP AND BEZEL

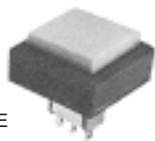

W-NU-29A

DECORATIVE FACE NUTS (SEE NOTE UNDER MATERIALS)

W-NU-30A

SPECIFICATIONS

Contact Rating — Letter codes G and Q (1 Pole) 5 amp resistive @ 125 VAC (U.L. recognized, CSA certified) or 5 amp resistive @ 28 VDC. (2 pole) 1 amp resistive @ 125 VAC (U.L. recognized, CSA certified) or 1 amp resistive @ 28 VDC.
Letter codes B and G — (1 and 2 Poles) 0.4 Volt-amps (VA) maximum @ 28 V max. (AC or DC).
Contact Resistance — 50 milliohms maximum.
Insulation Resistance — 1,000 megohms minimum.
Dielectric Strength — 1,000 volts RMS minimum at sea level.
Electrical Life — 60,000 cycles minimum at full load-resistive.
Maximum Allowable Installation Force on Plunger — 10 pounds.
 Multi-pole contacts do not make and break simultaneously.

MATERIALS

Case — Diallyl Phthalate.
Bushing — Brass, nickel plated.
Housing — Stainless steel.
Plunger — Thermoplastic.
Common Contact — Refer to contact material table above.
Center & End Contact — Refer to contact material table above.
Hardware — (2) Hex nuts W-NU-11, brass nickel plated. (1) Internal tooth lockwasher W-WA-16, steel chromium plated. (1) Locking Ring W-RI-16, C.R.S. nickel plated.
Decorative Face Nuts — Brass, bright chrome plated. See Page 16 for complete dimensions.

| Description | P/N | Color |
|------------------|---------------|-------|
| Small Cap .200 | W-KN-16 | Black |
| | W-KN-16A | White |
| | W-KN-16B | Red |
| Medium Cap .310 | W-KN-32 | Black |
| | W-KN-32A | White |
| Large Cap .375 | W-KN-17 | Black |
| | W-KN-17A | White |
| Square Cap .450 | W-KN-18 | Black |
| | W-KN-18A | White |
| .780 Square Cap | W-KN-18B | Red |
| | W-KN-52 | Black |
| .90 Square Bezel | W-KN-52A | White |
| | W-KN-52B | Red |
| | Bezel W-BZ-21 | Black |

Solder Lug Terminal

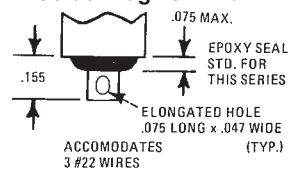

Printed Circuit Terminal

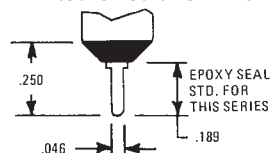

PS
SERIES 5 AMP. (S.P.)
0.4VA

**Sensitive Snap-Action Pushbutton Switches —
P.C. Terminals (Momentary Action)**

RIGHT ANGLE MOUNT IN P.C. BOARDS (HORIZONTAL)

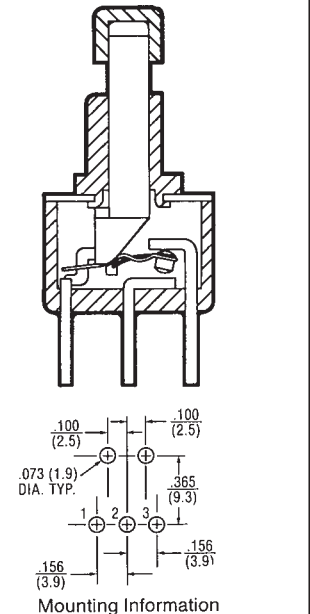
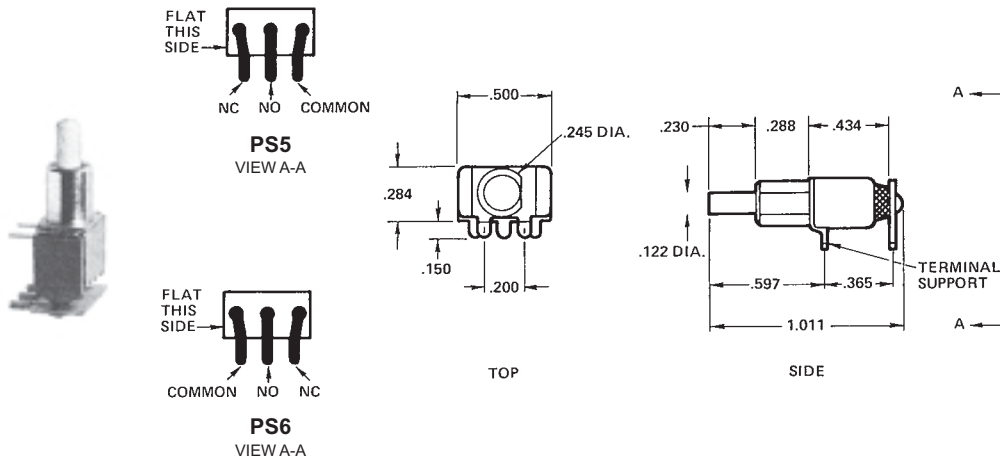

| Basic P/N | Terminal Type | Poles | Cap Size | Cap Color | Contact Material-Type |
|-----------|--|---------|---|---|---|
| PS | 5 - Rt. Angle P.C. Mount 6 - Rt. Angle P.C. Mount | 1 - One | 0 - No Cap 1 - .200 Dia. 2 - .375 Dia. 3 - .450 Sq. 4 - .310 Dia. | 0 - No Cap 1 - Black 2 - White 3 - Red | B - Gold/Nickel/Brass ② G - Gold/Nickel/Silver ①② Q - Coin Silver ② |

- ① Rating is 5 amps — 125 VAC or 28 VDC.
- ② Ratings are 0.4 VA — 28 VAC or DC.

ORDERING EXAMPLES:

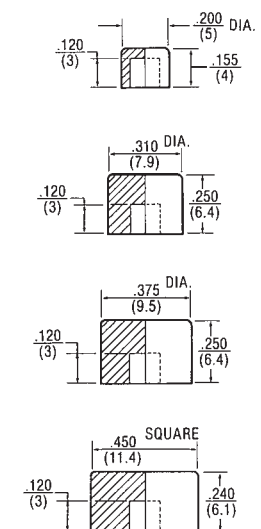
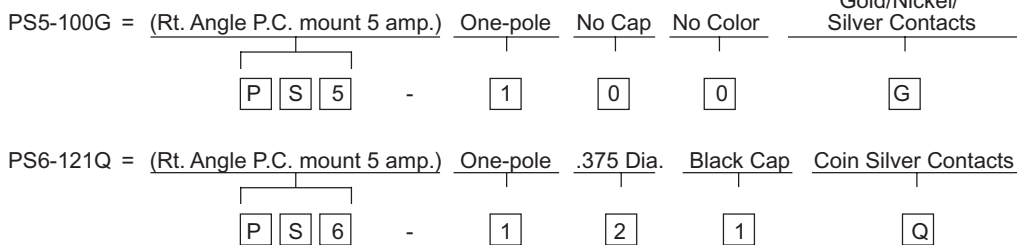

SPECIFICATIONS

Contact Rating — Letter codes G and Q — 5 amp resistive @ 125 VAC or 28 VDC.
Letter codes B and G — 0.4 volts-amps (VA) maximum @ 28 VAC or DC.

Contact Resistance — 50 milliohms maximum.

Insulation Resistance — 1,000 megohms minimum.

Dielectric Strength — 1,000 volts RMS minimum at sea level.

Electrical Life — 60,000 cycles minimum at full load.

Maximum Allowable Installation Force on Plunger — 10 pounds.

MATERIALS

Case — Diallyl Phthalate.

Bushing — Brass, nickel plated.

Housing — Stainless steel.

Plunger — Thermoplastic.

Common Contact — Refer to contact material table above.

Center & End Contact — Refer to contact material table above.

| Description | P/N | Color |
|--------------------|----------|-------|
| Small Cap .200 | W-KN-16 | Black |
| | W-KN-16A | White |
| | W-KN-16B | Red |
| Medium Cap .310 | W-KN-32 | Black |
| | W-KN-32A | White |
| | W-KN-32B | Red |
| Large Cap .375 | W-KN-17 | Black |
| | W-KN-17A | White |
| | W-KN-17B | Red |
| Square Cap .450 | W-KN-18 | Black |
| | W-KN-18A | White |
| | W-KN-18B | Red |

Sensitive Snap-Action Pushbutton Switches — P.C. Terminals (Momentary Action)

| | |
|---------------------|---------------|
| PS SERIES | 5 AMP. (S.P.) |
| | 1 AMP. (D.P.) |
| | 0.4 VA |

RIGHT ANGLE P.C. MOUNT SWITCHES

| Basic P/N | Terminal Type | Poles | Cap Size | Cap Color | Contact Material-Type |
|-----------|---|-----------|---------------|------------|----------------------------|
| PS | 9 - Horizontal Right Angle | 1 - One ① | 0 - No Cap | 0 - No Cap | B - Gold/Nickel/Brass ② |
| | 10 - Vertical Right Angle (.100 Terminal Spacing) | | 1 - .200 Dia. | 1 - Black | G - Gold/Nickel/Silver ① ② |
| | 11 - Vertical Right Angle 0.4 VA (.150 Terminal Spacing) | | 2 - .375 Dia. | 2 - White | Q - Coin Silver ① |
| | | 2 - Two ① | 3 - .450 Sq. | 3 - Red | |
| | | | 4 - .310 Dia. | | |

- ① Single pole circuit rated 5 amps, double pole circuit rated 1 amp.
- ② Ratings are 0.4 VA — 28 VAC or DC.

ORDERING EXAMPLES:

| | | | | | | |
|-------------|---------------------|----------|-----------|-----------|--------------------------------|---|
| PS9-100B = | (PC mounted 0.4 VA) | One-pole | No Cap | No Color | Gold/Nickel/ Brass Contacts | |
| | P S 9 | - | 1 | 0 | 0 | B |
| PS10-221Q = | (PC mounted 1 amp.) | Two-pole | .375 Dia. | Black Cap | Coin Silver Contacts | |
| | P S 10 | - | 2 | 2 | 1 | Q |

SPECIFICATIONS

Contact Rating — Letter codes G and Q (1 Pole) 5 amp resistive @ 125 VAC (U.L. recognized, CSA certified) or 5 amp resistive @ 28 VDC. (2 pole) 1 amp resistive @ 125 VAC (U.L. recognized, CSA certified) or 1 amp resistive @ 28 VDC.
 Letter codes B and G — (1 and 2 Poles) 0.4 Volt-amps (VA) maximum @ 28 V maximum (AC or DC).
Contact Resistance — 50 milliohms maximum.
Insulation Resistance — 1,000 megohms minimum.
Dielectric Strength — 1,000 volts RMS minimum at sea level.
Electrical Life — 60,000 cycles minimum at full load-resistive.
Maximum Allowable Installation Force on Plunger — 10 pounds.
 Multi-pole contacts do not make and break simultaneously.

MATERIALS

Case — Diallyl Phthalate.
Bushing — Brass, nickel plated.
Housing — Stainless steel.
Plunger — Thermoplastic.
Common Contact — Refer to contact material table above.
Center & End Contact — Refer to contact material table above.

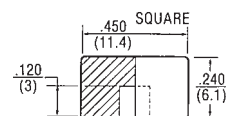
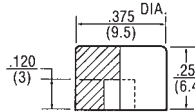
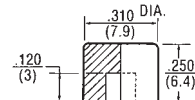
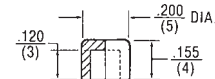
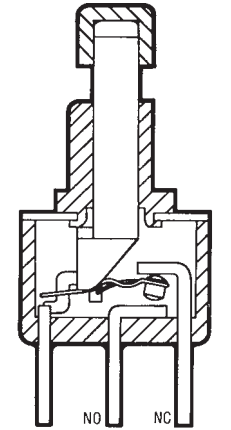

| Description | P/N | Color |
|--------------------|----------|-------|
| Small Cap .200 | W-KN-16 | Black |
| | W-KN-16A | White |
| | W-KN-16B | Red |
| Medium Cap .310 | W-KN-32 | Black |
| | W-KN-32A | White |
| Large Cap .375 | W-KN-17 | Black |
| | W-KN-17A | White |
| | W-KN-17B | Red |
| Square Cap .450 | W-KN-18 | Black |
| | W-KN-18A | White |
| | W-KN-18B | Red |

Right Angle P.C. Terminal

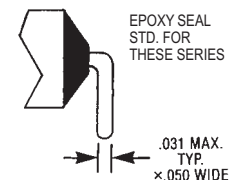

**Sensitive Snap-Action Pushbutton Switches —
P.C. Terminals (Momentary Action)**

PS SERIES 5 AMP. (S.P.)
1 AMP. (D.P.)
0.4VA

RIGHT ANGLE P.C. MOUNT SWITCHES

PS 9

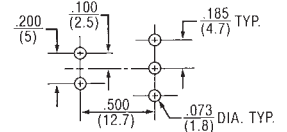
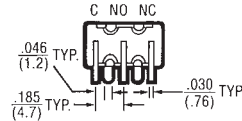
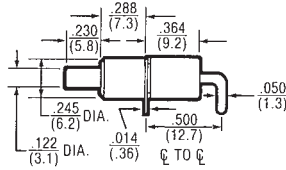
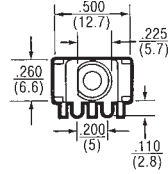

1 Pole P.C. Mounting

ONE POLE

EPOXY SEALED P.C. TERMINALS ARE SUPPLIED AS STANDARD FOR THESE OPTIONS.

PS 9

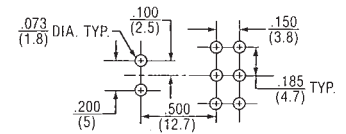
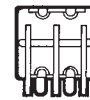
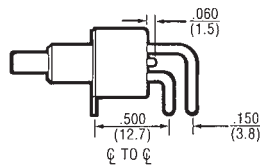
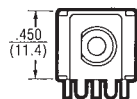

2 Pole P.C. Mounting

TWO POLE

EPOXY SEALED P.C. TERMINALS ARE SUPPLIED AS STANDARD FOR THESE OPTIONS.

PS 10

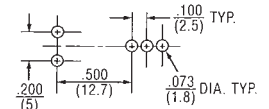
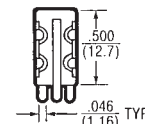
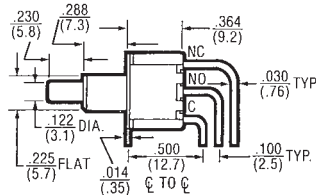
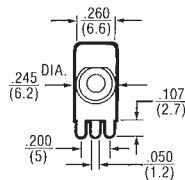

1 Pole P.C. Mounting

ONE POLE

EPOXY SEALED P.C. TERMINALS ARE SUPPLIED AS STANDARD FOR THESE OPTIONS.

PS 10

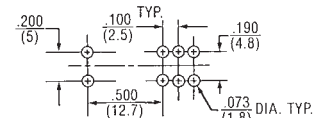
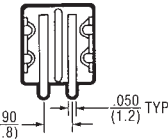
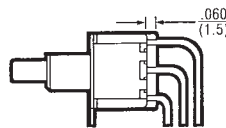
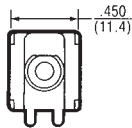

2 Pole P.C. Mounting

TWO POLE

EPOXY SEALED P.C. TERMINALS ARE SUPPLIED AS STANDARD FOR THESE OPTIONS.

PS 11

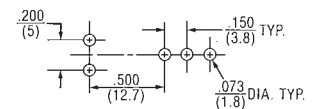
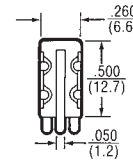
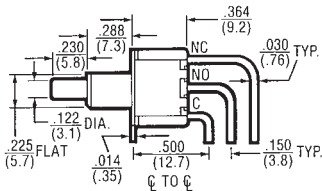
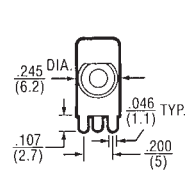

1 Pole P.C. Mounting

ONE POLE

EPOXY SEALED P.C. TERMINALS ARE SUPPLIED AS STANDARD FOR THESE OPTIONS.

PS 11

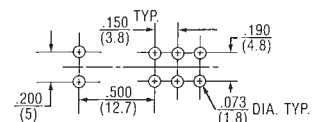
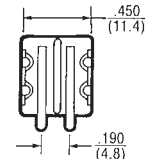
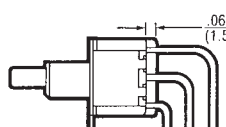
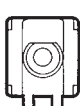

2 Pole P.C. Mounting

TWO POLE

EPOXY SEALED P.C. TERMINALS ARE SUPPLIED AS STANDARD FOR THESE OPTIONS.

Sensitive Snap-Action Pushbutton Switches — P.C. Terminals (Momentary Action)

PS SERIES 5 AMP. (S.P.)
1 AMP. (D.P.)
0.4 VA

VERTICAL P.C. MOUNT (.460 x .620 BRACKET)

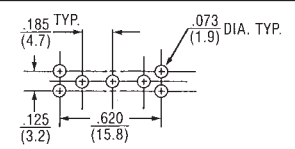
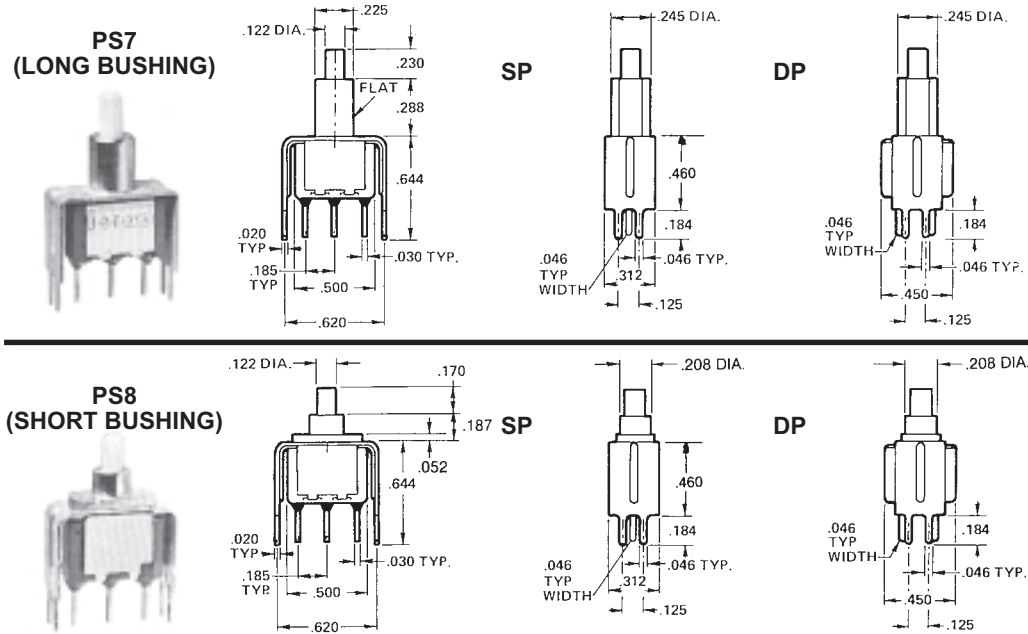

1 Pole P.C. Mounting

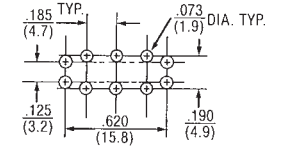

2 Pole P.C. Mounting

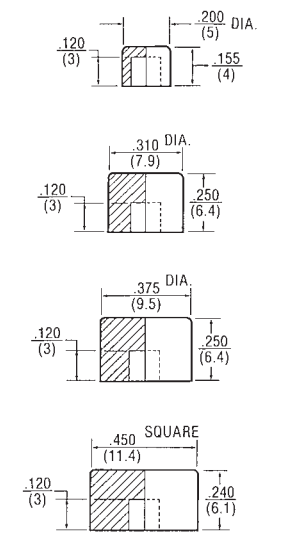

| Basic P/N | Terminal Type | Poles | Cap Size | Cap Color | Contact Material-Type |
|-----------|----------------------------------|------------------------|---|--------------------------------------|--|
| PS | 7 - PC Mounted 8 - PC Mounted | 1 - One ① 2 - Two ① | 0 - No Cap 1 - .200 Dia. 2 - .375 Dia. 3 - .450 Sq. 4 - .310 Dia. | 0 - No Cap 1 - Black 2 - White | B - Gold/Nickel/Brass ② G - Gold/Nickel/Silver ① ② Q - Coin Silver ① |

① Single pole circuit rated 5 amps, double pole circuit rated 1 amp.
② Ratings are 0.4 VA — 28 VAC or DC.

ORDERING EXAMPLES:

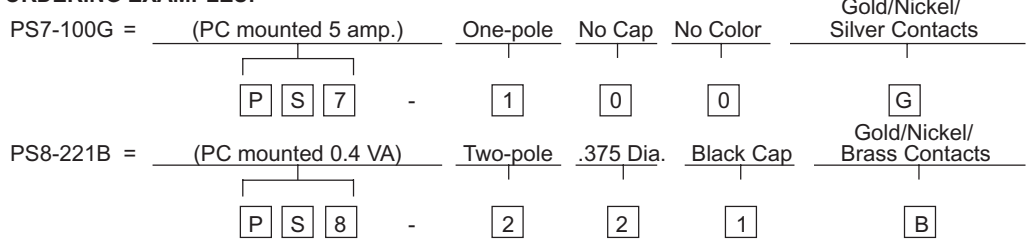

SPECIFICATIONS

Contact Rating — Letter codes G and Q (1 Pole) 5 amp resistive @ 125 VAC (U.L. recognized, CSA certified) or 5 amp resistive @ 28 VDC. (2 pole) 1 amp resistive @ 125 VAC (U.L. recognized, CSA certified) or 1 amp resistive @ 28 VDC.
 Letter codes B and G — (1 and 2 Poles) 0.4 Volt-amps (VA) maximum @ 28 V maximum (AC or DC).
Contact Resistance — 50 milliohms maximum.
Insulation Resistance — 1,000 megohms minimum.
Dielectric Strength — 1,000 volts RMS minimum at sea level.
Electrical Life — 60,000 cycles minimum at full load-resistive.
Maximum Allowable Installation Force on Plunger — 10 pounds.
 Multi-pole contacts do not make and break simultaneously.

MATERIALS

Case — Diallyl Phthalate.
Bushing — Brass, nickel plated.
Housing — Stainless steel.
Plunger — Thermoplastic.
Common Contact — Refer to contact material table above.
Center & End Contact — Refer to contact material table above.

| Description | P/N | Color |
|-----------------|----------|-------|
| Small Cap .200 | W-KN-16 | Black |
| | W-KN-16A | White |
| | W-KN-16B | Red |
| Medium Cap .310 | W-KN-32 | Black |
| | W-KN-32A | White |
| | W-KN-32B | Red |
| Large Cap .375 | W-KN-17 | Black |
| | W-KN-17A | White |
| | W-KN-17B | Red |
| Square Cap .450 | W-KN-18 | Black |
| | W-KN-18A | White |
| | W-KN-18B | Red |

Printed Circuit Terminal



Sensitive Snap-Action Pushbutton Switches — P.C. Terminals (Momentary Action)

PS SERIES 5 AMP. (S.P.)
1 AMP. (D.P.)
0.4 VA

VERTICAL P.C. MOUNT (.630 x .620 BRACKET)

PS71 (LONG BUSHING)

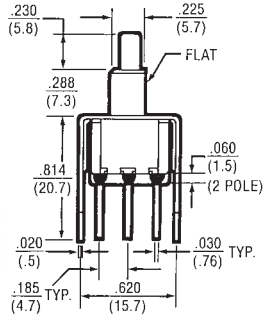
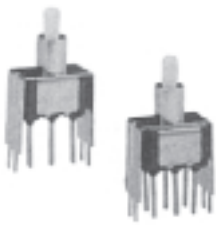

SP

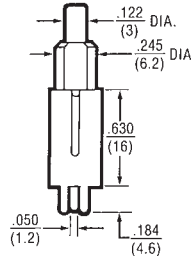

DP

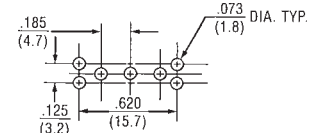
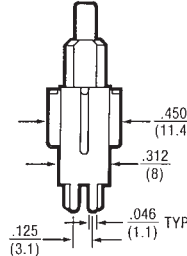

1 Pole P.C. Mounting

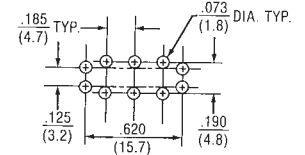

2 Pole P.C. Mounting

PS81 (SHORT BUSHING)

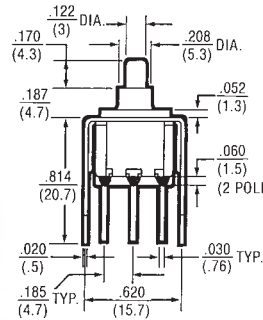
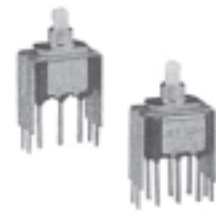

SP

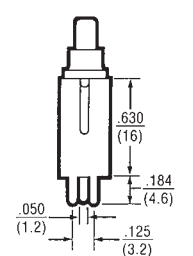

DP

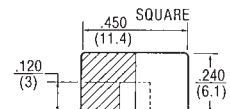
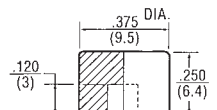
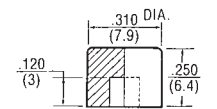
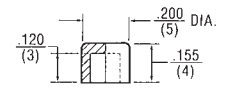
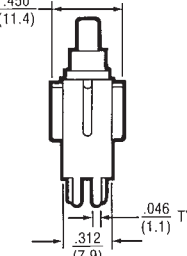

| Basic P/N | Terminal Type | Poles | Cap Size | Cap Color | Contact Material-Type |
|-----------|-----------------|-----------|---|-----------------------------------|---|
| PS | 71 - PC Mounted | 1 - One ① | 0 - No Cap | 0 - No Cap | B - Gold/Nickel/Brass ② |
| | 81 - PC Mounted | 2 - Two ① | 1 - .200 Dia. 2 - .375 Dia. 3 - .450 Sq. 4 - .310 Dia. | 1 - Black 2 - White 3 - Red | G - Gold/Nickel/Silver ① ② Q - Coin Silver ① |

① Single pole circuit rated 5 amps, double pole circuit rated 1 amp.
② Ratings are 0.4 VA — 28 VAC or DC.

ORDERING EXAMPLES:

PS71-100B= (PC mounted 0.4 VA) One-pole No Cap No Color Gold/Nickel/Brass Contacts
P S 71 - 1 0 0 B

PS81-221Q= (PC mounted 1 amp.) Two-pole .375 Dia. Black Cap Coin Silver Contacts
P S 81 - 2 2 1 Q

SPECIFICATIONS

Contact Rating — Letter codes G and Q (1 Pole) 5 amp resistive @ 125 VAC (U.L. recognized, CSA certified) or 5 amp resistive @ 28 VDC. (2 pole) 1 amp resistive @ 125 VAC (U.L. recognized, CSA certified) or 1 amp resistive @ 28 VDC.
 Letter codes B and G — (1 and 2 Poles) 0.4 Volt-amps (VA) maximum @ 28 V maximum (AC or DC).
Contact Resistance — 50 milliohms maximum.
Insulation Resistance — 1,000 megohms minimum.
Dielectric Strength — 1,000 volts RMS minimum at sea level.
Electrical Life — 60,000 cycles minimum at full load-resistive.
Maximum Allowable Installation Force on Plunger — 10 pounds.
 Multi-pole contacts do not make and break simultaneously.

MATERIALS

Case — Diallyl Phthalate.
Bushing — Brass, nickel plated.
Housing — Stainless steel.
Plunger — Thermoplastic.
Common Contact — Refer to contact material table above.
Center & End Contact — Refer to contact material table above.

| Description | P/N | Color |
|-----------------|----------|-------|
| Small Cap .200 | W-KN-16 | Black |
| | W-KN-16A | White |
| | W-KN-16B | Red |
| Medium Cap .310 | W-KN-32 | Black |
| | W-KN-32A | White |
| | W-KN-32B | Red |
| Large Cap .375 | W-KN-17 | Black |
| | W-KN-17A | White |
| | W-KN-17B | Red |
| Square Cap .450 | W-KN-18 | Black |
| | W-KN-18A | White |
| | W-KN-18B | Red |

Printed Circuit Terminal



**Sensitive Snap-Action Pushbutton Switches —
P.C. Terminals (Momentary Action)**

PS
SERIES 5 AMP. (S.P.)
1 AMP. (D.P.)
0.4 VA

VERTICAL P.C. MOUNT (.460 x .750 BRACKET)

**PS72
(LONG BUSHING)**

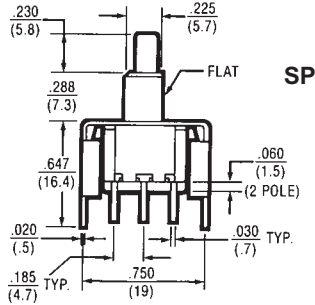

SP

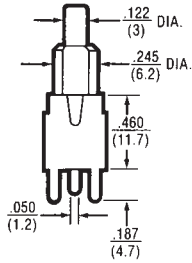

DP

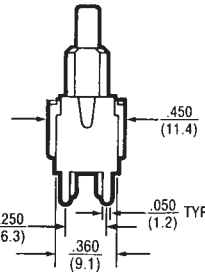

**PS82
(SHORT BUSHING)**

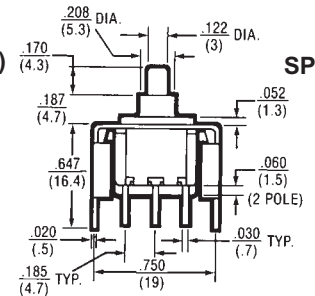
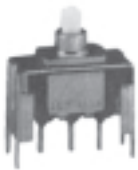

SP

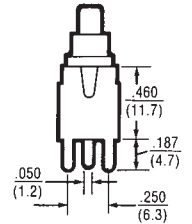

DP

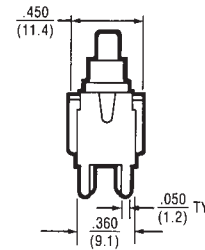

| Basic P/N | Terminal Type | Poles | Cap Size | Cap Color | Contact Material-Type |
|-----------|------------------------------------|------------------------|---|---|--|
| PS | 72 - PC Mounted 82 - PC Mounted | 1 - One ① 2 - Two ① | 0 - No Cap 1 - .200 Dia. 2 - .375 Dia. 3 - .450 Sq. 4 - .310 Dia. | 0 - No Cap 1 - Black 2 - White 3 - Red | B - Gold/Nickel/Brass ② G - Gold/Nickel/Silver ① ② Q - Coin Silver ① |

① Single pole circuit rated 5 amps, double pole circuit rated 1 amp.
② Ratings are 0.4 VA — 28 VAC or DC.

ORDERING EXAMPLES:

PS72-100Q= (PC mounted 5 amp.) One-pole No Cap No Color Coin Silver Contacts
P S 72 - 1 0 0 Q

PS82-221B= (PC mounted 0.4 VA) Two-pole .375 Dia. Black Cap Gold/Nickel/Brass Contacts
P S 82 - 2 2 1 B

SPECIFICATIONS

Contact Rating — Letter codes G and Q (1 Pole) 5 amp resistive @ 125 VAC (U.L. recognized, CSA certified) or 5 amp resistive @ 28 VDC. (2 pole) 1 amp resistive @ 125 VAC (U.L. recognized, CSA certified) or 1 amp resistive @ 28 VDC.
Letter codes B and G — (1 and 2 Poles) 0.4 Volt-amps (VA) maximum @ 28 V maximum (AC or DC).
Contact Resistance — 50 milliohms maximum.
Insulation Resistance — 1,000 megohms minimum.
Dielectric Strength — 1,000 volts RMS minimum at sea level.
Electrical Life — 60,000 cycles minimum at full load-resistive.
Maximum Allowable Installation Force on Plunger — 10 pounds.
 Multi-pole contacts do not make and break simultaneously.

MATERIALS

Case — Diallyl Phthalate.
Bushing — Brass, nickel plated.
Housing — Stainless steel.
Plunger — Thermoplastic.
Common Contact — Refer to contact material table above.
Center & End Contact — Refer to contact material table above.

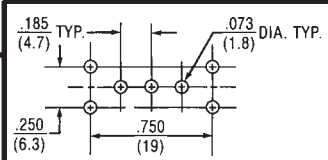

1 Pole P.C. Mounting

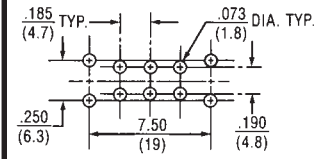

2 Pole P.C. Mounting

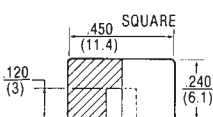
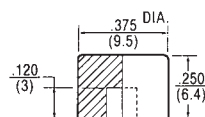
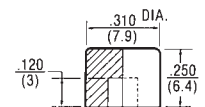
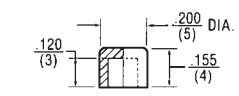

| Description | P/N | Color |
|-----------------|----------|-------|
| Small Cap .200 | W-KN-16 | Black |
| | W-KN-16A | White |
| | W-KN-16B | Red |
| Medium Cap .310 | W-KN-32 | Black |
| | W-KN-32A | White |
| | W-KN-32B | Red |
| Large Cap .375 | W-KN-17 | Black |
| | W-KN-17A | White |
| | W-KN-17B | Red |
| Square Cap .450 | W-KN-18 | Black |
| | W-KN-18A | White |
| | W-KN-18B | Red |

Printed Circuit Terminal



Sensitive Snap-Action Pushbutton Switches — P.C. Terminals (Momentary Action)

PS SERIES 5 AMP. (S.P.)
1 AMP (D.P.)
0.4 VA

VERTICAL P.C. MOUNT (.630 x .750 BRACKET)

PS73 (LONG BUSHING)

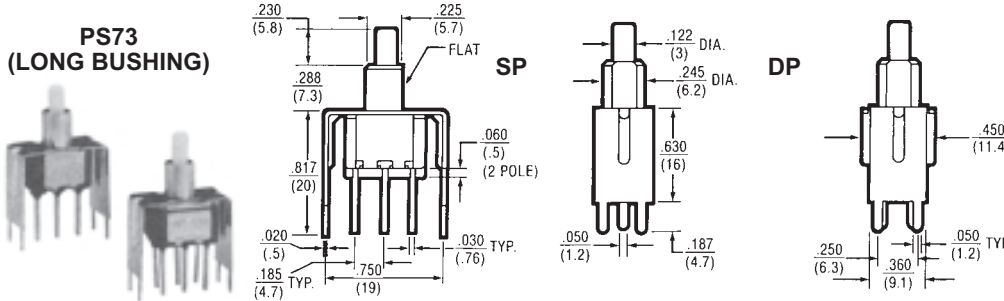

PS83 (SHORT BUSHING)

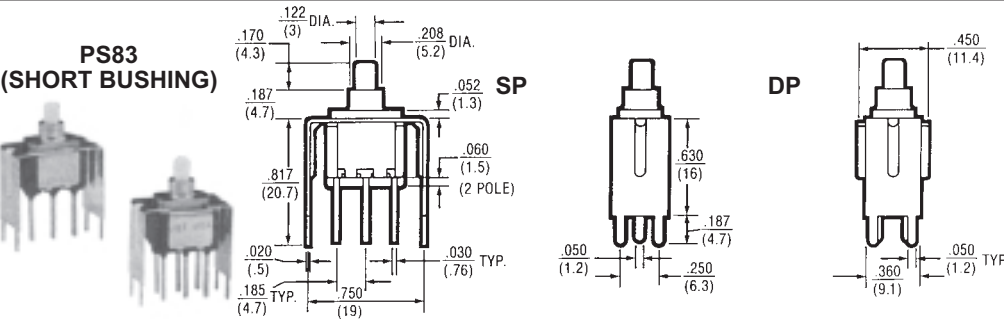

| Basic P/N | Terminal Type | Poles | Cap Size | Cap Color | Contact Material-Type |
|-----------|-----------------|---------|---------------|------------|---------------------------|
| PS | 73 - PC Mounted | 1 - One | 0 - No Cap | 0 - No Cap | B - Gold/Nickel/Brass ② |
| | 83 - PC Mounted | 2 - Two | 1 - .200 Dia. | 1 - Black | G - Gold/Nickel/Silver ①② |
| | | | 2 - .375 Dia. | 2 - White | Q - Coin Silver ② |
| | | | 3 - .450 Sq. | 3 - Red | |

- ① Single pole circuit rated 5 amps, double pole circuit rated 1 amp.
- ② Ratings are 0.4 VA — 28 VAC or DC.

ORDERING EXAMPLES:

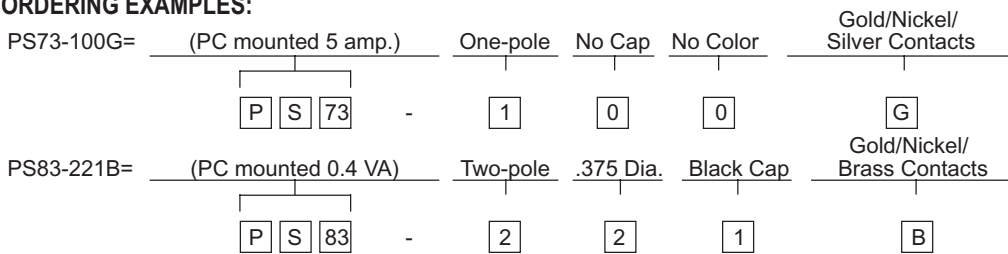

SPECIFICATIONS

Contact Rating — Letter codes G and Q (1 Pole) 5 amp resistive @ 125 VAC (U.L. recognized, CSA certified) or 5 amp resistive @ 28 VDC. (2 pole) 1 amp resistive @ 125 VAC (U.L. recognized, CSA certified) or 1 amp resistive @ 28 VDC.

Letter codes B and G — (1 and 2 Poles) 0.4 Volt-amps (VA) maximum @ 28 V maximum (AC or DC).

Contact Resistance — 50 milliohms maximum.

Insulation Resistance — 1,000 megohms minimum.

Dielectric Strength — 1,000 volts RMS minimum at sea level.

Electrical Life — 60,000 cycles minimum at full load-resistive.

Maximum Allowable Installation Force on Plunger — 10 pounds.

Multi-pole contacts do not make and break simultaneously.

MATERIALS

Case — Diallyl Phthalate.

Bushing — Brass, nickel plated.

Housing — Stainless steel.

Plunger — Thermoplastic.

Common Contact — Refer to contact material table above.

Center & End Contact — Refer to contact material table above.

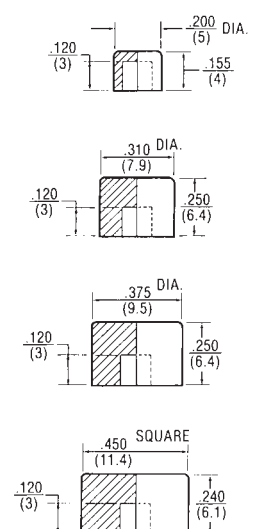
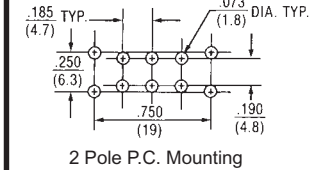
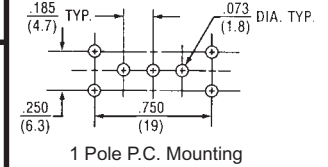

| Description | P/N | Color |
|-----------------|----------|-------|
| Small Cap .200 | W-KN-16 | Black |
| | W-KN-16A | White |
| | W-KN-16B | Red |
| Medium Cap .310 | W-KN-32 | Black |
| | W-KN-32A | White |
| | W-KN-32B | Red |
| Large Cap .375 | W-KN-17 | Black |
| | W-KN-17A | White |
| | W-KN-17B | Red |
| Square Cap .450 | W-KN-18 | Black |
| | W-KN-18A | White |
| | W-KN-18B | Red |

Printed Circuit Terminal



Sensitive Snap-Action Pushbutton Switches — Solder and P.C. Terminals (Momentary Action)

PS SERIES 5 AMP. (S.P.)
1 AMP. (D.P.)
0.4 VA

SNAP-IN MOUNT

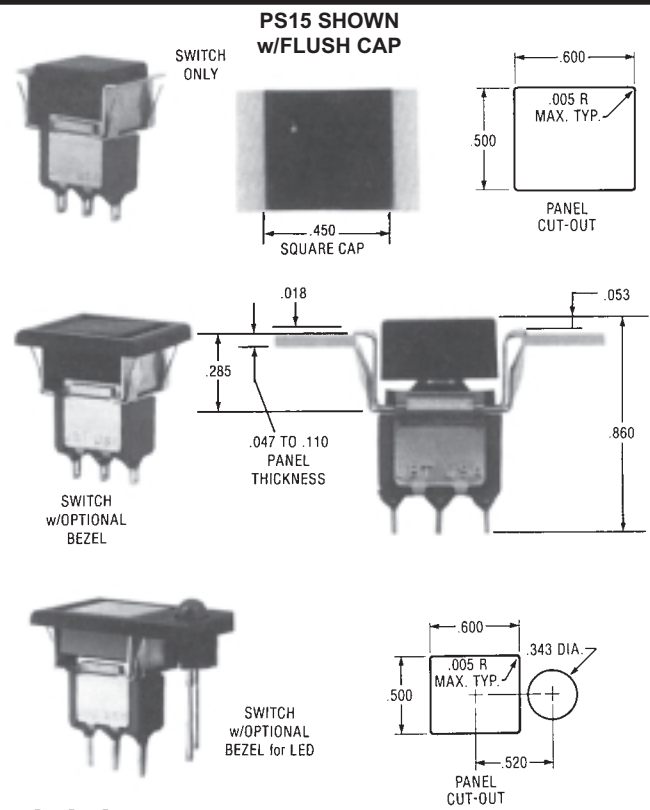
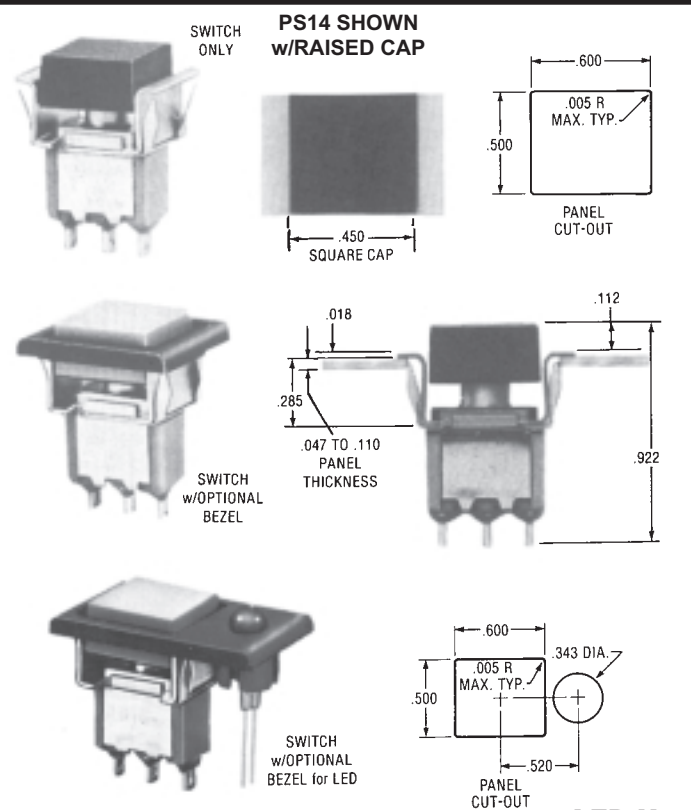

LED Not Included

| Basic P/N | Cap Configuration Terminal-Rating | Poles | Cap Size | Cap Color | Optional Features | |
|-----------|--|------------------------|----------------------------|---|---|--|
| | | | | | Bezel Color & Type | Contact Material-Type |
| PS | 14 - Raised Cap Solder Lug 15 - Flush Cap ③ Solder Lug 16 - Raised Cap PC Terminals 17 - Flush Cap ③ PC Terminals | 1 - One ① 2 - Two ① | 0 - No Cap 1 - .450 Sq. | 0 - No Cap 1 - White 2 - Black 3 - Red | 1 - White 2 - Black 3 - Red 4 - Black or LED | B - Gold/Nickel/Brass ② G - Gold/Nickel/Silver ① ② Q - Coin Silver ① |

① Single pole circuit rated 5 amps, double pole circuit rated 1 amp.

② Ratings are 0.4 VA — 28 BAC or DC.

③ Flush cap is flush to bezel, not to mounting bracket.

EXAMPLES:

PS14-100Q = Raised Cap, Solder Lug Terminals, 5 Amp, Single Pole, No Cap, Coin Silver Contacts

PS14-1134B = Raised Cap, Solder Lug Terminals, 0.4 VA Rating, Single Pole, .450 Square Red Cap, Black Bezel for LED, Gold/Brass Contact Material

SPECIFICATIONS

Contact Rating — Letter codes G and Q (1 Pole) 5 amp resistive @ 125 VAC (U.L. recognized, CSA certified) or 5 amp resistive @ 28 VDC. (2 pole) 1 amp resistive @ 125 VAC (U.L. recognized, CSA certified) or 1 amp resistive @ 28 VDC.

Letter codes B and G — (1 and 2 Poles) 0.4 Volt-amps (VA) maximum @ 28 V maximum (AC or DC).

Contact Resistance — 50 milliohms maximum.

Insulation Resistance — 1,000 megohms minimum.

Dielectric Strength — 1,000 volts RMS minimum at sea level.

Electrical Life — 60,000 cycles minimum at full load-resistive.

Maximum Allowable Installation Force on Plunger — 10 pounds. Multi-pole contacts do not make and break simultaneously.

MATERIALS

Case — Diallyl Phthalate.

Bushing — Brass, nickel plated.

Housing — Stainless steel.

Plunger — Thermoplastic.

Pushbutton Cap — Molded nylon.

Bezel — Molded nylon.

Common Contact — Refer to contact material table above.

Center & End Contact — Refer to contact material table above.

Solder Lug Terminal

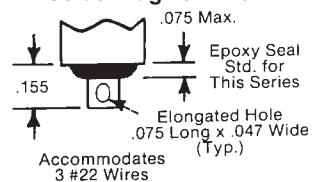

PC Terminal

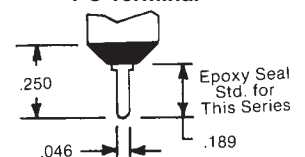

Sensitive Snap-Action Pushbutton Switches — Solder and P.C. Terminals (Momentary Action)

APPROXIMATE DIMENSIONS (For Optional Bezel Types Shown on Page 12)

OPTIONAL BEZEL TYPE 1, 2, 3 (SEE TABLE)
PS14 Shown w/Raised Cap

| Catalog No. | Color |
|-------------|-------|
| W-BZ-12 | Black |
| W-BZ-12A | White |
| W-BZ-12B | Red |

OPTIONAL BEZEL TYPE 1, 2, 3 (SEE TABLE)
PS15 Shown w/Flush Cap

| Catalog No. | Color |
|-------------|-------|
| W-BZ-12 | Black |
| W-BZ-12A | White |
| W-BZ-12B | Red |

OPTIONAL BEZEL TYPE 4 FOR LED
PS14 Shown w/Raised Cap

LED (.200 DIA.) SNAPS SECURELY INTO BEZEL. HEIGHT DEPENDS ON LED USED

SWITCHES SUPPLIED WITHOUT LED LAMPS.

| Catalog No. | Color |
|-------------|-------|
| W-BZ-15 | Black |

OPTIONAL BEZEL TYPE 4 FOR LED
PS17 Shown w/Flush Cap

LED (.200 DIA.) SNAPS SECURELY INTO BEZEL. HEIGHT DEPENDS ON LED USED

SWITCHES SUPPLIED WITHOUT LED LAMPS.

| Catalog No. | Color |
|-------------|-------|
| W-BZ-15 | Black |

OPTIONAL MOUNTING CLIP (For Use With PS14 Thru PS17 Series Only)

- For thick plastic panel mount applications (.094" - .125" thick)
- For availability consult Electroswitch.

Looking for pricing, stock, or lifecycle information?

Click below to explore more details on WIN SOURCE:

 [View PS82-100G on WIN SOURCE](#)

 [Electroswitch](#) Information

Optimize Your Supply Chain with WIN SOURCE Solutions

-  Global Sourcing Solution
-  Obsolete Management
-  Cost Control Management
-  Shortage Management
-  Alternative Solution
-  Excess Inventory Management