



# THE DATASHEET OF NDPL-04-V



# NDP series

Piano style • dual in line switches



## DISTINCTIVE FEATURES

2 to 12 Way

Self-cleaning wiping contacts

Gold plated terminals

Spray washable with tape seal



## ENVIRONMENTAL SPECIFICATIONS

- Operating Temperature: -20 °C to +70 °C (-4 °F to +158 °F)
- Storage Temperature: -40 °C to +85 °C (-40 °F to +185 °F)
- Spray washable (with tape seal)



## ELECTRICAL SPECIFICATIONS

- Max. Current/Voltage Rating:
  - Switching: 25 mA 24 VDC
  - Contact rating: 100 mA 50 VDC
- Initial Contact Resistance: 50 mΩ max
- Insulation Resistance: 100 MΩ min. at 500 VDC
- Dielectric Strength: 500 VAC min.
- Electrical Life: 2,000 cycles



## MECHANICAL SPECIFICATIONS

- Operating force: 400 gf (3.92 N) max



## MATERIALS

- Case & Actuator: PBT
- Base: PA66
- Contact: Gold plated
- Terminal: Gold plated brass
- Protection tape: Polyimide

The company reserves the right to change specifications without notice.

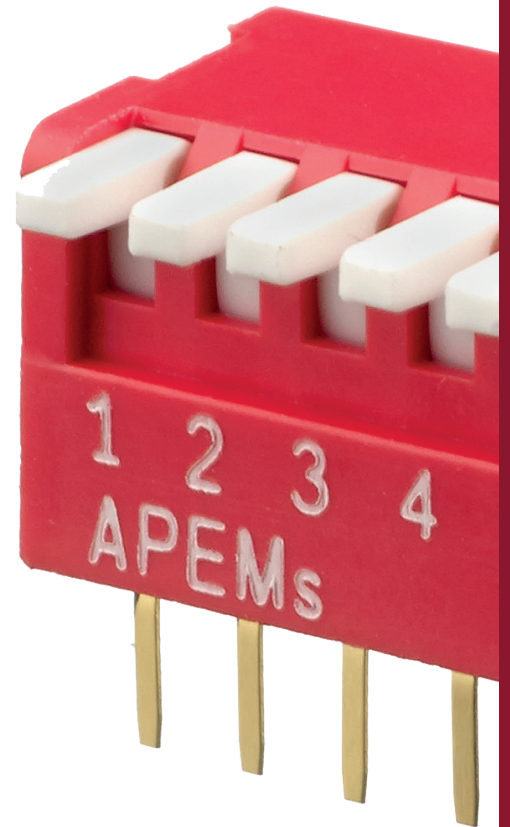
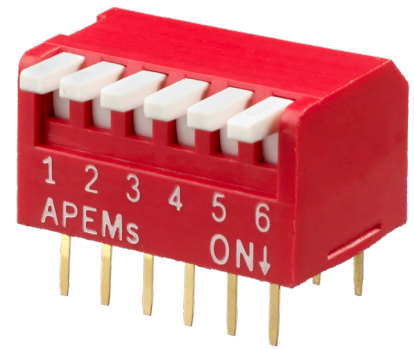

# NDP series

Piano style • dual in line switches



## PACKAGING

IC TUBE THROUGH-HOLE

Number of ways	No tape seal	With tape seal
2	70 pcs	65 pcs
3	50 pcs	49 pcs
4		39 pcs
5		32 pcs
6		27 pcs
7		24 pcs
8		21 pcs
9		19 pcs
10		17 pcs
12		14 pcs



## CIRCUIT



2,3,4,5,6,7,8,9,10,12 way only



## PCB LAYOUT

THROUGH-HOLE

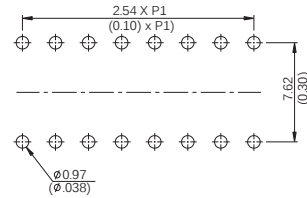

# NDP series

Piano style • dual in line switches



## BUILD YOUR PART NUMBER

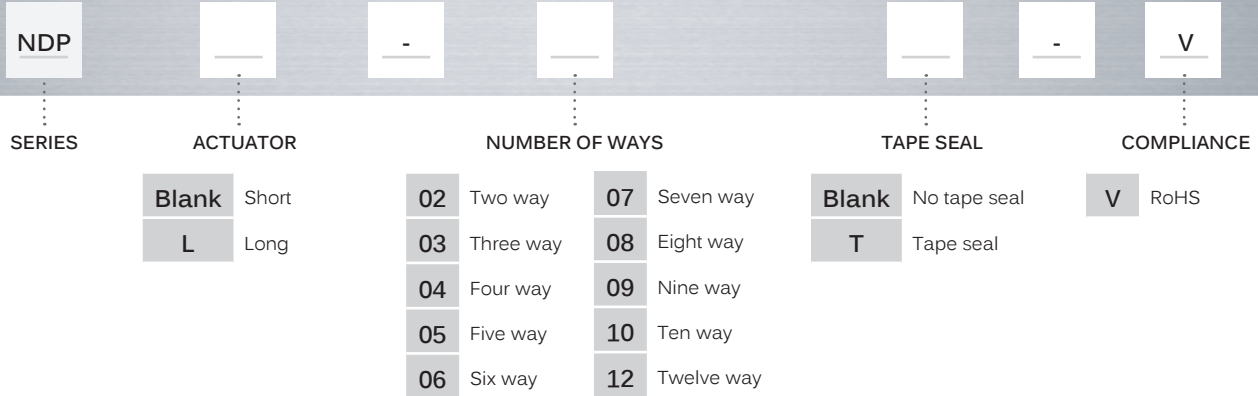

## 8 WAY STANDARD PROFILE THROUGH-HOLE PIANO STYLE

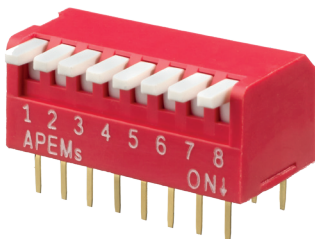

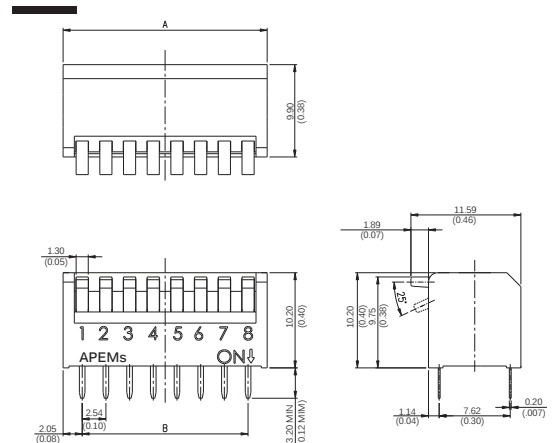

Number of ways	Dimension A	Dimension B
2	6.64 (0.26)	2.54 (0.1)
3	9.18 (0.36)	5.08 (0.2)
4	11.72 (0.46)	7.62 (0.3)
5	14.26 (0.56)	10.16 (0.4)
6	16.80 (0.66)	12.70 (0.5)
7	19.34 (0.76)	15.24 (0.6)
8	21.88 (0.86)	17.78 (0.7)
9	24.42 (0.96)	20.32 (0.8)
10	26.96 (1.06)	22.86 (0.9)
12	32.04 (1.26)	27.94 (1.1)



## Looking for pricing, stock, or lifecycle information?

Click below to explore more details on WIN SOURCE:

-  [View NDPL-04-V on WIN SOURCE](#)
-  [Apem Inc. Information](#)

## Optimize Your Supply Chain with WIN SOURCE Solutions

-  Global Sourcing Solution
-  Obsolete Management
-  Cost Control Management
-  Shortage Management
-  Alternative Solution
-  Excess Inventory Management