



THE DATASHEET OF CX2156NLT



CX2156NL

BALUN TRANSFORMER, 1:1
2.3 - 2700 MHz
IMPEDANCE = 75 OHMS
SURFACE MOUNT

NOTES: UNLESS OTHERWISE SPECIFIED:

1. OPERATING TEMPERATURE: -40°C TO +85°C
2. STORAGE TEMPERATURE: -20°C TO +125°C
3. JEDEC MOISTURE SENSITIVITY LEVEL 1
4. DIMENSIONS ARE IN MM [INCHES] WITH THE FOLLOWING TOLERANCE:

.X = ±0.1 [±.004]
.XX = ±0.05 [±.002]

5. OPTIONAL TAPE & REEL PACKAGING CAN BE ORDERED BY ADDING

A "T" SUFFIX TO THE PART NUMBER. ie: CX2156NLT

6. ROHS COMPLIANT

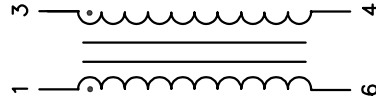

SCHEMATIC

ELECTRICAL SPECIFICATIONS @ 25°C:

INSERTION LOSS:

FREQUENCY	CALCULATED ATTENUATION
2.3 MHz	-0.4 dB MAXIMUM
500 MHz	-0.6 dB MAXIMUM
1000 MHz	-1.0 dB MAXIMUM
2000 MHz	-1.5 dB MAXIMUM
2700 MHz	-2.2 dB MAXIMUM

MECHANICAL SPECIFICATIONS:

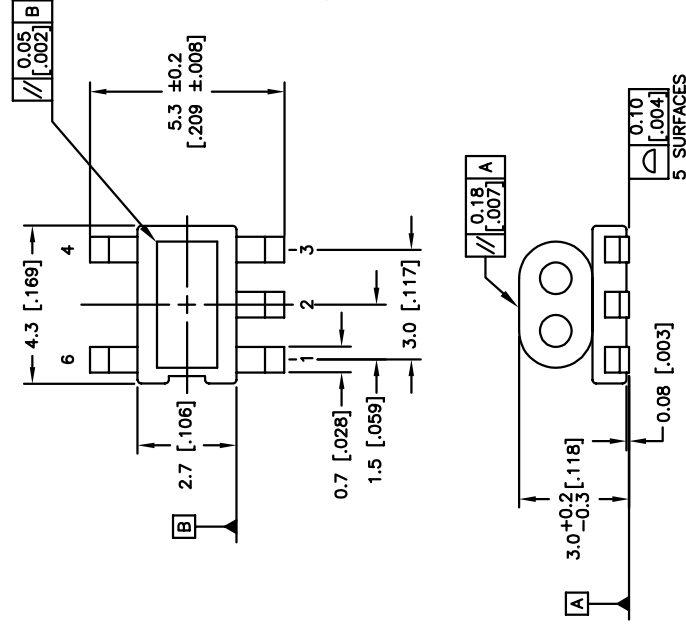

SUGGESTED LAND PATTERN

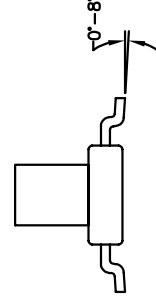

Looking for pricing, stock, or lifecycle information?

Click below to explore more details on WIN SOURCE:

 [View CX2156NLT on WIN SOURCE](#)

 [Pulse Information](#)

Optimize Your Supply Chain with WIN SOURCE Solutions

-  Global Sourcing Solution
-  Obsolete Management
-  Cost Control Management
-  Shortage Management
-  Alternative Solution
-  Excess Inventory Management