

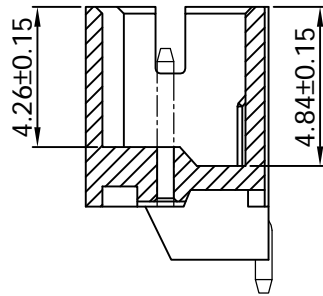

**THE DATASHEET OF**  
**4392**

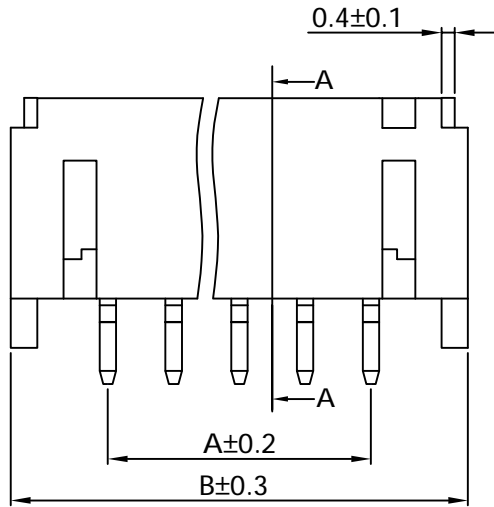

環保物料專用  
RoHS compliant



Section A-A

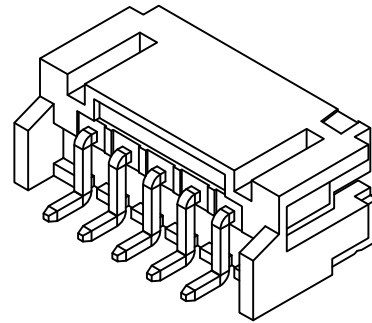

Specifications  
 Current Rating :2A AC,DC  
 Voltage rating :100V AC,DC  
 Temperature range :−25°C~+85°C  
 Contact resistance :20mΩMax  
 Insulation resistance :1000MΩMin  
 Withstanding voltage :800 V AC/minute  
 Pin Material :Brass  
 Finished :Tin-plated  
 Housing Mateial :Nylon-6T,UL94 V -0  
 Color :BLACK

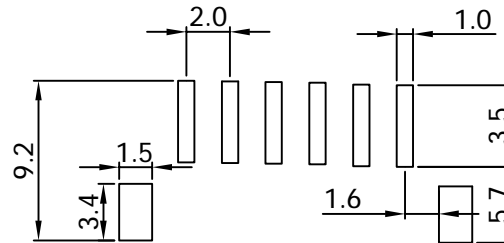
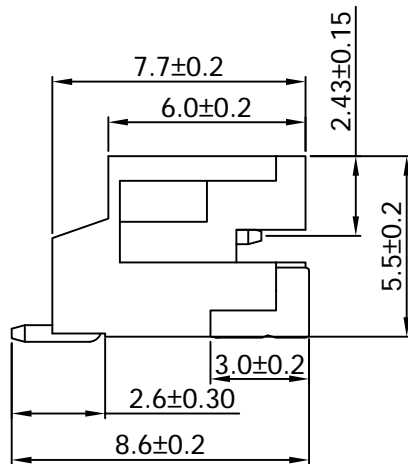
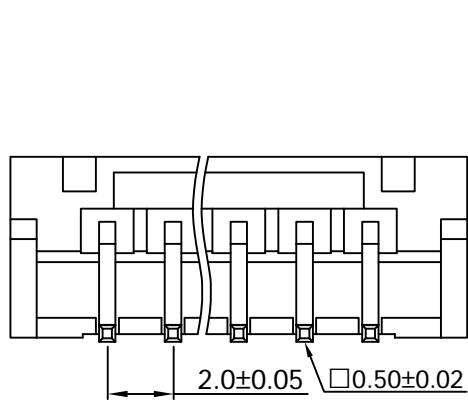

P.C.B Hole Layout

Circuits	Dimension mm	
	A	B
02	2.00	8.00
03	4.00	10.00
04	6.00	12.00
05	8.00	14.00
06	10.00	16.00
07	12.00	18.00
08	14.00	20.00
09	16.00	22.00
10	18.00	24.00
11	20.00	26.00
12	22.00	28.00
13	24.00	30.00
14	26.00	32.00
15	28.00	34.00
16	30.00	36.00



DESCRIPTION(內容):  
2.0mm Wafer 90° SMT

DRAWN(製圖):  
*Tom Liu*

CHECKED(確認):  
*Jack Wu*

APPROVAL(核准):  
*Kane He*

GENERAL TOLERANCE

LINEAR ANGLES

X.: ±0.30 X°: ±5.0°

X.X: ±0.20 X.X°: ±3.0°

X.XX: ±0.15 X.XX°: ±2.0°

X.XXX: ±0.10 X.XXX°: ±1.0°

REV:

A/1

UNIT:

mm

SHEET:

1/1

REV

1

2

3

4

DESCRIPTION

ORIGINAL

DATE

Aug-16-2019

A4

SCALE(比例):  
1:XX

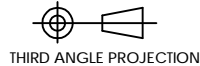

PART NO:  
(料號) CW2001-XXT-H01-BD-A  
DWG NO(圖號): KWRD1908016-007

A

B

C

D

E

FILE NO: KW-4E-09

## Looking for pricing, stock, or lifecycle information?

Click below to explore more details on WIN SOURCE:

-  [View 4392 on WIN SOURCE](#)
-  [Adafruit Industries LLC Information](#)

## Optimize Your Supply Chain with WIN SOURCE Solutions

-  Global Sourcing Solution
-  Obsolete Management
-  Cost Control Management
-  Shortage Management
-  Alternative Solution
-  Excess Inventory Management