



**THE DATASHEET OF  
2SH-C-02-TS**



APPROVED: \_\_\_\_\_  
 DATE: \_\_\_\_\_ TITLE: \_\_\_\_\_

Rev	AWO #	Description	Date	Appr
-		RELEASED	4/7/05	
A		ADDED DIM.	4/25/13	

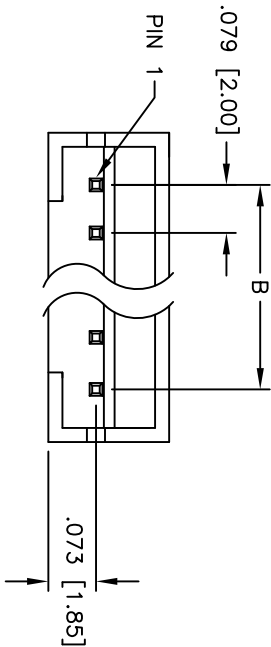

PCB LAYOUT

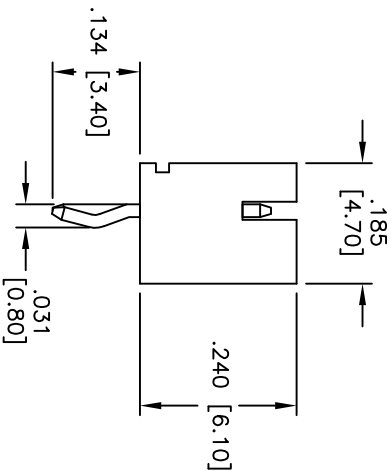
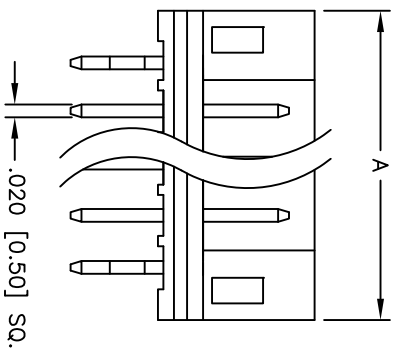
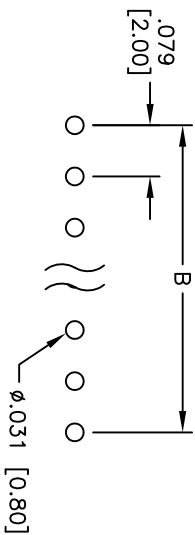

**SPECIFICATIONS:**

Material: Insulator: Nylon 66, rated UL 94V-0  
 Insulator color: White  
 Contacts: Brass

Plating: Tin over Copper underplate overall

Electrical: Operating voltage: 100 VAC max

Current rating: 2 Amps max

Contact resistance: 10 mohms max

Insulation resistance: 1,000 Mohms min @ 500 VDC

Dielectric withstanding voltage: 1,000 VAC for 1 minute

Temperature Rating:

Operating temperature: -25°C to +85°C

Environmental:

Lead free, RoHS compliant

Positions: 2 thru 15  
 A = .079 [2.00] x No. of Positions + .075 [1.90]  
 B = .079 [2.00] x No. of Spaces

**ADAM TECH**

909 Railway Avenue, Union, NJ 07083  
 Phone: 908-687-5000 Fax: 908-687-5710

TITLE: .079 [2.00] SHROUNDED HEADER  
 STRAIGHT, PCB

UNLESS OTHERWISE SPECIFIED ALL DIMENSIONS ARE INCHES [MM]		TOLERANCES: EXCEPT AS NOTED	
.X	± .10	ØX	± .10
.XX	± .020	ØXXX	± .015
.XXX	± .015	ØXXXX	± .010
APPROVALS	DATE		
DRAWN	SS	4/7/05	
CHECKED			
APPROVED			
SIZE	PART NO.	SCALE:	REV.
X	2SH-C-XX-TS	NTS	A
REF:		SHEET	1 OF 1

6

5

4

3

2

1

## Looking for pricing, stock, or lifecycle information?

Click below to explore more details on WIN SOURCE:

- ⊖ [View 2SH-C-02-TS on WIN SOURCE](#)
- ⊖ [Adam Technologies, Inc. Information](#)

## Optimize Your Supply Chain with WIN SOURCE Solutions

- ✓ Global Sourcing Solution
- ✓ Obsolete Management
- ✓ Cost Control Management
- ✓ Shortage Management
- ✓ Alternative Solution
- ✓ Excess Inventory Management