

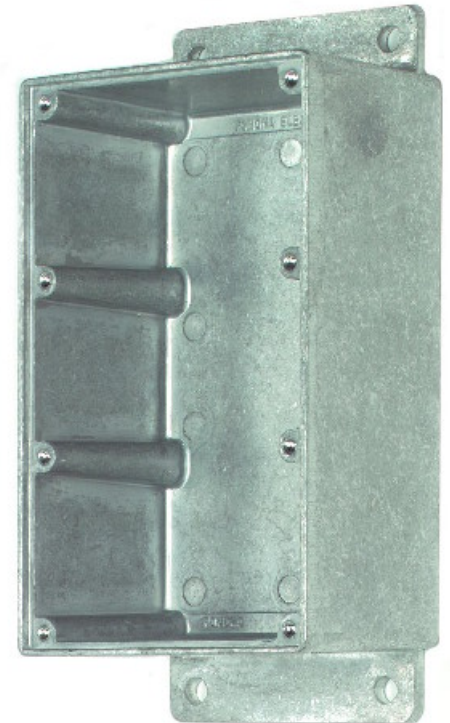

**THE DATASHEET OF**  
**2901**

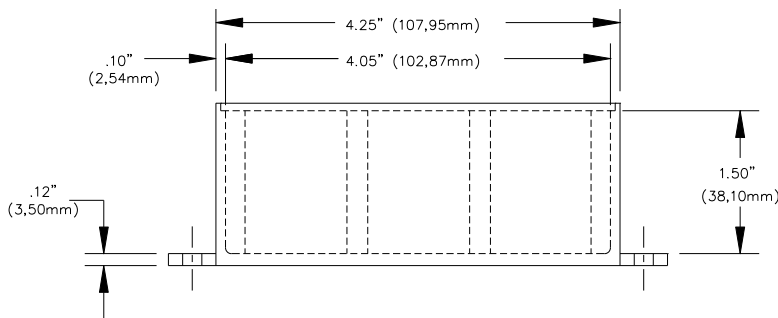

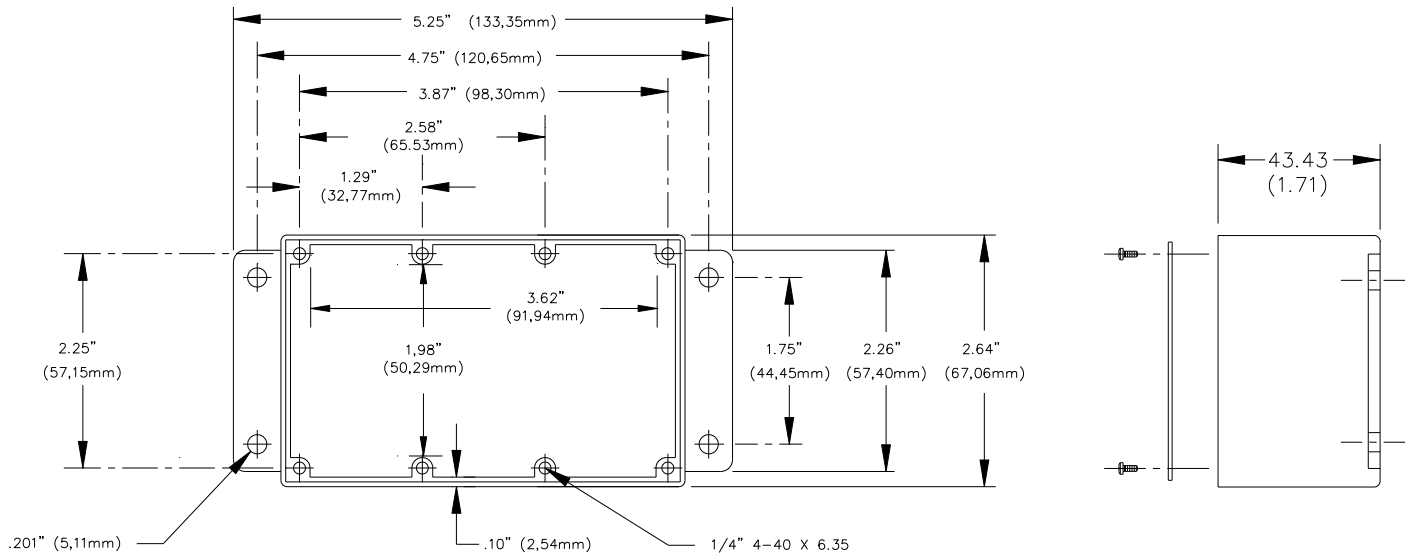

Model 2906

### MATERIALS:

Screws: Steel, 8 ea. #4-40 x 1/4" Pan Head (Per MS 35208-12 with clear irridite)

Cover: .040 Thick aluminum #1100-H14

Finish: Clear anodized per MIL-A-8625

Shielded Housing: Die cast aluminum alloy A380 or A384

Model 2901: Blue baked enamel per Federal Standard 595 #25109 over primer wash per DOD-P-15328.

Model 2906: Finish: None

### RATINGS:

Operating Temperature: +302°F (+150°C) Max.

### ORDERING INFORMATION:

Model: 2901 (blue baked enamel)

Model: 2906 (bare die cast aluminum)

All dimensions are in inches. Tolerances (except noted): .xx = ±.02" (.51 mm), .xxx = ±.005" (.127 mm).



All specifications are to the latest revisions. Specifications are subject to change without notice.

Registered trademarks are the property of their respective companies.

Sales: 800-490-2361 Fax: 888-403-3360 Technical Support: 800-241-2060 (technicalsupport@pomonatest.com)  
For "Where to Buy" information, visit the Pomona web site at [www.pomonaelectronics.com](http://www.pomonaelectronics.com)

## Looking for pricing, stock, or lifecycle information?

Click below to explore more details on WIN SOURCE:

-  [View 2901 on WIN SOURCE](#)
-  [Pomona Electronics](#) Information

## Optimize Your Supply Chain with WIN SOURCE Solutions

-  Global Sourcing Solution
-  Obsolete Management
-  Cost Control Management
-  Shortage Management
-  Alternative Solution
-  Excess Inventory Management