



**THE DATASHEET OF  
L16P015D15**



# Hall Effect Current Sensors

## 3 to 25 Amp Applications — Open Loop

- Compact PCB Mount Design
- Voltage Output type
- Very High Linearity
- 15V Supply Voltage
- CE EN50178 (pending)



Specifications Measured at 25°C, RL-10KΩ, Vcc=+15V

Specification	L16P003D15	L16P005D15	L16P010D15	L16P015D15	L16P020D15	L16P025D15
Nominal Primary DC Current (If)	3A	5A	10A	15A	20A	25A
Maximum Current If(max)	±9	±15	±30	±45	±60	±75
Output Voltage @ If	V <sub>OUT</sub> 4V					
Offset Voltage V <sub>OE</sub>	< ±40mV					
Accuracy @ If <sup>2</sup>	< ± 1% of If					
Output Linearity <sup>2</sup> (0..If MAX)	E <sub>L</sub> < ± 1% of If					
Power Supply V <sub>cc</sub>	±15V ±5%					
Response Time t <sub>r</sub>	<5μs					
Current Consumption I <sub>c</sub>	±12mA typ					
Output Temperature Characteristic TCE <sub>G</sub>	<±0.1% / °C					
Offset Temperature Characteristic V <sub>OT</sub>	± 1.2mV / °C typ					
Hysteresis Allowance @ If=0 V <sub>OH</sub>	<±25mV					
Withstand Voltage (50/60Hz) V <sub>d</sub>	2,000VACrms for 1 minute (Sensing Current 0.5mA)					
Insulation Resistance @ 500VDC R <sub>IS</sub>	≥ 500MΩ					
Operating Bandwidth <sup>1</sup> (-3dB) f	DC - 35kHz					
Operating Temperature T <sub>A</sub>	-10 - +80°C					
Storage Temperature T <sub>s</sub>	-20 - +85°C					

<sup>1</sup> Small signal only; derating needed to avoid excessive core heating at high frequency

<sup>2</sup> Without offset

### Package & Weight Information

QTY/Box	Weight/each(g)
100	10

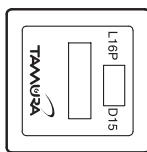

View A

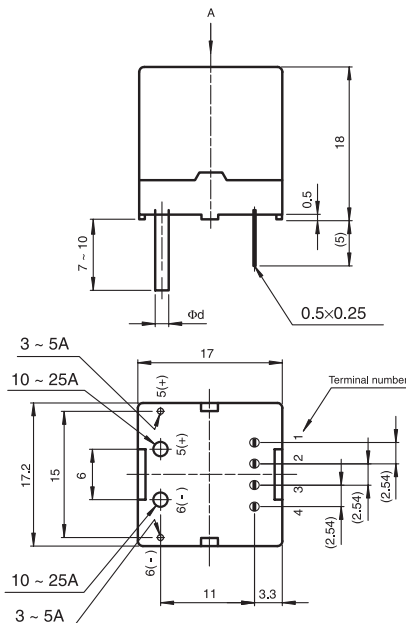

Types	Rated current	φ d
L16P003D15	3A	φ 0.5
L16P005D15	5A	φ 0.6
L16P010D15	10A	φ 0.8
L16P015D15	15A	φ 1.2
L16P020D15	20A	φ 1.4
L16P025D15	25A	φ 1.4

Terminal number	
1	- 15V
2	0V
3	+15V
4	OUT
5	+IN
6	- IN

### TAMURA CORPORATION

43352 Business Park Drive. | P.O. Box 892230 Temecula, CA 92589-2230 | www.tamuracorp.com  
 USA | Japan | United Kingdom | Hong Kong  
 Tel: 800-872-6624 | Tel: 81 (0)3 3978-2111 | Tel: 44 (0) 1380 731 700 | Tel: 852-2389-4321  
 Fax: 909-676-9482 | Fax: 81 (0)3 3923-0230 | Fax: 44 (0) 1380 731 702 | Fax: 852-2341-9689

## Looking for pricing, stock, or lifecycle information?

Click below to explore more details on WIN SOURCE:

 [View L16P015D15 on WIN SOURCE](#)

 [Tamura Information](#)

## Optimize Your Supply Chain with WIN SOURCE Solutions

-  Global Sourcing Solution
-  Obsolete Management
-  Cost Control Management
-  Shortage Management
-  Alternative Solution
-  Excess Inventory Management