

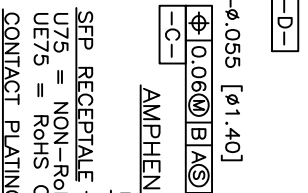

**THE DATASHEET OF
UE75-A20-6000T**

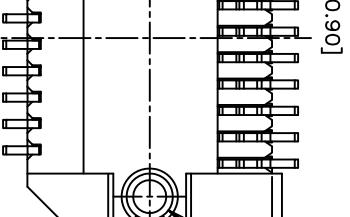

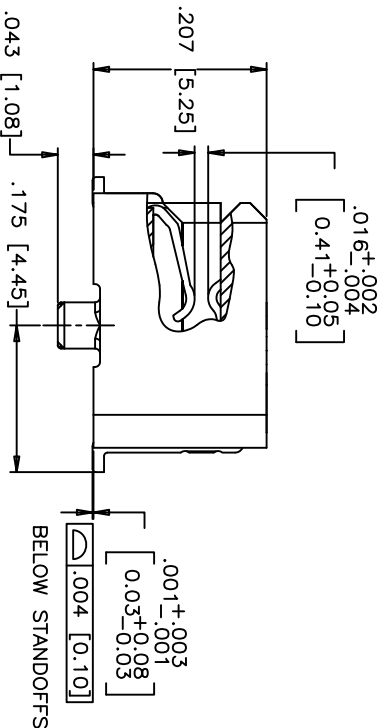
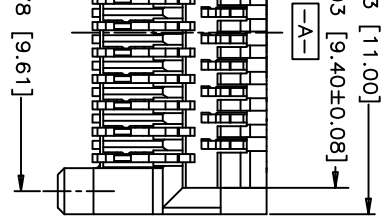
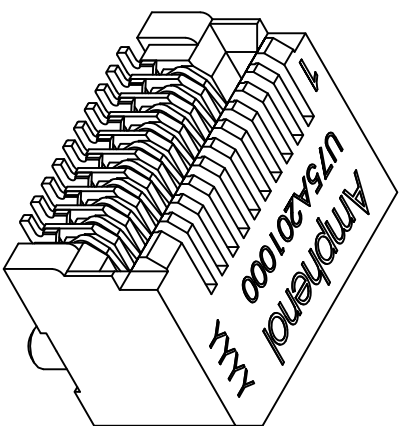
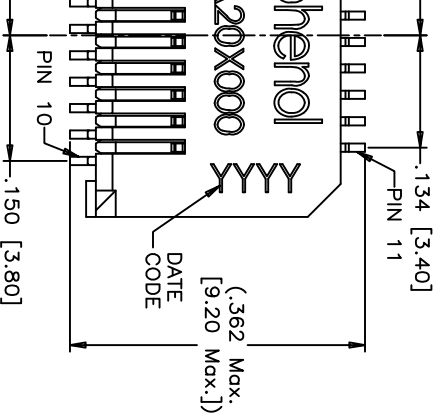

AMPHENOL PART NUMBER CONFIGURATION

UX75 - A 20 - X 0 0 X T

SFP RECEPTACLE
 U75 = NON-ROHS
 UET5 = ROHS COMPLIANT
 CONTACT PLATING
 LUBRICANT OPTION ON MATING AREA
 0 = NO
 1 = YES

(FOR U75 NON-ROHS)
 1 = PLATING OPTION 1 (SEE MATERIAL NOTES)
 4 = PLATING OPTION 4 (SEE MATERIAL NOTES)

(FOR UET5 ROHS)
 2 = PLATING OPTION 2 (SEE MATERIAL NOTES)
 3 = PLATING OPTION 3 (SEE MATERIAL NOTES)
 5 = PLATING OPTION 5 (SEE MATERIAL NOTES)
 6 = PLATING OPTION 6 (SEE MATERIAL NOTES)

REVISIONS				
SYM	ZONE	ECN, ERN NO.	DATE	APPRD.
K		UPDATED MATERIAL FOR HOUSING	MAR29/07	J.S.
L		UPDATED	APR16/08	A.G.
M		UPDATED	MAR 14/11	J.S.
N		UPDATED	NOV 21/11	J.S.
P		UPDATED	JUL 16/12	J.S.

THIS IS A CAD DRAWING. DO NOT MANUALLY REVISE.

MATERIAL NOTES:

PLASTIC HOUSING:
 HIGH TEMPERATURE LCP
 FLAMMABILITY RATING UL94V-0.

CONTACTS:

PHOSPHOR BRONZE

PLATING OPTION 1: (U75 ONLY)

30µ" [0.76 µm] MIN. GOLD ON MATING AREA AND 150-300 µ" (3.81-7.62 µm) MIN. TIN/LEAD (90/10) PLATING ON TERMINATION OVER 50µ" [1.27 µm] MIN. NICKEL UNDER LAYER.

PLATING OPTION 2: (ROHS FOR UET5 ONLY)

30µ" [0.76 µm] MIN. GOLD ON MATING AREA AND 2 µ" (0.05 µm) GOLD FLASH PLATING ON TERMINATION OVER 50µ" [1.27 µm] MIN. NICKEL UNDER LAYER.

PLATING OPTION 3: (ROHS FOR UET5 ONLY)

30µ" [0.76 µm] MIN. GOLD ON MATING AREA AND 150-300 µ" (3.81-7.62 µm) MIN. LOW WHISKER MATTE TIN PLATING ON TERMINATION OVER 50µ" [1.27 µm] MIN. NICKEL UNDER LAYER.

PLATING OPTION 4: (FOR U75 ONLY)

15µ" [0.38 µm] MIN. GOLD ON MATING AREA AND 150-300 µ" (3.81-7.62 µm) MIN. TIN/LEAD (90/10) PLATING ON TERMINATION OVER 50µ" [1.27 µm] MIN. NICKEL UNDER LAYER.

PLATING OPTION 5: (ROHS FOR UET5 ONLY)

15µ" [0.38 µm] MIN. GOLD ON MATING AREA AND 2 µ" (0.05 µm) GOLD FLASH PLATING ON TERMINATION OVER 50µ" [1.27 µm] MIN. NICKEL UNDER LAYER.

PLATING OPTION 6: (ROHS FOR UET5 ONLY)

15µ" [0.38 µm] MIN. GOLD ON MATING AREA AND 150-300 µ" (3.81-7.62 µm) MIN. LOW WHISKER MATTE TIN PLATING ON TERMINATION OVER 50µ" [1.27 µm] MIN. NICKEL UNDER LAYER.
 LUBRICANT OPTION: LUBRICANT CAN BE ADDED ON THE CONTACTS MATING AREA (SEE P/N FOR THE OPTION)

PACKAGING:
 TAPE AND REEL.

TEMPERATURE RANGE:
 -40°C TO +85°C

FOR ANY PURPOSE OR USED FOR MANUFACTURING ONLY FROM AMPHENOL CANADA CORP.

GENERAL TOLERANCES		INCH		MILLIMETERS	
DECIMALS	X.XXX±0.010	X.X±0.25		X.X±0.025	
ANGLES	X°±1°			X°±0.5°	

DRAWN	J.SI	DATE	DESIGNED	J.SI	DATE
CHECKED	X				
I. E. APPRD.					
Q. A. APPRD.					

DWG	DRAWING NO.	TITLE
A	P-UX75-A20-X00XX	SFP 20 POSITION HIGH SPEED CONNECTOR RECEPTACLE FIXED BOARD, RIGHT ANGLE SMT OPTIONAL PLATING AND LUBRICANT ON MATING

DIMENSIONS ARE IN INCHES [mm]		CODE	ID. NO.
X			
0.3554			

SCALE	4/1	WT.	SURF.	SHEET	1 of 3

Amphenol Canada Corp.

REVISIONS				
SYM	ZONE	ECN, ERN NO.	DATE	APPRD.
K		UPDATED MATERIAL FOR HOUSING	MAR29/07	J.S.
L		UPDATED	APR16/08	A.G.
M		UPDATED	MAR 14/11	J.S.
N		UPDATED	NOV 21/11	J.S.
P		UPDATED	JUL 18/12	J.S.

THIS IS A CAD DRAWING. DO NOT MANUALLY REVISE.

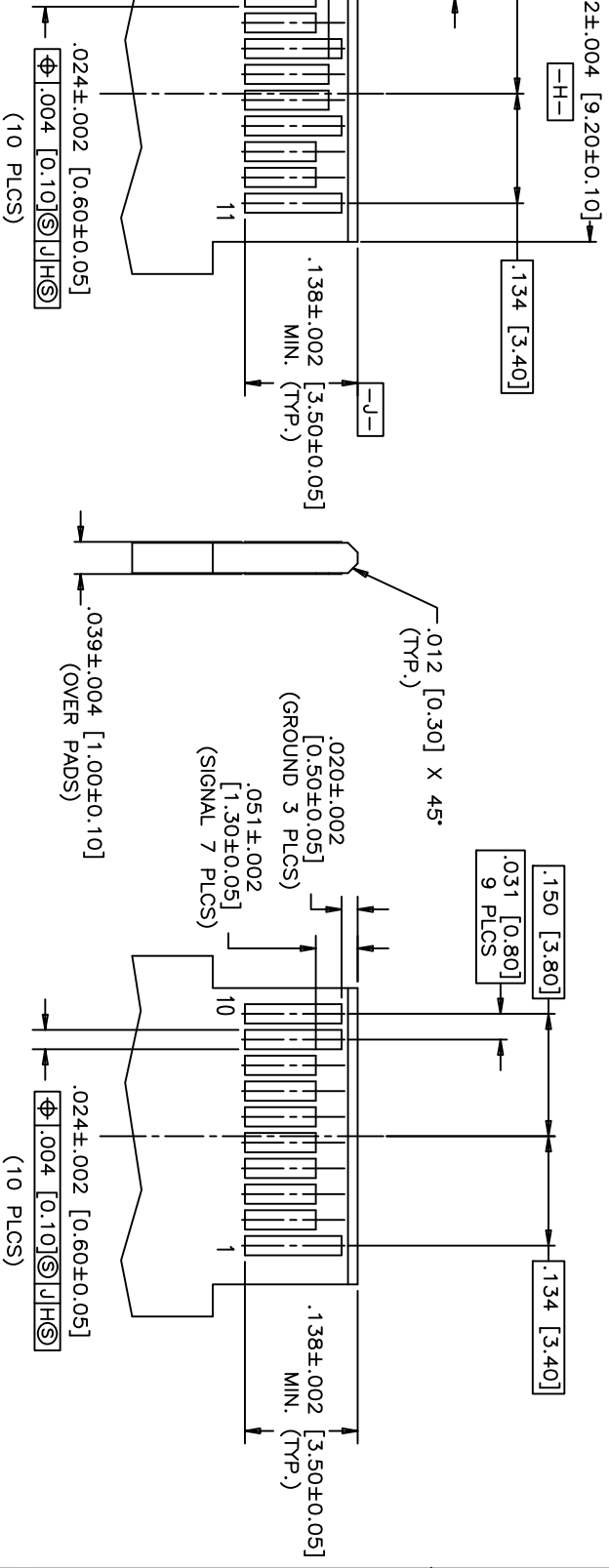

VIEW OF BOARD

BOTTOM VIEW OF BOARD

RECOMMENDED LAYOUT DETAIL
MATING TRANSCIEVER PCB

ALL INFORMATION AND SUCH INFORMATION
FOR ANY PURPOSE OR USED FOR MANUFACTURING
ONLY FROM AMPHENOL CANADA CORP.

DRAWN		DATE	
J.S/I	2009/03/09	J.S/I	2009/03/09
DESIGNED		CHECKED X	
X.XXX±0.010 X.X± 0.25		X	
K.XXXX±0.008K.XXX± 0.15		X	
X.X±.1		X	
K.X±0.05		X	
GENERAL TOLERANCES		DWG. APPRD.	
INCH		MILLIMETERS	
X.XXX±0.010 X.X± 0.25		X	
K.XXXX±0.008K.XXX± 0.15		X	
X.X±.1		X	
K.X±0.05		X	
DIMENSIONS ARE IN INCHES [mm]		CODE ID. NO.	
03554		A	
SCALE 4:1		WT. _____ SURF. _____	
SHEET 3 of 3		REV. _____	
TITLE			
SFP 20 POSITION HIGH SPEED CONNECTOR			
RECEPTACLE FIXED BOARD, RIGHT ANGLE SMT			
OPTIONAL PLATING AND LUBRICANT ON MATING			
DWG. DRAWING NO.		P-UX75-A20-X00XX	
AMPHENOL Canada Corp.		REV. _____	

Looking for pricing, stock, or lifecycle information?

Click below to explore more details on WIN SOURCE:

 [View UE75-A20-6000T on WIN SOURCE](#)

 [Amphenol Information](#)

Optimize Your Supply Chain with WIN SOURCE Solutions

-  Global Sourcing Solution
-  Obsolete Management
-  Cost Control Management
-  Shortage Management
-  Alternative Solution
-  Excess Inventory Management