



**THE DATASHEET OF**  
**1206**



## MINI BINDING POSTS



### THRU HOLE

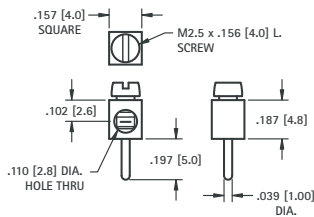

#### SPECIFICATIONS

**Terminal:** Brass, Tin Plate  
**Screw:** Steel, Zinc Plate  
**Mounting Hole:** .047 (1.2)  
**Current Rating:** 15 AMP

**CAT. NO. 8730** (Screw Installed)

### WIRE CONTACT

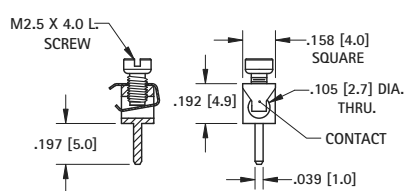

#### SPECIFICATIONS

**Terminal:** Brass, Tin Plate  
**Screw:** Steel, Zinc Plate  
**Contact:** Phosphor Bronze, Tin Plate  
**Mounting Hole:** .047 (1.2)  
**Current Rating:** 15 AMP

**CAT. NO. 8737** (Screw Installed)



## LOW PROFILE SCREW TERMINALS



6-32

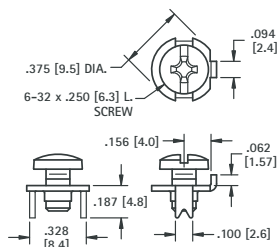

#### SPECIFICATIONS

**Rated:** 15 Amps  
**Terminal:** .032 (.81) Brass, Matte Tin Plate  
**Screw:** Combination drive, Stainless Steel

**CAT. NO. 1284** (No Screw Supplied)

**CAT. NO. 1298** (Screw Supplied Unassembled)

**CAT. NO. 1201** (Screw Installed & Captivated)

#### Mounting Detail

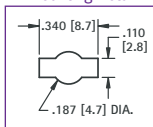

These sturdy, low cost screw terminals, feature an anti-rotation tab for use with spade terminals. They are available with the screw installed and captivated, the screw unassembled or without a screw.

#### PRINCIPLE FEATURES

- Easy to connect using solid or stranded wire, crimp lugs or terminals
- Anti-rotation tab for use with spade terminals
- Supplied with screw installed and captivated, or without screw
- Stainless steel screw will not wick



8-32

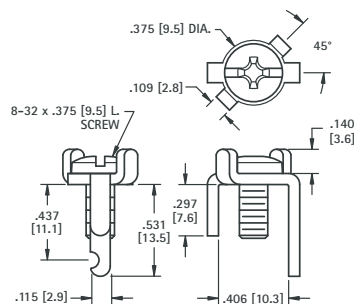

#### SPECIFICATIONS

**Rated:** 15 Amps  
**Terminal:** .064 (1.6) Brass, Matte Tin Plate  
**Screw:** Brass, Nickel Plate

**CAT. NO. 1205** (No Screw Supplied)

**CAT. NO. 1207** (Screw Supplied Unassembled)

**CAT. NO. 1209** (Screw Installed)

#### Mounting Detail

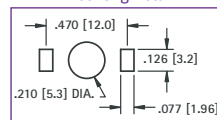

## HEAVY DUTY SCREW TERMINALS - 30 AMP



10-32

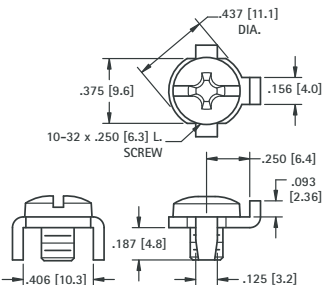

#### SPECIFICATIONS

**Rated:** 30 Amps  
**Terminal:** .062 (1.6) Brass, Matte Tin Plate  
**Screw:** Combination drive, Stainless Steel

**CAT. NO. 1293** (No Screw Supplied)

**CAT. NO. 1299** (Screw Supplied Unassembled)

**CAT. NO. 1202** (Screw Installed & Captivated)

#### Mounting Detail

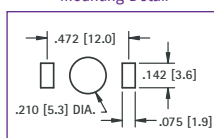

These heavy duty terminals are available with the screw installed or unassembled, and feature easy access to connect solid or stranded wire, crimp type lugs or terminals.

#### PRINCIPLE FEATURES

- Anti-rotation tab for use with spade terminals
- Below the board notched leg, to facilitate mechanical and solder connections
- Easy to connect using solid or stranded wire, crimp lugs or terminals
- Available with screw installed, unassembled, or without screw



10-32

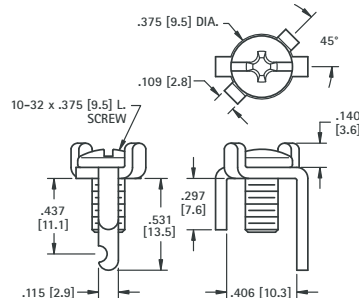

#### SPECIFICATIONS

**Rated:** 30 Amps  
**Terminal:** .064 (1.6) Brass, Matte Tin Plate  
**Screw:** Steel, Nickel Plate

**CAT. NO. 1206** (No Screw Supplied)

**CAT. NO. 1208** (Screw Supplied Unassembled)

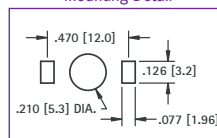

**CAT. NO. 1283** (Screw Installed)

#### Mounting Detail



## Looking for pricing, stock, or lifecycle information?

Click below to explore more details on WIN SOURCE:

-  [View 1206 on WIN SOURCE](#)
-  [Keystone Electronics](#) Information

## Optimize Your Supply Chain with WIN SOURCE Solutions

-  Global Sourcing Solution
-  Obsolete Management
-  Cost Control Management
-  Shortage Management
-  Alternative Solution
-  Excess Inventory Management