



**THE DATASHEET OF  
AH212M245001-T**



# Chip Antennas

## PACKAGING

### ① Minimum Quantity

| Type | Standard Quantity (pcs) |
|------|-------------------------|
|      | Embossed Tape           |
| A4   | 2000                    |
| A2   | 3000                    |
| A6   | 1000                    |
| 18   | 5000                    |

### ② Tape Material

#### ● Embossed Tape

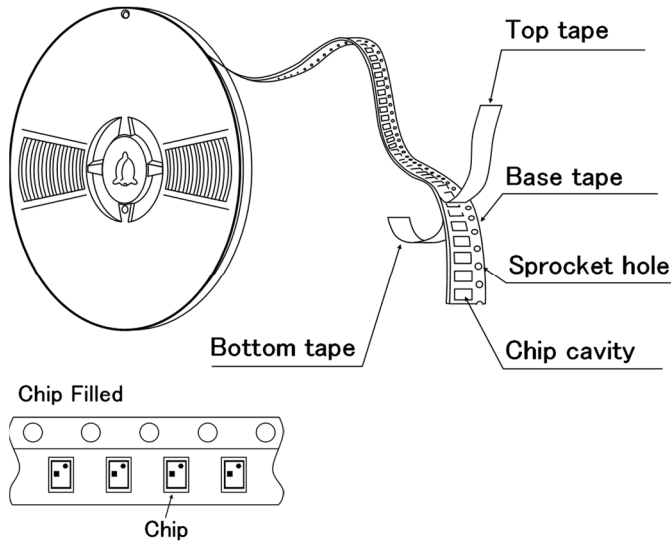

#### ● Card Board Carrier Tape

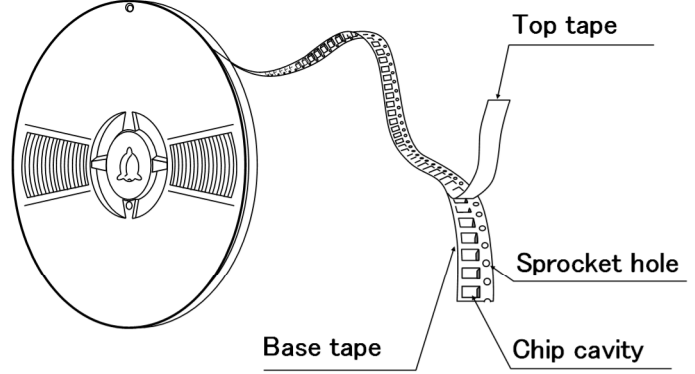

### ③ Taping Dimensions

#### ● Embossed Tape

Unit: mm (inch)

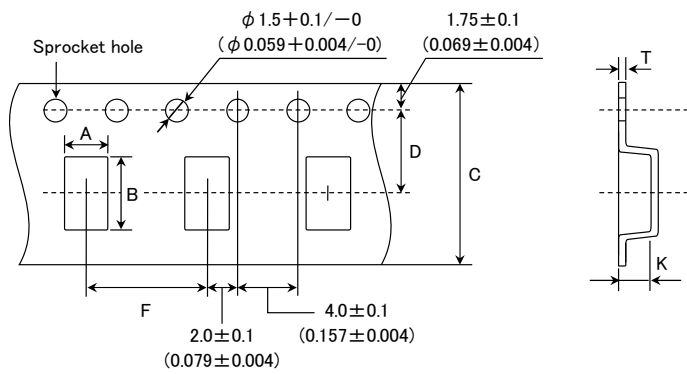

| Type | Chip Cavity                             |  | Tape Width                            |   | Insertion Pitch                       | Tape Thickness max. |                |
|------|---|--|---------------------------------------|---|---------------------------------------|---------------------|----------------|
|      | A                                       | B  | C                                     | D                                       | F                                     | K                   | T              |
| A2   | $1.9 \pm 0.2$<br>( $0.075 \pm 0.008$ )  | $3.5 \pm 0.2$<br>( $0.138 \pm 0.008$ )   | $8 \pm 0.2$<br>( $0.315 \pm 0.008$ )  | $3.5 \pm 0.1$<br>( $0.138 \pm 0.004$ )  | $4 \pm 0.1$<br>( $0.157 \pm 0.004$ )  | 0.85<br>(0.033)     | 0.3<br>(0.012) |
| A4   | $4.35 \pm 0.2$<br>( $0.171 \pm 0.008$ ) | $10.35 \pm 0.2$<br>( $0.407 \pm 0.008$ ) | $24 \pm 0.3$<br>( $0.945 \pm 0.012$ ) | $11.5 \pm 0.1$<br>( $0.435 \pm 0.004$ ) | $8 \pm 0.1$<br>( $0.315 \pm 0.004$ )  | 1.45<br>(0.061)     | 0.3<br>(0.012) |
| A6   | $6.25 \pm 0.2$<br>( $0.246 \pm 0.008$ ) | $8.26 \pm 0.2$<br>( $0.325 \pm 0.008$ )  | $16 \pm 0.3$<br>( $0.630 \pm 0.012$ ) | $7.5 \pm 0.1$<br>( $0.296 \pm 0.004$ )  | $12 \pm 0.1$<br>( $0.473 \pm 0.004$ ) | 1.3<br>(0.051)      | 0.3<br>(0.012) |

Unit: mm (inch)

▶ This catalog contains the typical specification only due to the limitation of space. When you consider the purchase of our products, please check our specification. For details of each product (characteristics graph, reliability information, precautions for use, and so on), see our Web site (<http://www.ty-top.com/>).

● Paper tape 0.315 inches wide

Unit: mm (inch)

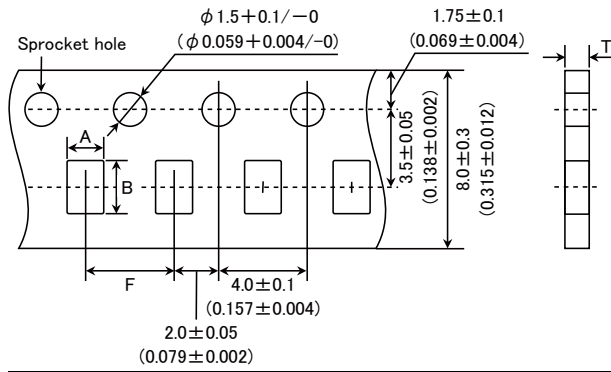

| Type | Chip cavity                |                            | Insertion Pitch          | Tape Thickness max. |
|------|----------------------------|----------------------------|--------------------------|---------------------|
|      | A                          | B                          | F                        | T                   |
| 18   | 0.95±0.05<br>(0.037±0.002) | 1.80±0.05<br>(0.071±0.002) | 4.0±0.1<br>(0.157±0.004) | 0.80<br>(0.031)     |

Unit: mm (inch)

#### ④ Leader and Blank Portion

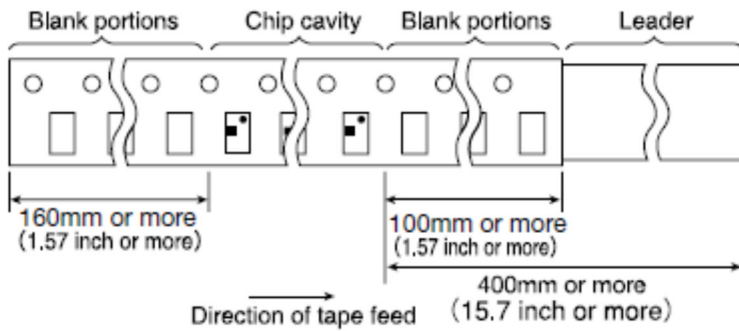

#### ⑤ Reel size

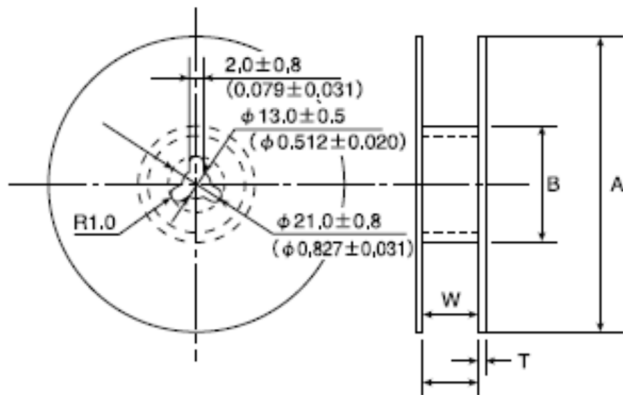

| Type   | A                      | B                      | W                        | T                       |
|--------|------------------------|------------------------|--------------------------|-------------------------|
| 18, A2 | 178±2.0<br>(7.0±0.08)  | 50 min.<br>(2.0 min.)  | 10.0±1.5<br>(0.394±0.06) | 3.0 max.<br>(0.12 max.) |
| A4     | 330±2.0<br>(13.0±0.08) | 100±1.0<br>(3.94±0.04) | 25.5±1.0<br>(1.0±0.04)   | 3.0 max.<br>(0.12 max.) |
| A6     | 330±2.0<br>(13.0±0.08) | 100±1.0<br>(3.94±0.04) | 17.0±1.0<br>(0.67±0.04)  | 2.5 max.<br>(0.1 max.)  |

Unit: mm (inch)

#### ⑥ Top Tape Strength

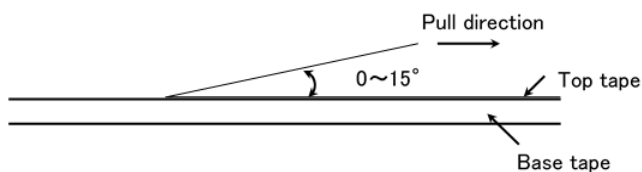

The top tape requires a peel-off force of 0.1~0.7N in the direction of the arrow as illustrated below.



▶ This catalog contains the typical specification only due to the limitation of space. When you consider the purchase of our products, please check our specification. For details of each product (characteristics graph, reliability information, precautions for use, and so on), see our Web site (<http://www.ty-top.com/>).

## Looking for pricing, stock, or lifecycle information?

Click below to explore more details on WIN SOURCE:

-  [View AH212M245001-T on WIN SOURCE](#)
-  [Taiyo Yuden Information](#)

## Optimize Your Supply Chain with WIN SOURCE Solutions

-  Global Sourcing Solution
-  Obsolete Management
-  Cost Control Management
-  Shortage Management
-  Alternative Solution
-  Excess Inventory Management