

Transfer or duplication of this document as well as the utilisation or communication of its content are not permitted unless express consent is granted. Violations give rise to claims for damages. All rights reserved in case of patent, utility model or design patent registrations.

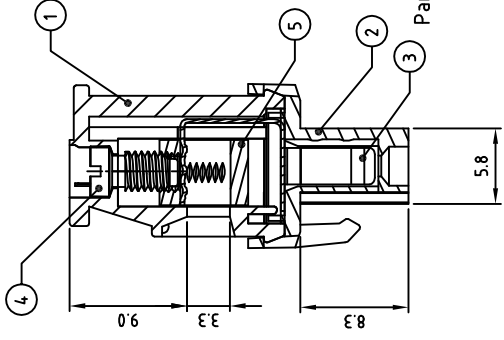
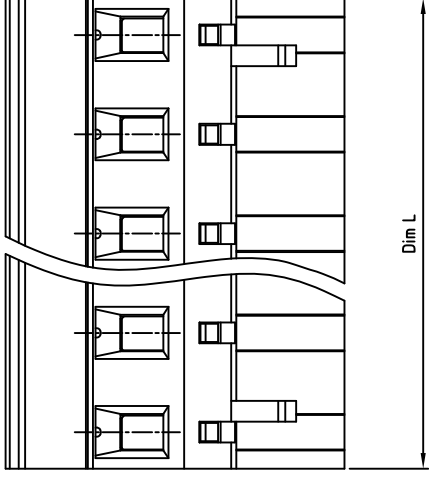
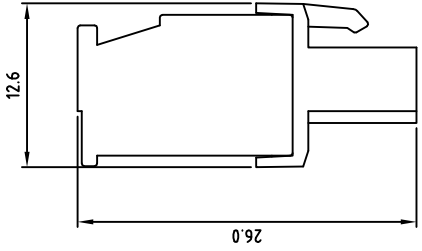
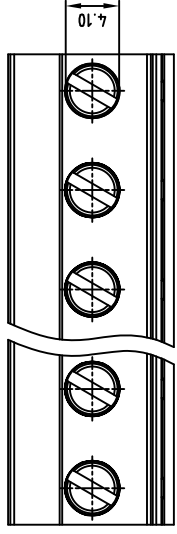

Part No.:

OSTTSXX01

No. of Pole
 02 2 Pole
 03 3 Pole
 ...
 24 24 Pole

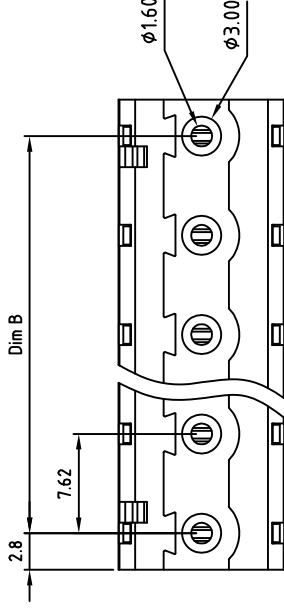

Nonstandard c		Mins could app	
5	CAGE	BRASS	
4	SCREW	STEEL	
3	WIRE GUARD	BRONZE (PbBz)	
2	COVER	PA66 UL94V-0	
1	BODY	PA66 UL94V-0	
ITEM		NAME OF PART	
DWG.		Marvin Zhang	DATE 2017.07.01
CHK.		Marvin Zhang	DATE 2017.07.01
APP.			DATE



ON-SHORE TECHNOLOGY, INC.



△	SIGN	DESCRIPTION	CHK.	DATE
---	------	-------------	------	------

Tec

1.1
 2.
 3.
 4.
 5.
 6.
 7.
 8.
 9.
 10
 11

Looking for pricing, stock, or lifecycle information?

Click below to explore more details on WIN SOURCE:

-  [View OSTTS17015A on WIN SOURCE](#)
-  [On Shore Technology Inc. Information](#)

Optimize Your Supply Chain with WIN SOURCE Solutions

-  Global Sourcing Solution
-  Obsolete Management
-  Cost Control Management
-  Shortage Management
-  Alternative Solution
-  Excess Inventory Management