



THE DATASHEET OF RSAN-2050



3A to 60A, 250VAC EMI Filters

Features

- ◆ High Voltage Pulse Attenuation
- ◆ DIN Rail Mount Option (Up 30A)
- ◆ Low Earth Leakage Current Option (Up to 30A)
- ◆ Conforms to UL, CSA and EN Safety Agency Certifications



Specifications								
Model		RSAN-2003 RSAN-2003D RSAN-2003L	RSAN-2006 RSAN-2006D RSAN-2006L	RSAN-2010 RSAN-2010D RSAN-2010L	RSAN-2016 RSAN-2016D RSAN-2016L	RSAN-2020 RSAN-2020D RSAN-2020L		
Rated Voltage (AC, DC)	V	250V						
Rated Current	A	3A	6A	10A	16A	20A		
Withstand Voltage	V	Terminals to Case: 2500VAC (1 Minute)						
Isolation Resistance	MΩ	100MΩ minimum (500VDC, 1 Minute)						
Leakage Current (max)	A	RSAN-20xx 1mA; RSAN20xxL 10uA (250VAC, 60Hz)						
DC Resistance (total)	mΩ	250	110	40	20	10		
Model		RSAN-2030 RSAN-2030D RSAN-2030L	RSAN-2040	RSAN-2050	RSAN-2060			
Rated Voltage (AC, DC)	V	250V						
Rated Current	A	30A	40A	50A	60A			
Withstand Voltage	V	Terminals to Case: 2500VAC (1 Minute)						
Isolation Resistance	MΩ	100MΩ minimum (500VDC, 1 Minute)						
Leakage Current (max)	A	RSAN-20xx 1mA; RSAN20xxL 10uA (250VAC, 60Hz)						
DC Resistance (total)	mΩ	6	6	4	3			
Operating Temperature	°C	-25 to +85°C (Derate above 55°C, see derating curve)						
Storage Temperature	°C	-25 to +85°C						
Safety Agency Certifications	-	UL1283, CSA C22.2 No.8, EN60939						
Weight	g	170g to 870g model dependant (See weights chart on website)						
Warranty	yr	5 Year						

Options	
Chassis Mount & Standard Leakage Current	RSAN-20xx
DIN Rail Mount & Standard Leakage Current	RSAN-20xxD
Chassis Mount & Low Leakage Current	RSAN-20xxL

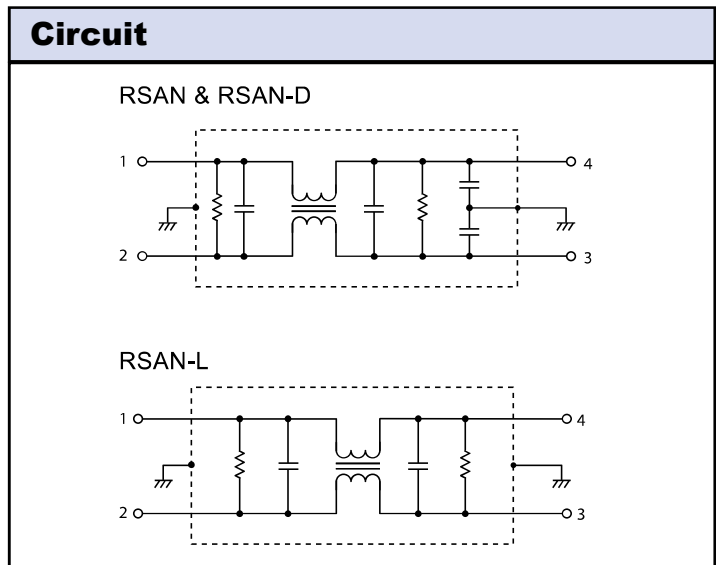
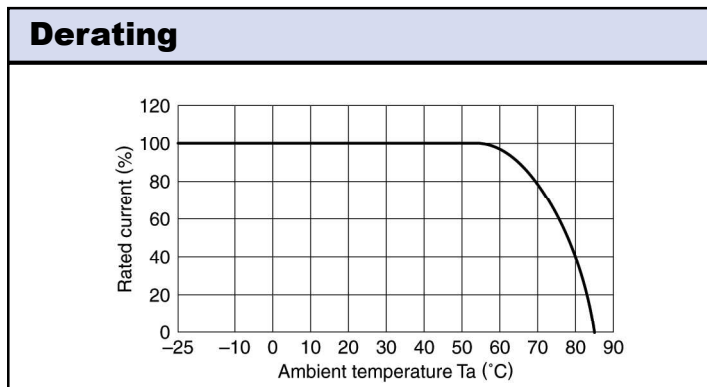

Outline Drawing

RSAN-2003/2006/2010/2016/2020/2030

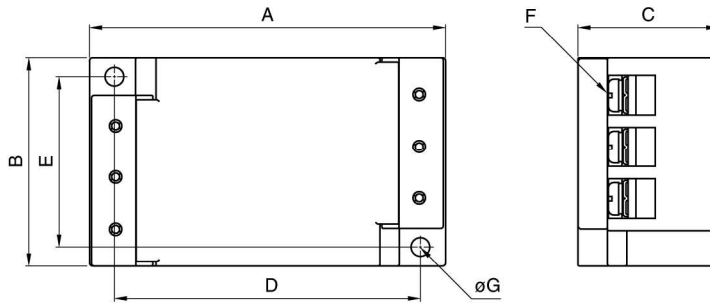

RSAN-2040/2050/2060

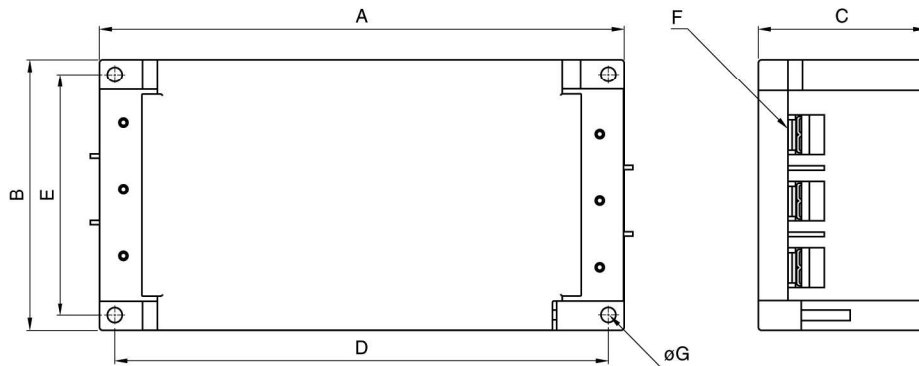

Dimensions in mm



Part No.	A	B	C	D	E	F	ϕG	Recommended clamping torque
RSAN-2003	87	52	35	75	43	M4	4.5	1.27N · m
RSAN-2006								
RSAN-2010								
RSAN-2016								
RSAN-2020								
RSAN-2030								
RSAN-2040	170	90	54	160	80	M5	4.5	2.5N · m
RSAN-2050								
RSAN-2060								

For Additional Information, please visit us.tdk-lambda.com/lp/products/r-series.htm



Looking for pricing, stock, or lifecycle information?

Click below to explore more details on WIN SOURCE:

-  [View RSAN-2050 on WIN SOURCE](#)
-  [TDK-Lambda Americas Inc. Information](#)

Optimize Your Supply Chain with WIN SOURCE Solutions

-  Global Sourcing Solution
-  Obsolete Management
-  Cost Control Management
-  Shortage Management
-  Alternative Solution
-  Excess Inventory Management