

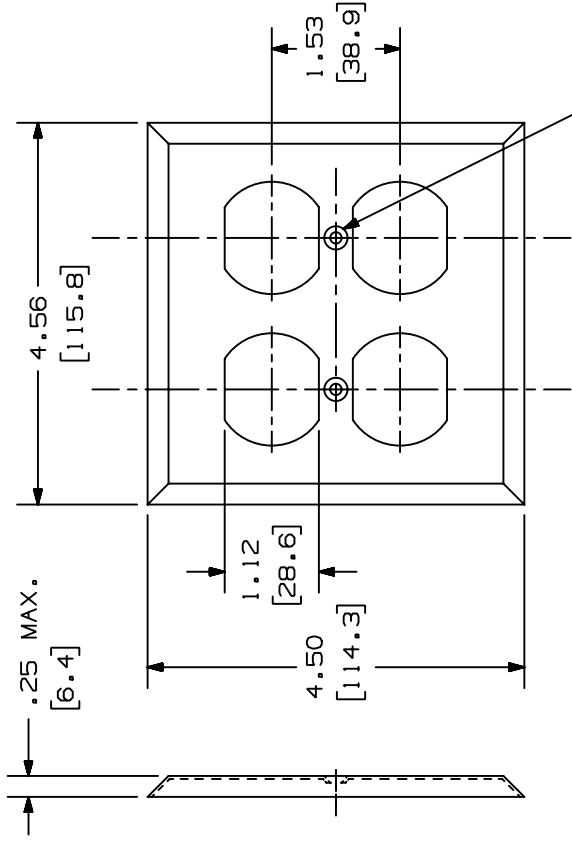

+

THIS COPY IS PROVIDED ON A RESTRICTED BASIS AND IS NOT TO BE USED IN ANY WAY DETRIMENTAL TO THE INTERESTS OF

PANDUIT P/N	WEIGHT
WPS-202	2.0 LB/10 PCS (910 9/10 PCS



C'SK FOR #6 - 32 X 1/2"  
OVAL HEAD SCREW

**NOTES:**

- SEE CURRENT CATALOG FOR ADDITIONAL PART NUMBER SUFFIXES TO INDICATE COLOR AND OR PACKAGE QUANTITY OR BRUSH FINISH.
- TWO #6 X 32 X 1/2" OVAL HEAD SCREWS FOR FASTENING WALLPLATE.
- DIMENSIONS IN PARENTHESES ARE IN MILLIMETERS.

CAD FILENAME/LAYERS

M00142BP\_I

PANDUIT  
CORP.

WPS-202 WALL PLATE  
TWO DUPLEX RECEPTACLE

UNLESS OTHERWISE SPECIFIED,  
DIMENSIONAL TOLERANCES ARE:  
(.X) ± (.XXX) ±.010(.3)  
(.XX) ± .03(.8) ANGLES ±

DRAWN BY

JBA

SCALE

MAT'L:

DATE

9-22-98

CHECKED BY

CEF

SUP

CEK

CEK

00142-18

RELEASED TO PRODUCTION.

JBA CEF

9-22-98

R

REV

DATE

BY

CHK

DESCRIPTION

ECN

CHK

CUST

SUP

DRAWN

9-22-98

CHECKED BY

CEF

SCALE

MAT'L:

.030" THICK

STAINLESS STEEL

+

## Looking for pricing, stock, or lifecycle information?

Click below to explore more details on WIN SOURCE:

 [View WPS-202 on WIN SOURCE](#)

 [Panduit Corp](#) Information

## Optimize Your Supply Chain with WIN SOURCE Solutions

-  Global Sourcing Solution
-  Obsolete Management
-  Cost Control Management
-  Shortage Management
-  Alternative Solution
-  Excess Inventory Management