



**THE DATASHEET OF
PL75MC-217**



DATA CONTAINED IN THIS DOCUMENT IS PROPRIETARY TO PERFORMER AND IS TO BE DISTRIBUTED ONLY TO PERSONS AUTHORIZED BY PERFORMING ORGANIZATION. IT IS TO BE REPRODUCED OR TRANSMITTED IN ANY FORM OR BY ANY MEANS, ELECTRONIC OR MECHANICAL, INCLUDING PHOTOCOPYING, RECORDING, OR BY ANY INFORMATION STORAGE AND RETRIEVAL SYSTEM, WITHOUT EXPRESS PERMISSION OF THE PERFORMING ORGANIZATION.

TABLE 1			
DASH NO.	CABLES ACCOMMODATED	ASSEMBLE PER	DIM "E"
-201	M17/176-00002		
-202	TWC-78-1		
-203	TWC-124-1A		
-204	10602, RAYCHEM		
-205	TWAC-78-1F2		
-206	7826D0130, RAYCHEM		
-207	83310, BELDEN		
-208	202-3927, MICRODOT		
-209	202-3942, MICRODOT		
-210	8451, BELDEN		
-211	202-3934, MICRODOT		
-212	2524E0114, RAYCHEM		
-213	TWC-78-2, M17/45-RG108	TA1-201	1.375
-214	TWC-124-2		
-215	BL982, TIMES		
-216	BL1242, TIMES		
-217	M27500-22 RC2S06		
-218	EDP221888, RAYCHEM		
-219	252601114, RAYCHEM		
-220	GC875RRT, GRUMMAN		
-221	10614, RAYCHEM		
-222	GC875TM24H, GRUMMAN		
-223	10613, RAYCHEM		
-224	HMS2-1149, HUGHES		
-224	TWCP-124-3		
-225	PS665PL, PRIME STOCK		
-226	TWCP-124-5	TA1-209	1.660
			1.495

TABLE 2
POLARIZATION CHAR.

KEY LETTER	A DEGREES	B DEGREES	C DEGREES
NONE	120°	120°	
T	100°	150°	111°
U	120°	130°	111°
V	115°	130°	111°
W	125°	110°	113°
X	130°	100°	113°
Y	110°	140°	111°
Z	100°	160°	101°
S	135°	135°	900°

INTERFACE PER MIL-STD-348 FIG 201-1

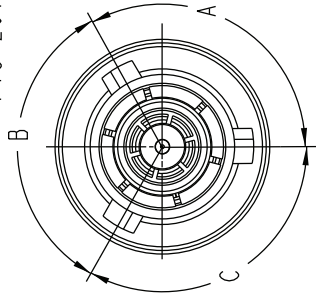

-201 SHOW

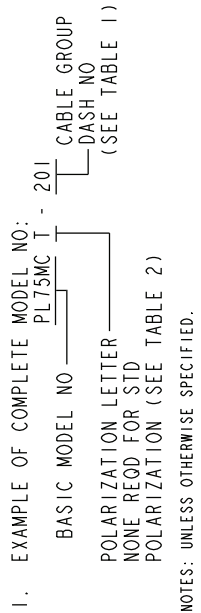

NOTES: UNLESS OTHERWISE SPECIFIED.

INTERPRET DRAWING MIL-STD-348 IN CONJUNCTION WITH MIL-STD-348 AND INCLUDE FINISH UNLESS OTHERWISE SPECIFIED.
E. McLENNAN 6-2-68

N/A	QUALITY
BLANK LENGTH (REF. ONLY)	DATE
N/A	APPROVED
SURFACE AREA	PROJ. FILE NO. 3-0285

Looking for pricing, stock, or lifecycle information?

Click below to explore more details on WIN SOURCE:

- ⊖ [View PL75MC-217](#) on WIN SOURCE
- ⊖ [Cinch Connectivity Solutions](#) Information

Optimize Your Supply Chain with WIN SOURCE Solutions

- ✓ Global Sourcing Solution
- ✓ Obsolete Management
- ✓ Cost Control Management
- ✓ Shortage Management
- ✓ Alternative Solution
- ✓ Excess Inventory Management