



**THE DATASHEET OF
1455QPLTBU-10**



1

2

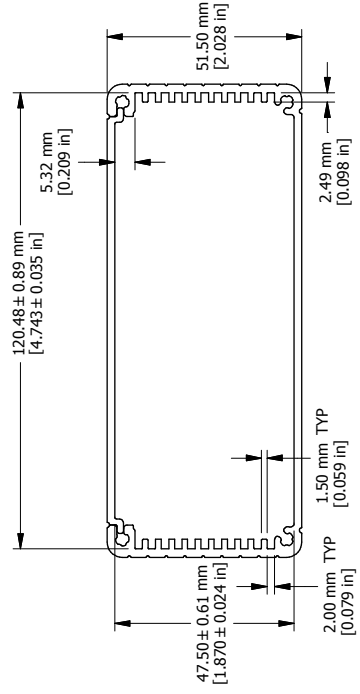

EXTRUSION



END PLATE

EXTRUSION DESIGNED FOR 120MM WIDE PC BOARD

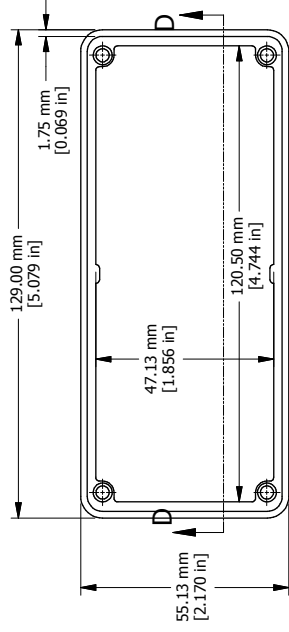

OPEN BEZEL

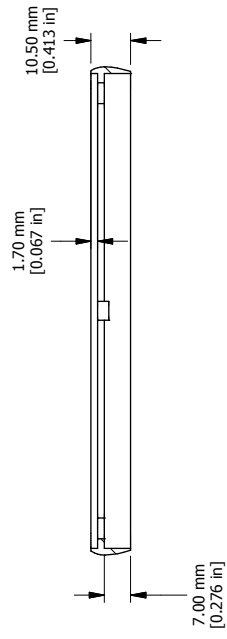

EXP

- Enclosures
- Solid mobile
- Contact Fe
- Purchase
- Taplight sc
- Box made
- Bezels ma

- C
- BI
- B
- R



1

2

B

A

Looking for pricing, stock, or lifecycle information?

Click below to explore more details on WIN SOURCE:

- [View 1455QPLTBU-10 on WIN SOURCE](#)
- [Hammond Manufacturing Information](#)

Optimize Your Supply Chain with WIN SOURCE Solutions

- ✓ Global Sourcing Solution
- ✓ Obsolete Management
- ✓ Cost Control Management
- ✓ Shortage Management
- ✓ Alternative Solution
- ✓ Excess Inventory Management