

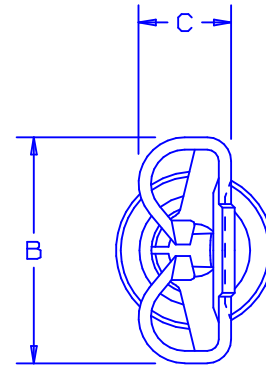

**THE DATASHEET OF
DNF18-250-C**

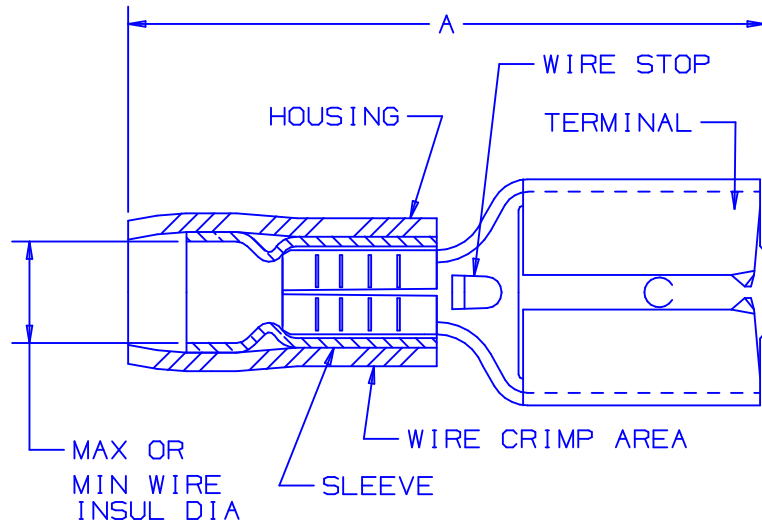



NOTES:

1. UL LISTED AND CSA CERTIFIED FOR:
 - A. 300V MAX VOLTAGE RATING
 - B. 194°F (90°C) MAX TEMP RATING
 - C. STRANDED COPPER WIRE ONLY
 - D. 6-12 LBS INITIAL INSERTION/WITHDRAWAL FORCE
2. MATERIAL:
 - A. STAMPING-BRASS, TIN PLATED
 - B. HOUSING-NYLON
 - C. SLEEVE-BRASS, TIN PLATED
3. DIMENSIONS IN BRACKETS ARE IN mm OR mm²
4. INSTALLATION TOOLS: UL/CSA: CT-500
PANDUIT APPROVED: CT-100, CT-160, CT-260, CT-400, CT-460, CT-1551, CT-1550
5. WIRE STRIP LENGTH: 9/32 ^{+1/32} (7.1 ⁺⁸)
6. PKG QTY:
 - C = 100
 - M = 1000

PART NUMBER	TAB SIZE	WIRE RANGE AWG	COLOR	MAX. INSUL.	MIN. INSUL.	DIMENSIONS in.		
						A ±.03	B ±.01	C ±.004
DNF18-250	.250 X .032	22-18	RED	.138 (3.51)	.040 (1.02)	.81 (20.57)	.29 (7.37)	.12 (3.05)
DNF14-250	.250 X .032	16-14	BLUE	.162 (4.11)	.050 (1.27)	.83 (21.08)	.29 (7.37)	.12 (3.05)



07	7/03	KLFU		ADDED INTERNAL SERRATIONS			
06	1/01	KMD	SKB	CAD FILE SPEC. WAS N41200AA_PCD_05	8938	JAC	CCH
05	3/99	JKD		ADDED CT-1551 & CT-1550 TOOLS	07632		
04	12/96	JB	RLS	ADDED TO TABLE "MIN INSUL"	05427	LA	DBH
03	4/95	MS	RLS	REMOVED SLOT FROM TERMINAL	03132	LA	KRS
REV	DATE	BY	CHK	DESCRIPTION	ECN #	CUST	PM

A41200_07





TINLEY PARK, ILLINOIS

FEMALE DISCONNECTS, NYLON INSULATED, FUNNEL
.250 X .032

DRAWN BY FES	CHK'D LA	SCALE NONE	DRAWING NO. A41200
-----------------	-------------	---------------	-----------------------

Looking for pricing, stock, or lifecycle information?

Click below to explore more details on WIN SOURCE:

-  [View DNF18-250-C on WIN SOURCE](#)
-  [Panduit Corp Information](#)

Optimize Your Supply Chain with WIN SOURCE Solutions

-  Global Sourcing Solution
-  Obsolete Management
-  Cost Control Management
-  Shortage Management
-  Alternative Solution
-  Excess Inventory Management