

4

3

2

NOTES

1. ALL DIMENSIONS ARE IN $\frac{\text{INCHES}}{\text{[MILLIMETERS]}}$
2. DIMENSIONS APPEARING IN TABLE ARE AS FOLLOWS:
 a - AS SUPPLIED
 b - AFTER UNRESTRICTED RECOVERY
3. COATING (ADHESIVE) IS OPTIONAL. AS SUPPLIED DIMENSIONS APPEARING IN TABLE ARE FOR UNCOATED PARTS. WHEN COATING IS ADDED, ENTRY DIAMETERS WILL BE REDUCED BY .06 MAX.
4. MOLDING PORTS ARE OPTIONAL. WHEN -00 MODIFICATION NUMBER IS SPECIFIED MOLDING PORTS WILL BE LOCATED AS SHOWN.

D

C

A

B

A

4

3

2

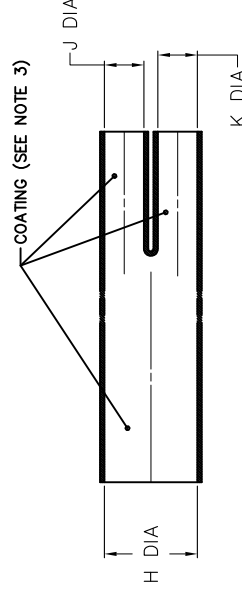

AS SUPPLIED

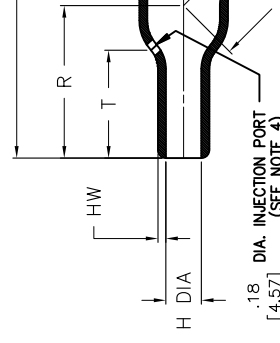

AFTER UNRESTRICTED RECOVERY

TABLE OF DIMENSIONS

| PART NUMBER | H | | J & K | | P | R | S | T | U |
|-------------|----------------|----------------|----------------|---------------|-----------------|-----------|-----------|-----------|-----------|
| | MIN | MAX | MIN | MAX | | | | | |
| 342A112 | .52 [13,2] | .24 [6,1] | .26 [6,6] | .12 [3,0] | 1.76 [44,7] | ±10% b | ±10% b | ±10% b | ±10% b |
| 342A124 | 1.06 [26,9] | .49 [12,4] | .52 [13,2] | .24 [6,1] | 3.54 [89,9] | ±10% b | ±10% b | ±10% b | ±10% b |
| 342A138 | 2.19 [55,6] | 1.00 [25,4] | 1.06 [26,9] | .49 [12,4] | 7.21 [183,1] | ±10% b | ±10% b | ±10% b | ±10% b |

UNLESS OTHERWISE SPECIFIED DIMENSIONS ARE IN INCHES. METRIC DIMENSIONS ARE IN BRACKETS.

DECIMAL TOLERANCES
 .XXX ± 0.005 (0.13 mm)
 .XX ± 0.01 (0.25 mm)
 .X ± 0.1 (2.54 mm)

ANGLE TOLERANCE
 X ± 1 DEG.

REVISED

UNGUYEN

DATE

06/04/2008



TITLE

SIZE

B

06

DO NOT

THIRD ANGLE PROJECTION

A

COMPATIBILITY CHART

| MATERIAL DASH NO. | MATERIAL DESCRIPTION | RT SPEC | COATING SLASH NO. | COATING SPEC |
|-------------------|--------------------------------------|---------|-------------------|----------------|
| -3 | POLYOLEFIN, SEMI-RIGID | RT-301 | /42; /86 | S-1017; S-1048 |
| -4 | POLYOLEFIN, FLEXIBLE | RT-1304 | /42; /86 | S-1017; S-1048 |
| -5 | ELASTOMER, FLEXIBLE | RT-501 | /42 | S-1017 |
| -6 | SILICONE | RT-602 | N/A | |
| -12 | FLUOROELASTOMER | RT-1312 | N/A | |
| -25 | ELASTOMER, FLUID RESISTANT | RW-2070 | /86 | S-1048 |
| -100 | POLYOLEFIN, SEMI-FLEXIBLE ZEROHAL | RT-1323 | /180; /86 | S-1030; S-1048 |

ORDERING INFORMATION

B

342A1XX -XX -XX /XX

BASE PART NUMBER

MATERIAL DASH NUMBER
(SEE COMPATIBILITY CHART)

MODIFICATION NUMBER

ADHESIVE SLASH NUMBER
(IF NECESSARY, SEE COMPATIBILITY CHART)

A

| | | | |
|---------------------------|----------|-----|------|
| SIZE | DWG. NO. | REV | DWG. |
| B | 06090 | M | |
| DO NOT SCALE THIS DRAWING | | | |

Looking for pricing, stock, or lifecycle information?

Click below to explore more details on WIN SOURCE:

- ⊖ [View 342A124-4/42-0-CS8563](#) on WIN SOURCE
- ⊖ [TE Connectivity](#) Information

Optimize Your Supply Chain with WIN SOURCE Solutions

- ✓ Global Sourcing Solution
- ✓ Obsolete Management
- ✓ Cost Control Management
- ✓ Shortage Management
- ✓ Alternative Solution
- ✓ Excess Inventory Management