

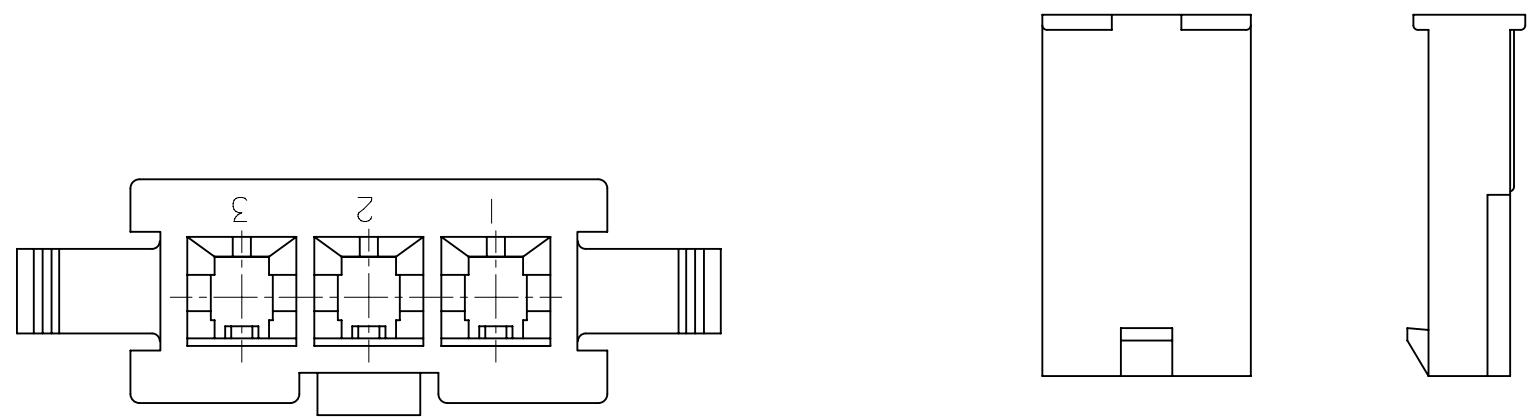

THE DATASHEET OF
39014032



| PART NO. | ENG. NO. | CKT. NO. | MOUNT OPTION | MAT'L. | RAMP OPTION |
|-------------------|----------------------|----------|--------------|------------|-------------|
| 39-01-4032 | 5559-03P2 | 3 | 2 | BLANK | POSITIVE |
| 39-01-4033 | 5559-03P2-210 | 3 | 2 | 210 | POSITIVE |
| 46999-0291 | 5559-03P2-400 | 3 | 2 | 400 | POSITIVE |
| 39-01-4036 | 5559-03P3 | 3 | 3 | BLANK | POSITIVE |
| 39-01-4037 | 5559-03P3-210 | 3 | 3 | 210 | POSITIVE |
| 46999-0290 | 5559-03P3-400 | 3 | 3 | 400 | POSITIVE |
| 39-01-6030 | 5559-03P2-BL | 3 | 2 | BL | POSITIVE |
| 39-01-6031 | 5559-03P3-BL | 3 | 3 | BL | POSITIVE |
| 50-29-0088 | 5559-03P4 | 3 | 4 | BLANK | PASSIVE |
| 50-29-0089 | 5559-03P5 | 3 | 5 | BLANK | PASSIVE |
| 50-29-0091 | 5559-03P4-210 | 3 | 4 | 210 | PASSIVE |
| 50-29-0093 | 5559-03P4-BL | 3 | 4 | BL | PASSIVE |
| 50-29-0094 | 5559-03P5-BL | 3 | 5 | BL | PASSIVE |



5559-03P3-***
WITHOUT MOUNTING EARS

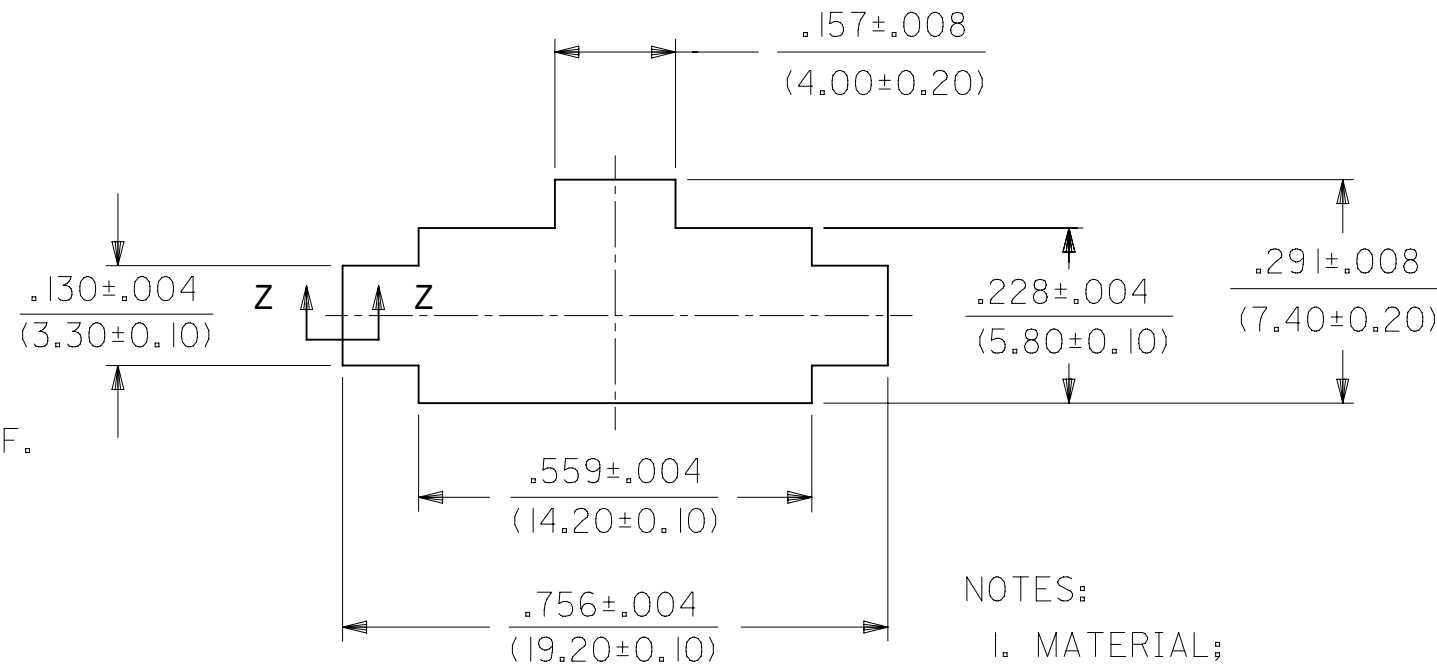
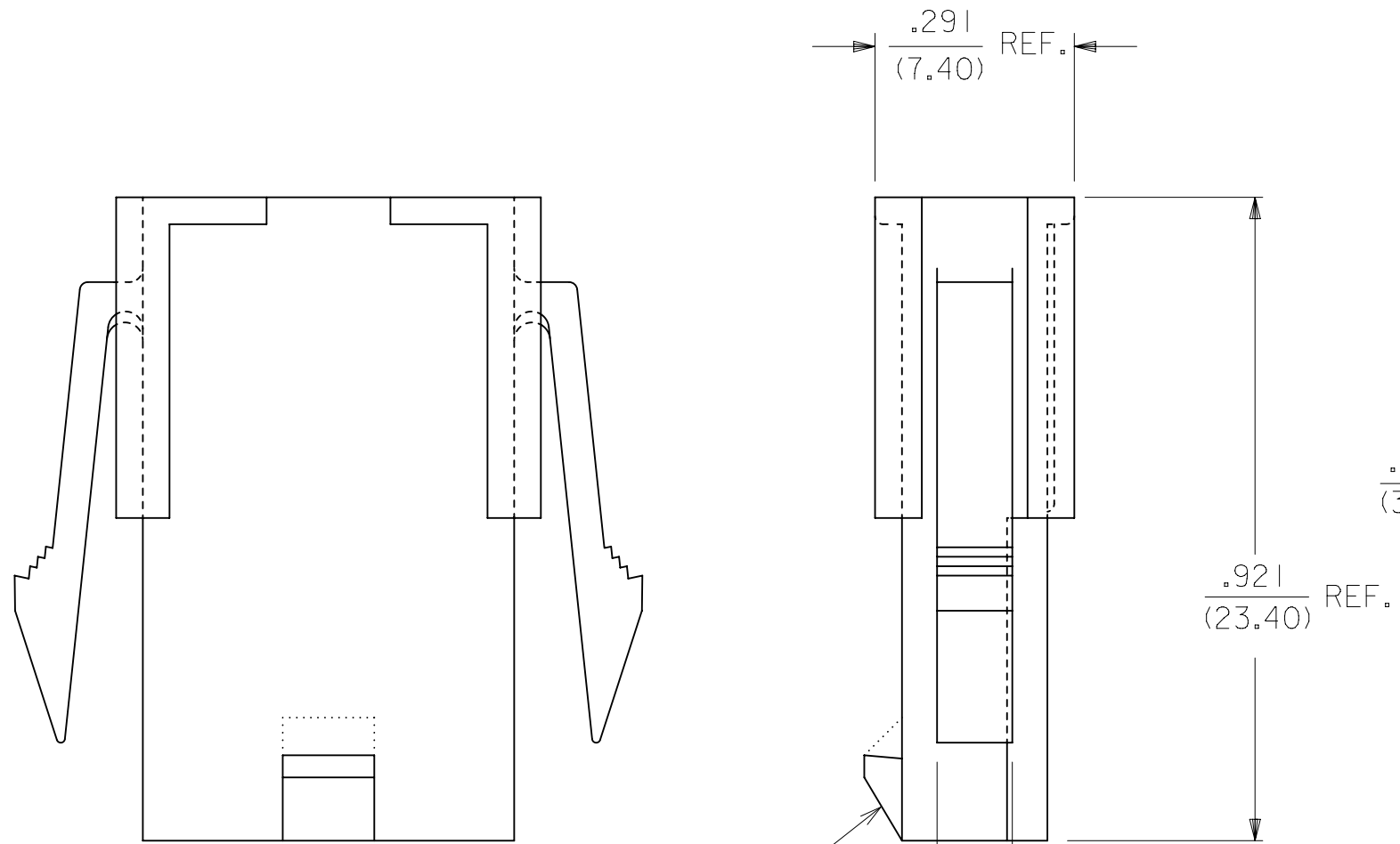
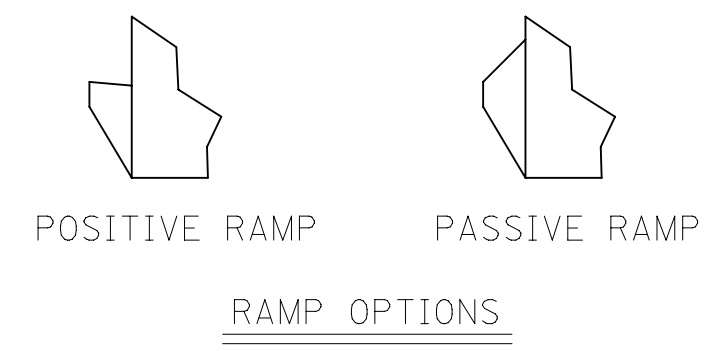

RECOMMENDED PANEL CUT-OUT
(SEE NOTES 7 & 8)

- NOTES:
- MATERIAL;
BLANK=NYLON 6/6, UL 94V-2, COLOR: NATURAL.
210=NYLON 6/6, UL 94V-0, COLOR: NATURAL.
BL=NYLON 6/6, UL 94V-2, COLOR: BLACK.
400=NYLON 6/6, UL 94V-0, COLOR: BLACK
 - FINISH: NOT APPLICABLE
 - PRODUCT SPECIFICATION: PS-5556-001
 - PACKAGING SPECIFICATION: PK-5559-003
 - THIS PART MATES WITH RECEPTACLE NO 5557.
 - THIS PART IS FOR USE WITH MOLEX MALE TERMINAL NO. 5558-*. THICK PANELS.
 - PANEL MOUNT VERSION IS FOR USE WITH .031/.079/(0.80/2.00)
 - PANEL SHOULD BE PUNCHED IN THE DIRECTION OF CONNECTOR INSERTION.
 - MOUNTING & RAMP OPTION:
2 = WITH EARS, WITH POSITIVE RAMP
3 = WITHOUT EARS, WITH POSITIVE RAMP
4 = WITH EARS, WITH PASSIVE RAMP
5 = WITHOUT EARS, WITH PASSIVE RAMP
 - PART IS NOT DESIGNED FOR CURRENT SHARING.
 - CONNECTORS ARE NOT TO BE MATED OR UNMATED WHILE CIRCUITS ARE LIVE.
 - WIRES ARE TO BE DRESSED IN SUCH A MANNER TO ALLOW THE TERMINALS TO FLOAT FREELY IN THE POCKET.
 - PART CONFORMS TO CLASS "B" REQUIREMENTS OF COSMETIC SPECIFICATION PS-45499-002.

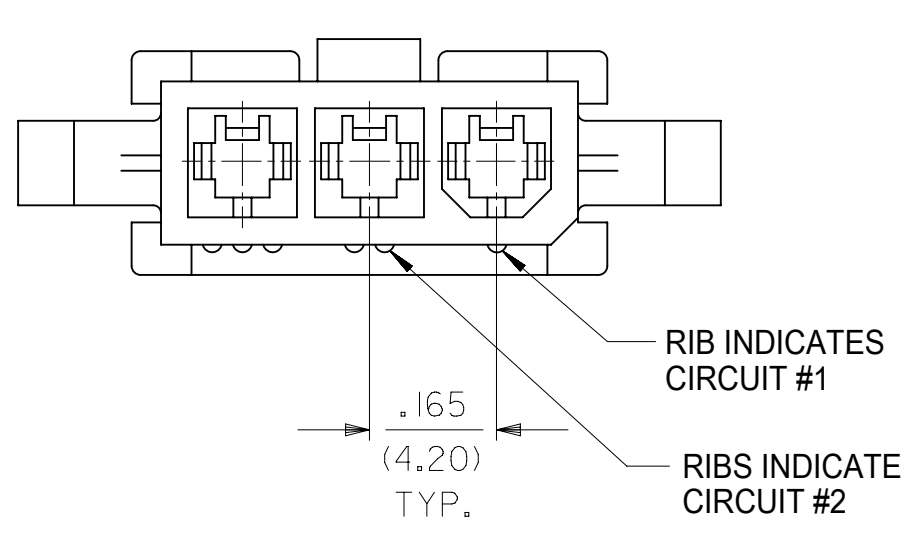
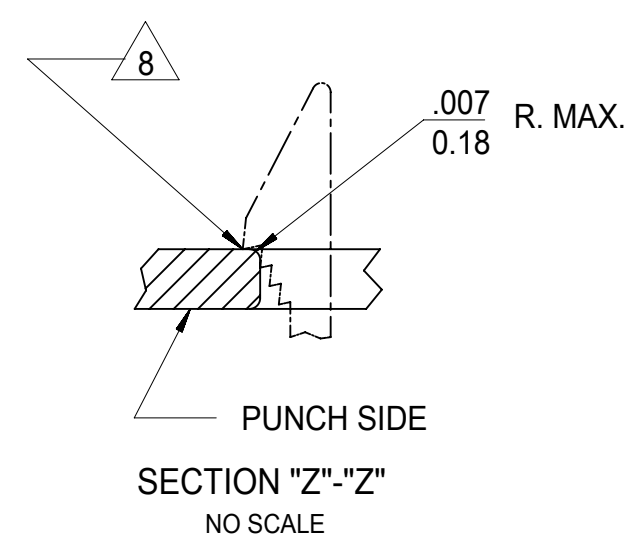

LEGEND

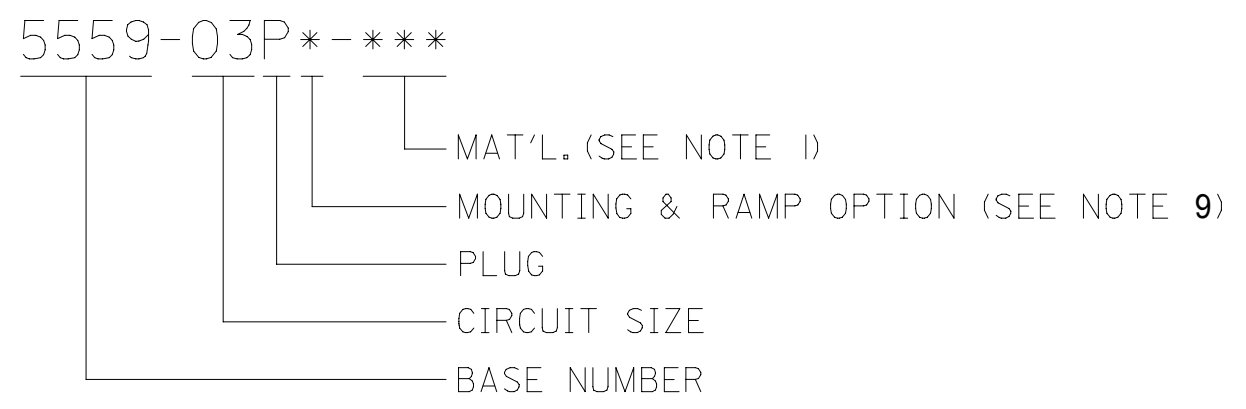

| SYMBOLS | | THIS DRAWING CONTAINS INFORMATION THAT IS PROPRIETARY TO MOLEX ELECTRONIC TECHNOLOGIES, LLC AND SHOULD NOT BE USED WITHOUT WRITTEN PERMISSION | |
|-----------------------------------|--|---|----------------|
| ∇ = 0 | IN/MM | SCALE | 4:1 |
| ∇ = 0 | GENERAL TOLERANCES (UNLESS SPECIFIED) | | |
| ∇ = 0 | 4 PLACES | ± | ± |
| ∇ = 0 | 3 PLACES | ± | ± 0.01 |
| ∇ = 0 | 2 PLACES | ± | ± 0.25 ± 0.015 |
| ∇ = 0 | 1 PLACE | ± | ± 0.38 ± |
| ∇ = 0 | 0 PLACES | ± | ± |
| ∇ = 0 | ANGULAR TOL ± 0.5 ° | | |
| ∇ = 0 | DRAFT WHERE APPLICABLE MUST REMAIN WITHIN DIMENSIONS | | |
| ∇ = 0 | THIRD ANGLE PROJECTION | | |
| ∇ = 0 | DRAWING SERIES | | |
| ∇ = 0 | C-SIZE 5559 | | |
| CURRENT REV DESC: MIGRATE TO ECTR | | EC NO: 172489 | |
| | | DRWN: AZAHIROVIC 2018/01/12 | |
| | | CHK'D: JBELL 2018/02/20 | |
| | | APPR: FSMITH 2018/02/22 | |
| | | INITIAL REVISION: | |
| | | DRWN: GEP 1990/07/11 | |
| | | APPR: RAS 1990/07/11 | |
| DOCUMENT NUMBER | | DOC TYPE DOC PART REVISION | |
| 55590300-SD | | PSD 000 A | |
| MATERIAL NUMBER | | CUSTOMER | |
| SEE CHART | | GENERAL MARKET | |
| SHEET NUMBER | | 1 OF 1 | |

Looking for pricing, stock, or lifecycle information?

Click below to explore more details on WIN SOURCE:

 [View 39014032 on WIN SOURCE](#)

 [Molex, LLC Information](#)

Optimize Your Supply Chain with WIN SOURCE Solutions

-  Global Sourcing Solution
-  Obsolete Management
-  Cost Control Management
-  Shortage Management
-  Alternative Solution
-  Excess Inventory Management