



**THE DATASHEET OF
PBPA2727**





Quality Products. Service Excellence.

PB Series Inner Panel *PBP Series*

Note: This product line has been discontinued as a stocked series. Information is for reference only. For alternative solution assistance, please contact Hammond Customer Service - sales@hammfg.com or USA (716) 630-7030, Canada and International (519) 822-2960.

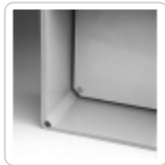

- Available in steel or unfinished aluminum.
- 14 gauge steel panels are finished in white powder coating.
- Aluminum panels are 0.080" (2.03 mm) unfinished.
- Hardware to mount inner panel is included with PB series enclosures.

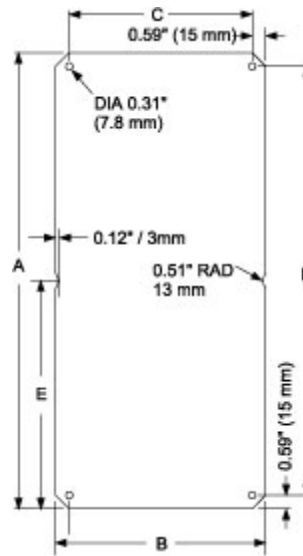



Steel Panel Part No.	Aluminum Panel	Fits PB Enclosure	A	B	C	D	E
PBP2718	PBPA2718	PB271818	9.06	5.51	4.33	7.88	-
PBP2727	PBPA2727	PB272718	9.06	9.06	7.88	7.88	-
PBP3627	PBPA3627	PB362718	12.60	9.06	7.88	11.42	-
PBP5427	PBPA5427	PB542718	19.69	9.06	7.88	18.51	9.84
PBP5436	PBPA5436	PB543618	19.69	12.60	11.42	18.51	9.84

Data subject to change without notice

Looking for pricing, stock, or lifecycle information?

Click below to explore more details on WIN SOURCE:

-  [View PBPA2727 on WIN SOURCE](#)
-  [Hammond Manufacturing Information](#)

Optimize Your Supply Chain with WIN SOURCE Solutions

-  Global Sourcing Solution
-  Obsolete Management
-  Cost Control Management
-  Shortage Management
-  Alternative Solution
-  Excess Inventory Management