



**THE DATASHEET OF  
10073978-030LF**



2

3

4

IS Rohs

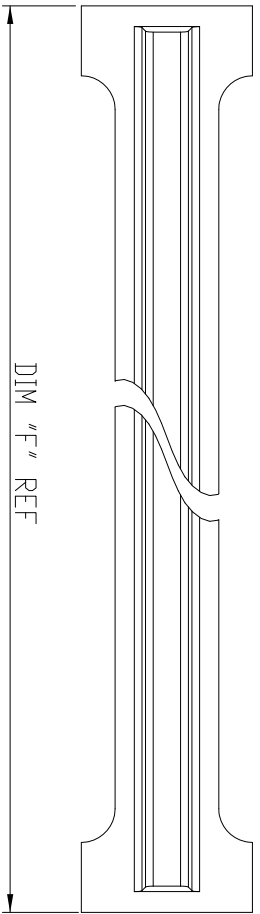

DIM "F" REF

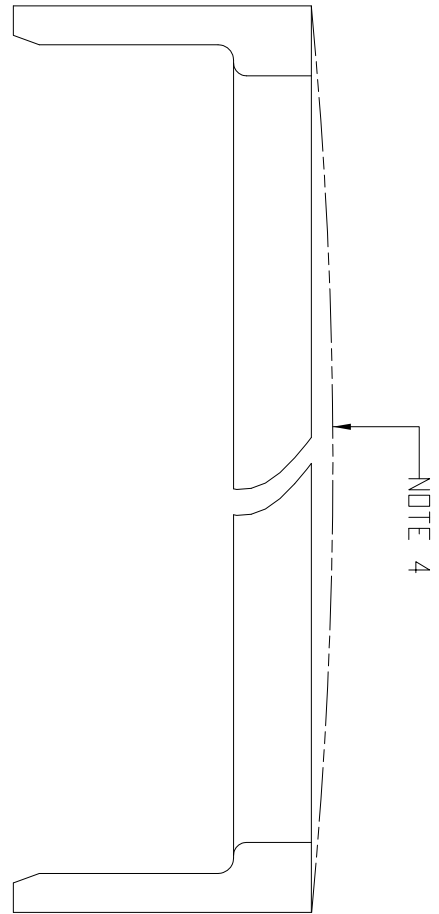

NOTE 4

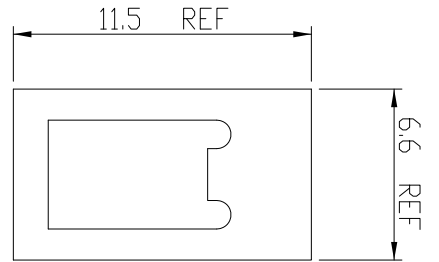

A B C D

www.fciconnect.com		surface		tolerance std		projection		mm	
Dr L.MULIN		07.02.2007		ANGULAR		0X		±0.3	
Eng JCDMPAGNON		07.02.2007		LINEAR		0XX		±0.15	
Chr				° ±2°		0XXX		±0.05	
Appr JCDMPAGNON		11.05.2007		Product family		-		Spec ref	
FCI		MTK IDC STRAIN RELIEF		dwg no		10073978		Rev. A	
catalog no				CUSTOMER		sheet 1 of 1			

rev	ech no	dr	date
A	F07-0185	LMU	11.05.2007
-	-	-	-
-	-	-	-
-	-	-	-
-	-	-	-
-	-	-	-
-	-	-	-

2

3

4

PDS: Rev A



STATUS: Released Printed: Oct 02, 2013

Rev. A

920  
XPOSED  
TH MINITEK

## Looking for pricing, stock, or lifecycle information?

Click below to explore more details on WIN SOURCE:

-  [View 10073978-030LF on WIN SOURCE](#)
-  [Amphenol FCI Information](#)

## Optimize Your Supply Chain with WIN SOURCE Solutions

-  Global Sourcing Solution
-  Obsolete Management
-  Cost Control Management
-  Shortage Management
-  Alternative Solution
-  Excess Inventory Management