

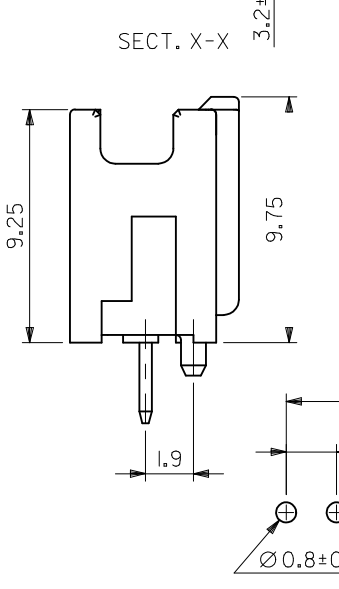

**THE DATASHEET OF**  
**559320610**

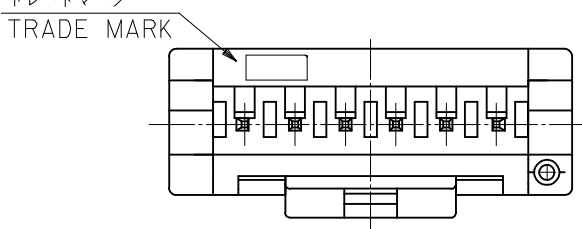

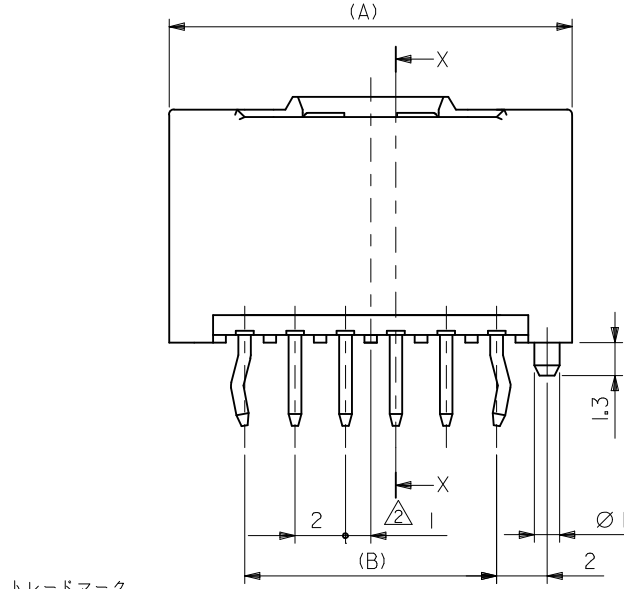
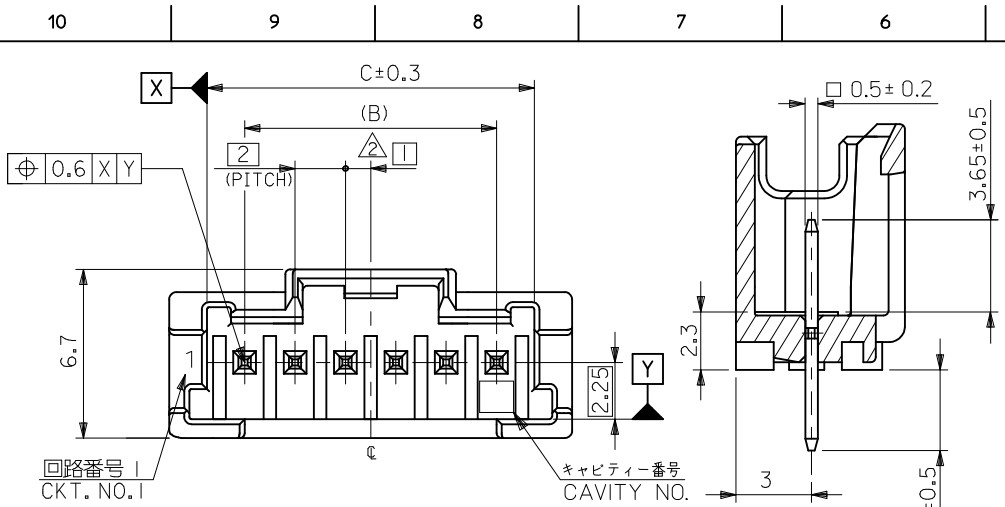

NOTE

- 嵌合相手: 51382シリーズ  
MATE WITH: 51382 SERIES
- 偶数極 (列) に適用。  
APPLY EVEN CIRCUIT PRODUCTS.
- キングは両外側の位置に付加。  
KINK TO BE APPLIED BOTH ENDS.
- 材質  
MATERIALS  
ハウジング: ポリエステル(PBT) UL94V-0  
HOUSING: POLYESTER(PBT) UL94V-0  
ピン: 黄銅  
PIN: BRASS
- めっき  
FINISHES  
ピン: 錫めっき, リフロー処理(前めっき) めっき厚: 1.0µm MIN.  
ニッケル下地めっき, めっき厚: 0.5µm MIN.  
PIN: PRE-TIN PLATED, (HEAT TREATED MATTE TIN)  
PLATING THICKNESS: 1.0µm MIN.  
NICKEL UNDERPLATE OVERALL  
PLATING THICKNESS: 0.5µm MIN.

△ 製品番号 MATERIAL NO.

55932-\*\*\*\*

極数 CIRCUIT SIZE

| 色 COLOR                    |
|----------------------------|
| 10 自然色 (白) NATURAL (WHITE) |
| 11 黒 BLACK                 |
| 12 赤 RED                   |
| 13 黄 YELLOW                |
| 14 青 BLUE                  |
| 15 桃 PINK                  |
| 16 緑 GREEN                 |
| 17 茶 BROWN                 |
| 18 橙 ORANGE                |
| 19 紫 VIOLET                |
| 41 灰 GRAY                  |
| 43 蛍光黄 FLUORESCENCE YELLOW |
| 44 水 PALE BLUE             |
| 46 黄緑 YELLOWISH GREEN      |

|    |    |    |              |      |
|----|----|----|--------------|------|
| 31 | 28 | 34 | 55932-15**   | 15   |
| 29 | 26 | 32 | 55932-14**   | 14   |
| 27 | 24 | 30 | 55932-13**   | 13   |
| 25 | 22 | 28 | 55932-12**   | 12   |
| 23 | 20 | 26 | 55932-11**   | 11   |
| 21 | 18 | 24 | 55932-10**   | 10   |
| 19 | 16 | 22 | 55932-09**   | 9    |
| 17 | 14 | 20 | 55932-08**   | 8    |
| 15 | 12 | 18 | 55932-07**   | 7    |
| 13 | 10 | 16 | 55932-06**   | 6    |
| 11 | 8  | 14 | 55932-05**   | 5    |
| 9  | 6  | 12 | 55932-04**   | 4    |
| 7  | 4  | 10 | 55932-03**   | 3    |
| 5  | 2  | 8  | 55932-02**   | 2    |
| C  | B  | A  | MATERIAL NO. | CKT. |

MODEL NO.: 55932-\*\*\*\*

| REVISED  | DESCRIPTION             | GENERAL TOLERANCES (UNLESS SPECIFIED) |           |           | DIMENSION STYLE    |   | SCALE  | DESIGN UNITS   |  |
|--|-------------------------|---------------------------------------|-----------|-----------|--------------------|---|--------|--|--|
|  |                         | 0.25 UNDER                            | 0.25 OVER | 0.5 UNDER | MM ONLY            | ---   | METRIC | THIRD ANGLE PROJECTION                                 |  |
| EC NO: J2017-0480                                    | DRWKUSATO 2017/03/13    | ±0.03                                 | ±0.05     | ±0.1      | DRAWN BY           | DATE  | TITLE  | 2.0 W/B SINGLE CONN. PLUG HOUSING ASS'Y ST -LEAD FREE- |  |
| CHKDAIDA 2017/03/13                                  | APPR:TKANEKO 2017/03/16 | ±0.25                                 | ±0.3      | ±3 °      | T.NIITSU '02/02/08 | '03/06/12   |        |  |  |
| DRAFT WHERE APPLICABLE MUST REMAIN WITHIN DIMENSIONS |                         |                                       |           |           | SIZE               | THIS DRAWING CONTAINS INFORMATION THAT IS PROPRIETARY TO MOLEX ELECTRONIC TECHNOLOGIES, LLC AND SHOULD NOT BE USED WITHOUT WRITTEN PERMISSION |        | DOCUMENT NO. SHEET NO.                                 |  |
|  |                         |                                       |           |           | A3                 | SEE CHART   |        | SD-55932-002 1 OF 2                                    |  |

10 9 8 7 6 5 4 3 2 1

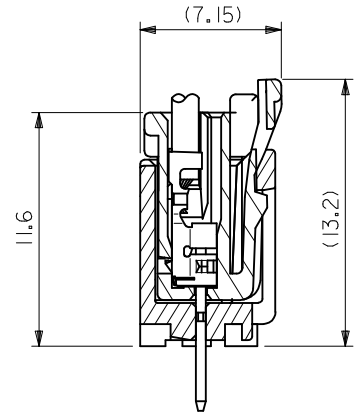
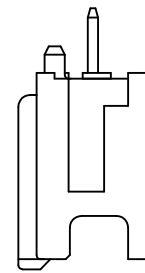
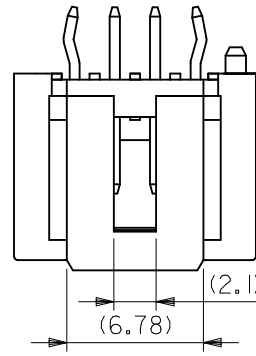
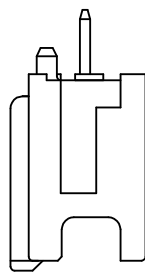
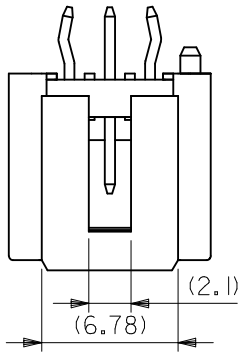
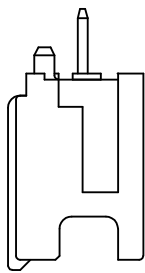
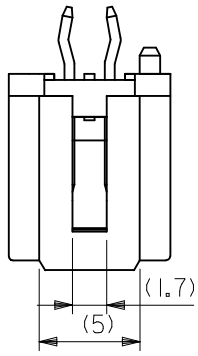

嵌合断面図

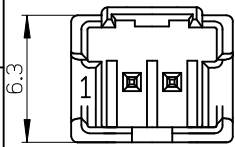

2 CIRCUIT

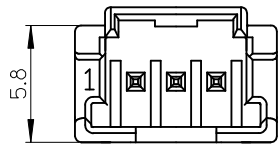

3 CIRCUIT

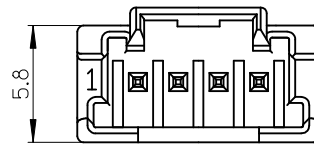

4 CIRCUIT 以上

MODEL NO. : 55932-\*\*\*\*

|  |                                       |           |                             |                            |   |  |                        |                        |  |
|--|---------------------------------------|-----------|-----------------------------|----------------------------|---|--|------------------------|------------------------|--|
| <b>REVISED</b><br>EC NO: J2017-0480<br>DRW:KUSATO 2017/03/13<br>CHK:DAIDA 2017/03/13<br>APPR:KANAKO 2017/03/16 | GENERAL TOLERANCES (UNLESS SPECIFIED) |           |                             | DIMENSION STYLE<br>MM ONLY |   | SCALE<br>---   | DESIGN UNITS<br>METRIC | THIRD ANGLE PROJECTION |  |
|  | 0.25 UNDER                            | UNDER     | ±0.03                       | DRAWN BY                   | DATE  | TITLE  |                        |                        |  |
|  | 0.25 OVER                             | 0.5 UNDER | ±0.05                       | T.NIITSU                   | '02/02/08   | 2.0 W/B SINGLE CONN.<br>PLUG HOUSING ASS'Y ST<br>-LEAD FREE- |                        |                        |  |
|  | 0.5 OVER                              | 1.0 UNDER | ±0.1                        | CHECKED BY                 | DATE  |  |                        |                        |  |
|  | 1.0 OVER                              | 10 UNDER  | ±0.2                        | K.ASAKAWA                  | '03/06/12   |  |                        |                        |  |
|  | 10 OVER                               | 30 UNDER  | ±0.25                       | APPROVED BY                | DATE  | DOCUMENT NO.   |                        | SHEET NO.              |  |
| 30 OVER  |                                       | ±0.3      | T.YAMAGUCHI                 | '03/06/12                  | SD-55932-002  |  | 2 OF 2                 |                        |  |
| ANGULAR  | ±3 °                                  |           | MATERIAL NO.<br>SEE SHEET 1 |                            | THIS DRAWING CONTAINS INFORMATION THAT IS PROPRIETARY TO MOLEX ELECTRONIC TECHNOLOGIES, LLC AND SHOULD NOT BE USED WITHOUT WRITTEN PERMISSION |  |                        |                        |  |
| DRAFT WHERE APPLICABLE MUST REMAIN WITHIN DIMENSIONS   |                                       |           |                             |                            |   |  |                        |                        |  |

9 8 7 6 5 4 3 2 1

## Looking for pricing, stock, or lifecycle information?

Click below to explore more details on WIN SOURCE:

 [View 559320610 on WIN SOURCE](#)

 [Molex, LLC Information](#)

## Optimize Your Supply Chain with WIN SOURCE Solutions

-  Global Sourcing Solution
-  Obsolete Management
-  Cost Control Management
-  Shortage Management
-  Alternative Solution
-  Excess Inventory Management