



**THE DATASHEET OF
10069525-124402LF**



10069525-AA B C D E V FF

AA	NO. OF POSITIONS
04	2X20
06	2X30
08	2X40
10	2X50
12	2X60
14	2X70
16	2X80
18	2X90
20	2X100

D	PEG
0	YES
2	NO

E	PACKAGING
0	TUBE WITHOUT METAL CAP
2	T&R WITH METAL CAP
9	TUBE WITH METAL CAP

B	
1	2
3	4

FOR COMBINATION OF MATED HEIGHT, SEE DWG. NO. 61082

C	
0	GOLD 0.2um MIN. ON CONTACT AREA; NICKEL UNDERPLATE OVERALL 1.27um
1	GOLD FLASH (0.065um MIN) OVER PATTERNED AREA; TIN LEAD 2.5um MIN ON CONTACT AREA; NICKEL UNDERPLATE OVERALL 1.27um
4	GOLD 0.2um MIN ON CONTACT AREA; NICKEL UNDERPLATE OVERALL 1.27um
5	GOLD 0.38um MIN ON CONTACT AREA; NICKEL UNDERPLATE OVERALL 1.27um
6	GOLD FLASH (0.065um MIN) OVER PATTERNED AREA; PURE MATT TIN 2.5um MIN ON CONTACT AREA; NICKEL UNDERPLATE OVERALL 1.27um

NOTE:

- MATERIAL:
HOUSING: G.F. LCP, NATURAL, UL94-V0
TERMINAL: BRASS
- PLATING: AS SHOWN IN TABLE.
- SEE GS-12-148 FOR PRODUCT SPEC.
- SEE GS-14-551 AND GS-14-816 FOR PACKING SPECIFICATION.
- PACKAGING OPTION 2: NOT ALL SIZES ARE AVAILABLE. CHECK WITH FACTORY.
- THIS PRODUCT MEETS THE EUROPEAN UNION DIRECTIVES AND OTHER COUNTRY REGULATIONS AS DESCRIBED IN GS-22-008.
- THE HOUSING WILL WITHSTAND EXPOSURE UP TO 260°C PEAK TEMPERATURE FOR 30 SECONDS IN A CONVECTION, INFRA-RED OR VAPOR PHASE REFLOW OVEN.
- PLATING OPTION "4" IS LEADFREE ALTERNATIVE FOR OPTION "0", AND OPTION "6" IS LEADFREE ALTERNATIVE FOR OPTION "1".
- THIS PARTNUMBER IS ONLY CATER FOR SPECIAL CUSTOMER, REQUIREMENTS OF COPLANARITY OF 0.1 FOR ALLPOSITION.
- A ΔSYMBOL WILL BE NEXT TO ANY DIMENSION, VIEW, OR NOTE WHICH HAS BEEN MODIFIED WITH CURRENT DRAWING REVISION.

mat'l. code		surface	ISO 1302
ltr	ecn no	dr	date
A	S06-0286	MCH	2016-08-25
B	S06-0316	MCH	2016-09-25
C	S09-0216	MCH	2016-06-26
D	S10-0069	MCH	2016-03-26
E	ELX-W-26381	Bob	2018-11-22

tolerances un	angles	linear
	0°±3°	

GuoMin	Bob C	engr	chr	LQ	Le	appd	Tim Y.

sheet	revision	A	B	C	D	E
index	sheet	1~6	1~6	1~6	1~6	1~6

form: A3-2016-02-24

2

3

4 PDS: Rev

1 | 2 | 3 | 4 |

PRODUCT NO.	NO. OF POSITION	DIMENSION		
		A	B	C
10069525-041***	2X20	15.2	21.8	20.2
10069525-061***	2X30	23.2	29.8	28.2
10069525-081***	2X40	31.2	37.8	36.2
10069525-101***	2X50	39.2	45.8	44.2
10069525-121***	2X60	47.2	53.8	52.2
10069525-141***	2X70	55.2	61.8	60.2
10069525-161***	2X80	63.2	69.8	68.2
10069525-181***	2X90	71.2	77.8	76.2
10069525-201***	2X100	79.2	85.8	84.2

A

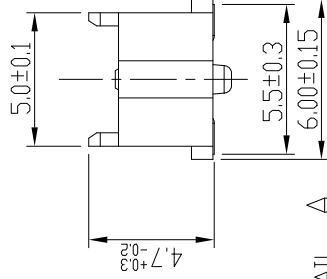
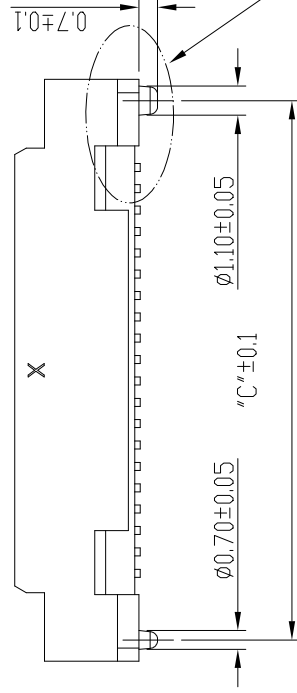
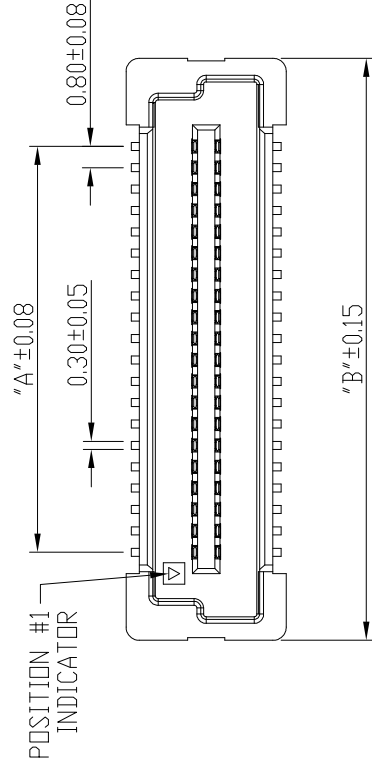

mat'l. code		surface	
ltr	ecn no dr	ISO 1302	tolerances un
E			
		angles	linear
		0°±3°	
		dr	GuoMin
		engr	Bob C
		chr	LQ Ls
		appd	Tim Y
sheet	revision	E	
index	sheet	1~6	

4 PDS: Rev

3

2

1

form: A3-2016-02-24

D



© 2016 AFCl

PRODUCT NO.	NO. OF POSITION	DIMENSION		
		A	B	C
10069525-042***	2X20	15.2	21.8	20.2
10069525-062***	2X30	23.2	29.8	28.2
10069525-082***	2X40	31.2	37.8	36.2
10069525-102***	2X50	39.2	45.8	44.2
10069525-122***	2X60	47.2	53.8	52.2
10069525-142***	2X70	55.2	61.8	60.2
10069525-162***	2X80	63.2	69.8	68.2
10069525-182***	2X90	71.2	77.8	76.2
10069525-202***	2X100	79.2	85.8	84.2

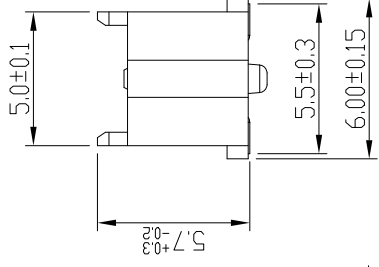
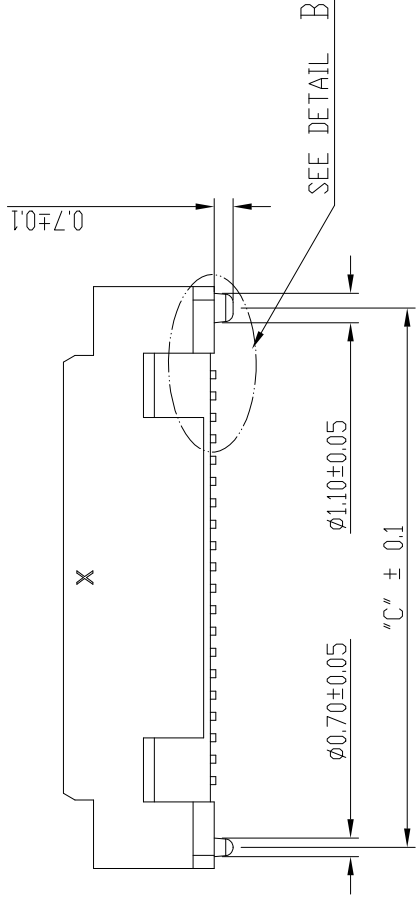
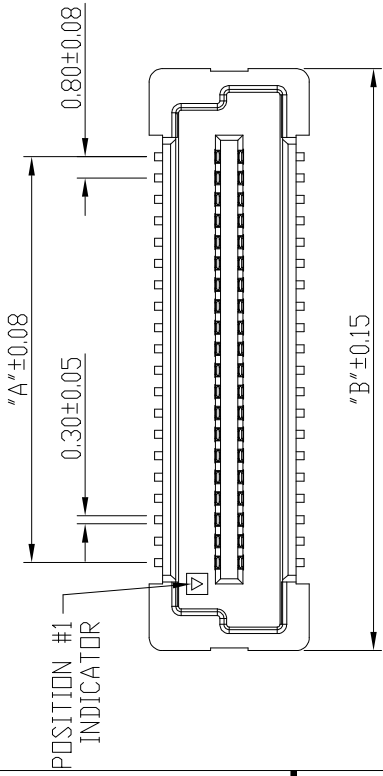

mat'l. code		surface	
ltr	ecn no	ISO 1302	✓
E	dr	tolerances un	
		angles	linear
		0°±3°	
		dr	GuoMin
		engr	Bob C
		chr	LQ Le
		appd	Tim Y
sheet	revision	E	
index	sheet	1~6	

1 | 2 | 3 | 4 |

PRODUCT NO.	NO. OF POSITION	DIMENSION		
		A	B	C
10069525-044***	2X20	15.2	21.8	20.2
10069525-064***	2X30	23.2	29.8	28.2
10069525-084***	2X40	31.2	37.8	36.2
10069525-104***	2X50	39.2	45.8	44.2
10069525-124***	2X60	47.2	53.8	52.2
10069525-144***	2X70	55.2	61.8	60.2
10069525-164***	2X80	63.2	69.8	68.2
10069525-184***	2X90	71.2	77.8	76.2
10069525-204***	2X100	79.2	85.8	84.2

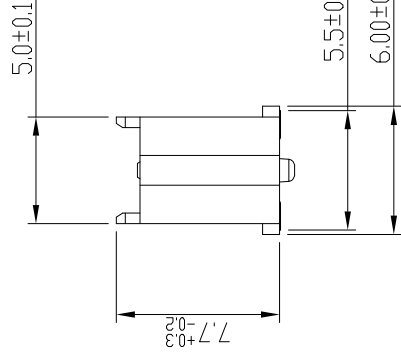
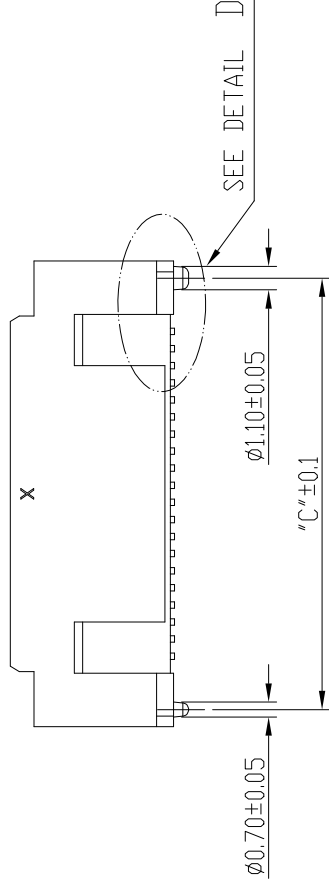
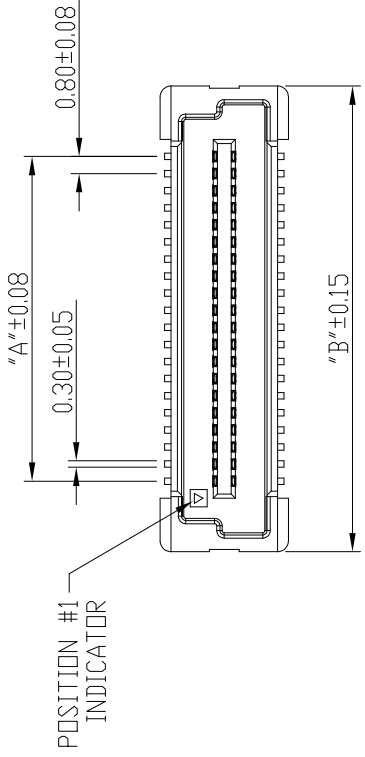

mat'l. code		surface	ISO 1302
ltr	ecn no	dr	date
E			
		tolerances un	
		angles	linear
		0°±3°	
		dr	GuoMin
		engr	Bob C
		chr	LQ Lc
		appd	Tim Y.
sheet	revision	E	
index	sheet	1~6	

form: A3-2016-02-24

1 |

2 |

3 |

4 | **PDS: Rev**

FOR PLUG 1/2/3/4

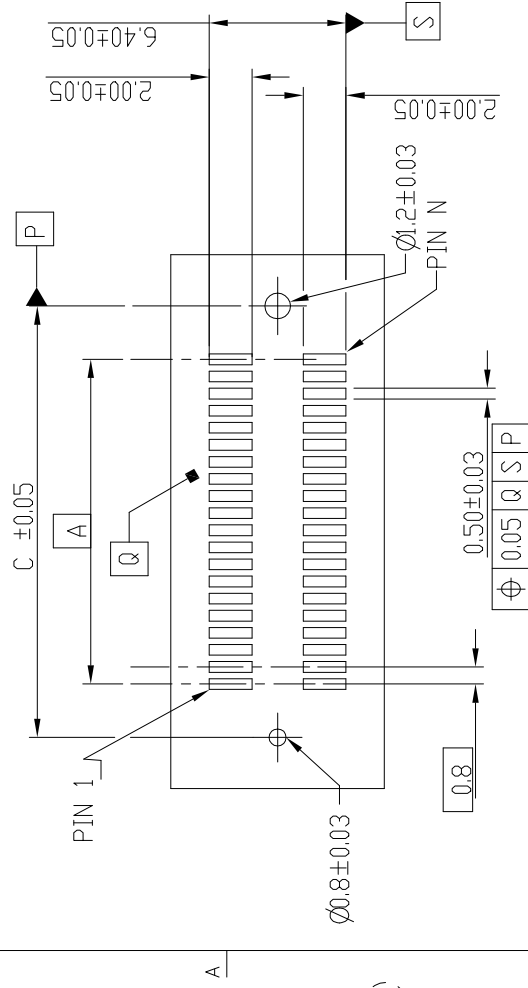

RECOMMENDED PCB LAYOUT WITH PEG FOR
 ND. OF POS 2X10, 2X20, 2X30, 2X40, 2X50 2X60

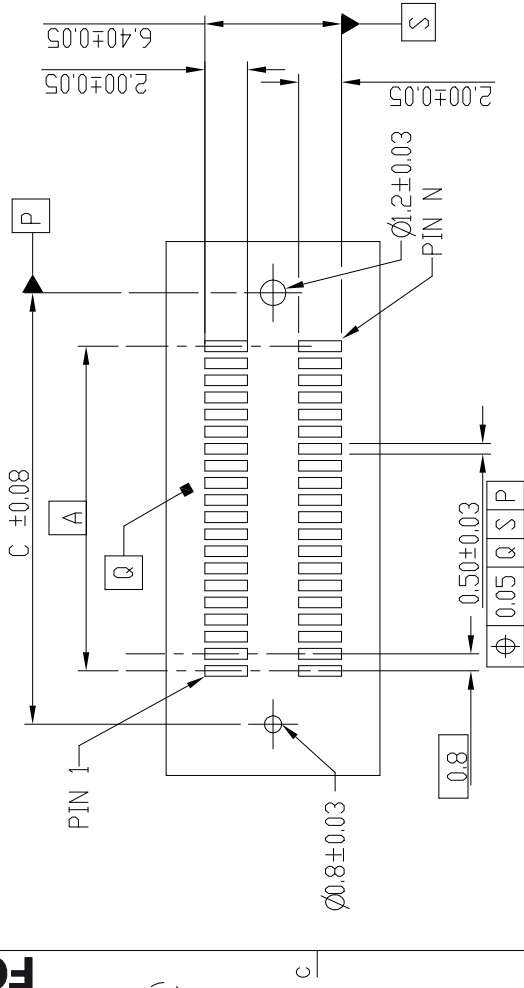

RECOMMENDED PCB LAYOUT WITH PEG FOR
 ND. OF POS 2X70, 2X80, 2X90, 2X100

form: A3-2016-02-24

1 |

2 |

3 |

4 |

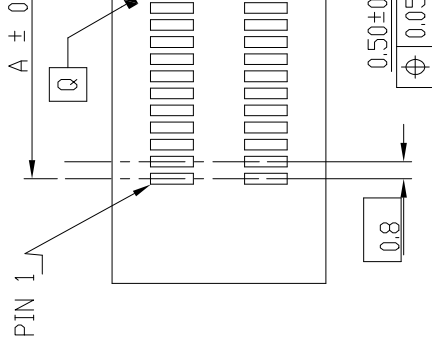



RECOMMENDED PCB LAYOUT W
 ND. OF POS 2X20, 2X30, 2X

mat'l. code		surface		ISO 1302
ltr	ecn no	dr	date	tolerances un
E				angles linear
				0°±3°
				dr
				GuoMin
				engr
				Bob C
				chr
				LQ Lc
				appd
				Tim Y.
sheet	revision	E		
index	sheet	1~6		

Looking for pricing, stock, or lifecycle information?

Click below to explore more details on WIN SOURCE:

-  [View 10069525-124402LF on WIN SOURCE](#)
-  [Amphenol FCI Information](#)

Optimize Your Supply Chain with WIN SOURCE Solutions

-  Global Sourcing Solution
-  Obsolete Management
-  Cost Control Management
-  Shortage Management
-  Alternative Solution
-  Excess Inventory Management