



THE DATASHEET OF 5005



(THM) THRU HOLE MOUNT TEST POINTS - COLOR KEYED

- Color keyed for visibility and quick identification
- Economical choice for PC test point terminations
- Snap-fit mounting provides positive retention for wave soldering
- Wire form loop for safe, non-slip testing
- Space saving, ultra low and low profile designs
- High profile design for difficult to reach applications
- Suitable for high density packaging on .062 (1.57) and .093 (2.36) PC boards
- Practical replacement for wire-wrap posts and turrets
- Secure grip for J hooks, EZ hooks, grabbers, alligator clips, tips or probes
- High temperature nylon base ideal for reflow soldering
- Ideal for reliable production testing and field service troubleshooting



COLOR KEYED

MINIATURE

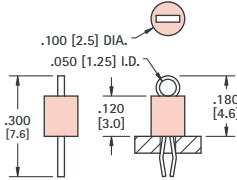

SPECIFICATIONS

Terminal:

.010 (.25) x .020 (.51) Phosphor Bronze, Silver Plate

Base: Nylon 46, UL Rated 94V-0

Mtg. Hole: .040 (1.0) Diameter

| CAT. NO. | BASE COLOR | CAT. NO. | BASE COLOR |
|----------|------------|----------|------------|
| 5000 | RED | 5115 | BROWN |
| 5001 | BLACK | 5116 | GREEN |
| 5002 | WHITE | 5117 | BLUE |
| 5003 | ORANGE | 5118 | GREY |
| 5004 | YELLOW | 5119 | PURPLE |

COMPACT

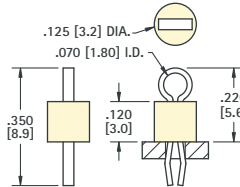

SPECIFICATIONS

Terminal:

.015 (.38) x .032 (.81) Phosphor Bronze, Silver Plate

Base: Nylon 46, UL Rated 94V-0

Mtg. Hole: .063 (1.6) Diameter

| CAT. NO. | BASE COLOR | CAT. NO. | BASE COLOR |
|----------|------------|----------|------------|
| 5005 | RED | 5120 | BROWN |
| 5006 | BLACK | 5121 | GREEN |
| 5007 | WHITE | 5122 | BLUE |
| 5008 | ORANGE | 5123 | GREY |
| 5009 | YELLOW | 5124 | PURPLE |

MULTIPURPOSE

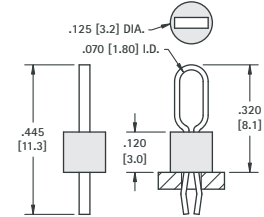

SPECIFICATIONS

Terminal:

.015 (.38) x .032 (.81) Phosphor Bronze, Silver Plate

Base: Nylon 46, UL Rated 94V-0

Mtg. Hole: .063 (1.6) Diameter

| CAT. NO. | BASE COLOR | CAT. NO. | BASE COLOR |
|----------|------------|----------|------------|
| 5010 | RED | 5125 | BROWN |
| 5011 | BLACK | 5126 | GREEN |
| 5012 | WHITE | 5127 | BLUE |
| 5013 | ORANGE | 5128 | GREY |
| 5014 | YELLOW | 5129 | PURPLE |

THM TEST POINTS

ULTRA LOW PROFILE

MATERIAL: .017 (.43) Dia. Phosphor Bronze Silver plate
Mtg Hole: .040 (1.0)

CAT. NO. 5021

SHOWN AS INSTALLED INTO .040 [1.02] DIA. MOUNTING HOLE

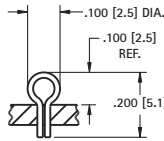

LOW PROFILE

MATERIAL: .016 (.40) x .028 (.71) Phosphor Bronze Silver plate
Mtg Hole: .040 (1.0)

CAT. NO. 5020

SHOWN AS INSTALLED INTO .040 [1.02] DIA. MOUNTING HOLE

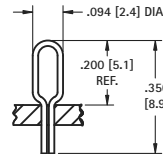

STANDARD

MATERIAL: .020 (.50) Dia. Phosphor Bronze Silver plate
Mtg Hole: .073 (1.85)

CAT. NO. 5023

SHOWN AS INSTALLED INTO .067 [1.70] TO .078 [1.98] DIA. MOUNTING HOLE

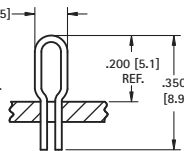

LARGE

MATERIAL: .020 (.50) Dia. Phosphor Bronze Silver plate
Mtg Hole: .114 (2.9)

CAT. NO. 5024

SHOWN AS INSTALLED INTO .112 [2.84] TO .116 [2.95] DIA. MOUNTING HOLE

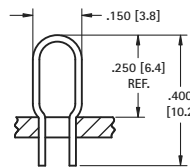

ALLIGATOR CLIPS



- Solder connection with strain relief
- Insulated or non-insulated
- Large clip also accepts standard banana plug

MATERIAL: Clip: Steel, Nickel Plate; Insulator: Vinyl

SMALL CLIP

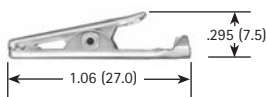

| CAT. NO. | COLOR |
|----------|--------|
| 5033 | NONE |
| 5034 | RED |
| 5035 | BLACK |
| 5036 | GREEN |
| 5037 | YELLOW |

JAW SPREAD
.236 (6.0) max.

MEDIUM CLIP

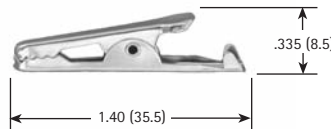

| CAT. NO. | COLOR |
|----------|-------|
| 5038 | NONE |
| 5039 | RED |
| 5040 | BLACK |

JAW SPREAD
.236 (6.0) max.

LARGE CLIP

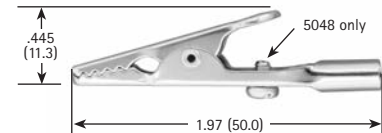



| CAT. NO. | COLOR |
|----------|-----------------|
| 5044 | NONE |
| 5045 | RED |
| 5046 | BLACK |
| 5048 | SCREW INSTALLED |

JAW SPREAD
.315 (8.0) max.

Looking for pricing, stock, or lifecycle information?

Click below to explore more details on WIN SOURCE:

-  [View 5005 on WIN SOURCE](#)
-  [Keystone Electronics](#) Information

Optimize Your Supply Chain with WIN SOURCE Solutions

-  Global Sourcing Solution
-  Obsolete Management
-  Cost Control Management
-  Shortage Management
-  Alternative Solution
-  Excess Inventory Management