



**THE DATASHEET OF**  
**3503**



# MICRO JACKS

**.032 (.81) - .046 (1.17) PIN - SOLDER MOUNT**

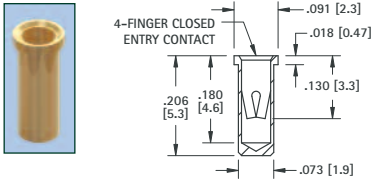

RoHS	NON-RoHS		Mtg. Hole Dia.
GOLD/GOLD	TIN/TIN	TIN/GOLD	
CAT. NO.	CAT. NO.	CAT. NO.	
1417	1437	1479	.076 (1.93)

**.032 (.81) - .046 (1.17) PIN - PRESS-FIT**

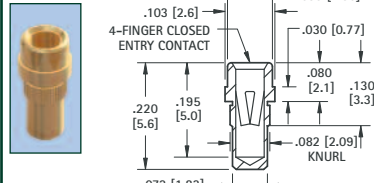

RoHS	NON-RoHS		Mtg. Hole Dia.
GOLD/GOLD	TIN/TIN	TIN/GOLD	
CAT. NO.	CAT. NO.	CAT. NO.	
1443	1446	1473	.078 (1.98)

**.032 (.81) - .046 (1.17) PIN - PRESS-FIT**

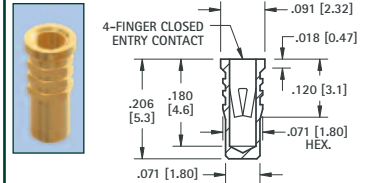

RoHS	NON-RoHS		Mtg. Hole Dia.
GOLD/GOLD	TIN/TIN	TIN/GOLD	
CAT. NO.	CAT. NO.	CAT. NO.	
1442	1445	1486	.079 (2.0)

**.032 (.81) - .046 (1.17) PIN - SOLDER MOUNT**

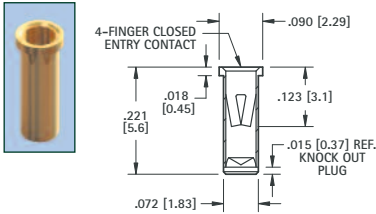

RoHS	NON-RoHS		Mtg. Hole Dia.
GOLD/GOLD	TIN/TIN	TIN/GOLD	
CAT. NO.	CAT. NO.	CAT. NO.	
1441	1444	1488	.076 (1.93)

**.032 (.81) - .046 (1.17) PIN - SOLDER MOUNT**

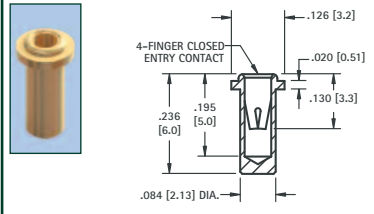

RoHS	NON-RoHS		Mtg. Hole Dia.
GOLD/GOLD	TIN/TIN	TIN/GOLD	
CAT. NO.	CAT. NO.	CAT. NO.	
1674	1675	1676	.087 (2.21)

**.032 (.81) - .046 (1.17) PIN - SOLDER MOUNT**

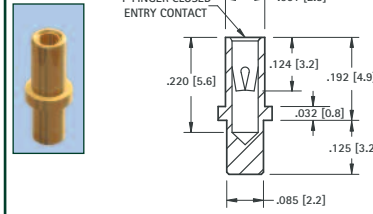

RoHS	NON-RoHS		Mtg. Hole Dia.
GOLD/GOLD	TIN/TIN	TIN/GOLD	
CAT. NO.	CAT. NO.	CAT. NO.	
1677	1678	1679	.089 (2.26)

**.032 (.81) - .046 (1.17) PIN - SOLDER MOUNT**

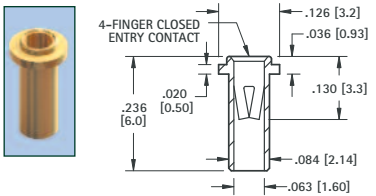

RoHS	NON-RoHS		Mtg. Hole Dia.
GOLD/GOLD	TIN/TIN	TIN/GOLD	
CAT. NO.	CAT. NO.	CAT. NO.	
1414	1434	1496	.089 (2.26)

**.040 (1.02) - .050 (1.27) PIN - SOLDER MOUNT**

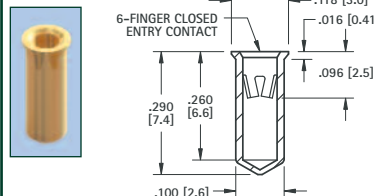

RoHS	NON-RoHS		Mtg. Hole Dia.
GOLD/GOLD	TIN/TIN	TIN/GOLD	
CAT. NO.	CAT. NO.	CAT. NO.	
1418	1438	1497	.104 (2.6)

**.048 (1.22) - .064 (1.63) PIN - SOLDER MOUNT**

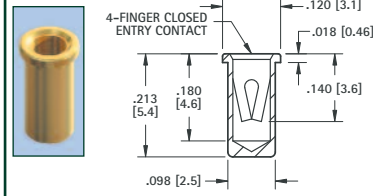

RoHS	NON-RoHS		Mtg. Hole Dia.
GOLD/GOLD	TIN/TIN	TIN/GOLD	
CAT. NO.	CAT. NO.	CAT. NO.	
1682	1683	1684	.102 (2.6)

**.065 (1.65) - .082 (2.08) PIN - SOLDER MOUNT**

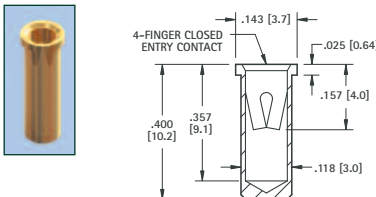

RoHS	NON-RoHS		Mtg. Hole Dia.
GOLD/GOLD	TIN/TIN	TIN/GOLD	
CAT. NO.	CAT. NO.	CAT. NO.	
1641A	1641B	1641C	.122 (3.1)

**.065 (1.65) - .082 (2.08) PIN - SOLDER MOUNT**

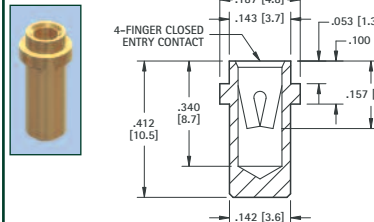

RoHS	NON-RoHS		Mtg. Hole Dia.
GOLD/GOLD	TIN/TIN	TIN/GOLD	
CAT. NO.	CAT. NO.	CAT. NO.	
1687	1688	1689	.146 (3.7)

**.084 (2.13) - .102 (2.6) PIN - PRESS-FIT**

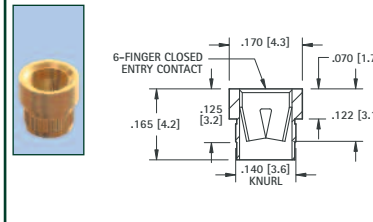

RoHS	NON-RoHS		Mtg. Hole Dia.
GOLD/GOLD	TIN/TIN	TIN/GOLD	
CAT. NO.	CAT. NO.	CAT. NO.	
1640A	1640B	1640C	.138 (3.5)

**.032 (.81) - .046 (1.17) PIN - CRIMP BARREL JACK**

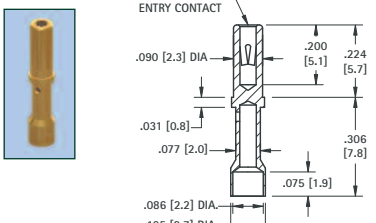

RoHS	NON-RoHS		Mtg. Hole Dia.
GOLD/GOLD	TIN/TIN	TIN/GOLD	
CAT. NO.	CAT. NO.	CAT. NO.	
3593	3594	3595	

**IC SOCKET CONTACTS FOR .015 (.38) - .025 (.64) LEADS - PRESS-FIT**

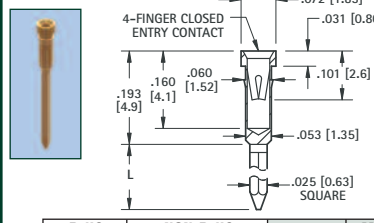

RoHS	NON-RoHS		L Length	Mtg. Hole Dia.
GOLD/GOLD	TIN/TIN	TIN/GOLD		
CAT. NO.	CAT. NO.	CAT. NO.		
3501	3505	3504	.360 (9.2)	.057
3502	3506	3508	.510 (13.0)	(1.45)

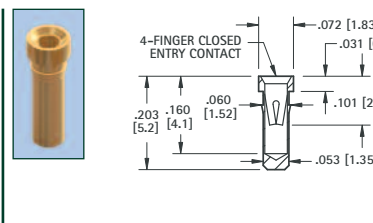

RoHS	NON-RoHS		Mtg. Hole Dia.
GOLD/GOLD	TIN/TIN	TIN/GOLD	
CAT. NO.	CAT. NO.	CAT. NO.	
3503	3507	3509	.057 (1.45)

## Looking for pricing, stock, or lifecycle information?

Click below to explore more details on WIN SOURCE:

- ⊖ [View 3503 on WIN SOURCE](#)
- ⊖ [Keystone Electronics Information](#)

## Optimize Your Supply Chain with WIN SOURCE Solutions

- ✓ Global Sourcing Solution
- ✓ Obsolete Management
- ✓ Cost Control Management
- ✓ Shortage Management
- ✓ Alternative Solution
- ✓ Excess Inventory Management