



**THE DATASHEET OF  
BU160Z-178-HT**



to 60V

(RMS)

Class Filled, UL94V-0  
 Brass, Flash Copper, Nickel 2-3µm, Tin 5µm  
 m-copper, Nickel 2-3µm, Gold 0.25µm  
 -125°C, 260°C for 5 sec. / 215°C for 2 minutes  
 min. - 3.8mm max.  
 min. - 0.56mm max.

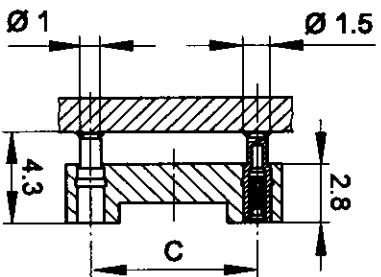
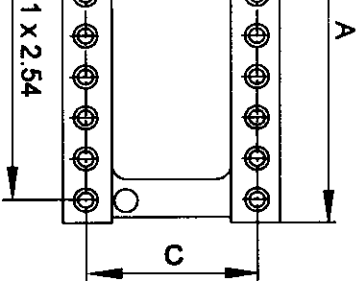

Positions	A	B	C
04	5.08	10.08	7.62
06	7.62	10.08	7.62
08	10.16	10.08	7.62
10	12.70	10.08	7.62
14	17.78	10.08	7.62
16	20.32	10.08	7.62
18	22.86	10.08	7.62
20	25.40	10.08	7.62
22	27.86	12.62	10.16
22(1)	27.94	10.08	7.62
24	30.48	17.70	15.24
24(1)	30.48	10.08	7.62
28	35.56	17.70	15.24
28(1)	35.56	10.08	7.62
32	40.64	17.70	15.24
36	45.75	17.70	15.24
40	50.80	17.70	15.24
48	60.96	17.70	15.24
50	63.50	25.32	22.86
64	81.28	25.32	22.86

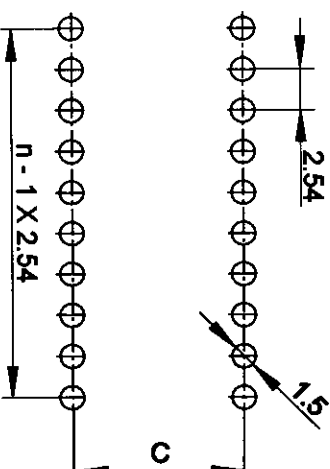

Recommended PCB Layout

Part Number

BU-\*\*0Z-178HT

\* - NUMBER OF POSITIONS

Units

mm

Drawing

Reviewed

Approved

Date



06/13/97

Sheet 1 of 1



Rev. A

## Looking for pricing, stock, or lifecycle information?

Click below to explore more details on WIN SOURCE:

-  [View BU160Z-178-HT on WIN SOURCE](#)
-  [On Shore Technology Inc. Information](#)

## Optimize Your Supply Chain with WIN SOURCE Solutions

-  Global Sourcing Solution
-  Obsolete Management
-  Cost Control Management
-  Shortage Management
-  Alternative Solution
-  Excess Inventory Management