

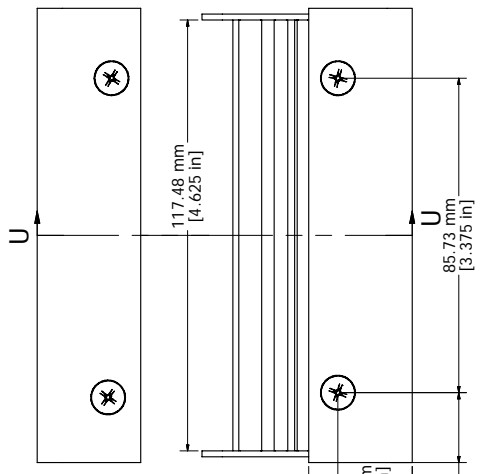

# THE DATASHEET OF 1402B



3 4 5 6 7 8



SECTION U-U

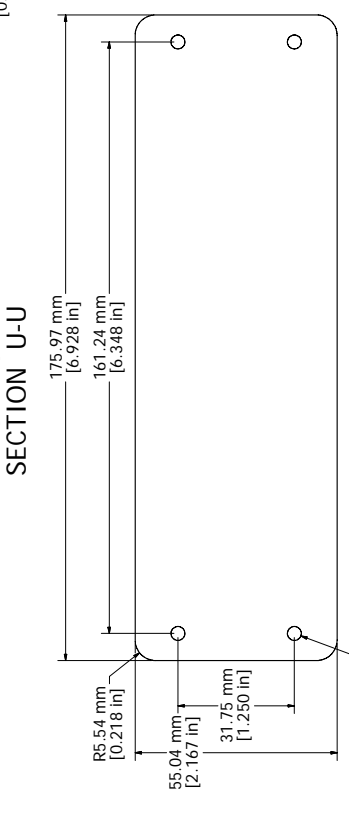

ASSEMBLY - VIEW FROM SIDE (OPEN)

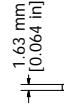

END PLATE - VIEW FROM OUTSIDE

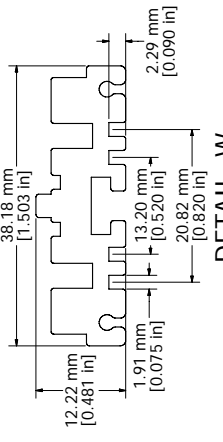
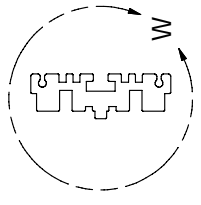

EXTRUSION - VIEW FROM INSIDE

|             |
|-------------|
| - 12 GA     |
| -           |
| EIG         |
| - 0.064" TH |
| -           |
| EXTRA SCR   |



Contact Factory  
Enclosures can be  
Solid models of



3 4 5 6 7 8

## Looking for pricing, stock, or lifecycle information?

Click below to explore more details on WIN SOURCE:

-  [View 1402B on WIN SOURCE](#)
-  [Hammond Manufacturing Information](#)

## Optimize Your Supply Chain with WIN SOURCE Solutions

-  Global Sourcing Solution
-  Obsolete Management
-  Cost Control Management
-  Shortage Management
-  Alternative Solution
-  Excess Inventory Management