



**THE DATASHEET OF  
PD-CAP-3/8-0**



REVISIONS

P	LTR	DESCRIPTION	DATE	DWN	APVD
	D	Updated A dim. for 3/16, 3/8 and 1/2.	5/2/19	J.B.	T.L.

## PD-Caps Semirigid Polyolefin Heat-shrinkable End Caps

As Supplied

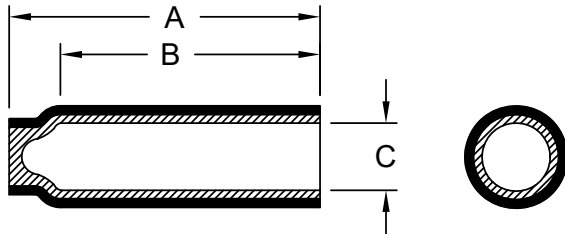

After Unrestricted Recovery

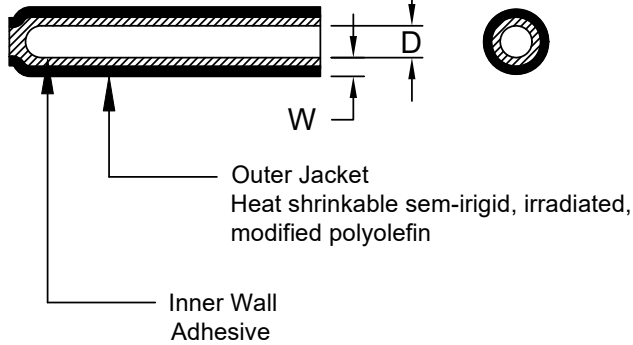

**Table 1: Dimensions mm (inches)**

Size	A	B Minimum	C Minimum	D Maximum	W Nominal
1/8	25.40 (1.000) ± 3.00 (0.125)	13.97 (0.550)	3.18 (0.125)	0.58 (0.023)	1.22 (0.048)
3/16	30.15 (1.187) ± 3.81 (0.150)	16.51 (0.650)	4.75 (0.187)	1.52 (0.060)	1.57 (0.062)
1/4	28.58 (1.125) ± 3.00 (0.125)	16.51 (0.650)	6.35 (0.250)	2.03 (0.080)	1.98 (0.078)
1/4	35.00 (1.378) ± 3.81 (0.150)	16.51 (0.650)	6.35 (0.250)	2.03 (0.080)	1.98 (0.078)
3/8	31.12 (1.225) ± 3.81 (0.150)	19.69 (0.775)	9.53 (0.375)	2.28 (0.090)	2.08 (0.082)
1/2	32.26 (1.270) ± 3.30 (0.130)	21.59 (0.850)	12.70 (0.500)	2.28 (0.090)	2.54 (0.100)
1/2	50.00 (1.968) ± 3.81 (0.150)	21.59 (0.850)	12.70 (0.500)	2.28 (0.090)	2.54 (0.100)

**Color:** Black



**Specification:** Formed from semirigid, encapsulant-lined polyolefin tubing per TEC-108-120027

THIS DRAWING IS UNPUBLISHED.  
 ALL RIGHTS RESERVED.  
 © COPYRIGHT 2019 TB Connectivity

DIMENSIONS: INCHES	DWN J. Bitter	10AUG2017	MATERIAL	FINISH
	CHK T. Licko	-	TE Connectivity Ltd.	
TOLERANCES UNLESS OTHERWISE SPECIFIED:  0 PLC ± - 1 PLC ± - 2 PLC ± - 3 PLC ± - 4 PLC ± - ANGLES ± -	APVD T. Licko	-		
	PRODUCT SPEC TEC-108-120027	-	NAME	RESTRICTED TO
	APPLICATION SPEC -	SIZE	CAGE CODE	DRAWING NO
	WEIGHT -	A4	06090	PD-CAPS
CUSTOMER DRAWING			SCALE None	SHEET 1 OF 1
			REV D	

## Looking for pricing, stock, or lifecycle information?

Click below to explore more details on WIN SOURCE:

-  [View PD-CAP-3/8-0 on WIN SOURCE](#)
-  [TE Connectivity Information](#)

## Optimize Your Supply Chain with WIN SOURCE Solutions

-  Global Sourcing Solution
-  Obsolete Management
-  Cost Control Management
-  Shortage Management
-  Alternative Solution
-  Excess Inventory Management