

**TOP VIEW**

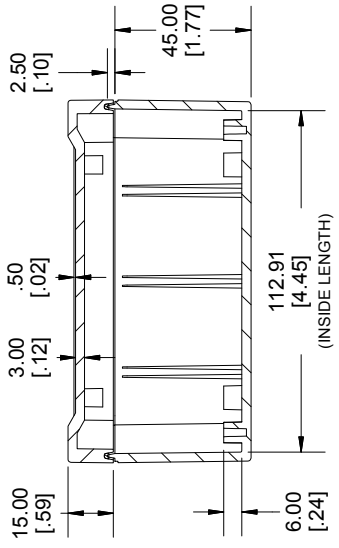

**SECTION A-A  
SIDE VIEW**

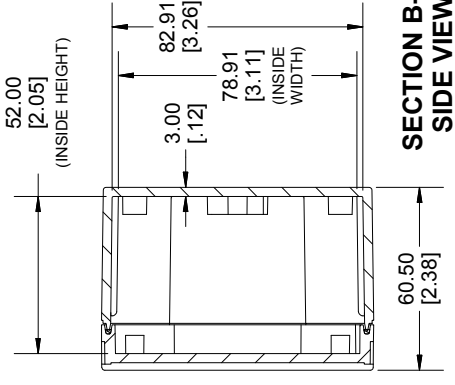

**SECTION B-B  
SIDE VIEW**

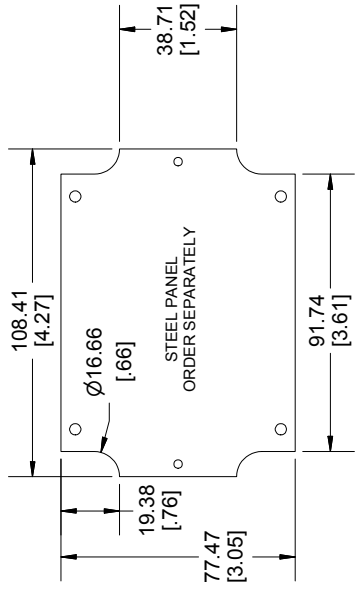

**INSIDE LID**

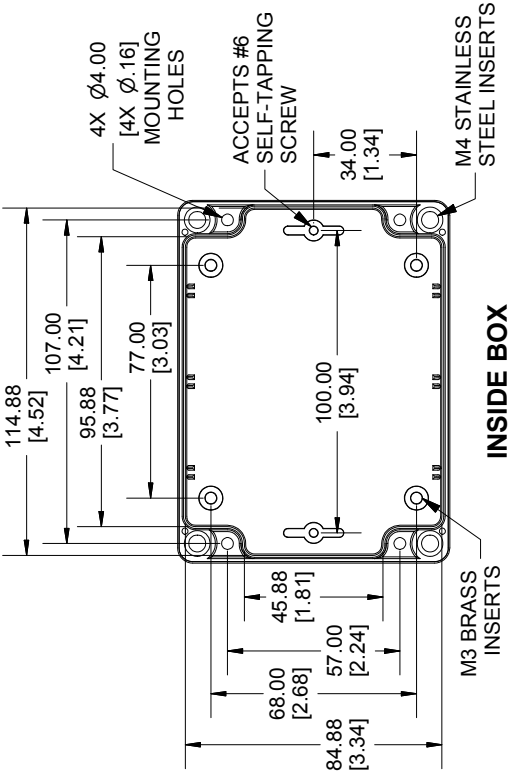

**INSIDE BOX**

**Dimensions:**  
mm  
[inches]

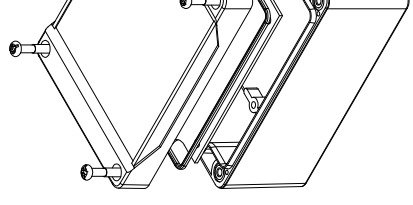

Enclosures can be  
Contact Factory  
Solid models of this  
(Part number and text placed  
we do not recommend using



Purchased assembly  
performed silicone gas  
General Purpose ABS  
Polycarbonate version  
**Recommended Co**

General Purp	Polycarbon	Steel	Steel Panel / P.C.	Steel Panel / P.C. E	Cover S	Silicone Pre-f
			[M3 x	[#6 X 1/4"	[M4 X 20mm	



## Looking for pricing, stock, or lifecycle information?

Click below to explore more details on WIN SOURCE:

-  [View 1555FFPL on WIN SOURCE](#)
-  [Hammond Manufacturing Information](#)

## Optimize Your Supply Chain with WIN SOURCE Solutions

-  Global Sourcing Solution
-  Obsolete Management
-  Cost Control Management
-  Shortage Management
-  Alternative Solution
-  Excess Inventory Management