



**THE DATASHEET OF
E32D101LPS302MC48M**



U32D Series



- Large Can
- Screw Terminals
- High Ripple
- 6.3 to 400VDC Voltage Range
- Dimensions in Inches
- RoHS Compliant
- +105°C Maximum Temperature



The U32D series allows for extremely high ripple currents for applications such as inverter designs and motor controllers. This series of capacitors offers very large capacitance of up to 2.2F and a maximum temperature rating of +105°C which allows a high operating temperature without sacrificing life. These capacitors are available with a variety of high current English or Metric thread terminals. Mounting options available are a three-footed clamp or bottom stud. (A special order two-footed clamp is also available for selected diameters.) All case size dimensions are based on inches. Custom designs are available upon request.

Summary of Specifications

- Screw terminals: high and low post, English and Metric thread.
- Capacitance range: 180 μ F to 2.2F.
- Voltage range: 6.3 to 400VDC.
- Category temperature range: -40°C to +105°C.
- Leakage current: 0.02CV(μ A) or 5mA, whichever is smaller, after 5 minutes at +25°C.
- Standard capacitance tolerance: \pm 20%
- Nominal case size (D \times L): D = 35mm (1.375") to 89mm (3.500"); L = 41mm (1.625") to 220mm (8.625").
- Rated lifetime: 2,000 hours at +105°C with rated ripple current applied.

U32D Series

U32D Specifications - Screw Terminals

| Item | Characteristics | | | | | | | | | | | | | | | | | | | | | | | | | | | | | | | | | | | | | | | | | | | | | | | | | | | | | | | | | | | | | | | | | | | | | | | | | | | | | | | | | | | | | | | | | | | |
|----------------------------------|---|---------|--------|-------|--------|-------|-------|------|------|------------------|---------------|------|-------|-------|------|-------|-------|-----------|-----------|------|------|------|------|------|------|----------|-----|------|------|------|------|------|------|-----------|------|------|------|------|------|------|------|-----|------|------|------|------|------|------|-----|------|------|------|------|------|------|-----------|------|------|------|------|------|------|------------|-----|------|------|------|------|------|------|-----------|------|------|------|------|------|------|-----|------|------|------|------|------|------|------------|-----------|------|------|------|------|------|------|
| Category Temperature Range | - 40 to +105°C | | | | | | | | | | | | | | | | | | | | | | | | | | | | | | | | | | | | | | | | | | | | | | | | | | | | | | | | | | | | | | | | | | | | | | | | | | | | | | | | | | | | | | | | | | | |
| Rated Voltage Range | 6.3 to 400VDC | | | | | | | | | | | | | | | | | | | | | | | | | | | | | | | | | | | | | | | | | | | | | | | | | | | | | | | | | | | | | | | | | | | | | | | | | | | | | | | | | | | | | | | | | | | |
| Capacitance Range | 180μF to 2.2F at +25°C, 120Hz | | | | | | | | | | | | | | | | | | | | | | | | | | | | | | | | | | | | | | | | | | | | | | | | | | | | | | | | | | | | | | | | | | | | | | | | | | | | | | | | | | | | | | | | | | | |
| Capacitance Tolerance | ± 20% (M) at +25°C, 120Hz | | | | | | | | | | | | | | | | | | | | | | | | | | | | | | | | | | | | | | | | | | | | | | | | | | | | | | | | | | | | | | | | | | | | | | | | | | | | | | | | | | | | | | | | | | | |
| Leakage Current | I = 0.02CV (μA) or 5mA, whichever is smaller, after 5 minutes at +25°C. Where I = Max. leakage current (μA), C = Nominal capacitance (μF) and V = Rated voltage (V) | | | | | | | | | | | | | | | | | | | | | | | | | | | | | | | | | | | | | | | | | | | | | | | | | | | | | | | | | | | | | | | | | | | | | | | | | | | | | | | | | | | | | | | | | | | |
| Rated Ripple Current Multipliers | <p>Ambient Temperature (°C)</p> <table border="1"> <tr> <td>≤ +45°C</td> <td>+65°C</td> <td>+85°C</td> <td>+105°C</td> </tr> <tr> <td>1.41</td> <td>1.29</td> <td>1.00</td> <td>0.57</td> </tr> </table> <p>Frequency (Hz)</p> <table border="1"> <thead> <tr> <th>DC Rated Voltage</th> <th>Case Diameter</th> <th>50Hz</th> <th>120Hz</th> <th>300Hz</th> <th>1kHz</th> <th>10kHz</th> <th>50kHz</th> </tr> </thead> <tbody> <tr> <td>6.3 - 50V</td> <td>∅35 - ∅76</td> <td>0.95</td> <td>1.00</td> <td>1.03</td> <td>1.05</td> <td>1.09</td> <td>1.12</td> </tr> <tr> <td rowspan="2">63 - 80V</td> <td>∅35</td> <td>0.90</td> <td>1.00</td> <td>1.06</td> <td>1.10</td> <td>1.18</td> <td>1.22</td> </tr> <tr> <td>∅51 - ∅76</td> <td>0.95</td> <td>1.00</td> <td>1.03</td> <td>1.05</td> <td>1.09</td> <td>1.12</td> </tr> <tr> <td rowspan="3">100V</td> <td>∅35</td> <td>0.82</td> <td>1.00</td> <td>1.12</td> <td>1.22</td> <td>1.30</td> <td>1.33</td> </tr> <tr> <td>∅51</td> <td>0.90</td> <td>1.00</td> <td>1.06</td> <td>1.10</td> <td>1.18</td> <td>1.22</td> </tr> <tr> <td>∅63 - ∅76</td> <td>0.95</td> <td>1.00</td> <td>1.03</td> <td>1.05</td> <td>1.09</td> <td>1.12</td> </tr> <tr> <td rowspan="3">160 - 250V</td> <td>∅35</td> <td>0.80</td> <td>1.00</td> <td>1.19</td> <td>1.34</td> <td>1.46</td> <td>1.52</td> </tr> <tr> <td>∅51 - ∅63</td> <td>0.81</td> <td>1.00</td> <td>1.14</td> <td>1.26</td> <td>1.36</td> <td>1.41</td> </tr> <tr> <td>∅76</td> <td>0.82</td> <td>1.00</td> <td>1.12</td> <td>1.22</td> <td>1.30</td> <td>1.33</td> </tr> <tr> <td>315 - 400V</td> <td>∅35 - ∅89</td> <td>0.80</td> <td>1.00</td> <td>1.19</td> <td>1.34</td> <td>1.46</td> <td>1.52</td> </tr> </tbody> </table> | ≤ +45°C | +65°C | +85°C | +105°C | 1.41 | 1.29 | 1.00 | 0.57 | DC Rated Voltage | Case Diameter | 50Hz | 120Hz | 300Hz | 1kHz | 10kHz | 50kHz | 6.3 - 50V | ∅35 - ∅76 | 0.95 | 1.00 | 1.03 | 1.05 | 1.09 | 1.12 | 63 - 80V | ∅35 | 0.90 | 1.00 | 1.06 | 1.10 | 1.18 | 1.22 | ∅51 - ∅76 | 0.95 | 1.00 | 1.03 | 1.05 | 1.09 | 1.12 | 100V | ∅35 | 0.82 | 1.00 | 1.12 | 1.22 | 1.30 | 1.33 | ∅51 | 0.90 | 1.00 | 1.06 | 1.10 | 1.18 | 1.22 | ∅63 - ∅76 | 0.95 | 1.00 | 1.03 | 1.05 | 1.09 | 1.12 | 160 - 250V | ∅35 | 0.80 | 1.00 | 1.19 | 1.34 | 1.46 | 1.52 | ∅51 - ∅63 | 0.81 | 1.00 | 1.14 | 1.26 | 1.36 | 1.41 | ∅76 | 0.82 | 1.00 | 1.12 | 1.22 | 1.30 | 1.33 | 315 - 400V | ∅35 - ∅89 | 0.80 | 1.00 | 1.19 | 1.34 | 1.46 | 1.52 |
| ≤ +45°C | +65°C | +85°C | +105°C | | | | | | | | | | | | | | | | | | | | | | | | | | | | | | | | | | | | | | | | | | | | | | | | | | | | | | | | | | | | | | | | | | | | | | | | | | | | | | | | | | | | | | | | | |
| 1.41 | 1.29 | 1.00 | 0.57 | | | | | | | | | | | | | | | | | | | | | | | | | | | | | | | | | | | | | | | | | | | | | | | | | | | | | | | | | | | | | | | | | | | | | | | | | | | | | | | | | | | | | | | | | |
| DC Rated Voltage | Case Diameter | 50Hz | 120Hz | 300Hz | 1kHz | 10kHz | 50kHz | | | | | | | | | | | | | | | | | | | | | | | | | | | | | | | | | | | | | | | | | | | | | | | | | | | | | | | | | | | | | | | | | | | | | | | | | | | | | | | | | | | | | |
| 6.3 - 50V | ∅35 - ∅76 | 0.95 | 1.00 | 1.03 | 1.05 | 1.09 | 1.12 | | | | | | | | | | | | | | | | | | | | | | | | | | | | | | | | | | | | | | | | | | | | | | | | | | | | | | | | | | | | | | | | | | | | | | | | | | | | | | | | | | | | | |
| 63 - 80V | ∅35 | 0.90 | 1.00 | 1.06 | 1.10 | 1.18 | 1.22 | | | | | | | | | | | | | | | | | | | | | | | | | | | | | | | | | | | | | | | | | | | | | | | | | | | | | | | | | | | | | | | | | | | | | | | | | | | | | | | | | | | | | |
| | ∅51 - ∅76 | 0.95 | 1.00 | 1.03 | 1.05 | 1.09 | 1.12 | | | | | | | | | | | | | | | | | | | | | | | | | | | | | | | | | | | | | | | | | | | | | | | | | | | | | | | | | | | | | | | | | | | | | | | | | | | | | | | | | | | | | |
| 100V | ∅35 | 0.82 | 1.00 | 1.12 | 1.22 | 1.30 | 1.33 | | | | | | | | | | | | | | | | | | | | | | | | | | | | | | | | | | | | | | | | | | | | | | | | | | | | | | | | | | | | | | | | | | | | | | | | | | | | | | | | | | | | | |
| | ∅51 | 0.90 | 1.00 | 1.06 | 1.10 | 1.18 | 1.22 | | | | | | | | | | | | | | | | | | | | | | | | | | | | | | | | | | | | | | | | | | | | | | | | | | | | | | | | | | | | | | | | | | | | | | | | | | | | | | | | | | | | | |
| | ∅63 - ∅76 | 0.95 | 1.00 | 1.03 | 1.05 | 1.09 | 1.12 | | | | | | | | | | | | | | | | | | | | | | | | | | | | | | | | | | | | | | | | | | | | | | | | | | | | | | | | | | | | | | | | | | | | | | | | | | | | | | | | | | | | | |
| 160 - 250V | ∅35 | 0.80 | 1.00 | 1.19 | 1.34 | 1.46 | 1.52 | | | | | | | | | | | | | | | | | | | | | | | | | | | | | | | | | | | | | | | | | | | | | | | | | | | | | | | | | | | | | | | | | | | | | | | | | | | | | | | | | | | | | |
| | ∅51 - ∅63 | 0.81 | 1.00 | 1.14 | 1.26 | 1.36 | 1.41 | | | | | | | | | | | | | | | | | | | | | | | | | | | | | | | | | | | | | | | | | | | | | | | | | | | | | | | | | | | | | | | | | | | | | | | | | | | | | | | | | | | | | |
| | ∅76 | 0.82 | 1.00 | 1.12 | 1.22 | 1.30 | 1.33 | | | | | | | | | | | | | | | | | | | | | | | | | | | | | | | | | | | | | | | | | | | | | | | | | | | | | | | | | | | | | | | | | | | | | | | | | | | | | | | | | | | | | |
| 315 - 400V | ∅35 - ∅89 | 0.80 | 1.00 | 1.19 | 1.34 | 1.46 | 1.52 | | | | | | | | | | | | | | | | | | | | | | | | | | | | | | | | | | | | | | | | | | | | | | | | | | | | | | | | | | | | | | | | | | | | | | | | | | | | | | | | | | | | | |
| Endurance (Load Life) | <p>The following specifications shall be satisfied when the capacitors are restored to +25°C after subjecting them to DC voltage for 2,000 hours at +105°C with the rated ripple current applied. The sum of the DC voltage and peak AC voltage must not exceed the full rated voltage of the capacitors.</p> <p>Capacitance change: ≤ 20% from initial measurement ESR change : ≤ 200% of initial specified limit Leakage current : ≤ initial specified limit</p> | | | | | | | | | | | | | | | | | | | | | | | | | | | | | | | | | | | | | | | | | | | | | | | | | | | | | | | | | | | | | | | | | | | | | | | | | | | | | | | | | | | | | | | | | | | |
| Shelf Test | <p>The following specifications shall be satisfied when the capacitors are restored to +25°C after exposing them for 500 hours at +105°C without voltage applied. The rated voltage shall be applied to the capacitors for a minimum of 30 minutes, at least 24 hours and not more than 48 hours before the measurements.</p> <p>Capacitance change: ≤ 20% from initial measurement ESR change : ≤ 200% of initial specified limit Leakage current : ≤ initial specified limit</p> | | | | | | | | | | | | | | | | | | | | | | | | | | | | | | | | | | | | | | | | | | | | | | | | | | | | | | | | | | | | | | | | | | | | | | | | | | | | | | | | | | | | | | | | | | | |

U32D Series

Diagram of Dimensions - Screw Terminals

Large Can/Screw Terminals

Unit: inches (mm)

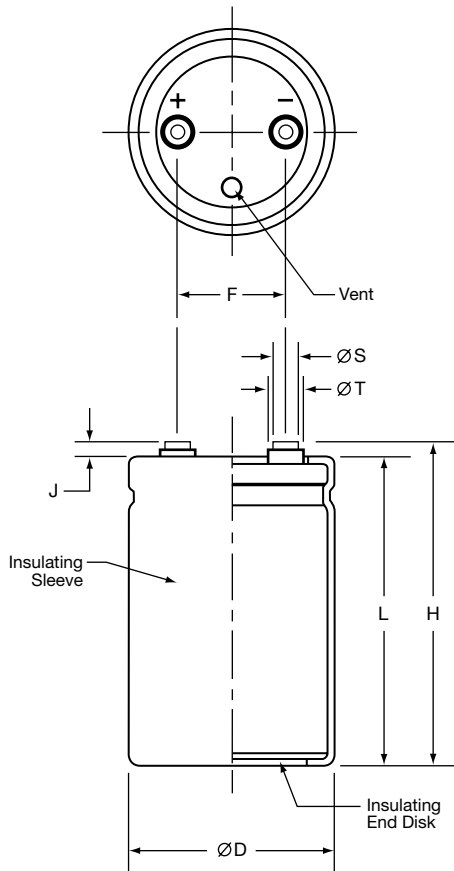

Case Dimensions

| Case Size Code | ØD +0.080 (2.0) | L ±0.040 (1.0) | F ±0.010 (0.25) |
|---|--------------------|--|--------------------|
| A41 A54 A67 A79 A92 AA5 AB7 AD0 AE3 | 1.375 (35.0) | 1.625 (41) 2.125 (54) 2.625 (67) 3.125 (79) 3.625 (92) 4.125 (105) 4.625 (117) 5.125 (130) 5.625 (143) | 0.500 (12.7) |
| C48 C54 C67 C79 C92 CA5 CB7 CD0 CE3 | 2.000 (50.8) | 1.875 (48) 2.125 (54) 2.625 (67) 3.125 (79) 3.625 (92) 4.125 (105) 4.625 (117) 5.125 (130) 5.625 (143) | 0.875 (22.2) |
| D79 DA5 DB7 DD0 DE3 | 2.500 (63.5) | 3.125 (79) 4.125 (105) 4.625 (117) 5.125 (130) 5.625 (143) | 1.125 (28.6) |
| E92 EA5 EB7 ED0 EE3 EN0 | 3.000 (76.2) | 3.625 (92) 4.125 (105) 4.625 (117) 5.125 (130) 5.625 (143) 8.625 (220) | 1.250 (31.8) |
| FA5 FB7 FE3 | 3.500 (89.0) | 4.125 (105) 4.625 (117) 5.625 (143) | 1.250 (31.8) |

Terminal Specifications

| Terminal Code | Available Case Diameter | | Thread Size | Minimum Thread Depth | J ±0.020 (0.5) | H ±0.080 (2.0) | ØS ±0.010 (0.25) | ØT ±0.010 (0.25) |
|---------------|-------------------------|-----------------------------|----------------|----------------------|-------------------|-------------------|---------------------|---------------------|
| | ØD Code | ØD inches (mm) | | | | | | |
| HP | C-E | 1.375 - 3.000 (35.0 - 76.2) | 10 - 32 NF-2B | 0.375 (9.5) | 0.250 (6.4) | L+J | 0.313 (8.0) | 0.438 (11.1) |
| LP | C-E | 1.375 - 3.000 (35.0 - 76.2) | 10 - 32 NF-2B | 0.219 (5.6) | 0.063 (1.6) | L+J | 0.313 (8.0) | — |
| HL | C-E | 1.375 - 3.000 (35.0 - 76.2) | M5x0.8-6H | 0.375 (9.5) | 0.250 (6.4) | L+J | 0.313 (8.0) | 0.438 (11.1) |
| ML | C-E | 1.375 - 3.000 (35.0 - 76.2) | M5x0.8-6H | 0.219 (5.6) | 0.063 (1.6) | L+J | 0.313 (8.0) | 0.438 (11.1) |
| CD | D-E | 2.500 - 3.000 (63.5 - 76.2) | M5x0.8-6H | 0.335 (8.5) | 0.200 (5.0) | L+J | 0.512 (13.0) | 0.740 (18.8) |
| CP | D-F | 2.500 - 3.500 (63.5 - 89.0) | 1/4 - 28 NF-2B | 0.344 (8.7) | 0.093 (2.4) | L+J | 0.689 (17.5) | — |
| CH | D-F | 2.500 - 3.500 (63.5 - 89.0) | 1/4 - 28 NF-2B | 0.468 (11.9) | 0.250 (6.4) | L+J | 0.689 (17.5) | — |
| CA | D-F | 2.500 - 3.500 (63.5 - 89.0) | M6x1-6H | 0.344 (8.7) | 0.093 (2.4) | L+J | 0.689 (17.5) | — |
| CS | D-F | 2.500 - 3.500 (63.5 - 89.0) | M6x1-6H | 0.468 (11.9) | 0.250 (6.4) | L+J | 0.689 (17.5) | — |

U32D
LARGE CAN 105°C

U32D Series

Mounting Hardware - Screw Terminals

Type C: Three-Footed Clamp

Unit: mm (inches)

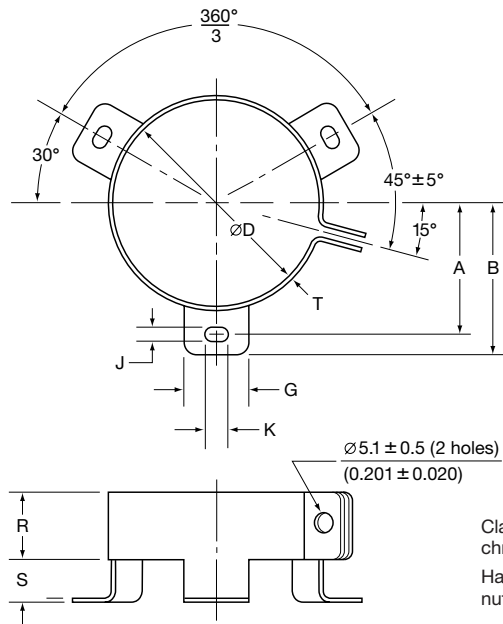

Clamp: Zinc with silver trivalent chromate post treatment.

Hardware: Screw, washer and hexagon nut included with each clamp.

Type C: Clamp Dimensions

| Mounting Code | Case ØD | A ±1.0 (0.040) | B ±1.0 (0.040) | G ±1.0 (0.040) | J ±0.5 (0.020) | K ±0.5 (0.020) | R ±1.0 (0.040) | S ±1.0 (0.040) | T ±0.5 (0.020) |
|---------------|--------------|-------------------|-------------------|-------------------|-------------------|-------------------|-------------------|-------------------|-------------------|
| See Note | 35.0 (1.375) | — | — | — | — | — | — | — | — |
| C | 50.8 (2.000) | 31.8 (1.250) | 36.5 (1.437) | 13.3 (0.524) | 4.5 (0.177) | 7.1 (0.280) | 19.1 (0.751) | 9.5 (0.374) | 0.8 (0.032) |
| C | 63.5 (2.500) | 38.1 (1.500) | 42.9 (1.689) | 13.3 (0.524) | 4.5 (0.177) | 7.1 (0.280) | 19.1 (0.751) | 9.5 (0.374) | 0.8 (0.032) |
| C | 76.2 (3.000) | 44.5 (1.750) | 49.2 (1.937) | 13.3 (0.524) | 4.5 (0.177) | 7.1 (0.280) | 19.1 (0.751) | 9.5 (0.374) | 1.0 (0.040) |
| C | 89.0 (3.500) | 50.8 (2.000) | 56.5 (2.224) | 16.0 (0.630) | 4.5 (0.177) | 8.0 (0.313) | 21.0 (0.827) | 9.0 (0.354) | 1.0 (0.040) |

Note: Type B two-footed clamp available upon request for Ø35, Ø50.8, Ø63.5 and Ø76.2. Consult UCC for specifications.

Type S: Stud Mounting

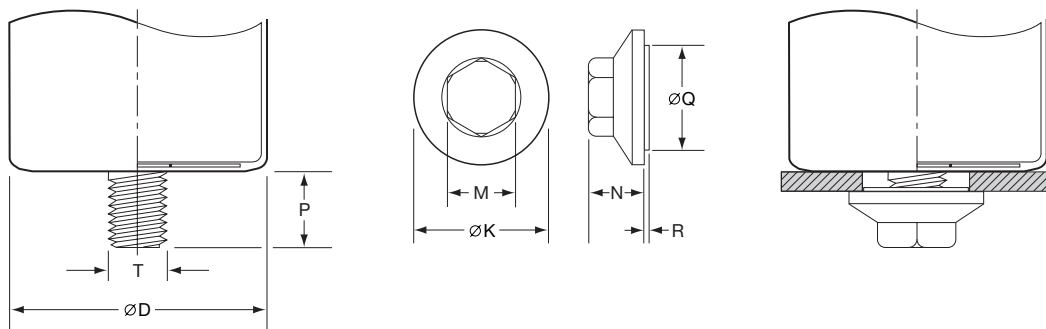

Type S: Stud Mounting Dimensions

| Mounting Code | P ±1.0 (0.040) | T Thread Size | M ±1.0 (0.040) | N ±1.0 (0.040) | ØK ±2.0 (0.080) | ØQ ±1.0 (0.040) | R ±1.0 (0.040) |
|---------------|-------------------|------------------|-------------------|-------------------|--------------------|--------------------|-------------------|
| S | 16.0 (0.630) | M12 | 19.0 (0.748) | 18.0 (0.709) | 30.0 (1.181) | 22.0 (0.866) | 1.40 (0.055) |

U32D Series

Part Numbering System for U32D Series When ordering, always specify complete 18-field global part number.

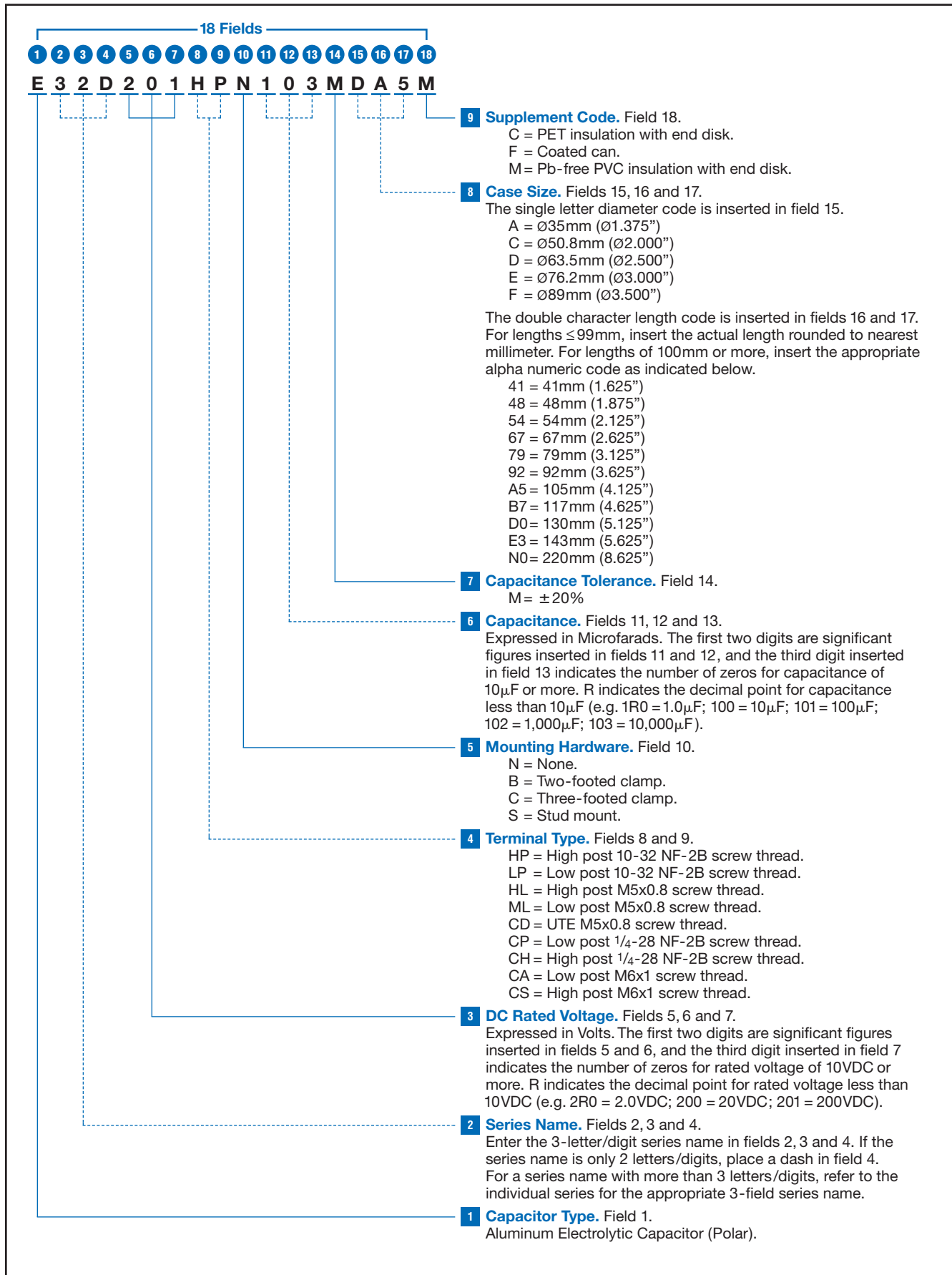

LARGE CAN 105°C
U32D

U32D Series

Standard Voltage Ratings - Screw Terminals

| Rated Voltage (WVDC) | Capacitance (µF) | Global Part Number† | Nominal Case Size* D × L (inches) | Case Size Code | Maximum ESR (mΩ) at +25°C, 120Hz | Rated Ripple Current (A rms) at +85°C, 120Hz |
|-----------------------------------|--------------------|---------------------|-----------------------------------|----------------|----------------------------------|--|
| 6.3 Volts 8 Volts Surge | 39,000 | E32D6R3HPN393MA41M | 1.375 × 1.625 | A41 | 39.9 | 7.03 |
| | 68,000 | E32D6R3HPN683MA54M | 1.375 × 2.125 | A54 | 24.0 | 9.62 |
| | 82,000 | E32D6R3HPN823MA67M | 1.375 × 2.625 | A67 | 19.5 | 10.87 |
| | 120,000 | E32D6R3HPN124MA79M | 1.375 × 3.125 | A79 | 14.5 | 13.76 |
| | 150,000 | E32D6R3HPN154MA92M | 1.375 × 3.625 | A92 | 12.2 | 15.53 |
| | 180,000 | E32D6R3HPN184MAA5M | 1.375 × 4.125 | AA5 | 11.8 | 18.10 |
| | 220,000 | E32D6R3HPN224MAD0M | 1.375 × 5.125 | AD0 | 9.1 | 20.93 |
| | 82,000 | E32D6R3HPN823MC48M | 2.000 × 1.875 | C48 | 22.1 | 11.19 |
| | 120,000 | E32D6R3HPN124MC54M | 2.000 × 2.125 | C54 | 16.2 | 13.53 |
| | 180,000 | E32D6R3HPN184MC67M | 2.000 × 2.625 | C67 | 11.3 | 17.11 |
| | 220,000 | E32D6R3HPN224MC79M | 2.000 × 3.125 | C79 | 9.2 | 20.41 |
| | 330,000 | E32D6R3HPN334MC92M | 2.000 × 3.625 | C92 | 7.7 | 24.76 |
| | 390,000 | E32D6R3HPN394MCA5M | 2.000 × 4.125 | CA5 | 6.4 | 27.19 |
| | 470,000 | E32D6R3HPN474MCB7M | 2.000 × 4.625 | CB7 | 6.0 | 30.87 |
| | 560,000 | E32D6R3HPN564MCE3M | 2.000 × 5.625 | CE3 | 4.9 | 35.78 |
| | 390,000 | E32D6R3HPN394MD79M | 2.500 × 3.125 | D79 | 8.7 | 22.54 |
| | 560,000 | E32D6R3HPN564MDA5M | 2.500 × 4.125 | DA5 | 6.3 | 29.81 |
| | 820,000 | E32D6R3HPN824MDB7M | 2.500 × 4.625 | DB7 | 5.7 | 32.97 |
| | 680,000 | E32D6R3HPN684ME92M | 3.000 × 3.625 | E92 | 8.3 | 26.88 |
| | 820,000 | E32D6R3HPN824MEA5M | 3.000 × 4.125 | EA5 | 7.2 | 30.40 |
| 1,000,000 | E32D6R3HPN105MEB7M | 3.000 × 4.625 | EB7 | 6.6 | 33.32 | |
| 1,200,000 | E32D6R3HPN125MED0M | 3.000 × 5.125 | ED0 | 6.1 | 36.04 | |
| 2,200,000 | E32D6R3HPN225MEN0M | 3.000 × 8.625 | EN0 | 4.0 | 56.03 | |
| 10 Volts 13 Volts Surge | 33,000 | E32D100HPN333MA41M | 1.375 × 1.625 | A41 | 39.7 | 7.03 |
| | 56,000 | E32D100HPN563MA54M | 1.375 × 2.125 | A54 | 24.3 | 9.55 |
| | 68,000 | E32D100HPN683MA67M | 1.375 × 2.625 | A67 | 19.6 | 10.79 |
| | 100,000 | E32D100HPN104MA79M | 1.375 × 3.125 | A79 | 14.6 | 13.71 |
| | 120,000 | E32D100HPN124MA92M | 1.375 × 3.625 | A92 | 12.5 | 14.66 |
| | 150,000 | E32D100HPN154MAB7M | 1.375 × 4.625 | AB7 | 10.4 | 18.83 |
| | 180,000 | E32D100HPN184MAD0M | 1.375 × 5.125 | AD0 | 9.2 | 20.80 |
| | 68,000 | E32D100HPN683MC48M | 2.000 × 1.875 | C48 | 22.2 | 11.13 |
| | 100,000 | E32D100HPN104MC54M | 2.000 × 2.125 | C54 | 16.3 | 13.48 |
| | 150,000 | E32D100HPN154MC67M | 2.000 × 2.625 | C67 | 11.4 | 17.11 |
| | 180,000 | E32D100HPN184MC79M | 2.000 × 3.125 | C79 | 9.3 | 20.28 |
| | 270,000 | E32D100HPN274MC92M | 2.000 × 3.625 | C92 | 7.8 | 24.76 |
| | 390,000 | E32D100HPN394MCB7M | 2.000 × 4.625 | CB7 | 6.0 | 30.55 |
| | 470,000 | E32D100HPN474MCE3M | 2.000 × 5.625 | CE3 | 4.9 | 35.78 |
| | 330,000 | E32D100HPN334MD79M | 2.500 × 3.125 | D79 | 8.8 | 22.40 |
| | 470,000 | E32D100HPN474MDA5M | 2.500 × 4.125 | DA5 | 6.4 | 29.81 |
| | 560,000 | E32D100HPN564MDB7M | 2.500 × 4.625 | DB7 | 5.7 | 33.95 |
| | 680,000 | E32D100HPN684MDD0M | 2.500 × 5.125 | DD0 | 5.3 | 36.68 |
| | 560,000 | E32D100HPN564ME92M | 3.000 × 3.625 | E92 | 8.3 | 26.88 |
| | 680,000 | E32D100HPN684MEA5M | 3.000 × 4.125 | EA5 | 7.2 | 30.40 |
| 820,000 | E32D100HPN824MEB7M | 3.000 × 4.625 | EB7 | 6.5 | 33.32 | |
| 1,000,000 | E32D100HPN105MED0M | 3.000 × 5.125 | ED0 | 6.1 | 36.04 | |
| 1,800,000 | E32D100HPN185MEN0M | 3.000 × 8.625 | EN0 | 4.0 | 56.03 | |
| 16 Volts 20 Volts Surge | 22,000 | E32D160HPN223MA41M | 1.375 × 1.625 | A41 | 41.4 | 6.26 |
| | 39,000 | E32D160HPN393MA54M | 1.375 × 2.125 | A54 | 27.3 | 8.68 |
| | 47,000 | E32D160HPN473MA67M | 1.375 × 2.625 | A67 | 19.9 | 9.80 |
| | 68,000 | E32D160HPN683MA79M | 1.375 × 3.125 | A79 | 15.0 | 12.48 |
| | 82,000 | E32D160HPN823MA92M | 1.375 × 3.625 | A92 | 12.8 | 14.04 |
| | 100,000 | E32D160HPN104MAA5M | 1.375 × 4.125 | AA5 | 11.1 | 16.47 |
| | 120,000 | E32D160HPN124MAD0M | 1.375 × 5.125 | AD0 | 9.5 | 19.11 |
| | 150,000 | E32D160HPN154MAE3M | 1.375 × 5.625 | AE3 | 9.3 | 21.33 |
| | 47,000 | E32D160HPN473MC48M | 2.000 × 1.875 | C48 | 22.7 | 10.18 |
| | 68,000 | E32D160HPN683MC54M | 2.000 × 2.125 | C54 | 16.7 | 12.38 |
| | 100,000 | E32D160HPN104MC67M | 2.000 × 2.625 | C67 | 11.7 | 15.75 |
| | 120,000 | E32D160HPN124MC79M | 2.000 × 3.125 | C79 | 9.6 | 18.66 |

† For terminal, mounting and construction options, refer to the part numbering system for descriptions and codes.

* Refer to diagram of dimensions for detailed case size specifications.

U32D Series

Standard Voltage Ratings - Screw Terminals

| Rated Voltage (WVDC) | Capacitance (µF) | Global Part Number† | Nominal Case Size* D × L (inches) | Case Size Code | Maximum ESR (mΩ) at +25°C, 120Hz | Rated Ripple Current (A rms) at +85°C, 120Hz |
|----------------------------|--------------------|---------------------|-----------------------------------|----------------|----------------------------------|--|
| 16 Volts 20 Volts Surge | 180,000 | E32D160HPN184MC92M | 2.000 × 3.625 | C92 | 7.5 | 22.89 |
| | 220,000 | E32D160HPN224MCA5M | 2.000 × 4.125 | CA5 | 7.0 | 25.40 |
| | 270,000 | E32D160HPN274MCB7M | 2.000 × 4.625 | CB7 | 6.1 | 28.80 |
| | 330,000 | E32D160HPN334MCE3M | 2.000 × 5.625 | CE3 | 5.2 | 33.82 |
| | 220,000 | E32D160HPN224MD79M | 2.500 × 3.125 | D79 | 8.9 | 21.75 |
| | 330,000 | E32D160HPN334MDA5M | 2.500 × 4.125 | DA5 | 6.5 | 28.62 |
| | 390,000 | E32D160HPN394MDB7M | 2.500 × 4.625 | DB7 | 5.9 | 32.66 |
| | 470,000 | E32D160HPN474MDD0M | 2.500 × 5.125 | DD0 | 5.4 | 34.54 |
| | 390,000 | E32D160HPN394ME92M | 3.000 × 3.625 | E92 | 8.5 | 26.07 |
| | 470,000 | E32D160HPN474MEA5M | 3.000 × 4.125 | EA5 | 7.4 | 29.56 |
| | 560,000 | E32D160HPN564MEB7M | 3.000 × 4.625 | EB7 | 6.7 | 32.56 |
| | 680,000 | E32D160HPN684MED0M | 3.000 × 5.125 | ED0 | 6.2 | 35.45 |
| | 820,000 | E32D160HPN824MEE3M | 3.000 × 5.625 | EE3 | 5.4 | 37.58 |
| 1,200,000 | E32D160HPN125MEN0M | 3.000 × 8.625 | EN0 | 4.0 | 55.32 | |
| 25 Volts 32 Volts Surge | 15,000 | E32D250HPN153MA41M | 1.375 × 1.625 | A41 | 41.3 | 6.27 |
| | 22,000 | E32D250HPN223MA54M | 1.375 × 2.125 | A54 | 27.7 | 8.20 |
| | 33,000 | E32D250HPN333MA67M | 1.375 × 2.625 | A67 | 19.5 | 9.88 |
| | 47,000 | E32D250HPN473MA79M | 1.375 × 3.125 | A79 | 16.6 | 12.53 |
| | 56,000 | E32D250HPN563MA92M | 1.375 × 3.625 | A92 | 12.8 | 13.71 |
| | 68,000 | E32D250HPN683MAA5M | 1.375 × 4.125 | AA5 | 12.3 | 16.47 |
| | 82,000 | E32D250HPN823MAD0M | 1.375 × 5.125 | AD0 | 9.4 | 19.11 |
| | 33,000 | E32D250HPN333MC48M | 2.000 × 1.875 | C48 | 22.4 | 10.23 |
| | 47,000 | E32D250HPN473MC54M | 2.000 × 2.125 | C54 | 16.6 | 12.42 |
| | 68,000 | E32D250HPN683MC67M | 2.000 × 2.625 | C67 | 11.7 | 15.68 |
| | 82,000 | E32D250HPN823MC79M | 2.000 × 3.125 | C79 | 9.6 | 18.76 |
| | 120,000 | E32D250HPN124MC92M | 2.000 × 3.625 | C92 | 7.6 | 22.73 |
| | 180,000 | E32D250HPN184MCB7M | 2.000 × 4.625 | CB7 | 6.1 | 28.80 |
| | 220,000 | E32D250HPN224MCE3M | 2.000 × 5.625 | CE3 | 5.3 | 33.82 |
| | 150,000 | E32D250HPN154MD79M | 2.500 × 3.125 | D79 | 8.9 | 21.63 |
| | 220,000 | E32D250HPN224MDA5M | 2.500 × 4.125 | DA5 | 6.5 | 28.62 |
| | 270,000 | E32D250HPN274MDB7M | 2.500 × 4.625 | DB7 | 5.9 | 32.66 |
| | 330,000 | E32D250HPN334MDE3M | 2.500 × 5.625 | DE3 | 4.9 | 37.88 |
| | 270,000 | E32D250HPN274ME92M | 3.000 × 3.625 | E92 | 8.6 | 25.92 |
| | 330,000 | E32D250HPN334MEA5M | 3.000 × 4.125 | EA5 | 7.5 | 29.16 |
| 390,000 | E32D250HPN394MEB7M | 3.000 × 4.625 | EB7 | 6.8 | 32.31 | |
| 470,000 | E32D250HPN474MED0M | 3.000 × 5.125 | ED0 | 6.3 | 35.16 | |
| 820,000 | E32D250HPN824MEN0M | 3.000 × 8.625 | EN0 | 4.1 | 55.32 | |
| 35 Volts 44 Volts Surge | 10,000 | E32D350HPN103MA41M | 1.375 × 1.625 | A41 | 45.8 | 5.94 |
| | 18,000 | E32D350HPN183MA54M | 1.375 × 2.125 | A54 | 26.7 | 8.33 |
| | 22,000 | E32D350HPN223MA67M | 1.375 × 2.625 | A67 | 21.6 | 9.40 |
| | 33,000 | E32D350HPN333MA79M | 1.375 × 3.125 | A79 | 15.7 | 12.14 |
| | 39,000 | E32D350HPN393MA92M | 1.375 × 3.625 | A92 | 13.6 | 13.60 |
| | 47,000 | E32D350HPN473MAA5M | 1.375 × 4.125 | AA5 | 11.8 | 15.95 |
| | 56,000 | E32D350HPN563MAB7M | 1.375 × 4.625 | AB7 | 10.4 | 17.35 |
| | 68,000 | E32D350HPN683MAE3M | 1.375 × 5.625 | AE3 | 8.9 | 20.57 |
| | 22,000 | E32D350HPN223MC48M | 2.000 × 1.875 | C48 | 24.1 | 9.86 |
| | 33,000 | E32D350HPN333MC54M | 2.000 × 2.125 | C54 | 17.4 | 12.15 |
| | 47,000 | E32D350HPN473MC67M | 2.000 × 2.625 | C67 | 12.4 | 15.34 |
| | 68,000 | E32D350HPN683MC79M | 2.000 × 3.125 | C79 | 9.4 | 18.76 |
| | 82,000 | E32D350HPN823MC92M | 2.000 × 3.625 | C92 | 7.9 | 22.26 |
| | 100,000 | E32D350HPN104MCA5M | 2.000 × 4.125 | CA5 | 6.9 | 24.82 |
| | 120,000 | E32D350HPN124MCB7M | 2.000 × 4.625 | CB7 | 6.1 | 28.03 |
| | 150,000 | E32D350HPN154MCE3M | 2.000 × 5.625 | CE3 | 5.2 | 33.12 |
| | 100,000 | E32D350HPN104MD79M | 2.500 × 3.125 | D79 | 8.8 | 21.88 |
| | 150,000 | E32D350HPN154MDA5M | 2.500 × 4.125 | DA5 | 6.5 | 28.84 |
| | 220,000 | E32D350HPN224MDB7M | 2.500 × 4.625 | DB7 | 5.8 | 32.08 |

† For terminal, mounting and construction options, refer to the part numbering system for descriptions and codes.

* Refer to diagram of dimensions for detailed case size specifications.

U32D
LARGE CAN 105°C

U32D Series

Standard Voltage Ratings - Screw Terminals

| Rated Voltage (WVDC) | Capacitance (µF) | Global Part Number† | Nominal Case Size* D × L (inches) | Case Size Code | Maximum ESR (mΩ) at +25°C, 120Hz | Rated Ripple Current (A rms) at +85°C, 120Hz |
|-----------------------------------|--------------------|---------------------|-----------------------------------|----------------|----------------------------------|--|
| 35 Volts 44 Volts Surge | 220,000 | E32D350HPN224ME92M | 3.000 × 3.625 | E92 | 8.3 | 25.19 |
| | 270,000 | E32D350HPN274MEB7M | 3.000 × 4.625 | EB7 | 6.6 | 32.81 |
| | 330,000 | E32D350HPN334MED0M | 3.000 × 5.125 | ED0 | 6.2 | 35.45 |
| | 390,000 | E32D350HPN394MEE3M | 3.000 × 5.625 | EE3 | 5.4 | 37.90 |
| | 560,000 | E32D350HPN564MEN0M | 3.000 × 8.625 | EN0 | 4.0 | 56.03 |
| 50 Volts 63 Volts Surge | 5,600 | E32D500HPN562MA41M | 1.375 × 1.625 | A41 | 52.2 | 5.66 |
| | 10,000 | E32D500HPN103MA54M | 1.375 × 2.125 | A54 | 30.3 | 7.25 |
| | 15,000 | E32D500HPN153MA67M | 1.375 × 2.625 | A67 | 21.3 | 9.01 |
| | 18,000 | E32D500HPN183MA79M | 1.375 × 3.125 | A79 | 17.9 | 10.92 |
| | 22,000 | E32D500HPN223MA92M | 1.375 × 3.625 | A92 | 15.1 | 12.58 |
| | 27,000 | E32D500HPN273MAA5M | 1.375 × 4.125 | AA5 | 12.9 | 15.23 |
| | 33,000 | E32D500HPN333MAB7M | 1.375 × 4.625 | AB7 | 12.5 | 17.22 |
| | 39,000 | E32D500HPN393MAE3M | 1.375 × 5.625 | AE3 | 9.7 | 20.56 |
| | 15,000 | E32D500HPN153MC48M | 2.000 × 1.875 | C48 | 24.3 | 10.01 |
| | 18,000 | E32D500HPN183MC54M | 2.000 × 2.125 | C54 | 19.4 | 11.50 |
| | 27,000 | E32D500HPN273MC67M | 2.000 × 2.625 | C67 | 13.4 | 14.97 |
| | 39,000 | E32D500HPN393MC79M | 2.000 × 3.125 | C79 | 10.1 | 19.30 |
| | 56,000 | E32D500HPN563MC92M | 2.000 × 3.625 | C92 | 8.5 | 22.56 |
| | 68,000 | E32D500HPN683MCB7M | 2.000 × 4.625 | CB7 | 6.5 | 27.67 |
| | 82,000 | E32D500HPN823MCD0M | 2.000 × 5.125 | CD0 | 5.8 | 29.50 |
| | 100,000 | E32D500HPN104MCE3M | 2.000 × 5.625 | CE3 | 5.6 | 34.03 |
| | 68,000 | E32D500HPN683MD79M | 2.500 × 3.125 | D79 | 9.4 | 24.55 |
| | 100,000 | E32D500HPN104MDA5M | 2.500 × 4.125 | DA5 | 6.8 | 31.43 |
| | 120,000 | E32D500HPN124MDB7M | 2.500 × 4.625 | DB7 | 5.9 | 34.04 |
| | 150,000 | E32D500HPN154MDE3M | 2.500 × 5.625 | DE3 | 5.1 | 37.63 |
| 120,000 | E32D500HPN124ME92M | 3.000 × 3.625 | E92 | 8.9 | 33.88 | |
| 150,000 | E32D500HPN154MEA5M | 3.000 × 4.125 | EA5 | 7.8 | 36.22 | |
| 180,000 | E32D500HPN184MEB7M | 3.000 × 4.625 | EB7 | 6.5 | 38.22 | |
| 220,000 | E32D500HPN224MEE3M | 3.000 × 5.625 | EE3 | 5.7 | 44.44 | |
| 330,000 | E32D500HPN334MEN0M | 3.000 × 8.625 | EN0 | 4.0 | 65.97 | |
| 63 Volts 79 Volts Surge | 4,700 | E32D630HPN472MA41M | 1.375 × 1.625 | A41 | 57.1 | 5.18 |
| | 6,800 | E32D630HPN682MA54M | 1.375 × 2.125 | A54 | 33.8 | 6.68 |
| | 10,000 | E32D630HPN103MA67M | 1.375 × 2.625 | A67 | 23.9 | 7.36 |
| | 12,000 | E32D630HPN123MA79M | 1.375 × 3.125 | A79 | 20.1 | 8.92 |
| | 15,000 | E32D630HPN153MA92M | 1.375 × 3.625 | A92 | 16.6 | 10.39 |
| | 18,000 | E32D630HPN183MAA5M | 1.375 × 4.125 | AA5 | 14.3 | 12.44 |
| | 22,000 | E32D630HPN223MAB7M | 1.375 × 4.625 | AB7 | 12.3 | 14.06 |
| | 27,000 | E32D630HPN273MAD0M | 1.375 × 5.125 | AD0 | 12.1 | 16.36 |
| | 10,000 | E32D630HPN103MC48M | 2.000 × 1.875 | C48 | 26.7 | 8.18 |
| | 12,000 | E32D630HPN123MC54M | 2.000 × 2.125 | C54 | 21.5 | 9.39 |
| | 22,000 | E32D630HPN223MC67M | 2.000 × 2.625 | C67 | 14.8 | 13.52 |
| | 27,000 | E32D630HPN273MC79M | 2.000 × 3.125 | C79 | 10.8 | 16.06 |
| | 39,000 | E32D630HPN393MC92M | 2.000 × 3.625 | C92 | 9.1 | 20.62 |
| | 47,000 | E32D630HPN473MCB7M | 2.000 × 4.625 | CB7 | 6.9 | 23.00 |
| | 56,000 | E32D630HPN563MCD0M | 2.000 × 5.125 | CD0 | 6.2 | 26.34 |
| | 68,000 | E32D630HPN683MCE3M | 2.000 × 5.625 | CE3 | 6.0 | 30.31 |
| | 47,000 | E32D630HPN473MD79M | 2.500 × 3.125 | D79 | 9.6 | 22.05 |
| | 68,000 | E32D630HPN683MDA5M | 2.500 × 4.125 | DA5 | 6.9 | 29.84 |
| | 82,000 | E32D630HPN823MDB7M | 2.500 × 4.625 | DB7 | 6.2 | 29.93 |
| | 100,000 | E32D630HPN104MDE3M | 2.500 × 5.625 | DE3 | 5.2 | 32.23 |
| 82,000 | E32D630HPN823ME92M | 3.000 × 3.625 | E92 | 8.9 | 29.71 | |
| 100,000 | E32D630HPN104MEA5M | 3.000 × 4.125 | EA5 | 7.7 | 34.67 | |
| 120,000 | E32D630HPN124MEB7M | 3.000 × 4.625 | EB7 | 6.9 | 35.58 | |
| 150,000 | E32D630HPN154MEE3M | 3.000 × 5.625 | EE3 | 5.7 | 39.63 | |
| 220,000 | E32D630HPN224MEN0M | 3.000 × 8.625 | EN0 | 4.0 | 53.86 | |

† For terminal, mounting and construction options, refer to the part numbering system for descriptions and codes.

* Refer to diagram of dimensions for detailed case size specifications.

U32D Series

Standard Voltage Ratings - Screw Terminals

| Rated Voltage (WVDC) | Capacitance (µF) | Global Part Number† | Nominal Case Size* D × L (inches) | Case Size Code | Maximum ESR (mΩ) at +25°C, 120Hz | Rated Ripple Current (A rms) at +85°C, 120Hz |
|-------------------------------------|--------------------|---------------------|-----------------------------------|----------------|----------------------------------|--|
| 80 Volts 100 Volts Surge | 2,200 | E32D800HPN222MA41M | 1.375 × 1.625 | A41 | 67.0 | 4.09 |
| | 3,900 | E32D800HPN392MA54M | 1.375 × 2.125 | A54 | 44.2 | 5.84 |
| | 4,700 | E32D800HPN472MA67M | 1.375 × 2.625 | A67 | 31.7 | 6.51 |
| | 6,800 | E32D800HPN682MA79M | 1.375 × 3.125 | A79 | 23.0 | 8.67 |
| | 8,200 | E32D800HPN822MA92M | 1.375 × 3.625 | A92 | 19.5 | 9.92 |
| | 10,000 | E32D800HPN103MAA5M | 1.375 × 4.125 | AA5 | 19.0 | 10.36 |
| | 12,000 | E32D800HPN123MAD0M | 1.375 × 5.125 | AD0 | 14.0 | 12.19 |
| | 4,700 | E32D800HPN472MC48M | 2.000 × 1.875 | C48 | 34.3 | 6.27 |
| | 6,800 | E32D800HPN682MC54M | 2.000 × 2.125 | C54 | 24.6 | 7.90 |
| | 10,000 | E32D800HPN103MC67M | 2.000 × 2.625 | C67 | 17.0 | 10.19 |
| | 12,000 | E32D800HPN123MC79M | 2.000 × 3.125 | C79 | 14.0 | 11.97 |
| | 18,000 | E32D800HPN183MC92M | 2.000 × 3.625 | C92 | 10.4 | 15.66 |
| | 22,000 | E32D800HPN223MCA5M | 2.000 × 4.125 | CA5 | 9.9 | 18.36 |
| | 27,000 | E32D800HPN273MCB7M | 2.000 × 4.625 | CB7 | 8.5 | 21.35 |
| | 33,000 | E32D800HPN333MCE3M | 2.000 × 5.625 | CE3 | 7.2 | 25.86 |
| | 22,000 | E32D800HPN223MD79M | 2.500 × 3.125 | D79 | 10.6 | 16.52 |
| | 33,000 | E32D800HPN333MDA5M | 2.500 × 4.125 | DA5 | 7.6 | 22.84 |
| | 39,000 | E32D800HPN393MDB7M | 2.500 × 4.625 | DB7 | 6.8 | 23.76 |
| | 47,000 | E32D800HPN473MDD0M | 2.500 × 5.125 | DD0 | 6.1 | 25.31 |
| | 39,000 | E32D800HPN393ME92M | 3.000 × 3.625 | E92 | 8.9 | 23.66 |
| 47,000 | E32D800HPN473MEA5M | 3.000 × 4.125 | EA5 | 7.7 | 27.45 | |
| 56,000 | E32D800HPN563MEB7M | 3.000 × 4.625 | EB7 | 6.9 | 31.38 | |
| 68,000 | E32D800HPN683MED0M | 3.000 × 5.125 | ED0 | 6.4 | 33.51 | |
| 120,000 | E32D800HPN124MEN0M | 3.000 × 8.625 | EN0 | 4.2 | 52.62 | |
| 100 Volts 125 Volts Surge | 1,500 | E32D101HPN152MA41M | 1.375 × 1.625 | A41 | 80.9 | 4.14 |
| | 2,700 | E32D101HPN272MA54M | 1.375 × 2.125 | A54 | 45.9 | 5.95 |
| | 3,900 | E32D101HPN392MA67M | 1.375 × 2.625 | A67 | 37.2 | 7.26 |
| | 4,700 | E32D101HPN472MA79M | 1.375 × 3.125 | A79 | 27.1 | 8.82 |
| | 5,600 | E32D101HPN562MA92M | 1.375 × 3.625 | A92 | 23.1 | 10.04 |
| | 6,800 | E32D101HPN682MAA5M | 1.375 × 4.125 | AA5 | 19.5 | 11.03 |
| | 8,200 | E32D101HPN822MAB7M | 1.375 × 4.625 | AB7 | 19.2 | 11.80 |
| | 10,000 | E32D101HPN103MAE3M | 1.375 × 5.625 | AE3 | 14.1 | 13.44 |
| | 3,900 | E32D101HPN392MC48M | 2.000 × 1.875 | C48 | 39.9 | 6.59 |
| | 4,700 | E32D101HPN472MC54M | 2.000 × 2.125 | C54 | 28.7 | 7.59 |
| | 6,800 | E32D101HPN682MC67M | 2.000 × 2.625 | C67 | 20.0 | 9.70 |
| | 10,000 | E32D101HPN103MC79M | 2.000 × 3.125 | C79 | 14.5 | 12.62 |
| | 12,000 | E32D101HPN123MC92M | 2.000 × 3.625 | C92 | 12.2 | 14.77 |
| | 15,000 | E32D101HPN153MCA5M | 2.000 × 4.125 | CA5 | 10.2 | 17.51 |
| | 18,000 | E32D101HPN183MCB7M | 2.000 × 4.625 | CB7 | 9.8 | 20.13 |
| | 22,000 | E32D101HPN223MCE3M | 2.000 × 5.625 | CE3 | 7.5 | 24.38 |
| | 15,000 | E32D101HPN153MD79M | 2.500 × 3.125 | D79 | 11.9 | 15.26 |
| | 22,000 | E32D101HPN223MDA5M | 2.500 × 4.125 | DA5 | 8.5 | 20.85 |
| | 27,000 | E32D101HPN273MDB7M | 2.500 × 4.625 | DB7 | 7.4 | 24.22 |
| | 33,000 | E32D101HPN333MDD0M | 2.500 × 5.125 | DD0 | 6.6 | 28.05 |
| 39,000 | E32D101HPN393MDE3M | 2.500 × 5.625 | DE3 | 6.3 | 31.82 | |
| 27,000 | E32D101HPN273ME92M | 3.000 × 3.625 | E92 | 9.3 | 21.56 | |
| 33,000 | E32D101HPN333MEA5M | 3.000 × 4.125 | EA5 | 8.0 | 25.20 | |
| 39,000 | E32D101HPN393MEB7M | 3.000 × 4.625 | EB7 | 7.2 | 28.69 | |
| 47,000 | E32D101HPN473MED0M | 3.000 × 5.125 | ED0 | 6.6 | 30.09 | |
| 56,000 | E32D101HPN563MEE3M | 3.000 × 5.625 | EE3 | 6.1 | 34.25 | |
| 82,000 | E32D101HPN823MEN0M | 3.000 × 8.625 | EN0 | 4.3 | 50.23 | |
| 160 Volts 200 Volts Surge | 820 | E32D161HPN821MA41M | 1.375 × 1.625 | A41 | 184.8 | 2.50 |
| | 1,500 | E32D161HPN152MA54M | 1.375 × 2.125 | A54 | 101.2 | 3.62 |
| | 1,800 | E32D161HPN182MA67M | 1.375 × 2.625 | A67 | 83.3 | 4.03 |
| | 2,700 | E32D161HPN272MA79M | 1.375 × 3.125 | A79 | 56.8 | 5.46 |
| | 3,900 | E32D161HPN392MAA5M | 1.375 × 4.125 | AA5 | 40.0 | 7.47 |
| | 4,700 | E32D161HPN472MAD0M | 1.375 × 5.125 | AD0 | 33.4 | 8.81 |
| | 5,600 | E32D161HPN562MAE3M | 1.375 × 5.625 | AE3 | 28.6 | 10.06 |

† For terminal, mounting and construction options, refer to the part numbering system for descriptions and codes.

* Refer to diagram of dimensions for detailed case size specifications.

U32D
LARGE CAN 105°C

U32D Series

Standard Voltage Ratings - Screw Terminals

| Rated Voltage (WVDC) | Capacitance (µF) | Global Part Number† | Nominal Case Size* D × L (inches) | Case Size Code | Maximum ESR (mΩ) at +25°C, 120Hz | Rated Ripple Current (A rms) at +85°C, 120Hz |
|------------------------------|--------------------|---------------------|-----------------------------------|----------------|----------------------------------|--|
| 160 Volts 200 Volts Surge | 2,200 | E32D161HPN222MC48M | 2.000 × 1.875 | C48 | 74.6 | 4.29 |
| | 2,700 | E32D161HPN272MC54M | 2.000 × 2.125 | C54 | 59.6 | 4.98 |
| | 3,900 | E32D161HPN392MC67M | 2.000 × 2.625 | C67 | 41.1 | 6.36 |
| | 5,600 | E32D161HPN562MC79M | 2.000 × 3.125 | C79 | 29.4 | 8.18 |
| | 6,800 | E32D161HPN682MC92M | 2.000 × 3.625 | C92 | 24.0 | 9.63 |
| | 8,200 | E32D161HPN822MCA5M | 2.000 × 4.125 | CA5 | 20.5 | 11.21 |
| | 10,000 | E32D161HPN103MCB7M | 2.000 × 4.625 | CB7 | 17.0 | 12.99 |
| | 12,000 | E32D161HPN123MCE3M | 2.000 × 5.625 | CE3 | 14.3 | 15.60 |
| | 8,200 | E32D161HPN822MD79M | 2.500 × 3.125 | D79 | 22.6 | 11.28 |
| | 12,000 | E32D161HPN123MDA5M | 2.500 × 4.125 | DA5 | 15.8 | 15.40 |
| | 18,000 | E32D161HPN183MDB7M | 2.500 × 4.625 | DB7 | 11.8 | 19.77 |
| | 18,000 | E32D161HPN183ME92M | 3.000 × 3.625 | E92 | 14.7 | 19.68 |
| | 22,000 | E32D161HPN223MEB7M | 3.000 × 4.625 | EB7 | 11.3 | 24.09 |
| | 27,000 | E32D161HPN273MED0M | 3.000 × 5.125 | ED0 | 9.9 | 27.93 |
| 47,000 | E32D161HPN473MEN0M | 3.000 × 8.625 | EN0 | 6.2 | 46.58 | |
| 200 Volts 250 Volts Surge | 680 | E32D201HPN681MA41M | 1.375 × 1.625 | A41 | 192.4 | 2.28 |
| | 1,000 | E32D201HPN102MA54M | 1.375 × 2.125 | A54 | 128.5 | 2.96 |
| | 1,500 | E32D201HPN152MA67M | 1.375 × 2.625 | A67 | 86.3 | 3.68 |
| | 1,800 | E32D201HPN182MA79M | 1.375 × 3.125 | A79 | 71.8 | 4.46 |
| | 2,200 | E32D201HPN222MA92M | 1.375 × 3.625 | A92 | 59.1 | 5.14 |
| | 2,700 | E32D201HPN272MAA5M | 1.375 × 4.125 | AA5 | 48.7 | 6.22 |
| | 3,300 | E32D201HPN332MAB7M | 1.375 × 4.625 | AB7 | 40.4 | 7.03 |
| | 3,900 | E32D201HPN392MAD0M | 1.375 × 5.125 | AD0 | 34.7 | 8.03 |
| | 1,500 | E32D201HPN152MC48M | 2.000 × 1.875 | C48 | 110.7 | 4.09 |
| | 2,200 | E32D201HPN222MC54M | 2.000 × 2.125 | C54 | 63.1 | 5.19 |
| | 3,300 | E32D201HPN332MC67M | 2.000 × 2.625 | C67 | 42.2 | 6.76 |
| | 3,900 | E32D201HPN392MC79M | 2.000 × 3.125 | C79 | 35.2 | 7.88 |
| | 5,600 | E32D201HPN562MC92M | 2.000 × 3.625 | C92 | 25.1 | 10.09 |
| | 8,200 | E32D201HPN822MCB7M | 2.000 × 4.625 | CB7 | 17.8 | 13.59 |
| | 10,000 | E32D201HPN103MCE3M | 2.000 × 5.625 | CE3 | 14.8 | 16.44 |
| | 6,800 | E32D201HPN682MD79M | 2.500 × 3.125 | D79 | 23.6 | 10.27 |
| | 10,000 | E32D201HPN103MDA5M | 2.500 × 4.125 | DA5 | 16.5 | 14.06 |
| | 12,000 | E32D201HPN123MDB7M | 2.500 × 4.625 | DB7 | 13.8 | 16.14 |
| | 15,000 | E32D201HPN153MDE3M | 2.500 × 5.625 | DE3 | 11.5 | 19.74 |
| | 12,000 | E32D201HPN123ME92M | 3.000 × 3.625 | E92 | 16.4 | 16.07 |
| 15,000 | E32D201HPN153MEA5M | 3.000 × 4.125 | EA5 | 13.7 | 18.99 | |
| 18,000 | E32D201HPN183MEB7M | 3.000 × 4.625 | EB7 | 11.9 | 21.79 | |
| 22,000 | E32D201HPN223MEE3M | 3.000 × 5.625 | EE3 | 9.8 | 26.29 | |
| 33,000 | E32D201HPN333MEN0M | 3.000 × 8.625 | EN0 | 6.8 | 39.03 | |
| 250 Volts 300 Volts Surge | 470 | E32D251HPN471MA41M | 1.375 × 1.625 | A41 | 273.0 | 1.89 |
| | 820 | E32D251HPN821MA54M | 1.375 × 2.125 | A54 | 155.3 | 2.68 |
| | 1,200 | E32D251HPN122MA67M | 1.375 × 2.625 | A67 | 106.5 | 3.29 |
| | 1,500 | E32D251HPN152MA79M | 1.375 × 3.125 | A79 | 85.3 | 3.53 |
| | 1,800 | E32D251HPN182MA92M | 1.375 × 3.625 | A92 | 71.3 | 4.02 |
| | 2,200 | E32D251HPN222MAA5M | 1.375 × 4.125 | AA5 | 58.8 | 4.86 |
| | 2,700 | E32D251HPN272MAB7M | 1.375 × 4.625 | AB7 | 48.5 | 5.51 |
| | 3,300 | E32D251HPN332MAE3M | 1.375 × 5.625 | AE3 | 40.0 | 6.69 |
| | 1,200 | E32D251HPN122MC48M | 2.000 × 1.875 | C48 | 112.1 | 3.17 |
| | 1,500 | E32D251HPN152MC54M | 2.000 × 2.125 | C54 | 88.4 | 3.71 |
| | 2,200 | E32D251HPN222MC67M | 2.000 × 2.625 | C67 | 60.1 | 4.78 |
| | 3,300 | E32D251HPN332MC79M | 2.000 × 3.125 | C79 | 41.0 | 6.28 |
| | 3,900 | E32D251HPN392MC92M | 2.000 × 3.625 | C92 | 34.6 | 7.29 |
| | 4,700 | E32D251HPN472MCA5M | 2.000 × 4.125 | CA5 | 29.0 | 8.49 |
| | 5,600 | E32D251HPN562MCB7M | 2.000 × 4.625 | CB7 | 24.7 | 9.72 |
| | 6,800 | E32D251HPN682MCD0M | 2.000 × 5.125 | CD0 | 20.7 | 11.24 |
| | 5,600 | E32D251HPN562MD79M | 2.500 × 3.125 | D79 | 27.7 | 9.32 |
| | 8,200 | E32D251HPN822MDA5M | 2.500 × 4.125 | DA5 | 19.3 | 12.73 |

† For terminal, mounting and construction options, refer to the part numbering system for descriptions and codes.

* Refer to diagram of dimensions for detailed case size specifications.

U32D Series

Standard Voltage Ratings - Screw Terminals

| Rated Voltage (WVDC) | Capacitance (µF) | Global Part Number† | Nominal Case Size* D × L (inches) | Case Size Code | Maximum ESR (mΩ) at +25°C, 120Hz | Rated Ripple Current (A rms) at +85°C, 120Hz |
|------------------------------|--------------------|---------------------|-----------------------------------|----------------|----------------------------------|--|
| 250 Volts 300 Volts Surge | 10,000 | E32D251HPN103MDB7M | 2.500 × 4.625 | DB7 | 18.5 | 14.74 |
| | 12,000 | E32D251HPN123MDE3M | 2.500 × 5.625 | DE3 | 13.6 | 17.65 |
| | 10,000 | E32D251HPN103ME92M | 3.000 × 3.625 | E92 | 18.8 | 14.67 |
| | 12,000 | E32D251HPN123MEA5M | 3.000 × 4.125 | EA5 | 15.9 | 16.99 |
| | 15,000 | E32D251HPN153MED0M | 3.000 × 5.125 | ED0 | 12.7 | 20.82 |
| | 18,000 | E32D251HPN183MEE3M | 3.000 × 5.625 | EE3 | 11.2 | 23.78 |
| | 27,000 | E32D251HPN273MEN0M | 3.000 × 8.625 | EN0 | 7.7 | 35.30 |
| 315 Volts 365 Volts Surge | 220 | E32D3B1HPN221MA41M | 1.375 × 1.625 | A41 | 750.3 | 1.59 |
| | 330 | E32D3B1HPN331MA54M | 1.375 × 2.125 | A54 | 492.0 | 2.08 |
| | 470 | E32D3B1HPN471MA67M | 1.375 × 2.625 | A67 | 343.8 | 2.52 |
| | 680 | E32D3B1HPN681MA79M | 1.375 × 3.125 | A79 | 237.8 | 3.36 |
| | 820 | E32D3B1HPN821MA92M | 1.375 × 3.625 | A92 | 197.2 | 3.14 |
| | 1,000 | E32D3B1HPN102MAA5M | 1.375 × 4.125 | AA5 | 161.9 | 8.46 |
| | 1,200 | E32D3B1HPN122MAD0M | 1.375 × 5.125 | AD0 | 134.9 | 9.96 |
| | 470 | E32D3B1HPN471MC48M | 2.000 × 1.875 | C48 | 354.0 | 2.80 |
| | 680 | E32D3B1HPN681MC54M | 2.000 × 2.125 | C54 | 243.1 | 3.53 |
| | 1,000 | E32D3B1HPN102MC67M | 2.000 × 2.625 | C67 | 164.1 | 3.72 |
| | 1,200 | E32D3B1HPN122MC79M | 2.000 × 3.125 | C79 | 135.9 | 4.37 |
| | 1,800 | E32D3B1HPN182MC92M | 2.000 × 3.625 | C92 | 91.0 | 5.72 |
| | 2,200 | E32D3B1HPN222MCA5M | 2.000 × 4.125 | CA5 | 75.0 | 6.70 |
| | 2,700 | E32D3B1HPN272MCB7M | 2.000 × 4.625 | CB7 | 61.3 | 7.80 |
| | 3,300 | E32D3B1HPN332MCE3M | 2.000 × 5.625 | CE3 | 50.3 | 9.44 |
| | 2,200 | E32D3B1HPN222MD79M | 2.500 × 3.125 | D79 | 77.0 | 6.75 |
| | 3,300 | E32D3B1HPN332MDA5M | 2.500 × 4.125 | DA5 | 51.7 | 9.32 |
| | 3,900 | E32D3B1HPN392MDB7M | 2.500 × 4.625 | DB7 | 43.7 | 10.63 |
| | 4,700 | E32D3B1HPN472MDD0M | 2.500 × 5.125 | DD0 | 36.9 | 12.22 |
| | 3,900 | E32D3B1HPN392ME92M | 3.000 × 3.625 | E92 | 45.7 | 10.58 |
| 4,700 | E32D3B1HPN472MEA5M | 3.000 × 4.125 | EA5 | 38.2 | 12.28 | |
| 5,600 | E32D3B1HPN562MEB7M | 3.000 × 4.625 | EB7 | 32.4 | 14.03 | |
| 6,800 | E32D3B1HPN682MED0M | 3.000 × 5.125 | ED0 | 27.2 | 16.19 | |
| 8,200 | E32D3B1HPN822MEE3M | 3.000 × 5.625 | EE3 | 23.1 | 18.53 | |
| 12,000 | E32D3B1HPN123MEN0M | 3.000 × 8.625 | EN0 | 16.0 | 27.17 | |
| 350 Volts 400 Volts Surge | 180 | E32D351HPN181MA41M | 1.375 × 1.625 | A41 | 882.3 | 1.43 |
| | 330 | E32D351HPN331MA54M | 1.375 × 2.125 | A54 | 475.0 | 2.08 |
| | 470 | E32D351HPN471MA67M | 1.375 × 2.625 | A67 | 332.0 | 2.52 |
| | 560 | E32D351HPN561MA79M | 1.375 × 3.125 | A79 | 277.6 | 3.05 |
| | 680 | E32D351HPN681MA92M | 1.375 × 3.625 | A92 | 228.5 | 3.36 |
| | 820 | E32D351HPN821MAA5M | 1.375 × 4.125 | AA5 | 189.6 | 3.43 |
| | 1,000 | E32D351HPN102MAB7M | 1.375 × 4.625 | AB7 | 156.0 | 3.87 |
| | 1,200 | E32D351HPN122MAD0M | 1.375 × 5.125 | AD0 | 130.0 | 4.45 |
| | 470 | E32D351HPN471MC48M | 2.000 × 1.875 | C48 | 342.0 | 2.80 |
| | 680 | E32D351HPN681MC54M | 2.000 × 2.125 | C54 | 235.0 | 3.53 |
| | 1,000 | E32D351HPN102MC67M | 2.000 × 2.625 | C67 | 156.0 | 3.72 |
| | 1,200 | E32D351HPN122MC79M | 2.000 × 3.125 | C79 | 131.3 | 4.37 |
| | 1,800 | E32D351HPN182MC92M | 2.000 × 3.625 | C92 | 88.0 | 5.72 |
| | 2,200 | E32D351HPN222MCB7M | 2.000 × 4.625 | CB7 | 71.9 | 7.04 |
| | 2,700 | E32D351HPN272MCD0M | 2.000 × 5.125 | CD0 | 59.0 | 8.18 |
| | 2,200 | E32D351HPN222MD79M | 2.500 × 3.125 | D79 | 75.0 | 6.75 |
| | 3,300 | E32D351HPN332MDA5M | 2.500 × 4.125 | DA5 | 50.0 | 9.32 |
| | 3,900 | E32D351HPN392MDB7M | 2.500 × 4.625 | DB7 | 42.0 | 10.63 |
| | 4,700 | E32D351HPN472MDE3M | 2.500 × 5.625 | DE3 | 35.0 | 12.76 |
| | 3,900 | E32D351HPN392ME92M | 3.000 × 3.625 | E92 | 44.0 | 10.58 |
| 4,700 | E32D351HPN472MEA5M | 3.000 × 4.125 | EA5 | 37.0 | 12.28 | |
| 5,600 | E32D351HPN562MEB7M | 3.000 × 4.625 | EB7 | 32.0 | 14.03 | |
| 6,800 | E32D351HPN682MED0M | 3.000 × 5.125 | ED0 | 27.0 | 16.19 | |
| 10,000 | E32D351HPN103MEN0M | 3.000 × 8.625 | EN0 | 17.9 | 24.81 | |

†For terminal, mounting and construction options, refer to the part numbering system for descriptions and codes.

*Refer to diagram of dimensions for detailed case size specifications.

U32D
LARGE CAN 105°C

U32D Series

Standard Voltage Ratings - Screw Terminals



| Rated Voltage (WVDC) | Capacitance (µF) | Global Part Number† | Nominal Case Size* D × L (inches) | Case Size Code | Maximum ESR (mΩ) at +25°C, 120Hz | Rated Ripple Current (A rms) at +85°C, 120Hz |
|-------------------------------------|--------------------|---------------------|-----------------------------------|----------------|----------------------------------|--|
| 350 Volts 400 Volts Surge | 5,600 | E32D351LLN562MFA5M | 3.500 × 4.125 | FA5 | 35.0 | 15.40 |
| | 6,800 | E32D351LLN682MFB7M | 3.500 × 4.625 | FB7 | 30.0 | 17.28 |
| | 8,200 | E32D351LLN822MFE3M | 3.500 × 5.625 | FE3 | 24.0 | 21.00 |
| 400 Volts 450 Volts Surge | 180 | E32D401HPN181MA41M | 1.375 × 1.625 | A41 | 806.0 | 1.43 |
| | 270 | E32D401HPN271MA54M | 1.375 × 2.125 | A54 | 528.4 | 1.88 |
| | 390 | E32D401HPN391MA67M | 1.375 × 2.625 | A67 | 364.1 | 2.30 |
| | 470 | E32D401HPN471MA79M | 1.375 × 3.125 | A79 | 301.2 | 2.79 |
| | 680 | E32D401HPN681MA92M | 1.375 × 3.625 | A92 | 209.0 | 2.86 |
| | 820 | E32D401HPN821MAB7M | 1.375 × 4.625 | AB7 | 172.9 | 3.50 |
| | 1,000 | E32D401HPN102MAD0M | 1.375 × 5.125 | AD0 | 142.0 | 4.06 |
| | 390 | E32D401HPN391MC48M | 2.000 × 1.875 | C48 | 374.9 | 2.55 |
| | 560 | E32D401HPN561MC54M | 2.000 × 2.125 | C54 | 259.0 | 3.21 |
| | 820 | E32D401HPN821MC67M | 2.000 × 2.625 | C67 | 176.0 | 3.37 |
| | 1,000 | E32D401HPN102MC79M | 2.000 × 3.125 | C79 | 143.3 | 3.99 |
| | 1,500 | E32D401HPN152MC92M | 2.000 × 3.625 | C92 | 96.0 | 5.22 |
| | 2,200 | E32D401HPN222MCB7M | 2.000 × 4.625 | CB7 | 66.0 | 7.04 |
| | 2,700 | E32D401HPN272MCE3M | 2.000 × 5.625 | CE3 | 54.0 | 8.54 |
| | 1,800 | E32D401HPN182MD79M | 2.500 × 3.125 | D79 | 82.0 | 6.10 |
| | 2,700 | E32D401HPN272MDA5M | 2.500 × 4.125 | DA5 | 55.0 | 8.43 |
| | 3,300 | E32D401HPN332MDB7M | 2.500 × 4.625 | DB7 | 45.4 | 9.78 |
| | 3,900 | E32D401HPN392MDD0M | 2.500 × 5.125 | DD0 | 39.0 | 11.13 |
| | 3,300 | E32D401HPN332ME92M | 3.000 × 3.625 | E92 | 48.0 | 9.73 |
| | 3,900 | E32D401HPN392MEA5M | 3.000 × 4.125 | EA5 | 40.3 | 11.18 |
| | 4,700 | E32D401HPN472MEB7M | 3.000 × 4.625 | EB7 | 34.0 | 12.86 |
| | 5,600 | E32D401HPN562MED0M | 3.000 × 5.125 | ED0 | 29.0 | 14.69 |
| | 10,000 | E32D401HPN103MEN0M | 3.000 × 8.625 | EN0 | 17.0 | 24.81 |
| 4,700 | E32D401LLN472MFA5M | 3.500 × 4.125 | FA5 | 36.0 | 15.19 | |
| 5,600 | E32D401LLN562MFB7M | 3.500 × 4.625 | FB7 | 32.0 | 16.73 | |
| 6,800 | E32D401LLN682MFE3M | 3.500 × 5.625 | FE3 | 25.0 | 20.58 | |

† For terminal, mounting and construction options, refer to the part numbering system for descriptions and codes.







* Refer to diagram of dimensions for detailed case size specifications.

Looking for pricing, stock, or lifecycle information?

Click below to explore more details on WIN SOURCE:

-  [View E32D101LPS302MC48M on WIN SOURCE](#)
-  [United Chemi-Con Information](#)

Optimize Your Supply Chain with WIN SOURCE Solutions

-  Global Sourcing Solution
-  Obsolete Management
-  Cost Control Management
-  Shortage Management
-  Alternative Solution
-  Excess Inventory Management