



**THE DATASHEET OF  
CLS62NP-150NC**



**Type: CLS62**
**◆ Product Description**

- 7.3×7.1mm Max.(L×W), 2.5mm Max. Height.
- Inductance Range: 10  $\mu$  H~39mH, Rated current range: 37mA~700mA
- In addition to the typical versions of parameters shown here, custom designs are available to meet your exact requirements.

**◆ Feature**

- Magnetically shielded construction.
- Ideally used in power supply of DSC, DVC, Note PC .
- RoHS Compliance

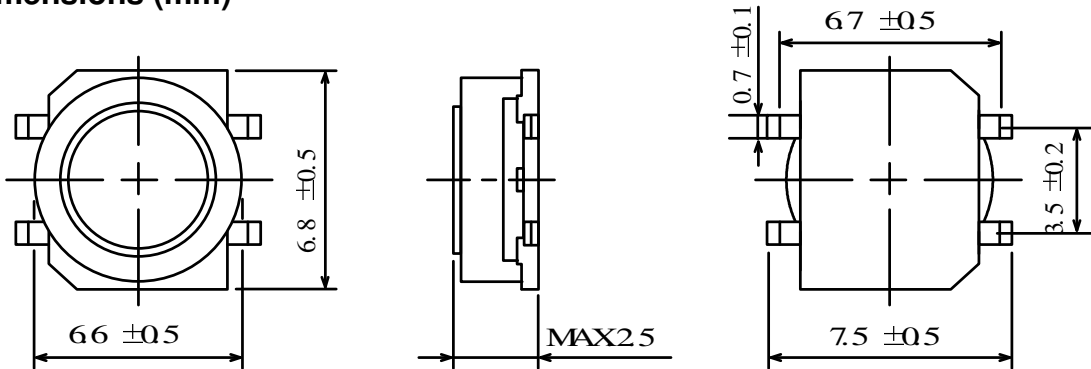
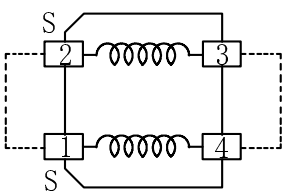
**◆ Dimensions (mm)**

**◆ Schematics (Bottom)**

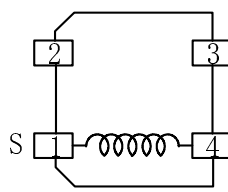
10  $\mu$  H~22  $\mu$  H  
270  $\mu$  H~390  $\mu$  H



27  $\mu$  H~220  $\mu$  H  
470  $\mu$  H~3.9mH

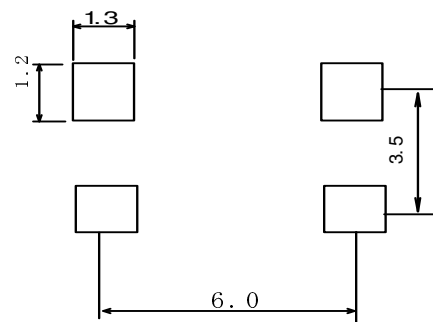

“ S ” indicates winding start.

**◆ Land Pattern (mm)**



## Looking for pricing, stock, or lifecycle information?

Click below to explore more details on WIN SOURCE:

-  [View CLS62NP-150NC on WIN SOURCE](#)
-  [Sumida America Components Inc. Information](#)

## Optimize Your Supply Chain with WIN SOURCE Solutions

-  Global Sourcing Solution
-  Obsolete Management
-  Cost Control Management
-  Shortage Management
-  Alternative Solution
-  Excess Inventory Management