

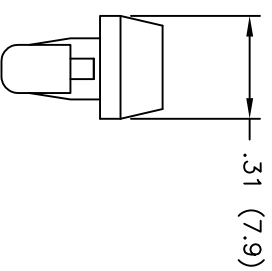

**THE DATASHEET OF
MB-5-156**

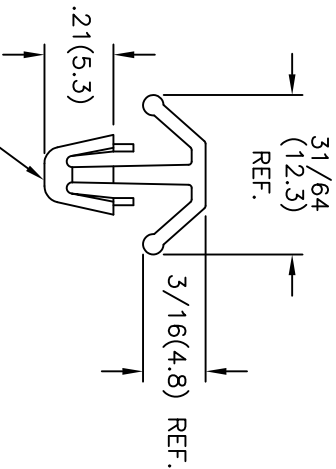

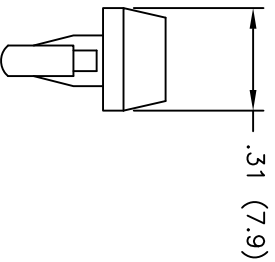
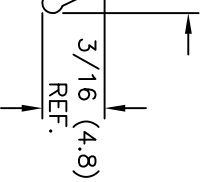
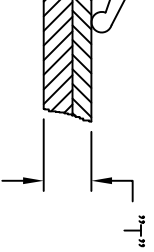

PART NUMBER	RECOMMENDED
MB-1-156	1/32-3/32 (0.8-2.4)
MB-3-156	3/32-5/32 (2.4-4.0)
MB-5-156	5/32-7/32 (4.0-5.6)
MB-7-156	7/32-9/32 (5.6-7.1)
MB-9-156	9/32-11/32 (7.1-8.7)
MB-11-156	11/32-13/32 (8.7-10.3)
MB-13-156	13/32-15/32 (10.3-11.9)
MB-15-156	15/32-17/32 (11.9-13.5)
MB-17-156	17/32-19/32 (13.5-15.1)

FIT A .156
DIA. HOLE

P/N MB-156

P/N MB-187

6 (RMS-01).
NYLON (RMS-19),
ALL ORDER ONLY.

MOUNTING BUTTON

ANGES	SK 05.23.08
ANGES	SK 04.07.08
E BLOCK	SM 05.17.01
D.	JL 7.9.98
RANGE	JB 08.15.96
	ENGR DATE

TITLE:	MOUNTING BUTTON		DWG IN IN (MM)	FINAL	PRINT TYPE
TOLERANCES UNLESS NOTED	FILE #	MB	DWN: R.S.	APP:	CA
.XX=±.010	MAT'L:	SEE NOTES	DT: 11-10-93	DT:	
.XXX=±.005	RE:	RICHCO, INC.	Po BOX 804238	RICHCO INC.	SEE TABLE
FRAC=±1/64			(773) 539-4060	CHICAGO, 60680	
ANG=±1°					

Looking for pricing, stock, or lifecycle information?

Click below to explore more details on WIN SOURCE:

- ⊖ [View MB-5-156 on WIN SOURCE](#)
- ⊖ [Essentra Components Information](#)

Optimize Your Supply Chain with WIN SOURCE Solutions

- ✓ Global Sourcing Solution
- ✓ Obsolete Management
- ✓ Cost Control Management
- ✓ Shortage Management
- ✓ Alternative Solution
- ✓ Excess Inventory Management