



**THE DATASHEET OF
KD231050000G**



PRODUCT NUMBER	PITCH
KDxx10x00J0G	3.50 mm

PART NO

Dim L=(N-1)×3.5+4.2	
Dim P=(N-1)×3.5	
N=Number of poles	
POLES	Tolerance
2p-6p	±0.15
7p-12p	±0.25
13p-18p	±0.30
19p-24p	±0.40

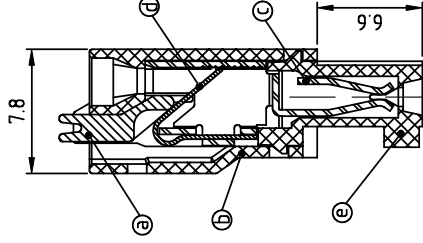
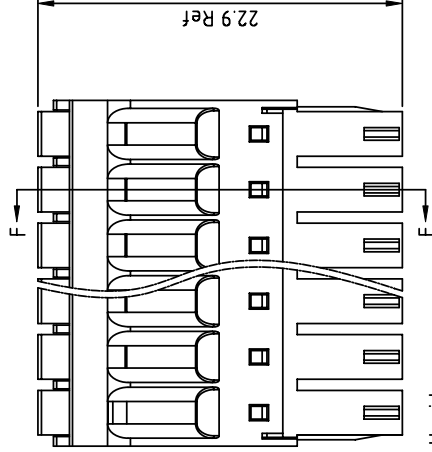
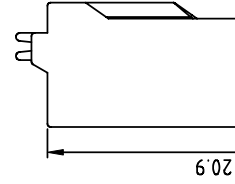
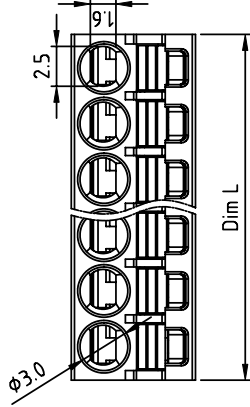

SECTION F-F

2P-6P Ribs on both sides
7P-24P No rib

- Material:
- Item Ⓐ Terminal
 - Item Ⓑ Top housing
 - Item Ⓒ Female contact
 - Item Ⓓ Spring clip
 - Item Ⓔ Bottom housing
- Electrical:
- Voltage rating:
 - Current rating:
 - Wire range:
 - Solid wire(AWG)
 - Stranded wire()
 - Wire strip length
 - Withstanding V
 - Operating temp
 - Safety Approva

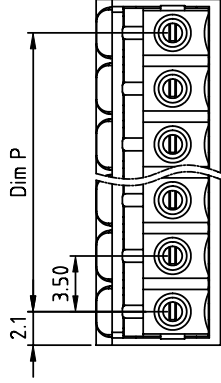

mat'l. code		surface	
itr	ecn no dr	date	tolerances unless oth
B	T-24172 HF	052816	ASME Y14.5 A
			angles
			X ±1°
			dr
			engr
			chr
			appd
sheet	revision	B	
index	sheet	1	

form: A4mmXLc

1

2

PDS: Rev

Looking for pricing, stock, or lifecycle information?

Click below to explore more details on WIN SOURCE:

- ⊖ [View KD231050000G on WIN SOURCE](#)
- ⊖ [Amphenol Anytek Information](#)

Optimize Your Supply Chain with WIN SOURCE Solutions

- ✓ Global Sourcing Solution
- ✓ Obsolete Management
- ✓ Cost Control Management
- ✓ Shortage Management
- ✓ Alternative Solution
- ✓ Excess Inventory Management