



**THE DATASHEET OF
OSTV8205150**



5

4

3

2

1

THESE DRAWINGS AND SPECIFICATIONS ARE THE PROPERTY OF ON-SHORE TECHNOLOGY, INC. AND SHALL NOT BE REPRODUCED, COPIED OR USED IN ANY MANNER WITHOUT THE PRIOR WRITTEN CONSENT OF ON-SHORE TECHNOLOGY, INC.

SIGN	DATE	Approval address
△	2011.08.08	THIS IS CAD DRAWING

Material

- Insulator (Body): Therm
- Insulator (Cover): Therm
- Terminal screw: Steel Z
- Terminal body: Brass (Cu)
- Contact Pin: Brass, Tin

Electrical

- Voltage rating: 300VAC
- Current rating: 20A
- Wire range: Solid wire(AWG): 12-24 Stranded wire(AWG): 16-18
- Torque: 4Lb-In
- Screw: M3
- Wire strip length: 7-8mm
- Withstanding Voltage: 1000V
- Operating temperature: -40 to 100°C
- Safety Approval: CE, RoHS

RoHS Compliant

PART NUMBER:

OSTV8XX5

No. of Pole	02 2 Pole
	03 3 Pole

	24 24 Pole

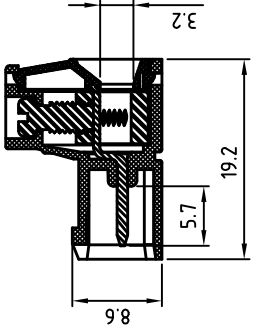
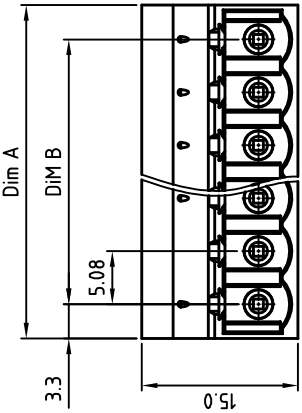
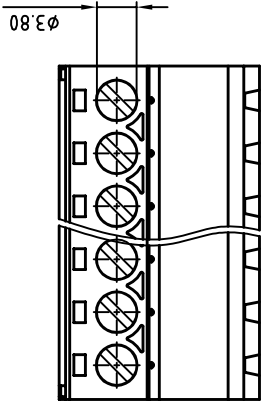

Poles	2	3	4	5	6	7	8	9	10	11	12	13
Dim A	11.66	16.74	21.82	26.90	31.98	37.06	42.14	47.22	52.30	57.38	62.46	67.54
Dim B	5.08	10.16	15.24	20.32	25.40	30.48	35.56	40.64	45.72	50.80	55.88	60.96
TOL	±0.15											
Poles	14	15	16	17	18	19	20	21	22	23	24	
Dim A	72.62	77.70	82.78	87.86	92.94	98.02	103.10	108.18	113.26	118.34	123.42	
Dim B	66.04	71.12	76.20	81.28	86.36	91.44	96.52	101.60	106.68	111.76	116.84	
TOL	±0.25											

Poles	2	3	4	5	6	7	8	9	10	11	12	13
Dim A	11.66	16.74	21.82	26.90	31.98	37.06	42.14	47.22	52.30	57.38	62.46	67.54
Dim B	5.08	10.16	15.24	20.32	25.40	30.48	35.56	40.64	45.72	50.80	55.88	60.96
TOL	±0.20											



ON-SHORE

TITLE	OSTV8 5.08 Series without flange		
PART NO.	OSTV8XX5150	DESIGNED	DRAWN
APPROVED	Marvin 2008.06.06	CHECKED	Marvin 2008.06.06
		DESIGNED	Tason 2007,10,31

5

4



3

2

1

Looking for pricing, stock, or lifecycle information?

Click below to explore more details on WIN SOURCE:

-  [View OSTV8205150 on WIN SOURCE](#)
-  [On Shore Technology Inc. Information](#)

Optimize Your Supply Chain with WIN SOURCE Solutions

-  Global Sourcing Solution
-  Obsolete Management
-  Cost Control Management
-  Shortage Management
-  Alternative Solution
-  Excess Inventory Management