



**THE DATASHEET OF  
CG-NPT-1-2-BK**



# CG US #E336396

PART NUMBER	THREAD SIZE	CABLE DIAMETER		SUGGESTED CLEARANCE HOLE FOR NON THREADED MOUNTING	"L" ±0.5[.020]	"SW-1" ±0.5[.020]	"H" MAX REF	INSTALLATION TORQUE**
		MIN Ø	MAX Ø					
CG-NPT-3/8-1-BK	NPT-3/8	3[.118]	7[.276]	17[.670]	14.5[.571]	22[.866]	44.5[1.752]	2.2
CG-NPT-3/8-2-BK		5[.197]	10[.394]					
CG-NPT-1/2-1-BK	NPT-1/2	5[.197]	9[.236]	22.2[.875]	15[.591]	24[.945]	45[1.772]	2.7
CG-NPT-1/2-2-BK		7[.276]	12[.472]					
CG-NPT-1/2-3-BK	NPT-3/4	10[.394]	14[.551]	27.1[1.068]	18[.709]	27[1.063]	47.5[1.870]	3.0
CG-NPT-3/4-1-BK		9[.236]	16[.630]					
CG-NPT-3/4-2-BK	NPT-1	14[.551]	18[.709]	34.3[1.350]	42[1.654]	33[1.299]	52[2.047]	5.0
CG-NPT-1-1-BK		12[.472]	20[.787]					
CG-NPT-1-2-BK		19[.748]	25[.984]					7.5

O RING INCLUDED WITH THREADS NPT-1

PARTS AVAILABLE IN GREY (RAL 7035) BY SPECIAL ORDER.  
TO ORDER REMOVE -BK FROM END OF PART NUMBER.

\*\*TESTED WITH SPECIFIED TEST MANDRELS ACCORDING DIN EN 50262, CHAPTER 5.7. DEPENDING ON THE CABLE CONSTRUCTION DIFFERENCES ARE POSSIBLE.

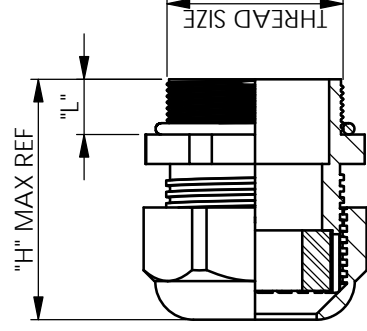
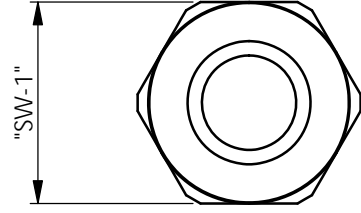

NOTES:  
TEMPERATURE RANGE -20 °C TO +100 °C  
PROTECTION GRADE IP68 - 5 BAR

INFOR	RICH	REPR
<b>RICH</b>	<b>WWW.F.</b>	
MATERIA		
DESCRIP		
DRG No		
DRN		
MT		

## Looking for pricing, stock, or lifecycle information?

Click below to explore more details on WIN SOURCE:

- ⊖ [View CG-NPT-1-2-BK on WIN SOURCE](#)
- ⊖ [Essentra Components Information](#)

## Optimize Your Supply Chain with WIN SOURCE Solutions

- ✓ Global Sourcing Solution
- ✓ Obsolete Management
- ✓ Cost Control Management
- ✓ Shortage Management
- ✓ Alternative Solution
- ✓ Excess Inventory Management