

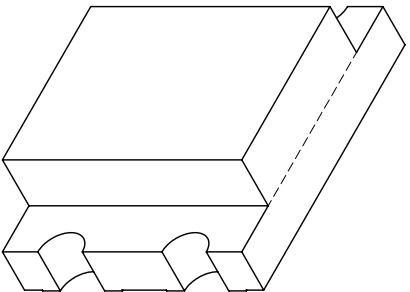

**THE DATASHEET OF  
SML-LX1210IGC-TR**



PART NUMBER	SML-LX1210GC-TR	REV.	1
DATE	E.C.N. NUMBER AND REVISION COMMENTS	REV.	
11.06.95	ADDED TAPE W/POLARITY AND DIRECTION.	A	
03.17.97	E.C.N. #10324.	B	
05.22.98	E.C.N. #10404, & #10BRDR & REDRAWN.	C	
01.04.01	E.C.N. #10695	D	
01.25.02	E.C.N. #10834.	E	
03.25.03	E.C.N. #10972.	F	
02.07.05	E.C.N. #11148.	G	
03.10.09	E.C.N. #11508.	H	
07.22.11	E.C.N. #11740/#10BRDR & REDRAWN.	I	



CATHODE MARK THIS SIDE

PARAMETER	MIN	TP	MAX	UNITS	UNITS
PEAK WAVELENGTH (R/G)	639/565			nm	
FORWARD VOLTAGE (R/G)	2.0/2.2		2.6	Vf	I <sub>f</sub> =1000μA
REVERSE VOLTAGE	5.0			Vr	I <sub>r</sub> =20mA
AXIAL INTENSITY		10		mcd	
VIEWING ANGLE		160		2x theta	
EMITTED COLOR:		RED/GREEN			
EPOXY LENS FINISH:		WATER CLEAR			

LIMITS OF SAFE OPERATION AT 25°C

PARAMETER	MAX	UNITS
PEAK FORWARD CURRENT*	150	mA
STEADY CURRENT (R/G)	30/25	mA
POWER DISSIPATION	65	mW
DERATE FROM 25°C	-1.2	mW/°C
OPERATING TEMP.	-25 TO +85	°C
STORAGE TEMP.	-30 TO +85	°C

\* I<10μs

**CAUTION: MOISTURE SENSITIVE DEVICE**  
PER JEDEC LEVEL 2 STANDARDS

RECOMMENDED SOLDER PAD LAYOUT

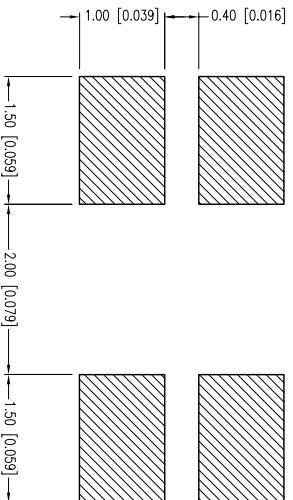

X±1 (+0.039), X-X±0.5 (+0.020), XX±0.25 (+0.010), XXX±0.127 (+0.005), LEAD SIZE±0.05 (+0.002), LEAD LENGTH±0.75 (+0.030), MIN±0.001 DECMAL PRECISION MAX±0.001 DECMAL PRECISION

HELEN ROAD  
E. I. L 60067-6976  
+1.847.359.2790  
WWW.LUXEY.COM

2.7x 3.2mm P.C.B. SURFACE MOUNT LED, DUAL RED/GREEN CHIPS, WATER CLEAR LENS, TAPE & REEL.

\*\*THE SPECIFICATIONS MAY CHANGE AT ANY TIME WITHOUT NOTICE DUE TO NEW MATERIALS OR PRODUCT IMPROVEMENT\*\*

CONFIDENTIAL INFORMATION  
THE INFORMATION CONTAINED IN THIS DOCUMENT IS THE PROPERTY OF LUXEY INC. EXCEPT AS SPECIFICALLY AUTHORIZED IN WRITING BY LUXEY INC., THE HOLDER OF THIS DOCUMENT SHALL KEEP ALL INFORMATION CONTAINED HEREIN CONFIDENTIAL AND SHALL PROTECT SAME IN WHOLE OR IN PART FROM DISCLOSURE AND DISSEMINATION TO ALL THIRD PARTIES.

UNCONTROLLED DOCUMENT

DATE:	07.22.11	DRAWN BY:	AB
PAGE:	1 OF 2	CHKD BY:	KF
SCALE:	NTS	APRVD BY:	SS
UNIT:	mm [INCH]		



PART NUMBER	SML-LX1210GC-TR		REV.	1
DATE	E.C.N. NUMBER AND REVISION COMMENTS		REV.	N/A
N/A	FOR REVISION HISTORY PLEASE SEE PAGE 1		REV.	N/A

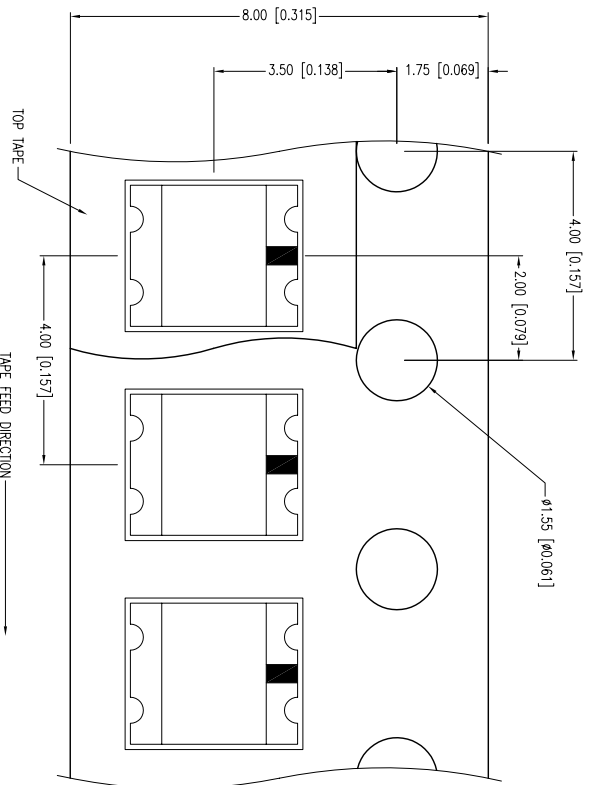
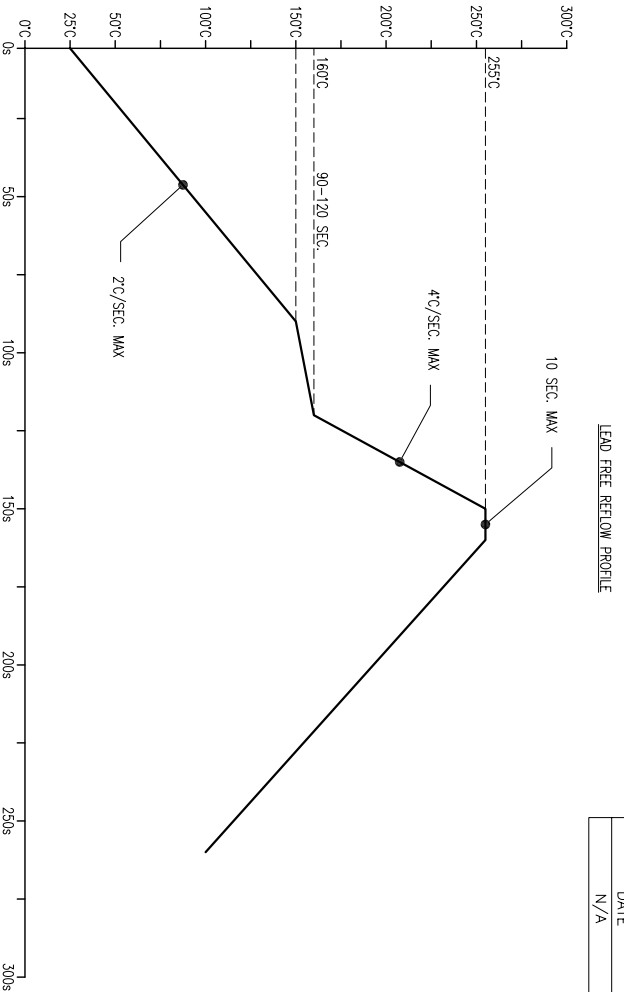

- NOTES:
1. THE CATHODE IS ORIENTED TOWARDS THE TAPE SPROCKET HOLE.
  2. LOCATION FOR CATHODE MARK CAN BE EITHER ON THE TOP OR BOTTOM OF THE PART.

## Looking for pricing, stock, or lifecycle information?

Click below to explore more details on WIN SOURCE:

- ⊖ [View SML-LX1210IGC-TR on WIN SOURCE](#)
- ⊖ [Lumex Opto/Components Inc. Information](#)

## Optimize Your Supply Chain with WIN SOURCE Solutions

- ✓ Global Sourcing Solution
- ✓ Obsolete Management
- ✓ Cost Control Management
- ✓ Shortage Management
- ✓ Alternative Solution
- ✓ Excess Inventory Management